

ELEVATION  
SCALE - 1:25

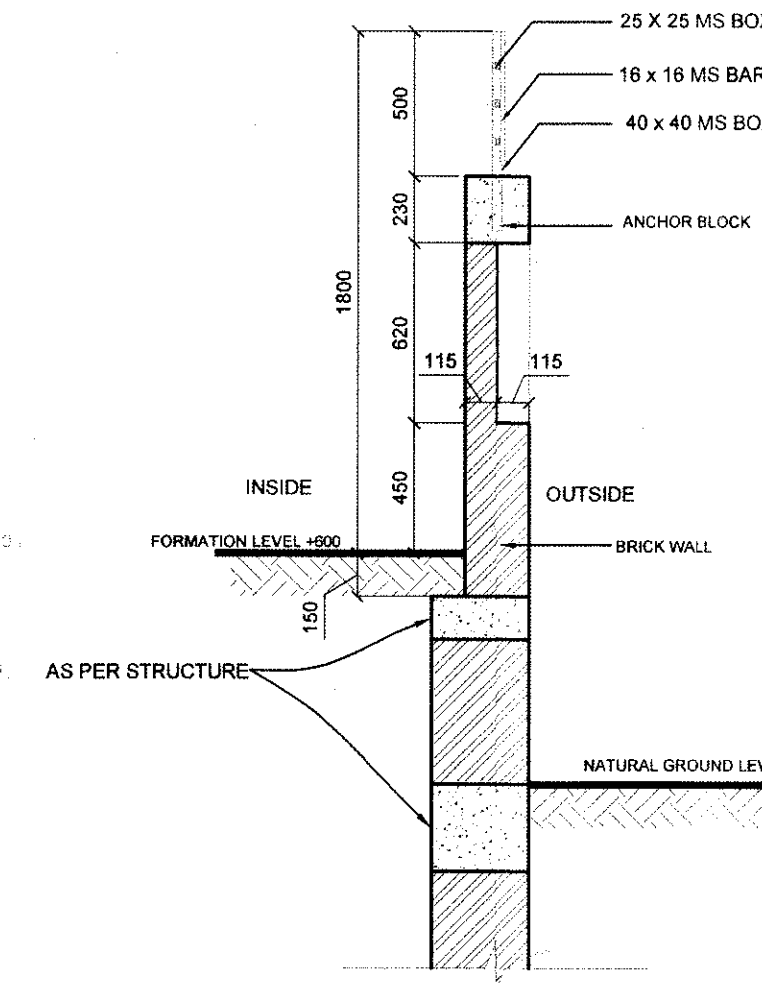

DETAIL - AA'  
SCALE - 1:25

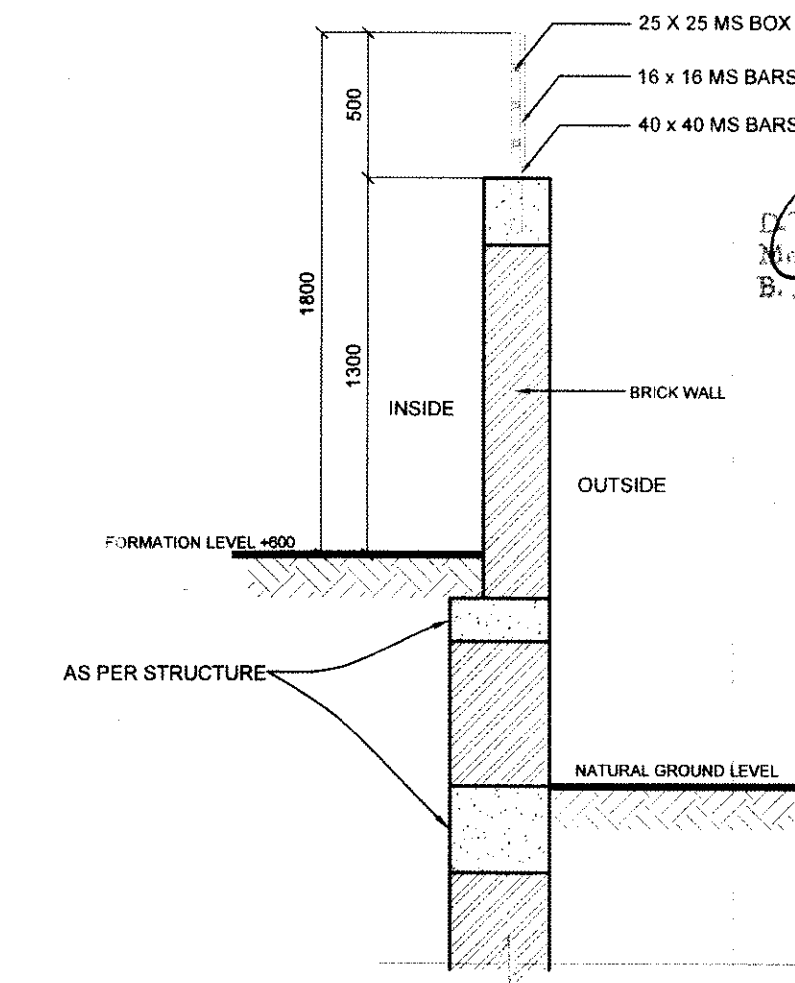

DETAIL - BB'  
SCALE - 1:25

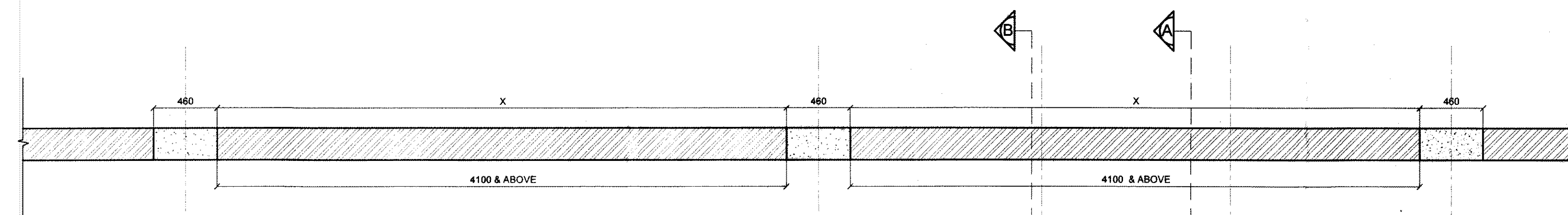

DETAIL - 3 (FROM POINT A TO C)  
SCALE - 1:25

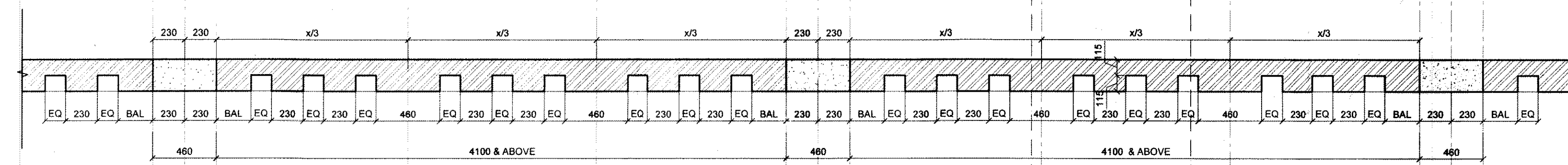

DETAIL - 2 (FROM POINT A TO C)  
SCALE - 1:25

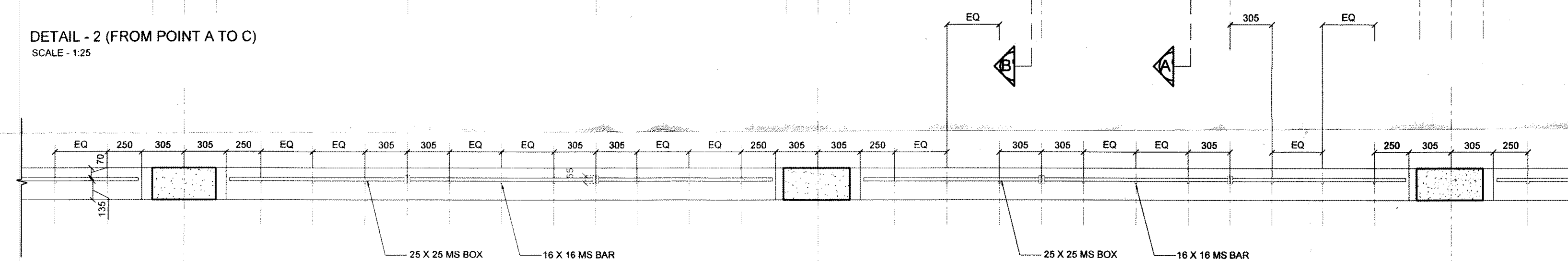

DETAIL - 1 (FROM POINT A TO C)  
SCALE - 1:25

Notes

Sanctioned

To be read in conjunction with memo No. 9636 Dtd. 11/11/12

Architect's Signature: *Baljeet Kumar*  
**BALJEET KUMAR, Architect**  
 Council of Architecture  
 Registration No. CA2008/42228

Client's Signature: *M/S Mahagori Estates Pvt. Ltd.*

Client: **M/S MAHAGORI ESTATES PVT. LTD.**

Architects: **Arco Associates Pvt. Ltd.**  
 E. 108, Sector 14, Gurgaon, Haryana  
 Ph: 01294-224242

Project: PROPOSED Building Plan of Group Housing Scheme on land measuring 11.25 ACRES (Licence No. 114 of 2011 dated 13/12/2011) in S-14, R-152, Faridkot Alameda Urban Complex, Gurgaon, Haryana. (Proposed by MAHAGORI ESTATES PVT. LTD.)

Sheet: **WALL ELEVATIONS & SECTIONS BOUNDARY WALL**

Scale	1:25	Sheet No.	A-05
Date	11/11/12	Project	Arco Associates Pvt. Ltd.