

**ALREADY APPROVAL GRANTED THROW
LETTER NO :- LC-1108B-PA(SN)/2017/3716
DATED :- 28/02/2017**

COMBINED DETAILS FOR POCKET-A & B

| POCKET | TOWER | TYPE | NO. OF UNITS | AREA (SQ. M) | NO. OF FLOORS | NO. OF STAIRS | NO. OF LIFTS | NO. OF ELEVATORS | NO. OF ESCAPE ROUTES | NO. OF FIRE ALARMS | NO. OF FIRE EXTINGUISHERS | NO. OF FIRE HOSES | NO. OF FIRE ALARMS | NO. OF FIRE EXTINGUISHERS | NO. OF FIRE HOSES |
|----------|---------|--------|--------------|--------------|---------------|---------------|--------------|------------------|----------------------|--------------------|---------------------------|-------------------|--------------------|---------------------------|-------------------|
| POCKET-A | TOWER-1 | TYPE-A | 100 | 10000 | 10 | 10 | 10 | 10 | 10 | 10 | 10 | 10 | 10 | 10 | 10 |
| | TOWER-2 | TYPE-B | 100 | 10000 | 10 | 10 | 10 | 10 | 10 | 10 | 10 | 10 | 10 | 10 | 10 |
| | TOWER-3 | TYPE-C | 100 | 10000 | 10 | 10 | 10 | 10 | 10 | 10 | 10 | 10 | 10 | 10 | 10 |
| | TOWER-4 | TYPE-D | 100 | 10000 | 10 | 10 | 10 | 10 | 10 | 10 | 10 | 10 | 10 | 10 | 10 |
| POCKET-B | TOWER-5 | TYPE-E | 100 | 10000 | 10 | 10 | 10 | 10 | 10 | 10 | 10 | 10 | 10 | 10 | 10 |
| | TOWER-6 | TYPE-F | 100 | 10000 | 10 | 10 | 10 | 10 | 10 | 10 | 10 | 10 | 10 | 10 | 10 |
| | TOWER-7 | TYPE-G | 100 | 10000 | 10 | 10 | 10 | 10 | 10 | 10 | 10 | 10 | 10 | 10 | 10 |
| | TOWER-8 | TYPE-H | 100 | 10000 | 10 | 10 | 10 | 10 | 10 | 10 | 10 | 10 | 10 | 10 | 10 |

| POCKET | TOWER | TYPE | NO. OF UNITS | AREA (SQ. M) | NO. OF FLOORS | NO. OF STAIRS | NO. OF LIFTS | NO. OF ELEVATORS | NO. OF ESCAPE ROUTES | NO. OF FIRE ALARMS | NO. OF FIRE EXTINGUISHERS | NO. OF FIRE HOSES | NO. OF FIRE ALARMS | NO. OF FIRE EXTINGUISHERS | NO. OF FIRE HOSES |
|----------|---------|--------|--------------|--------------|---------------|---------------|--------------|------------------|----------------------|--------------------|---------------------------|-------------------|--------------------|---------------------------|-------------------|
| POCKET-A | TOWER-1 | TYPE-A | 100 | 10000 | 10 | 10 | 10 | 10 | 10 | 10 | 10 | 10 | 10 | 10 | 10 |
| | TOWER-2 | TYPE-B | 100 | 10000 | 10 | 10 | 10 | 10 | 10 | 10 | 10 | 10 | 10 | 10 | 10 |
| | TOWER-3 | TYPE-C | 100 | 10000 | 10 | 10 | 10 | 10 | 10 | 10 | 10 | 10 | 10 | 10 | 10 |
| | TOWER-4 | TYPE-D | 100 | 10000 | 10 | 10 | 10 | 10 | 10 | 10 | 10 | 10 | 10 | 10 | 10 |
| POCKET-B | TOWER-5 | TYPE-E | 100 | 10000 | 10 | 10 | 10 | 10 | 10 | 10 | 10 | 10 | 10 | 10 | 10 |
| | TOWER-6 | TYPE-F | 100 | 10000 | 10 | 10 | 10 | 10 | 10 | 10 | 10 | 10 | 10 | 10 | 10 |
| | TOWER-7 | TYPE-G | 100 | 10000 | 10 | 10 | 10 | 10 | 10 | 10 | 10 | 10 | 10 | 10 | 10 |
| | TOWER-8 | TYPE-H | 100 | 10000 | 10 | 10 | 10 | 10 | 10 | 10 | 10 | 10 | 10 | 10 | 10 |

NOTES

- ALL DIMENSIONS ARE IN MM.
- ALL ELECTRICAL INSTALLATIONS SHALL BE AS PER PROVISIONS OF IEC & IS STANDARDS.
- FIRE FIGHTING PROVISIONS OF IEC & IS STANDARDS SHALL BE AS PER CENTRAL PROVISIONS OF IEC & IS STANDARDS.
- BOUNDARY WALL AND GATE AS PER STANDARDS ARE 600/900/1600 MM THK BRICKWORK WALL.
- RAIN WATER HARVESTING SYSTEM SHALL BE PROVIDED AS PER CENTRAL PROVISIONS OF IEC & IS STANDARDS.
- ALL WINDOWS & VENTILATORS ARE OPENABLE.
- ALL MECHANICALLY VENTILATED & AIR-CONDITIONED AREAS SHALL BE PROVIDED WITH 24HR POWER BACKUP.

| POCKET | TOWER | TYPE | NO. OF UNITS | AREA (SQ. M) | NO. OF FLOORS | NO. OF STAIRS | NO. OF LIFTS | NO. OF ELEVATORS | NO. OF ESCAPE ROUTES | NO. OF FIRE ALARMS | NO. OF FIRE EXTINGUISHERS | NO. OF FIRE HOSES | NO. OF FIRE ALARMS | NO. OF FIRE EXTINGUISHERS | NO. OF FIRE HOSES |
|----------|---------|--------|--------------|--------------|---------------|---------------|--------------|------------------|----------------------|--------------------|---------------------------|-------------------|--------------------|---------------------------|-------------------|
| POCKET-A | TOWER-1 | TYPE-A | 100 | 10000 | 10 | 10 | 10 | 10 | 10 | 10 | 10 | 10 | 10 | 10 | 10 |
| | TOWER-2 | TYPE-B | 100 | 10000 | 10 | 10 | 10 | 10 | 10 | 10 | 10 | 10 | 10 | 10 | 10 |
| | TOWER-3 | TYPE-C | 100 | 10000 | 10 | 10 | 10 | 10 | 10 | 10 | 10 | 10 | 10 | 10 | 10 |
| | TOWER-4 | TYPE-D | 100 | 10000 | 10 | 10 | 10 | 10 | 10 | 10 | 10 | 10 | 10 | 10 | 10 |
| POCKET-B | TOWER-5 | TYPE-E | 100 | 10000 | 10 | 10 | 10 | 10 | 10 | 10 | 10 | 10 | 10 | 10 | 10 |
| | TOWER-6 | TYPE-F | 100 | 10000 | 10 | 10 | 10 | 10 | 10 | 10 | 10 | 10 | 10 | 10 | 10 |
| | TOWER-7 | TYPE-G | 100 | 10000 | 10 | 10 | 10 | 10 | 10 | 10 | 10 | 10 | 10 | 10 | 10 |
| | TOWER-8 | TYPE-H | 100 | 10000 | 10 | 10 | 10 | 10 | 10 | 10 | 10 | 10 | 10 | 10 | 10 |

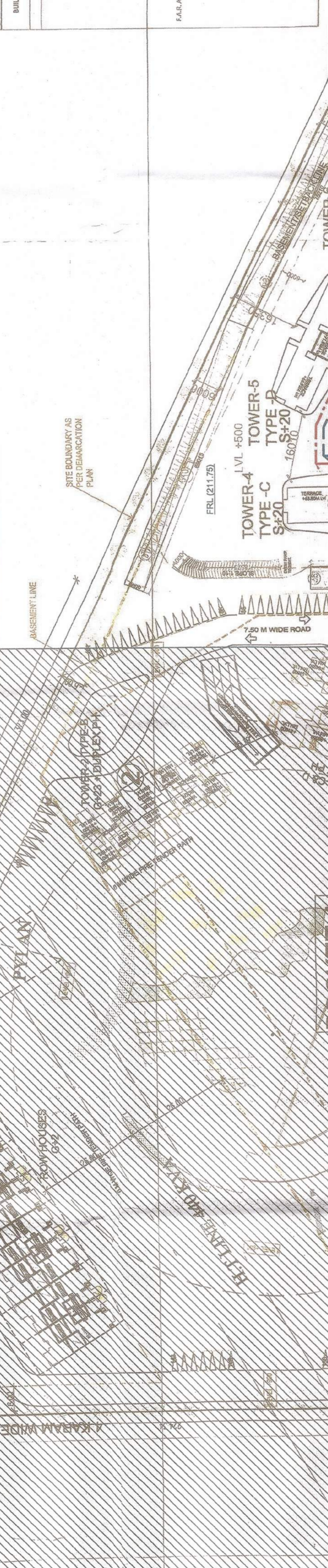

| POCKET | TOWER | TYPE | NO. OF UNITS | AREA (SQ. M) | NO. OF FLOORS | NO. OF STAIRS | NO. OF LIFTS | NO. OF ELEVATORS | NO. OF ESCAPE ROUTES | NO. OF FIRE ALARMS | NO. OF FIRE EXTINGUISHERS | NO. OF FIRE HOSES | NO. OF FIRE ALARMS | NO. OF FIRE EXTINGUISHERS | NO. OF FIRE HOSES |
|----------|---------|--------|--------------|--------------|---------------|---------------|--------------|------------------|----------------------|--------------------|---------------------------|-------------------|--------------------|---------------------------|-------------------|
| POCKET-A | TOWER-1 | TYPE-A | 100 | 10000 | 10 | 10 | 10 | 10 | 10 | 10 | 10 | 10 | 10 | 10 | 10 |
| | TOWER-2 | TYPE-B | 100 | 10000 | 10 | 10 | 10 | 10 | 10 | 10 | 10 | 10 | 10 | 10 | 10 |
| | TOWER-3 | TYPE-C | 100 | 10000 | 10 | 10 | 10 | 10 | 10 | 10 | 10 | 10 | 10 | 10 | 10 |
| | TOWER-4 | TYPE-D | 100 | 10000 | 10 | 10 | 10 | 10 | 10 | 10 | 10 | 10 | 10 | 10 | 10 |
| POCKET-B | TOWER-5 | TYPE-E | 100 | 10000 | 10 | 10 | 10 | 10 | 10 | 10 | 10 | 10 | 10 | 10 | 10 |
| | TOWER-6 | TYPE-F | 100 | 10000 | 10 | 10 | 10 | 10 | 10 | 10 | 10 | 10 | 10 | 10 | 10 |
| | TOWER-7 | TYPE-G | 100 | 10000 | 10 | 10 | 10 | 10 | 10 | 10 | 10 | 10 | 10 | 10 | 10 |
| | TOWER-8 | TYPE-H | 100 | 10000 | 10 | 10 | 10 | 10 | 10 | 10 | 10 | 10 | 10 | 10 | 10 |



| POCKET | TOWER | TYPE | NO. OF UNITS | AREA (SQ. M) | NO. OF FLOORS | NO. OF STAIRS | NO. OF LIFTS | NO. OF ELEVATORS | NO. OF ESCAPE ROUTES | NO. OF FIRE ALARMS | NO. OF FIRE EXTINGUISHERS | NO. OF FIRE HOSES | NO. OF FIRE ALARMS | NO. OF FIRE EXTINGUISHERS | NO. OF FIRE HOSES |
|----------|---------|--------|--------------|--------------|---------------|---------------|--------------|------------------|----------------------|--------------------|---------------------------|-------------------|--------------------|---------------------------|-------------------|
| POCKET-A | TOWER-1 | TYPE-A | 100 | 10000 | 10 | 10 | 10 | 10 | 10 | 10 | 10 | 10 | 10 | 10 | 10 |
| | TOWER-2 | TYPE-B | 100 | 10000 | 10 | 10 | 10 | 10 | 10 | 10 | 10 | 10 | 10 | 10 | 10 |
| | TOWER-3 | TYPE-C | 100 | 10000 | 10 | 10 | 10 | 10 | 10 | 10 | 10 | 10 | 10 | 10 | 10 |
| | TOWER-4 | TYPE-D | 100 | 10000 | 10 | 10 | 10 | 10 | 10 | 10 | 10 | 10 | 10 | 10 | 10 |
| POCKET-B | TOWER-5 | TYPE-E | 100 | 10000 | 10 | 10 | 10 | 10 | 10 | 10 | 10 | 10 | 10 | 10 | 10 |
| | TOWER-6 | TYPE-F | 100 | 10000 | 10 | 10 | 10 | 10 | 10 | 10 | 10 | 10 | 10 | 10 | 10 |
| | TOWER-7 | TYPE-G | 100 | 10000 | 10 | 10 | 10 | 10 | 10 | 10 | 10 | 10 | 10 | 10 | 10 |
| | TOWER-8 | TYPE-H | 100 | 10000 | 10 | 10 | 10 | 10 | 10 | 10 | 10 | 10 | 10 | 10 | 10 |

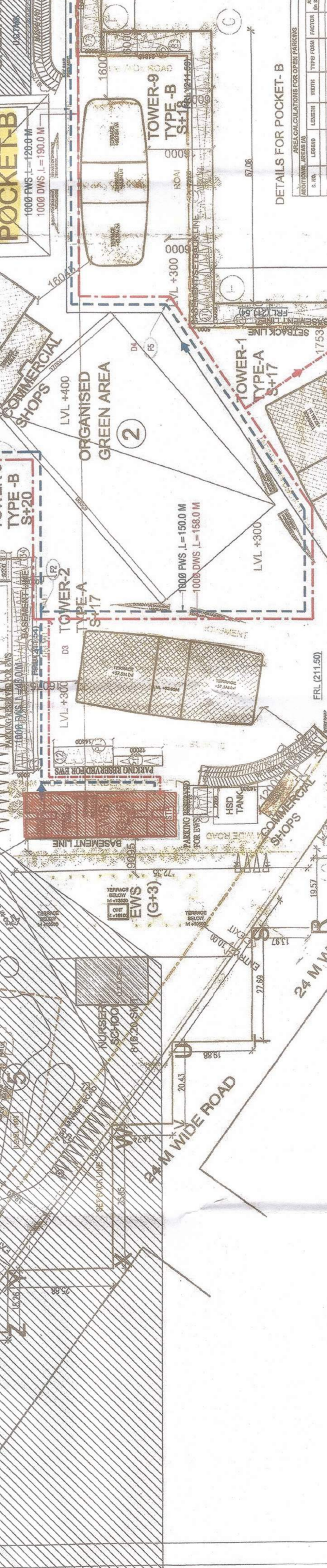

| POCKET | TOWER | TYPE | NO. OF UNITS | AREA (SQ. M) | NO. OF FLOORS | NO. OF STAIRS | NO. OF LIFTS | NO. OF ELEVATORS | NO. OF ESCAPE ROUTES | NO. OF FIRE ALARMS | NO. OF FIRE EXTINGUISHERS | NO. OF FIRE HOSES | NO. OF FIRE ALARMS | NO. OF FIRE EXTINGUISHERS | NO. OF FIRE HOSES |
|----------|---------|--------|--------------|--------------|---------------|---------------|--------------|------------------|----------------------|--------------------|---------------------------|-------------------|--------------------|---------------------------|-------------------|
| POCKET-A | TOWER-1 | TYPE-A | 100 | 10000 | 10 | 10 | 10 | 10 | 10 | 10 | 10 | 10 | 10 | 10 | 10 |
| | TOWER-2 | TYPE-B | 100 | 10000 | 10 | 10 | 10 | 10 | 10 | 10 | 10 | 10 | 10 | 10 | 10 |
| | TOWER-3 | TYPE-C | 100 | 10000 | 10 | 10 | 10 | 10 | 10 | 10 | 10 | 10 | 10 | 10 | 10 |
| | TOWER-4 | TYPE-D | 100 | 10000 | 10 | 10 | 10 | 10 | 10 | 10 | 10 | 10 | 10 | 10 | 10 |
| POCKET-B | TOWER-5 | TYPE-E | 100 | 10000 | 10 | 10 | 10 | 10 | 10 | 10 | 10 | 10 | 10 | 10 | 10 |
| | TOWER-6 | TYPE-F | 100 | 10000 | 10 | 10 | 10 | 10 | 10 | 10 | 10 | 10 | 10 | 10 | 10 |
| | TOWER-7 | TYPE-G | 100 | 10000 | 10 | 10 | 10 | 10 | 10 | 10 | 10 | 10 | 10 | 10 | 10 |
| | TOWER-8 | TYPE-H | 100 | 10000 | 10 | 10 | 10 | 10 | 10 | 10 | 10 | 10 | 10 | 10 | 10 |

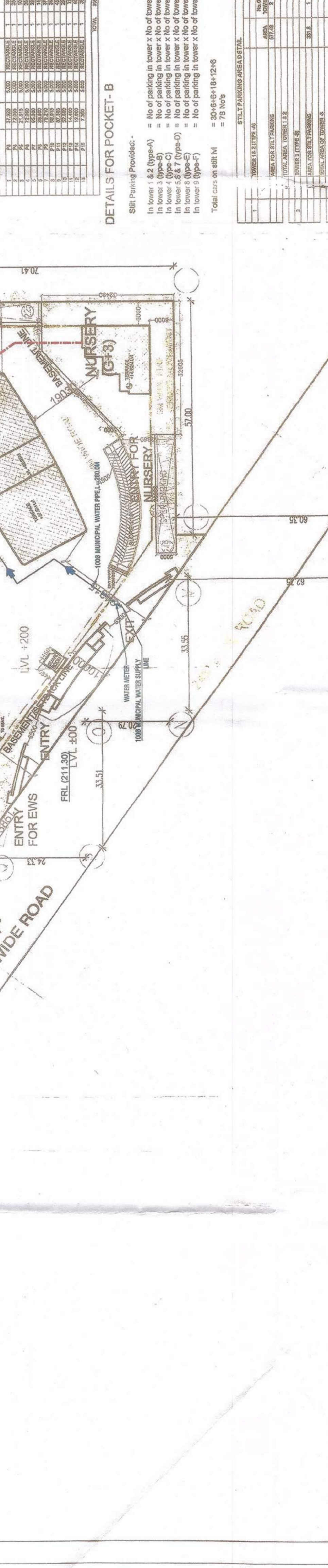

| POCKET | TOWER | TYPE | NO. OF UNITS | AREA (SQ. M) | NO. OF FLOORS | NO. OF STAIRS | NO. OF LIFTS | NO. OF ELEVATORS | NO. OF ESCAPE ROUTES | NO. OF FIRE ALARMS | NO. OF FIRE EXTINGUISHERS | NO. OF FIRE HOSES | NO. OF FIRE ALARMS | NO. OF FIRE EXTINGUISHERS | NO. OF FIRE HOSES |
|----------|---------|--------|--------------|--------------|---------------|---------------|--------------|------------------|----------------------|--------------------|---------------------------|-------------------|--------------------|---------------------------|-------------------|
| POCKET-A | TOWER-1 | TYPE-A | 100 | 10000 | 10 | 10 | 10 | 10 | 10 | 10 | 10 | 10 | 10 | 10 | 10 |
| | TOWER-2 | TYPE-B | 100 | 10000 | 10 | 10 | 10 | 10 | 10 | 10 | 10 | 10 | 10 | 10 | 10 |
| | TOWER-3 | TYPE-C | 100 | 10000 | 10 | 10 | 10 | 10 | 10 | 10 | 10 | 10 | 10 | 10 | 10 |
| | TOWER-4 | TYPE-D | 100 | 10000 | 10 | 10 | 10 | 10 | 10 | 10 | 10 | 10 | 10 | 10 | 10 |
| POCKET-B | TOWER-5 | TYPE-E | 100 | 10000 | 10 | 10 | 10 | 10 | 10 | 10 | 10 | 10 | 10 | 10 | 10 |
| | TOWER-6 | TYPE-F | 100 | 10000 | 10 | 10 | 10 | 10 | 10 | 10 | 10 | 10 | 10 | 10 | 10 |
| | TOWER-7 | TYPE-G | 100 | 10000 | 10 | 10 | 10 | 10 | 10 | 10 | 10 | 10 | 10 | 10 | 10 |
| | TOWER-8 | TYPE-H | 100 | 10000 | 10 | 10 | 10 | 10 | 10 | 10 | 10 | 10 | 10 | 10 | 10 |

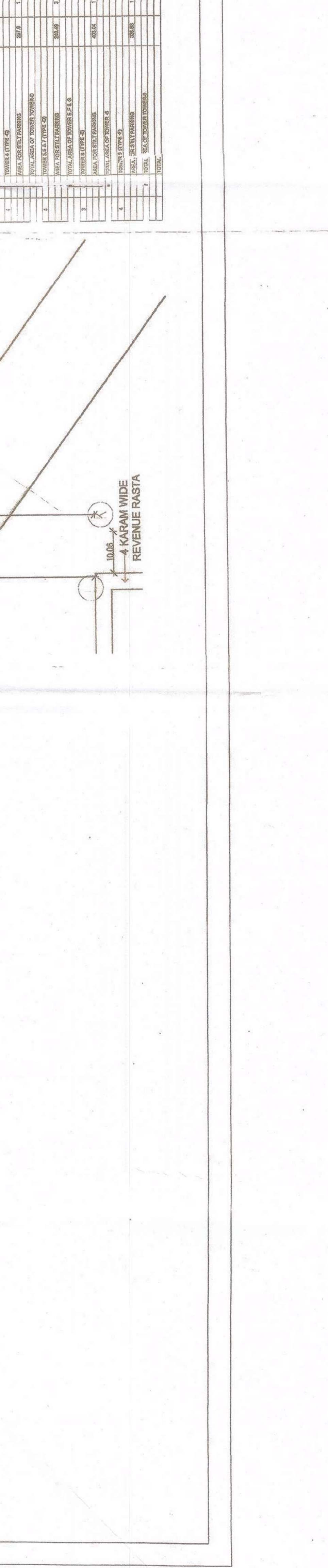

WATER SUPPLY
K-16
Towns & Country Planning
Hyderabad, Chandrababu Naidu
Director
Dr. Jayaraman
Director
Dr. Jayaraman
Director
Dr. Jayaraman

Executive Engineer
HUDA Division No V
Ganganagar
Addl. Chief Engineer
HUDA Ganganagar

Project - (B)

Checked subject to compliance
with the provisions of the
Town and Country Planning
Act, 1973 and the
Town and Country Planning
Rules, 1973.

REVISIONS

| NO. | DESCRIPTION | DATE |
|-----|--------------------|------------|
| 1 | ISSUED FOR TENDERS | 28/02/2017 |

REVISIONS

| NO. | DESCRIPTION | DATE |
|-----|--------------------|------------|
| 1 | ISSUED FOR TENDERS | 28/02/2017 |

REVISIONS

| NO. | DESCRIPTION | DATE |
|-----|--------------------|------------|
| 1 | ISSUED FOR TENDERS | 28/02/2017 |

REVISIONS

| NO. | DESCRIPTION | DATE |
|-----|--------------------|------------|
| 1 | ISSUED FOR TENDERS | 28/02/2017 |

REVISIONS

| NO. | DESCRIPTION | DATE |
|-----|--------------------|------------|
| 1 | ISSUED FOR TENDERS | 28/02/2017 |

REVISIONS

| NO. | DESCRIPTION | DATE |
|-----|--------------------|------------|
| 1 | ISSUED FOR TENDERS | 28/02/2017 |

REVISIONS

| NO. | DESCRIPTION | DATE |
|-----|--------------------|------------|
| 1 | ISSUED FOR TENDERS | 28/02/2017 |

REVISIONS

| NO. | DESCRIPTION | DATE |
|-----|--------------------|------------|
| 1 | ISSUED FOR TENDERS | 28/02/2017 |

REVISIONS

| NO. | DESCRIPTION | DATE |
|-----|--------------------|------------|
| 1 | ISSUED FOR TENDERS | 28/02/2017 |

REVISIONS

| NO. | DESCRIPTION | DATE |
|-----|--------------------|------------|
| 1 | ISSUED FOR TENDERS | 28/02/2017 |

REVISIONS

| NO. | DESCRIPTION | DATE |
|-----|--------------------|------------|
| 1 | ISSUED FOR TENDERS | 28/02/2017 |

REVISIONS

| NO. | DESCRIPTION | DATE |
|-----|--------------------|------------|
| 1 | ISSUED FOR TENDERS | 28/02/2017 |

REVISIONS

| NO. | DESCRIPTION | DATE |
|-----|--------------------|------------|
| 1 | ISSUED FOR TENDERS | 28/02/2017 |

REVISIONS

| NO. | DESCRIPTION | DATE |
|-----|--------------------|------------|
| 1 | ISSUED FOR TENDERS | 28/02/2017 |

REVISIONS

| NO. | DESCRIPTION | DATE |
|-----|--------------------|------------|
| 1 | ISSUED FOR TENDERS | 28/02/2017 |

REVISIONS

| NO. | DESCRIPTION</ |
|-----|---------------|
|-----|---------------|