



AREA STATEMENT

ACRES	SQM.		
TOTAL PLOT AREA	36,822.512		
AREA FOR COMMERCIAL COMPONENT	0.3075		
AREA FOR RESIDENTIAL COMPONENT	0.3019		
TOTAL PLOT AREA	1,463.300		
BALANCE PLOT AREA FOR HOUSING	8,678.6		
PERMISSIBLE REQUIRED	APPROVED SUBMISSION	ACHIEVED	REFERENCE SHEET NO.
AREA FOR COMMERCIAL	1,463.300 SQM.		
F.A.R. FOR COMMERCIAL	1.75	1.6916	17.10
COVERED AREA FOR COMMERCIAL	2,560.775	2,473.350	212.188
AREA FOR RESIDENTIAL	35,119.212 SQM.		
F.A.R. FOR RESIDENTIAL	2.24955		2.1820
COVERED AREA FOR RESIDENTIAL	79,002.378 SQM.	78,656.503 SQM.	1.24
STILT AREA	7,308.789 SQM.	7,186.660 SQM.	1.24
GROUND COVERAGE	18,291.256 SQM.	9,833.829 SQM.	1.24
% OF PLOT AREA	50.9 %	26.38 %	1.24
NO. OF DWELLING UNITS	1,489	1,489	1.24
OCCUPANCY PER DWELLING UNIT	5	5	5
TOTAL POPULATION	7,445	7,445	5
NO. OF CAR PARKING SPACES	852	852	5
% OF PLOT AREA	5,487.277 SQM.	5,465.870 SQM.	23.38 %
CAR PARKING	852 E.C.S. PER DWELLING UNIT		
TOTAL CAR PARKING SPACE	1,489 Nos.	1,489	1.659
TOTAL AREA FOR PARKING	749 E.C.S.	834 E.C.S.	2.74
COMMUNITY BUILDINGS	22,046.671 SQM.	22,046.671 SQM.	2.74
1% COMMUNITY CENTER	165.81 SQM.	165.81 SQM.	19.24
TOTAL F.A.R. ACHIEVED	165.81 SQM.	165.81 SQM.	212.420
			20.24

SUMMARY STATEMENT OF F. A. R. AREA FOR HOUSING

S. No.	BLOCK	NO. OF FLOORS	NO. OF DWELLING UNITS	NO. OF CAR PARKING SPACES	NO. OF COMMUNITY BUILDINGS	TOTAL AREA OF ALL BLOCKS	NO. OF DWELLING UNITS	NO. OF CAR PARKING SPACES	NO. OF COMMUNITY BUILDINGS	REFERENCE SHEET NO.
1	BLOCK-1	15	413,123	413,123	4,102,794	62,411,970	50M.	4,204		4.24
2	BLOCK-2	10	309,067	309,067	3,154,899	4,164,889	50M.	7,24		7.24
3	BLOCK-3	10	309,067	309,067	3,154,899	4,022,234	50M.	10,24		10.24
4	BLOCK-4	10	417,429	417,429	4,202,854	4,202,854	50M.	13,24		13.24
5	BLOCK-5	10	170,310	170,310	1,724,846	1,724,846	50M.	16,24		16.24
TOTAL										
76,509,853 SQM.										
AND FOR 13 Nos. END WALLS FOR BLOCKS (14 IN 10th FLOOR) MENTIONED AS 'A1' - A13 IN SHEET NO. 1										
6		11	8,848	8,848	9,274	9,274	50M.	1.24		1.24
7		10	8,848	8,848	9,274	9,274	50M.	1.24		1.24
8		10	8,848	8,848	9,274	9,274	50M.	1.24		1.24
TOTAL F.A.R. ACHIEVED										
76,656,893 SQM.										
OR										
21,81,200 %										

SUMMARY STATEMENT OF STILT AREA FOR PARKING FOR HOUSING

S. No.	BLOCK	NO. OF STILT AREA OF ALL BLOCKS	NO. OF DWELLING UNITS	NO. OF CAR PARKING SPACES	NO. OF COMMUNITY BUILDINGS	TOTAL AREA OF ALL BLOCKS	NO. OF DWELLING UNITS	NO. OF CAR PARKING SPACES	NO. OF COMMUNITY BUILDINGS	REFERENCE SHEET NO.
1	BLOCK-1	15	413,123	413,123	4,102,794	62,411,970	50M.	4,204		4.24
2	BLOCK-2	10	309,067	309,067	3,154,899	4,164,889	50M.	7,24		7.24
3	BLOCK-3	10	309,067	309,067	3,154,899	4,022,234	50M.	10,24		10.24
4	BLOCK-4	10	417,429	417,429	4,202,854	4,202,854	50M.	13,24		13.24
5	BLOCK-5	10	170,310	170,310	1,724,846	1,724,846	50M.	16,24		16.24
TOTAL										
7,180,660 SQM.										

SUMMARY OF NO. OF DWELLING UNITS

S. No.	TYPE OF UNITS	A-1	A-2	A-3	A-4	A-5	A-6	A-7	A-8A	ASA	TOTAL
1	No. of Units	890	390	390	20	10	10	10	10	10	1460

DETAIL OF DWELLING UNITS

FLOOR	BLOCK-1	BLOCK-2	BLOCK-3	BLOCK-4	BLOCK-5
1st FLOOR	15	10	10	10	10
2nd FLOOR	15	10	10	10	10
3rd FLOOR	15	10	10	10	10
4th FLOOR	15	10	10	10	10
5th FLOOR	15	10	10	10	10
6th FLOOR	15	10	10	10	10
7th FLOOR	15	10	10	10	10
8th FLOOR	15	10	10	10	10
9th FLOOR	15	10	10	10	10
10th FLOOR	15	10	10	10	10
TOTAL	150	100	100	100	100

SUMMARY STATEMENT OF NON-F. A. R. AREA

S. No.	BLOCK	NO. OF FLOORS	NO. OF DWELLING UNITS	NO. OF CAR PARKING SPACES	NO. OF COMMUNITY BUILDINGS	TOTAL AREA OF ALL BLOCKS	NO. OF DWELLING UNITS	NO. OF CAR PARKING SPACES	NO. OF COMMUNITY BUILDINGS	REFERENCE SHEET NO.
1	BLOCK-1 (17th-18th)	10	15	15	15	15	15	15	15	15
2	BLOCK-1 (17th-18th)	10	15	15	15	15	15	15	15	15
3	BLOCK-1 (17th-18th)	10	15	15	15	15	15	15	15	15
4	BLOCK-1 (17th-18th)	10	15	15	15	15	15	15	15	15
5	BLOCK-1 (17th-18th)	10	15	15	15	15	15	15	15	15
6	BLOCK-1 (17th-18th)	10	15	15	15	15	15	15	15	15
7	BLOCK-1 (17th-18th)	10	15	15	15	15	15	15	15	15
8	BLOCK-1 (17th-18th)	10	15	15	15	15	15	15	15	15
9	BLOCK-1 (17th-18th)	10	15	15	15	15	15	15	15	15
10	BLOCK-1 (17th-18th)	10	15	15	15	15	15	15	15	15
11	BLOCK-1 (17th-18th)	10	15	15	15	15	15	15	15	15
12	BLOCK-1 (17th-18th)	10	15	15	15	15	15	15	15	15
13	BLOCK-1 (17th-18th)	10	15	15	15	15	15	15	15	15
14	BLOCK-1 (17th-18th)	10	15	15	15	15	15	15	15	15
15	BLOCK-1 (17th-18th)	10	15	15	15	15	15	15	15	15
16	BLOCK-1 (17th-18th)	10	15	15	15	15	15	15	15	15
17	BLOCK-1 (17th-18th)	10	15	15	15	15	15	15	15	15
18	BLOCK-1 (17th-18th)	10	15	15	15	15	15	15	15	15
19	BLOCK-1 (17th-18th)	10	15	15	15	15	15	15	15	15
TOTAL NON-F.A.R. AREA										
10,756,636 SQM.										

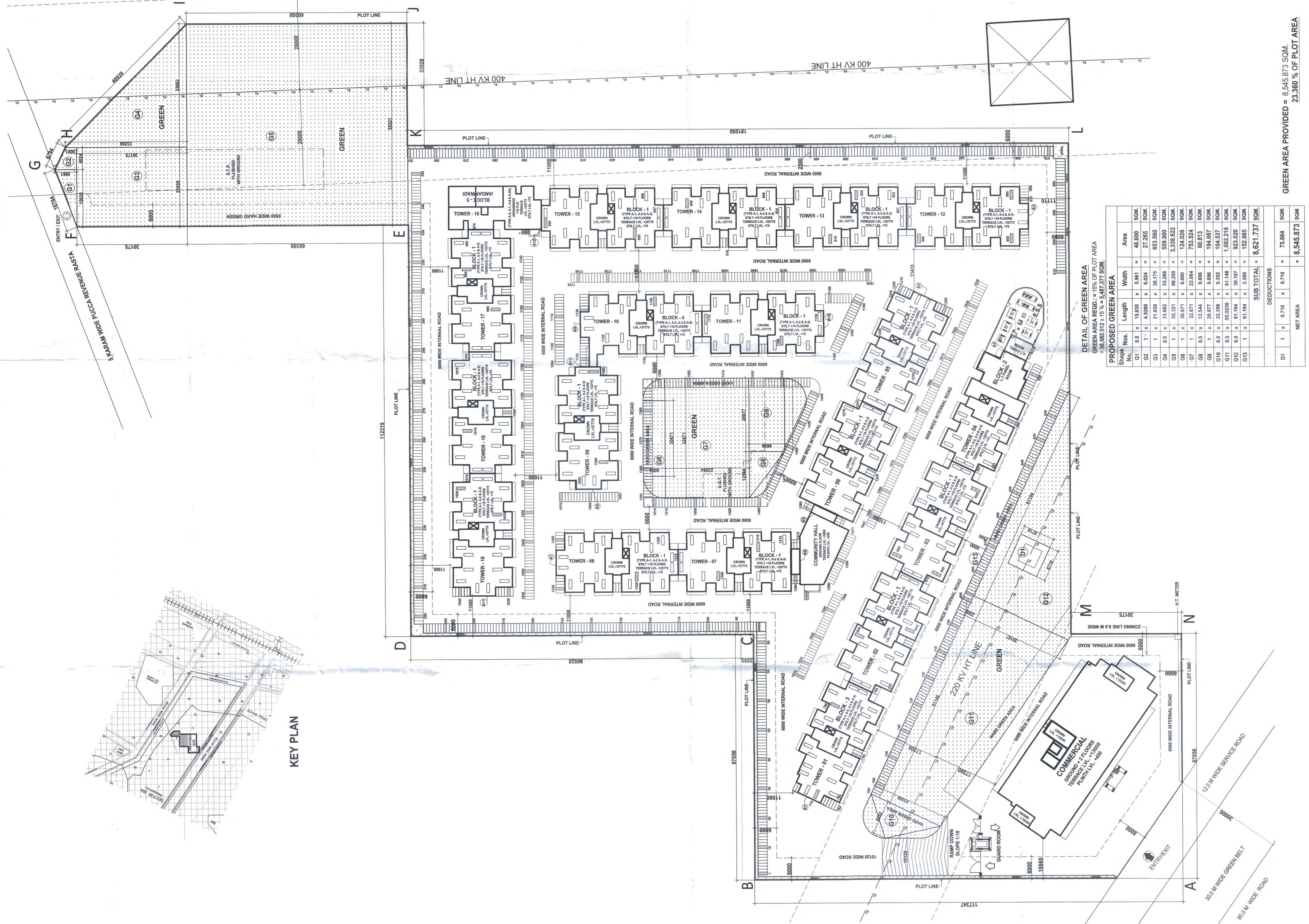

DETAIL OF GREEN AREA

Shape	No.	Length	Width	Area
G1	1	15.00	1.00	15.00
G2	1	15.00	1.00	15.00
G3	1	15.00	1.00	15.00
G4	1	15.00	1.00	15.00
G5	1	15.00	1.00	15.00
G6	1	15.00	1.00	15.00
G7	1	15.00	1.00	15.00
G8	1	15.00	1.00	15.00
G9	1	15.00	1.00	15.00
G10	1	15.00	1.00	15.00
G11	1	15.00	1.00	15.00
G12	1	15.00	1.00	15.00
G13	1	15.00	1.00	15.00
SUB TOTAL				
8,621.737 SQM.				
DEDUCTIONS				
D1	1	17.76	1.776	31.54
NET AREA				
8,590.193 SQM.				

GREEN AREA PROVIDED = 8,590.193 SQM.
23.36% OF PLOT AREA

OWNER
FOR INFRASTRUCTURE PVT. LTD.

ARCHITECT
VIRENDER ASSOCIATES

DATE: OCT. 2019
DRG. NO. 1/24

DRAWING TITLE:
LAYOUT PLAN

PROJECT:
AFFORDABLE GROUP HOUSING COLONY
FOR 4.8875 ACRES MEASURING TOTAL AREA 9.8875 ACRES
AND LICENSE NO. 19 OF 2014 DATED 06.06.2014 FOR 5.0 ACRES
BEING DEVELOPED BY
M/S A.V.L. INFRASTRUCTURE (P) LTD.
LAND OWNERS: L.C. 3033