

PLOT AREA = 19982.174 SQ. MT.
= (4.913 ACRES)
ALL DIMENSIONS ARE IN METERS

AUTHORITY SIGNATURE

1. S.P. & ARCHITECTURAL APPROVED BUILDING PLAN
2. APPROVED BY THE COMPETENT AUTHORITY
3. APPROVED BY THE COMPETENT AUTHORITY
4. APPROVED BY THE COMPETENT AUTHORITY
5. APPROVED BY THE COMPETENT AUTHORITY
6. APPROVED BY THE COMPETENT AUTHORITY
7. APPROVED BY THE COMPETENT AUTHORITY
8. APPROVED BY THE COMPETENT AUTHORITY
9. APPROVED BY THE COMPETENT AUTHORITY
10. APPROVED BY THE COMPETENT AUTHORITY
11. APPROVED BY THE COMPETENT AUTHORITY
12. APPROVED BY THE COMPETENT AUTHORITY
13. APPROVED BY THE COMPETENT AUTHORITY
14. APPROVED BY THE COMPETENT AUTHORITY
15. APPROVED BY THE COMPETENT AUTHORITY
16. APPROVED BY THE COMPETENT AUTHORITY
17. APPROVED BY THE COMPETENT AUTHORITY
18. APPROVED BY THE COMPETENT AUTHORITY
19. APPROVED BY THE COMPETENT AUTHORITY
20. APPROVED BY THE COMPETENT AUTHORITY
21. APPROVED BY THE COMPETENT AUTHORITY
22. APPROVED BY THE COMPETENT AUTHORITY
23. APPROVED BY THE COMPETENT AUTHORITY
24. APPROVED BY THE COMPETENT AUTHORITY
25. APPROVED BY THE COMPETENT AUTHORITY
26. APPROVED BY THE COMPETENT AUTHORITY
27. APPROVED BY THE COMPETENT AUTHORITY
28. APPROVED BY THE COMPETENT AUTHORITY
29. APPROVED BY THE COMPETENT AUTHORITY
30. APPROVED BY THE COMPETENT AUTHORITY
31. APPROVED BY THE COMPETENT AUTHORITY
32. APPROVED BY THE COMPETENT AUTHORITY
33. APPROVED BY THE COMPETENT AUTHORITY
34. APPROVED BY THE COMPETENT AUTHORITY
35. APPROVED BY THE COMPETENT AUTHORITY
36. APPROVED BY THE COMPETENT AUTHORITY
37. APPROVED BY THE COMPETENT AUTHORITY
38. APPROVED BY THE COMPETENT AUTHORITY
39. APPROVED BY THE COMPETENT AUTHORITY
40. APPROVED BY THE COMPETENT AUTHORITY
41. APPROVED BY THE COMPETENT AUTHORITY
42. APPROVED BY THE COMPETENT AUTHORITY
43. APPROVED BY THE COMPETENT AUTHORITY
44. APPROVED BY THE COMPETENT AUTHORITY
45. APPROVED BY THE COMPETENT AUTHORITY
46. APPROVED BY THE COMPETENT AUTHORITY
47. APPROVED BY THE COMPETENT AUTHORITY
48. APPROVED BY THE COMPETENT AUTHORITY
49. APPROVED BY THE COMPETENT AUTHORITY
50. APPROVED BY THE COMPETENT AUTHORITY
51. APPROVED BY THE COMPETENT AUTHORITY
52. APPROVED BY THE COMPETENT AUTHORITY
53. APPROVED BY THE COMPETENT AUTHORITY
54. APPROVED BY THE COMPETENT AUTHORITY
55. APPROVED BY THE COMPETENT AUTHORITY
56. APPROVED BY THE COMPETENT AUTHORITY
57. APPROVED BY THE COMPETENT AUTHORITY
58. APPROVED BY THE COMPETENT AUTHORITY
59. APPROVED BY THE COMPETENT AUTHORITY
60. APPROVED BY THE COMPETENT AUTHORITY
61. APPROVED BY THE COMPETENT AUTHORITY
62. APPROVED BY THE COMPETENT AUTHORITY
63. APPROVED BY THE COMPETENT AUTHORITY
64. APPROVED BY THE COMPETENT AUTHORITY
65. APPROVED BY THE COMPETENT AUTHORITY
66. APPROVED BY THE COMPETENT AUTHORITY
67. APPROVED BY THE COMPETENT AUTHORITY
68. APPROVED BY THE COMPETENT AUTHORITY
69. APPROVED BY THE COMPETENT AUTHORITY
70. APPROVED BY THE COMPETENT AUTHORITY
71. APPROVED BY THE COMPETENT AUTHORITY
72. APPROVED BY THE COMPETENT AUTHORITY
73. APPROVED BY THE COMPETENT AUTHORITY
74. APPROVED BY THE COMPETENT AUTHORITY
75. APPROVED BY THE COMPETENT AUTHORITY
76. APPROVED BY THE COMPETENT AUTHORITY
77. APPROVED BY THE COMPETENT AUTHORITY
78. APPROVED BY THE COMPETENT AUTHORITY
79. APPROVED BY THE COMPETENT AUTHORITY
80. APPROVED BY THE COMPETENT AUTHORITY
81. APPROVED BY THE COMPETENT AUTHORITY
82. APPROVED BY THE COMPETENT AUTHORITY
83. APPROVED BY THE COMPETENT AUTHORITY
84. APPROVED BY THE COMPETENT AUTHORITY
85. APPROVED BY THE COMPETENT AUTHORITY
86. APPROVED BY THE COMPETENT AUTHORITY
87. APPROVED BY THE COMPETENT AUTHORITY
88. APPROVED BY THE COMPETENT AUTHORITY
89. APPROVED BY THE COMPETENT AUTHORITY
90. APPROVED BY THE COMPETENT AUTHORITY
91. APPROVED BY THE COMPETENT AUTHORITY
92. APPROVED BY THE COMPETENT AUTHORITY
93. APPROVED BY THE COMPETENT AUTHORITY
94. APPROVED BY THE COMPETENT AUTHORITY
95. APPROVED BY THE COMPETENT AUTHORITY
96. APPROVED BY THE COMPETENT AUTHORITY
97. APPROVED BY THE COMPETENT AUTHORITY
98. APPROVED BY THE COMPETENT AUTHORITY
99. APPROVED BY THE COMPETENT AUTHORITY
100. APPROVED BY THE COMPETENT AUTHORITY

NOTES
1. ALL DIMENSIONS ARE IN MILLIMETER UNLESS STATED OTHERWISE.
2. THE CONSTRUCTION OF THE BUILDINGS SHALL BE IN ACCORDANCE WITH THE HARYANA BUILDING CODE 2017 IS SALENT THE NATIONAL BUILDING CODE OF INDIA, 2016 SHALL BE APPLICABLE.
3. THE GATE AND BOUNDARY WALL SHALL BE CONSTRUCTED AS SCODE.
4. THE CONSTRUCTION OF BASEMENT BE EXECUTED AS SCODE.
5. PROPER FIRE SAFETY MEASURES PROVISIONS AS PER CODES SHALL BE PROVIDED.
6. INSTALLATION OF SOLAR POWER PLANT AS SCODE.
7. PROVISION OF COVERED SPACES - COVERED OPEN IN THE BASEMENT AS SCODE.
8. PROVISION OF SEWAGE TREATMENT PLANT AS SCODE.

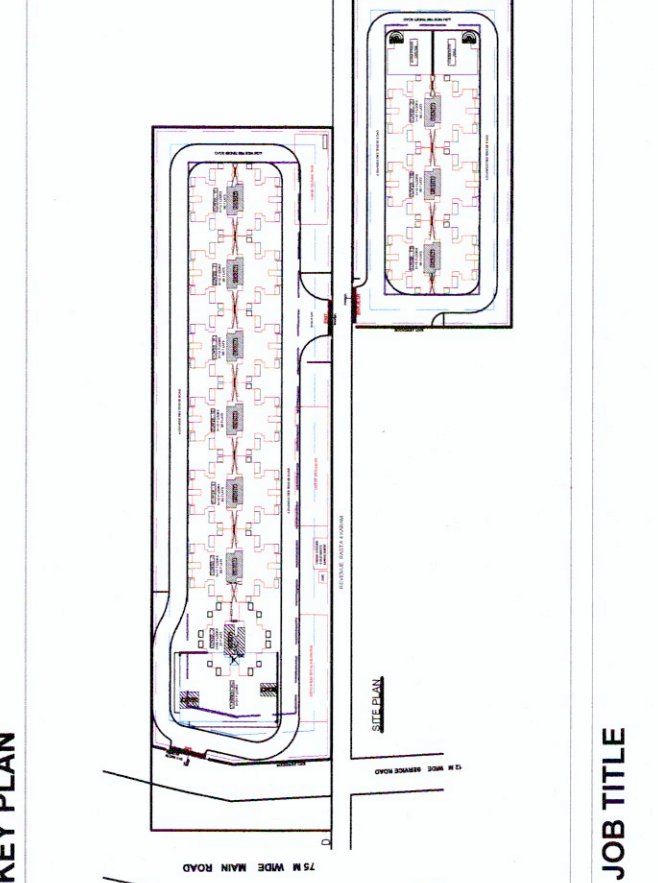

JOB TITLE
REVISED BUILDING PLAN OF AFFORDABLE GROUP HOUSING SCHEME MEASURING 5.00 ACRES (LICENCE NO. 106 OF 2014 DATED 14.08.2014) IN SECTOR-99A, GURUGRAM MANESAR URBAN COMPLEX BEING DEVELOPED BY PAREENA INFRASTRUCTURE PVT. LTD.

OWNER
PAREENA INFRASTRUCTURE PVT. LTD.
PROJECT
PROPOSED AFFORDABLE GROUP HOUSING AT SECTOR-99A, GURUGRAM

CONSULTANTS
KAMBO DESIGN STUDIO
209/1 STREET No. 03
VIRENDER NAGAR
NEW DELHI - 110058
EMAIL - kambostudio@gmail.com

ARCHITECT
LINEAR CONCEPTS
407 ASO GL, NORTHLEX TOWERS, NETAJI SUBRAMAN PLACE
NEW DELHI - 110028
EMAIL: INFO@LINEARCONCEPTS.NL TEL: +91 2326 4659

DESCRIPTION
REVISED SUBMISSION DRAWING

SCALE
1 : 100 @ A1
SHEET NO.
DATE ISSUED 12-03-2019
DRAWN BY
CHECKED BY
ARCHITECT'S SIGNATURE AND SEAL
OWNER'S SIGNATURE AND SEAL



SITE PLAN
GROUND COVERAGE & GREEN AREA
PROJECT NO. AF-AR-02

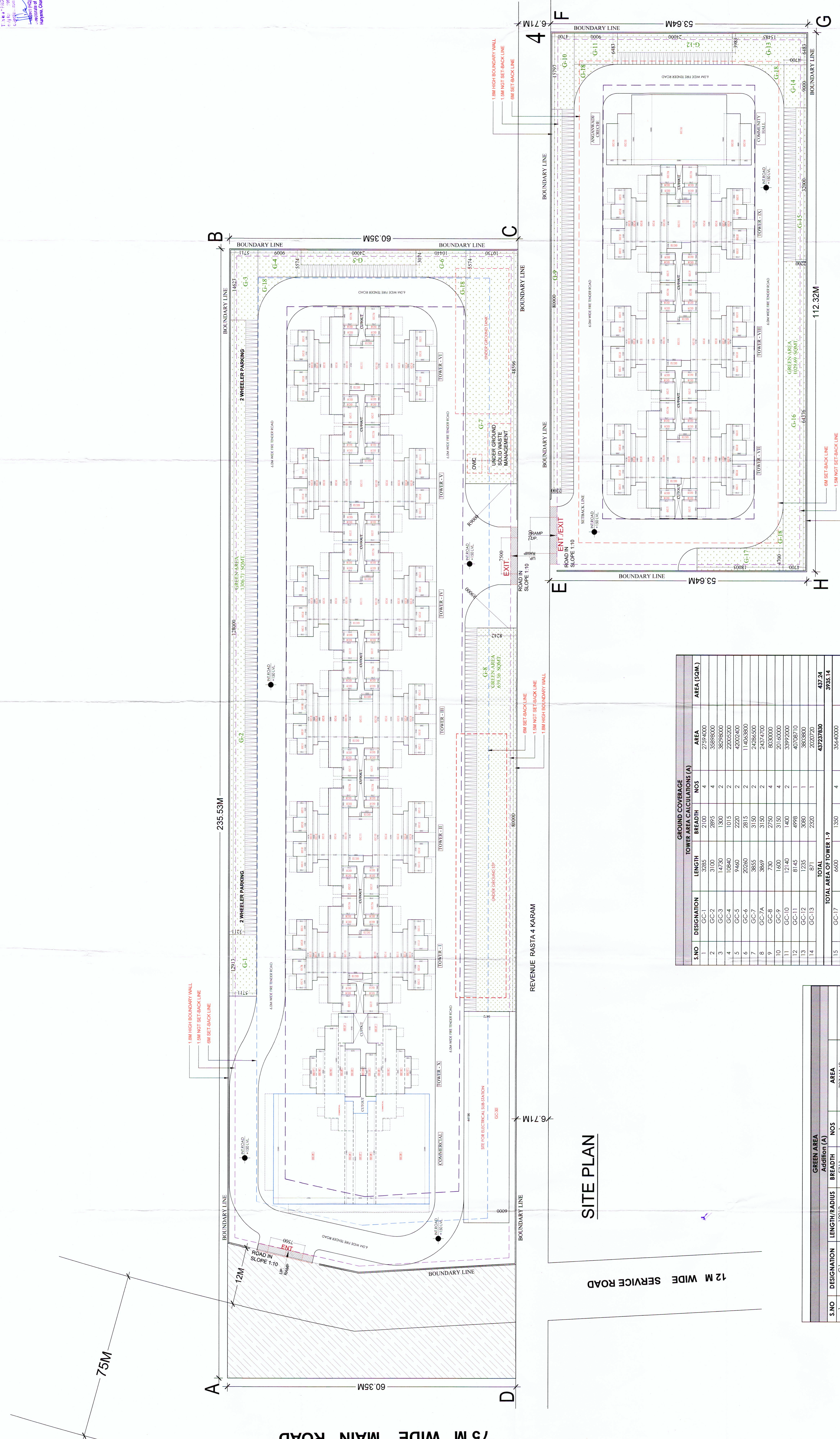

GROUND COVERAGE			
S.NO	DESIGNATION	LENGTH	BREADTH
1	GC-1	3085	2100
2	GC-2	3100	2895
3	GC-3	1720	1330
4	GC-4	1570	1200
5	GC-5	9460	2220
6	GC-6	20260	2815
7	GC-7	3855	3150
8	GC-7A	3869	3150
9	GC-8	730	2750
10	GC-9	600	3130
11	GC-10	1300	1700
12	GC-11	8145	4998
13	GC-12	1235	3080
14	GC-13	871	2320
15	GC-14	8090	2291
16	GC-15	10640	2929
17	GC-16	14565	19800
18	GC-17	1350	1565
19	GC-18	8500	1750
20	GC-19	14350	2815
21	GC-20	10820	1400
22	GC-21	6185	3150
23	GC-22	9980	3225
24	GC-23	1450	1125
25	GC-24	3115	2150
26	GC-25	22985	15021
27	GC-26	21465	1750
28	GC-27	18935	3000
29	GC-28	21465	1750
30	GC-29	22985	11125
31	GC-30	44196	9472
32	GC-31	41824512	418.42
33	GC-32	158870662	585.33
34	GC-33	288387000	9941.085
35	GC-34	370108	5835.33
36	GC-35	345257485	9941.085
37	GC-36	37563750	5835.33
38	GC-37	56805000	9941.085
39	GC-38	37563750	5835.33
40	GC-39	229851125	9941.085
41	GC-40	72079210	732.79
42	GC-41	41824512	418.42
43	GC-42	158870662	585.33
44	GC-43	288387000	9941.085
45	GC-44	370108	5835.33
46	GC-45	345257485	9941.085
47	GC-46	37563750	5835.33
48	GC-47	56805000	9941.085
49	GC-48	37563750	5835.33
50	GC-49	229851125	9941.085
51	GC-50	72079210	732.79
52	GC-51	41824512	418.42
53	GC-52	158870662	585.33
54	GC-53	288387000	9941.085
55	GC-54	370108	5835.33
56	GC-55	345257485	9941.085
57	GC-56	37563750	5835.33
58	GC-57	56805000	9941.085
59	GC-58	37563750	5835.33
60	GC-59	229851125	9941.085
61	GC-60	72079210	732.79
62	GC-61	41824512	418.42
63	GC-62	158870662	585.33
64	GC-63	288387000	9941.085
65	GC-64	370108	5835.33
66	GC-65	345257485	9941.085
67	GC-66	37563750	5835.33
68	GC-67	56805000	9941.085
69	GC-68	37563750	5835.33
70	GC-69	229851125	9941.085
71	GC-70	72079210	732.79
72	GC-71	41824512	418.42
73	GC-72	158870662	585.33
74	GC-73	288387000	9941.085
75	GC-74	370108	5835.33
76	GC-75	345257485	9941.085
77	GC-76	37563750	5835.33
78	GC-77	56805000	9941.085
79	GC-78	37563750	5835.33
80	GC-79	229851125	9941.085
81	GC-80	72079210	732.79
82	GC-81	41824512	418.42
83	GC-82	158870662	585.33
84	GC-83	288387000	9941.085
85	GC-84	370108	5835.33
86	GC-85	345257485	9941.085
87	GC-86	37563750	5835.33
88	GC-87	56805000	9941.085
89	GC-88	37563750	5835.33
90	GC-89	229851125	9941.085
91	GC-90	72079210	732.79
92	GC-91	41824512	418.42
93	GC-92	158870662	585.33
94	GC-93	288387000	9941.085
95	GC-94	370108	5835.33
96	GC-95	345257485	9941.085
97	GC-96	37563750	5835.33
98	GC-97	56805000	9941.085
99	GC-98	37563750	5835.33
100	GC-99	229851125	9941.085
101	GC-100	72079210	732.79

GREEN AREA			
S.NO	DESIGNATION	LENGTH/RADIUS	BREADTH
1	G1	12913	5711
2	G2	128200	3211
3	G3	14623	5711
4	G4	5574	9009
5	G5	3074	24000
6	G6	5574	10440
7	G7	46996	10790
8	G8	80000	8242
9	G9	80000	2200
10	G10	15797	4700
11	G11	6483	2000
12	G12	2963	24000
13	G13	10626	10626
14	G14	9000	1700
15	G15	33000	2200
16	G16	44376	4700
17	G17	4700	18005
18	G18	9000	9000
19	G19	9000	9000
20	G20	9000	9000
21	G21	9000	9000
22	G22	9000	9000
23	G23	9000	9000
24	G24	9000	9000
25	G25	9000	9000
26	G26	9000	9000
27	G27	9000	9000
28	G28	9000	9000
29	G29	9000	9000
30	G30	9000	9000
31	G31	9000	9000
32	G32	9000	9000
33	G33	9000	9000
34	G34	9000	9000
35	G35	9000	9000
36	G36	9000	9000
37	G37	9000	9000
38	G38	9000	9000
39	G39	9000	9000
40	G40	9000	9000
41	G41	9000	9000
42	G42	9000	9000
43	G43	9000	9000
44	G44	9000	9000
45	G45	9000	9000
46	G46	9000	9000
47	G47	9000	9000
48	G48	9000	9000
49	G49	9000	9000
50	G50	9000	9000
51	G51	9000	9000
52	G52	9000	9000
53	G53	9000	9000
54	G54	9000	9000
55	G55	9000	9000
56	G56	9000	9000
57	G57	9000	9000
58	G58	9000	9000
59	G59	9000	9000
60	G60	9000	9000
61	G61	9000	9000
62	G62	9000	9000
63	G63	9000	9000
64	G64	9000	9000
65	G65	9000	9000
66	G66	9000	9000
67	G67	9000	9000
68	G68	9000	9000
69	G69	9000	9000
70	G70	9000	9000
71	G71	9000	9000
72	G72	9000	9000
73	G73	9000	9000
74	G74	9000	9000
75	G75	9000	9000
76	G76	9000	9000
77	G77	9000	9000
78	G78	9000	9000
79	G79	9000	9000
80	G80	9000	9000
81	G81	9000	9000
82	G82	9000	9000
83	G83	9000	9000
84	G84	9000	9000
85	G85	9000	9000
86	G86	9000	9000
87	G87	9000	9000
88	G88	9000	9000
89	G89	9000	9000
90	G90	9000	9000
91	G91	9000	9000
92	G92	9000	9000
93	G93	9000	9000
94	G94	9000	9000
95	G95	9000	9000
96	G96	9000	9000
97	G97	9000	9000
98	G98	9000	9000
99	G99	9000	9000
100	G100	9000	9000

TOTAL AREA CALCULATION			
S.NO	DESIGNATION	LENGTH/RADIUS	BREADTH
1	G1	12913	5711
2	G2	128200	3211
3	G3	14623	5711
4	G4	5574	9009
5	G5	3074	24000
6	G6	5574	10440
7	G7	46996	10790
8	G8	80000	8242
9	G9	80000	2200
10	G10	15797	4700
11	G11	6483	2000
12	G12	2963	24000
13	G13	10626	10626
14	G14	9000	1700
15	G15	33000	2200
16	G16	44376	4700
17	G17	4700	18005
18	G18	9000	9000
19	G19	9000	9000
20	G20	9000	9000
21	G21	9000	9000
22	G22	9000	9000
23	G23	9000	9000
24	G24	9000	9000
25	G25	9000	9000
26	G26	9000	9000
27	G27	9000	9000
28	G28	9000	9000
29	G29	9000	9000
30	G30	9000	9000
31	G31	9000	9000
32	G32	9000	9000
33	G33	9000	9000
34	G34	9000	9000
35	G35	9000	9000
36	G36	9000	9000
37	G37	9000	9000
3			