

Storm water Drainage

PROJECT_NAME

STORM WATER



Check the dimensions in the plan and verify the same with the estimate.
 The site plan is attached with the estimate.
 The site plan is attached with the estimate.

Executive Engineer (Water) for Chief Engineer, HUDA Panchkula
 HUDA Panchkula
 HUDA Panchkula

Supervisor, HUDA Panchkula
 HUDA Panchkula
 HUDA Panchkula

Studio 104 & 105
 104/105, 10th Floor, Sector 15
 Gurgaon - 122002, Haryana, India
 Phone: +91 122 4131030 / 4131031
 Fax: +91 122 4131032
 Email: info@studio104.com
 Website: www.studio104.com

Executive Director, HUDA Panchkula
 HUDA Panchkula
 HUDA Panchkula

Optimal Consultancy Services Pvt. Ltd.
 Optimal Consultancy Services Pvt. Ltd.
 Optimal Consultancy Services Pvt. Ltd.

T.S. Sethi & Engineering Associates
 T.S. Sethi & Engineering Associates
 T.S. Sethi & Engineering Associates

ANAC Consultants
 ANAC Consultants
 ANAC Consultants

CONSULTANTS PRIVATE LIMITED
 CONSULTANTS PRIVATE LIMITED
 CONSULTANTS PRIVATE LIMITED

Design Cell
 Design Cell
 Design Cell

RMS Architects (P) Ltd.
 RMS Architects (P) Ltd.
 RMS Architects (P) Ltd.

Rev.	Description	Date	By	Check

MUNICIPAL SUBMISSION DRAWING

TOWN SQUARE GURGAON

SITE PLAN (STORM WATER)

DATE: 03-09-2012
 CHECKED BY: GM
 APPROVED BY: GM

For MIS VTIKA LIMITED
 HUDA Panchkula
 Gurgaon

Authorised Signatory

Revision No: R01

PL-602

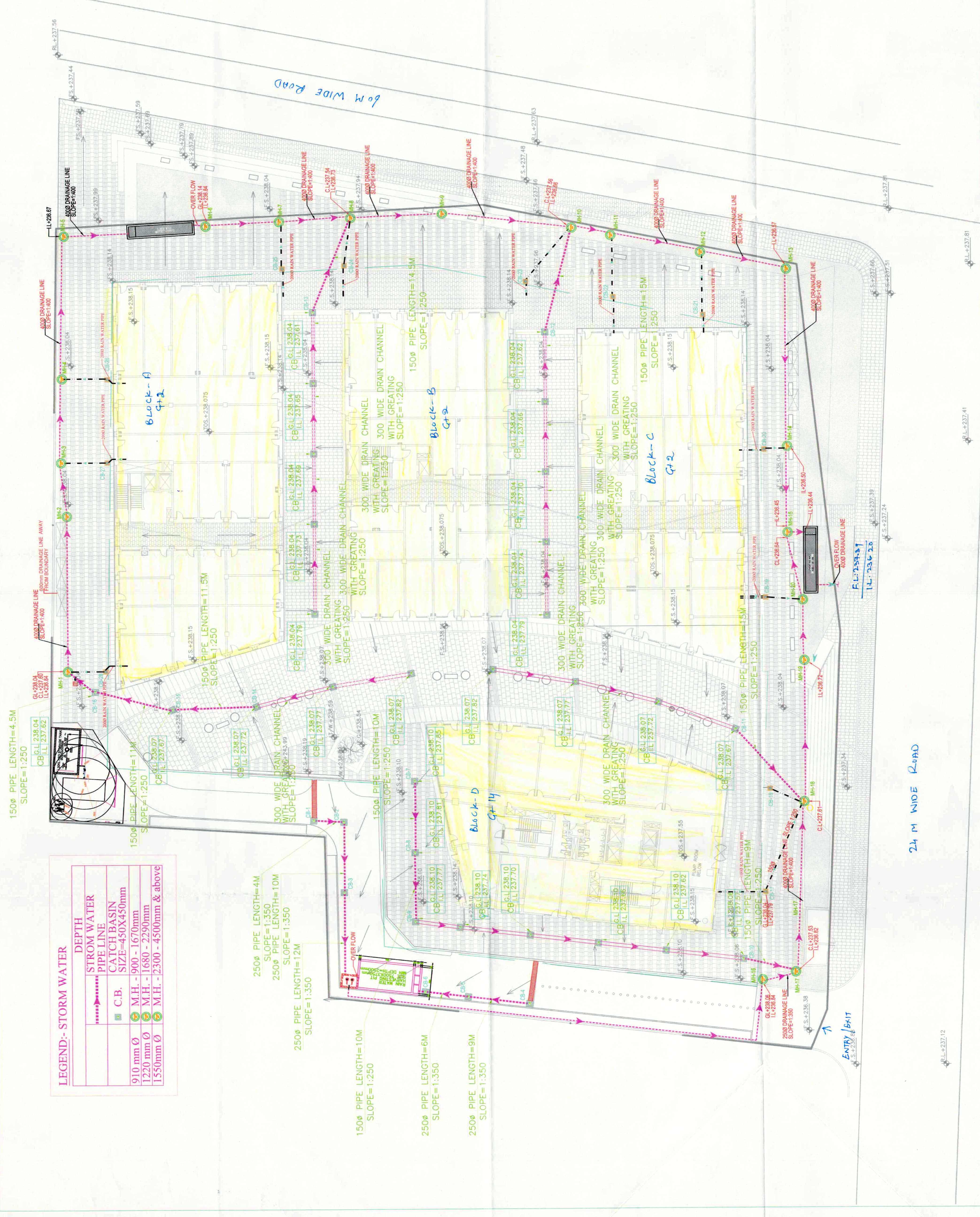

LEGEND:- STORM WATER

DEPTH	STORM WATER PIPE LINE
910 mm Ø	C.B.
1220 mm Ø	M.H. - 900 - 1670mm
1550mm Ø	M.H. - 1680 - 2290mm
	M.H. - 2300 - 4500mm & above

- 250Ø PIPE LENGTH=4M SLOPE=1:350
- 250Ø PIPE LENGTH=10M SLOPE=1:350
- 250Ø PIPE LENGTH=12M SLOPE=1:350
- 150Ø PIPE LENGTH=10M SLOPE=1:250
- 250Ø PIPE LENGTH=6M SLOPE=1:350
- 250Ø PIPE LENGTH=9M SLOPE=1:350

60M WIDE ROAD

24M WIDE ROAD

ENTRY EXIT

Block-A G+2

Block-B G+2

Block-C G+2

Block-D G+1/4



Director General
Town and Country Planning
Haryana, Chandigarh

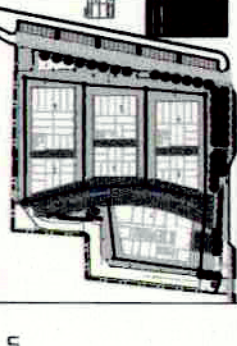

NOTE:-
1. All dimensions are in millimeters.
2. The drawing shall be read in conjunction with relevant architectural specifications.
3. The drawing shall be read in conjunction with relevant architectural specifications.
4. The drawing shall be read in conjunction with relevant architectural specifications.
5. The drawing shall be read in conjunction with relevant architectural specifications.

Client:
Vatika Limited
Plot No. 1, Block 'A', G Road
Sector 12, Gurgaon - 122001, Haryana, India. Ph: 0124 417 7377

Design Architect:
studio ura ltd
Plot No. 1, Block 'A', G Road
Sector 12, Gurgaon - 122001, Haryana, India. Ph: 0124 417 7377

Executive Architect:
Studio ura NORR Architects Pvt Ltd
Vatika A/C, Block B, 4th Floor
Sector 12, Gurgaon - 122001, Haryana, India. Ph: 0124 417 7377

Structural Consultants:
S.A. Associates
Plot No. 1, Block 'A', G Road
Sector 12, Gurgaon - 122001, Haryana, India. Ph: 0124 417 7377

Electrical Consultants:
T S Sethi & Engineering Associates
Plot No. 1, Block 'A', G Road
Sector 12, Gurgaon - 122001, Haryana, India. Ph: 0124 417 7377

HVAC Consultants:
Abid Husain Consultants
Plot No. 1, Block 'A', G Road
Sector 12, Gurgaon - 122001, Haryana, India. Ph: 0124 417 7377

Landscaping Consultants:
Design Cell Architects
Plot No. 1, Block 'A', G Road
Sector 12, Gurgaon - 122001, Haryana, India. Ph: 0124 417 7377

Architect of Records:
RMS Architects (P) Ltd
Plot No. 1, Block 'A', G Road
Sector 12, Gurgaon - 122001, Haryana, India. Ph: 0124 417 7377

Revision Table:

No.	Description	Date	By

Project:
TOWN SQUARE
GURGAON

FOR SUBMISSION OF SERVICE ESTIMATE

Scale: 1:250
Date: Oct. 15, 2012
Checked by: Approved by:

File Name:
Drawing Title

Drawing No.: LD-01SE
Revision No.: R.00

and subject to correction in drawing No. 12345 in D.P. 1/24/2012 as attached with the estimate

Executive Engineer
HUDA Panchkula

Supervising Engineer
HUDA Circle No. 1, Gurgaon

Executive Engineer
HUDA Circle No. 1, Gurgaon

RL+237.56

GL+237.10
GL+236.80

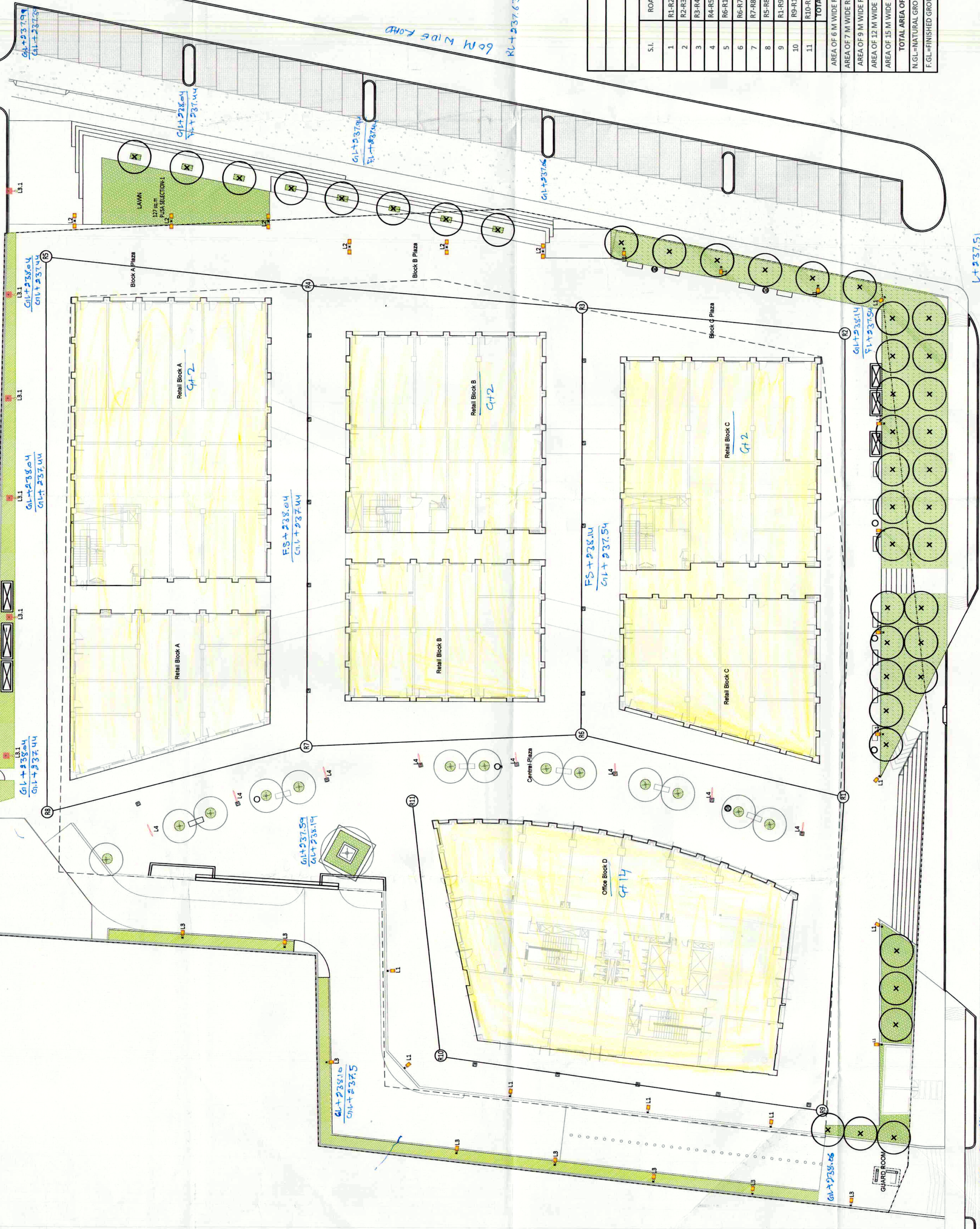

LEGEND

SYMBOL	ITEM	QUANTITY
	ELECTRIC POLE	30
	TREES	34
	GREEN AREA	506 sqm.

MEASUREMENT SHEET
TOWN SQUARE, GURGAON

S.L.	ROAD NO.	ROAD CALCULATIONS			
		6 M LENGTH(M)	7 M LENGTH(M)	9.0M LENGTH(M)	12.0M LENGTH(M)
1	R1-R2		54		15.0M
2	R2-R3			30	
3	R3-R4				31
4	R4-R5			30	
5	R6-R1				30
6	R6-R7				31
7	R7-R8				30
8	R5-R8		64		
9	R1-R9			36	
10	R9-R10		45		
11	R10-R11		30		
TOTAL		139	90	60	31
AREA OF 6 M WIDE ROAD =		139			
AREA OF 7 M WIDE ROAD =		90			
AREA OF 9 M WIDE ROAD =		60			
AREA OF 12 M WIDE ROAD =		31			
AREA OF 15 M WIDE ROAD =		91			
TOTAL AREA OF ROADS		411			
N.G.L-NATURAL GROUND LEVEL					
F.G.L-FINISHED GROUND LEVEL					

RL+237.51

24 M WIDE ROAD
RL+237.40

IFS+236.85

RL+237.12

ENTRANCE