

PRODUCED BY AN AUTODESK EDUCATIONAL PRODUCT

PRODUCED BY AN AUTODESK EDUCATIONAL PRODUCT

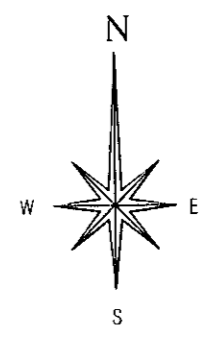
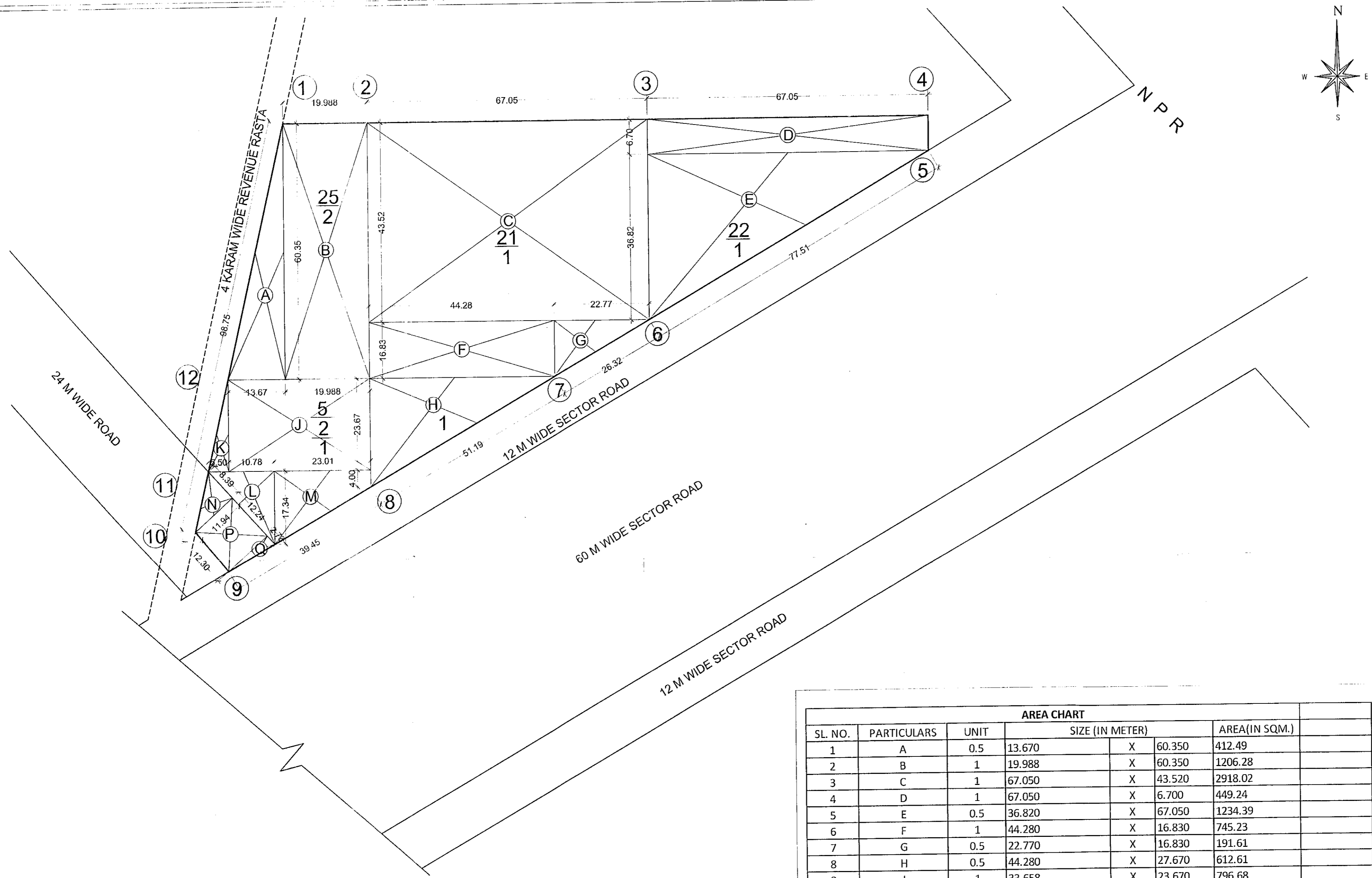

AREA AS PER L.O.I. = 2.281 ACRES  
 AREA AS PER DEMARCATION (A -Q) = 2.281 ACRES  
 AREA FALLING IN 24 M WIDE ROAD (N+P+Q)  
 = 212.54 SQ.M. (0.0525 Acs.)  
 NET SITE AREA = 2.2285 ACS

AREA CHART							
SL. NO.	PARTICULARS	UNIT	SIZE (IN METER)		AREA(IN SQM.)		
1	A	0.5	13.670	X	60.350	412.49	
2	B	1	19.988	X	60.350	1206.28	
3	C	1	67.050	X	43.520	2918.02	
4	D	1	67.050	X	6.700	449.24	
5	E	0.5	36.820	X	67.050	1234.39	
6	F	1	44.280	X	16.830	745.23	
7	G	0.5	22.770	X	16.830	191.61	
8	H	0.5	44.280	X	27.670	612.61	
9	J	1	33.658	X	23.670	796.68	
10	K	0.5	23.670	X	5.500	65.09	
11	L	0.5	17.340	X	16.280	141.15	
12	M	0.5	(17.34+4.00)= 21.34	X	23.010	245.52	
13	N	0.5	8.390	X	11.940	50.09	
14	P	1	11.940	X	12.240	146.15	
15	Q	0.5	11.940	X	2.730	16.30	
<b>TOTAL</b>						<b>9230.84</b>	<b>SQ.M.</b>
						<b>2.281</b>	<b>ACRES</b>

For Raheja Developers Ltd.  
 Authorized Signatory

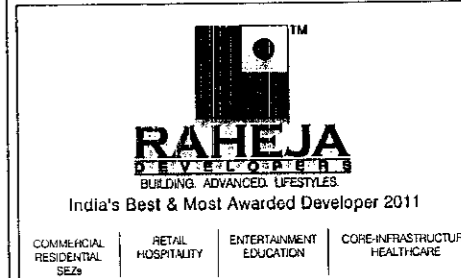

PROJECT-  
 COMMERCIAL PROJECT ON THE  
 LAND MEASURING 2.281 ACRES  
 AT VILLAGE- SIHI, SECTOR - 84,  
 GURGAON

ARCHITECT-  
 Daljeet Singh  
 Architect  
 AC/87/11165

SCALE: 1:750

DATE:

APPROVED:

CHECKED:

DRAWN:

THIS DRAWING IS COPYRIGHT. IT IS THE  
 INTELLECTUAL PROPERTY OF M/S FDL, AND IS  
 NOT TO BE REPRODUCED, COPIED, HANDED  
 OVER TO A THIRD PARTY OR USED FOR ANY  
 PURPOSE OTHER THAN FOR WHICH IT HAS  
 BEEN LOANED.

R-0

JE. AD HS PA AJP DTP