

PROPOSED BUILDING PLAN OF COMMERCIAL SITE MEASURING 100 ACRES IN COUNTY OF LUCERNE NO. 119 OF 2011 DATED 28.12.2011 IN URBAN COMPLEX BEING DEVELOPED BY HEIGHTS PVT. LTD.

Scale: 1:1000
 1:500
 1:200
 1:100
 1:50
 1:20
 1:10

ASSET MANAGER ARCHITECT CONSULTANTS

SITE PLAN
 001

ACPL
 ACPL Design Ltd

AREA DETAIL

TOTAL SITE AREA : 1 A CRES OR 4046.85 SQM
 PERMISSIBLE GROUND COVERAGE - 50% OF SITE AREA OF 1.0 ACRE OR = 4046.85 SQM.
 4046.85 X 50 / 100 = 2023.425 SQM
 PERMISSIBLE F.A.R. : 175 OF SITE AREA (NEIGHBOURHOOD SHOPPING 50%)
 = 175 X 4046.85 = 7081.987 SQM

TOTAL AREA PROPOSED

FLOOR	AREA
1 GROUND FLOOR (COVERAGE)	1898.81 SQM
2 1ST FLOOR	1454.715 SQM
3 2ND FLOOR	735.584 SQM
4 3RD FLOOR	679.991 SQM
5 4TH FLOOR	679.991 SQM
6 5TH FLOOR	679.991 SQM
7 6TH FLOOR	679.991 SQM
8 7TH FLOOR	199.62 SQM
7008.693 SQM	
9 BASEMENT 1ST	2207.409 SQM
10 BASEMENT 2ND	2207.409 SQM
11 BASEMENT 3RD	2207.409 SQM
12 SERVICE FLOOR	678.054 SQM

TOTAL GROUND COVERAGE PROPOSED : 1898.81 SQM (46.92%)
 TOTAL F.A.R PROPOSED : 7008.693 SQM (173.188%)
 TOTAL PARKING REQUIRED : 1 E.C.S. FOR 50 SQM OFF F.A.R
 7008.693 / 50 = 140.17 SAYS=141 CARS
 15% PARKING ON STREET LVL = 141 / 15% = 21.15 OR 21 CARS
 BASEMENT 1 PARKING BASEMENT AREA / 35 = 1453.720 / 35 = 47.249 CARS or 47 cars
 BASEMENT 2 PARKING BASEMENT AREA / 35 = 1674.45 / 35 = 47.841 CARS or 48 cars
 BASEMENT 3 PARKING BASEMENT AREA / 35 = 1674.45 / 35 = 47.841 CARS or 48 cars
47+48+48 = 143 CARS (PROPOSED)

NOTE
 2. FULL BUILDING A/C AND MECHANICALLY VENTILATED.
 3. THE RESPONSIBILITY OF STRUCTURAL DESIGN, STRUCTURE STABILITY AND STRUCTURE SAFETY AGAINST THE EARTH-QUAKE SHALL BE ENTIRE OF OWNERS/ARCHITECT/ENGINEER

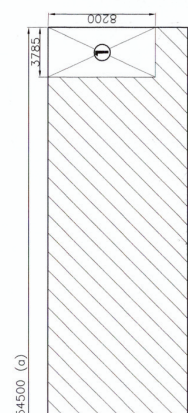

SURFACE PARKING AREA DIAGRAM

OPEN SURFACE CAR PARKING AREA DETAIL
 AXB=54.5X10.7 = 583.15 SQM.
 DEDUCT
 3.785X8.2+2.5X6.2=31.037+15.5=46.537 SQM.
 TOTAL CAR PARKING
 583.15-46.537=536.613/25=21.464 (21 CARS)

NEIGHBOURHOOD SHOPPING AREA
 GROUND FLOOR = 1898.81 SQM.
 1ST. FLOOR = 1454.715 SQM.
 2ND. FLOOR = 735.584 SQM.
 TOTAL = 4089.107 SQM. (57.74%)

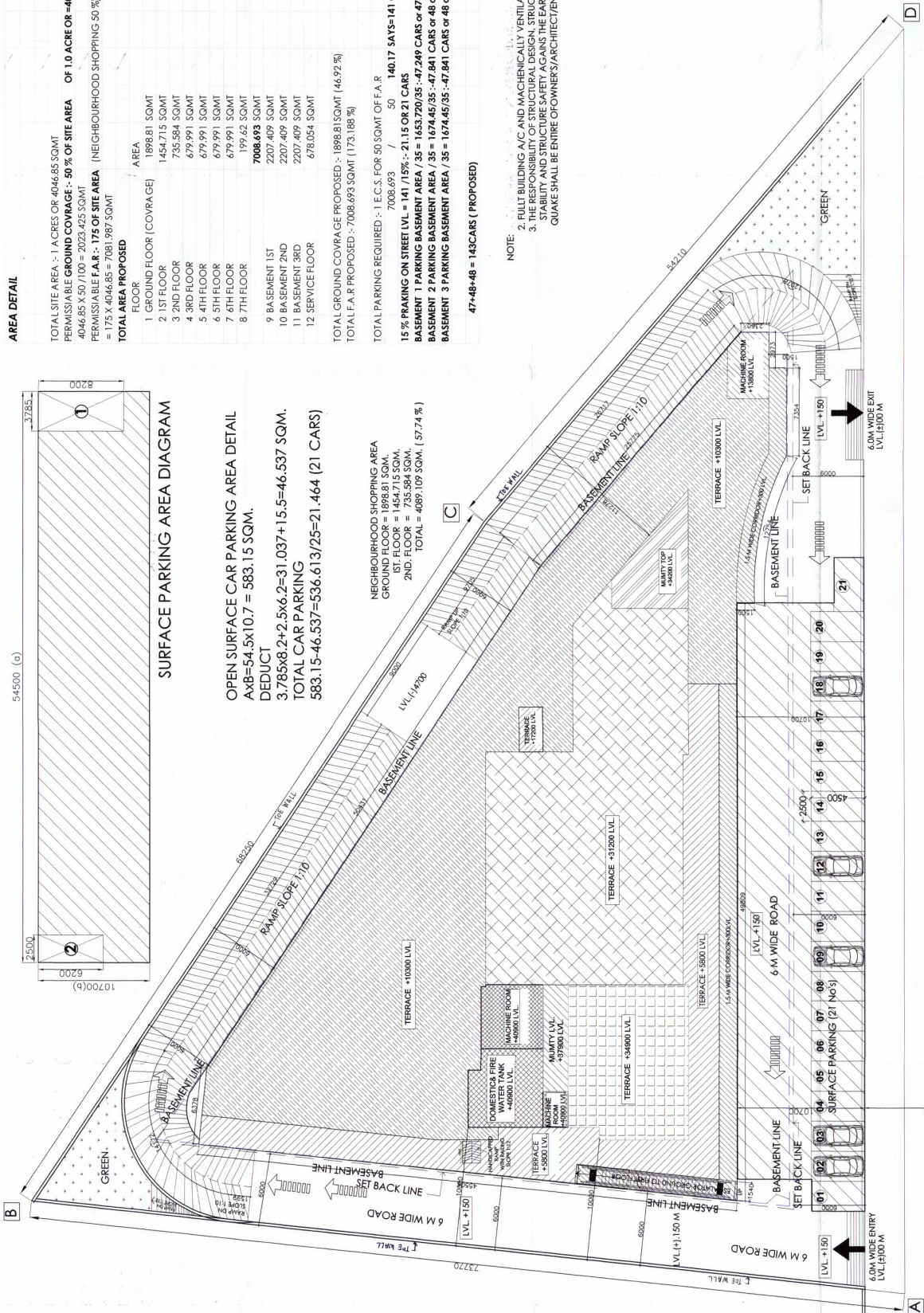

12 M WIDE ROAD

60.0 MT WIDE ROAD