

AREA AND POPULATION STATEMENT - SIE-B																			
S. No.	Bldg. Type	Description	No. of Floors	No. of Units	Total No. of Units	AREA CALCULATIONS										POPULATION STATEMENT			
						Ground Coverage	Total	Of One Bldg.	Total	Of One Bldg.	Total	Of One Bldg.	Total	Of One Bldg.	Total	Of One Bldg.	Total	Of One Bldg.	Total
1	TOWER - A	(G+21) Apartments	67.00	73.950	1	87	87	832.657	832.657	11464.773	11464.773	485.121	247.500	247.500	435	435	435	435	
2	TOWER - B	(G+21) Apartments	67.00	73.950	1	87	87	839.647	839.647	14520.080	14520.080	604.602	235.045	235.045	435	435	435	435	
3	TOWER - C	(G+21) Apartments	67.00	73.950	1	87	87	679.136	679.136	11450.031	11450.031	485.269	193.867	193.867	435	435	435	435	
4	TOWER - D	(G+21) Apartments	67.00	73.950	1	87	87	579.4.211	579.4.211	9799.804	9799.804	433.319	159.465	159.465	435	435	435	435	
5	TOWER - E	(G+21) Apartments	67.00	73.950	1	87	87	C10.237	C10.237	9608.727	9608.727	432.319	215.491	215.491	435	435	435	435	
6	TOWER - F	(G+21) Apartments	67.00	73.950	1	87	87	778.006	778.006	11461.307	11461.307	485.151	292.855	292.855	435	435	435	435	
7	TOWER - J	(S-22) Apartments	78.750	85.650	1	88	88	922.493	922.493	16853.346	16853.346	159.400	703.027	703.027	440	440	440	440	
8	TOWER - H	(S-22) Apartments	78.750	85.650	1	88	88	977.482	977.482	17229.629	17229.629	159.958	817.524	817.524	440	440	440	440	
9	TOWER - G	(S-24/6S+12) Apartments	81.950	88.850	1	58	58	971.672	971.672	15773.477	15773.477	204.144	767.528	767.528	290	290	290	290	
10	COMMUNITY BLOCK - X1	(G+1)	10.150	10.150	1	---	---	1465.354	1465.354	1087.626	1087.626	677.079	788.275	788.275	0	0	0	0	
11	COMMUNITY BLOCK - X2	(G+1)	10.150	10.150	1	---	---	940.704	940.704	763.307	763.307	506.836	433.868	433.868	0	0	0	0	
13	CONVENIENT SHOPPING	(Ground)	4.600	4.600	1	---	---	428.701	428.701	352.205	352.205	352.205	76.496	76.496	0	0	0	0	
14	EWS - Y	(G+7) Apartments	25.000	31.000	1	134	134	329.698	329.698	3082.167	3082.167	110.593	419.105	419.105	268	268	268	268	
15	ENTRANCE GATE - Z	(Ground)	4.750	4.750	3	---	---	9.000	9.000	27.000	27.000	9.000	0.000	0.000	0	0	0	0	
17	NURSERY SCHOOL	(G+1)	5.110	5.110	2	---	---	180.094	180.094	380.188	380.188	---	---	---	0	0	0	0	
Total						890	---	---	---	11096.156	Grand Total in Sqm	113473.714	5501.052	907.112	42	3780	268	168	4218

AREA CALCULATIONS FOR LANDSCAPE (ORGANISED GREEN)				
NO	A (M)	B (M)	No. of	AREA (SqM) = A x B
ADDITIONS FOR GREEN AREAS				
G-1	43.510	96.277	1	4189.012
G-2	31.750	10.774	1	342.338
G-3	46.849	12.880	1	603.299
G-4	18.981	29.014	1	550.673
G-5	16.762	21.603	1	362.109
G-6	10.820	15.690	1	169.766
G-7	17.330	22.460	1	389.232
G-8	6.470	18.630	1	120.596
G-9	14.920	9.670	1	144.275
G-10	8.890	30.415	1	270.389
G-11	26.900	14.155	1	380.770
G-12	22.675	17.870	1	404.069
G-13	33.525	24.553	1	823.139
G-14	27.550	6.120	1	168.660
G-15	78.460	17.650	1	1384.819
G-16	45.300	16.640	1	753.792
G-17	37.270	9.600	1	357.792
G-18	52.500	30.260	1	1588.650
G-19	37.320	21.890	1	816.935
G-20	38.970	6.000	1	233.820
TOTAL ADDITIONS				14023.673
SUBTRACTIONS FOR GREEN AREAS				
TOTAL SUBTRACTIONS				0.000
TOTAL GREEN AREA				14023.673

POPULATION			
Category	Permissible	Proposed	Remarks
Total Population of Main Units	3780	3780	Autonomous
Total Population of EWS Units	268	268	Autonomous
Total Population of Service Units	158	158	Autonomous
TOTAL POPULATION	4218	4218	
TOTAL DENSITY	241	241	PPA

INFRASTRUCTURE			
Category	Required	Proposed	Remarks
Convenient shopping	354.00 Sqm	352.21 Sqm	
At 0.5% of the total area site			

PARKING			
Category	Required	Proposed	Remarks
Parking in Basement	1202	1202	ECS
Parking on STILTS	42	42	ECS
Parking on SURFACE	193	193	ECS
TOTAL PARKING for Main Unit	1437	1437	ECS
open	233.50	193	ECS
covered	1202	1244	ECS
TOTAL PARKING for EWS	57	58	ECS
NET TOTAL PARKING	1494	1495	ECS

GREEN AREA			
Category	Required	Proposed	Remarks
Total Maintained Green Area	15% of the total site area	19.81% of the total site area	
Required	10610.95 Sqm	14023.67 Sqm	

STILTS AREA			
Category	Required	Proposed	Remarks
Total Stilt Area Proposed		7.77% of the total site area	
Required		5505.51 Sqm	

Checked and found ok for Public Health (Planned) to be used only subject to comments in letter by Mr. B. Singh on 17.12.2012
 Checked by Engineer 400
 Date: 17/12/2012

Notes:

1. GATE AND BOUNDARY WALL AS PER STANDARD SIZE.
 2. EXHAUST FAN PROVIDED IN KITCHEN & TOILET.
 3. ALL SERVICE AREAS (INCLUDING LIFTS) ARE PROVIDED WITH 100 PERCENT POWER BACKUP.
 4. ALL THE TOWERS ARE PROVIDED WITH AUTOMATIC SPRINKLER SYSTEM.

Architects:
 Arcop Associates Pvt. Ltd.
 Plot-36b, Sec-32, Gurgaon-122001
 4th Floor, Arcop
 Montreal, Toronto, New Delhi, Boston

Architect's Signature: [Signature]

Owner's Signature: [Signature]

Client's: Aakashan Estates Pvt. Ltd. in collaboration with ADANI MKP Projects LLP, Gurgaon

Job Title: Proposed building plan of Ground Heating Colony measuring 13.72 x 13.518 acres. License no. 29 of 2012 dated 10/04/2012 and license no. 30 of 2012 dated 10/04/2012. Total 19.288 acres in Sector 102 & 102A, Gurgaon. Master Unit: Complex being developed by Aakashan Estates Pvt. Ltd. in collaboration with Adani MKP Projects LLP.

Drawing Title: MASTER PLAN SITE B

Drawn By: [Name]

Job No.: [Number]

Date: [Date]

Scale: 1:500

Revisions: [Table]

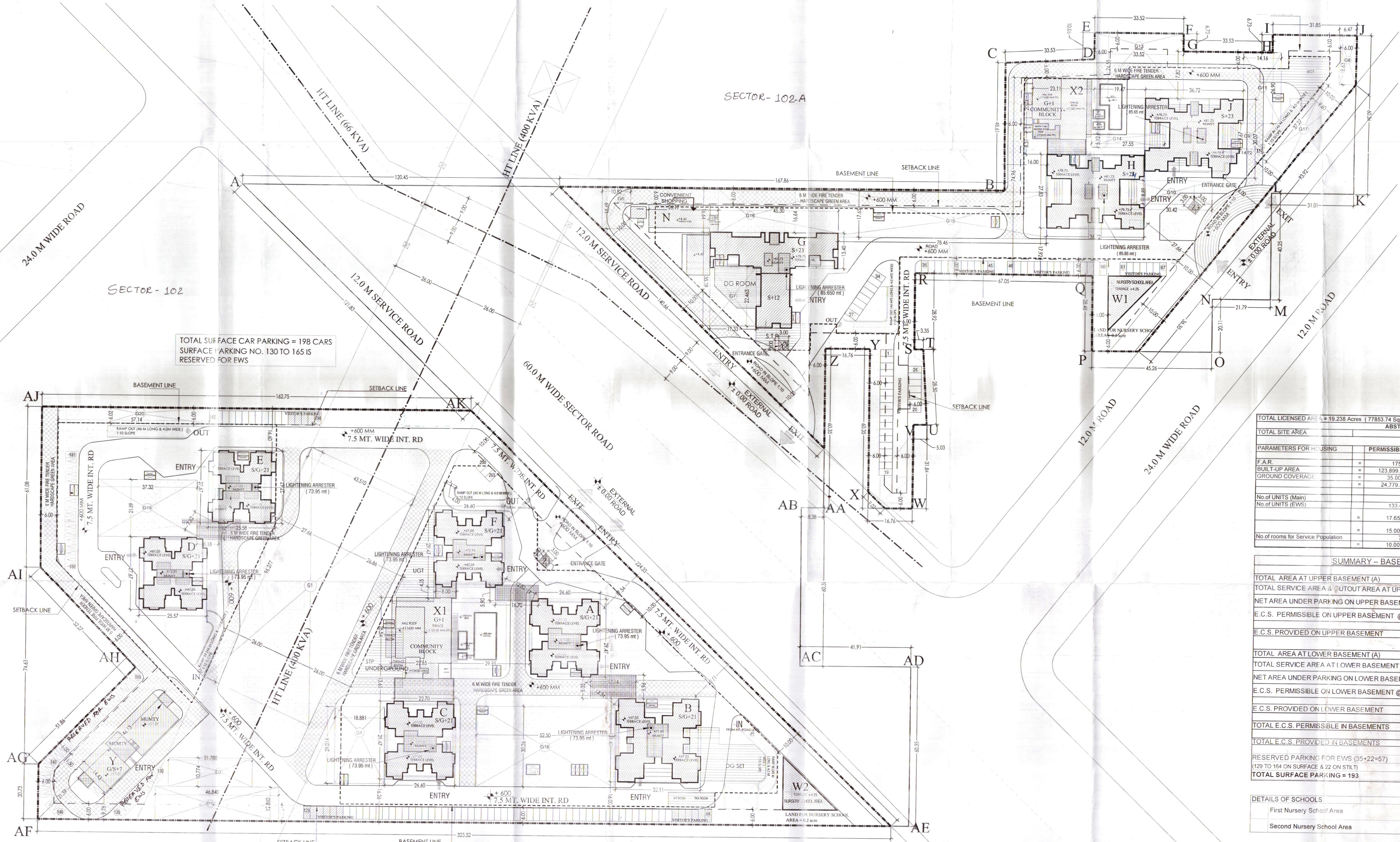

TOTAL SURFACE CAR PARKING = 198 CARS
 SURFACE PARKING NO. 130 TO 165 IS RESERVED FOR EWS

TOTAL LICENSED AREA = 19.238 Acres (77853.74 Sqm)			
TOTAL SITE AREA	ABSTRACT	17.495 ACRES	70799.64 Sqm
PARAMETERS FOR HOUSING			
F.A.R.	= 175%		174.68%
BUILT UP AREA	= 123,899.37 sqm		123,873.70 Sqm
GROUND COVERAGE	= 35.02%		15.52%
	= 24,779.87 sqm		11,066.84 Sqm
No. of UNITS (Main)	= 756 units		134 units
No. of UNITS (EWS)	= 133.41	of TOTAL UNITS (including EWS)	= 17.22%
	= 17.65%	of MAIN UNITS (excluding EWS)	= 15.00%
No. of rooms for Service Population	= 76		54 units
	= 10.00%	of TOTAL UNITS	11.11%

SUMMARY - BASEMENT PARKING	
TOTAL AREA AT UPPER BASEMENT (A)	30434.120
TOTAL SERVICE AREA & OUTPUT AREA AT UPPER BASEMENT (B)	2599.981
NET AREA UNDER PARKING ON UPPER BASEMENT (A-B)	27834.140
E.C.S. PERMISSIBLE ON UPPER BASEMENT @ 35 SQM	795.261
E.C.S. PROVIDED ON UPPER BASEMENT	795
	619
TOTAL AREA AT LOWER BASEMENT (A)	30273.661
TOTAL SERVICE AREA AT LOWER BASEMENT (B)	2343.084
NET AREA UNDER PARKING ON LOWER BASEMENT (A-B)	27930.576
E.C.S. PERMISSIBLE ON LOWER BASEMENT @ 35 SQM	798.016
E.C.S. PROVIDED ON LOWER BASEMENT	798
	630
TOTAL E.C.S. PERMISSIBLE IN BASEMENTS	1593
TOTAL E.C.S. PROVIDED IN BASEMENTS	1249
RESERVED PARKING FOR EWS (35+22+57)	56.4
TOTAL SURFACE PARKING	57

DETAILS OF SCHOOLS		
First Nursery School Area	0.2 Acre	809.37 Sq. mt.
Second Nursery School Area	0.2 Acre	809.37 Sq. mt.

SANCTIONED
 Prepared by [Name]
 Date: 17/12/2012