

ABSTRACT		PROPOSED		TOTAL	
TOTAL SITE AREA	30.150 Acres	POCKET-A	632.21 Acres	POCKET-B	1155.42 Acres
NET AREA FOR POCKET-A	30.4252 Acres	POCKET-A	632.21 Acres	POCKET-B	1155.42 Acres
NET AREA FOR POCKET-B	30.2000 Acres	POCKET-A	632.21 Acres	POCKET-B	1155.42 Acres
NET AREA FOR POCKET-A & B	60.6252 Acres	POCKET-A	632.21 Acres	POCKET-B	1155.42 Acres

PARAMETERS	PROPOSED	POCKET-A	POCKET-B	TOTAL
Ground Coverage	35.0%	35.0%	35.0%	35.0%
F.A.R.	1.75	1.75	1.75	1.75
No. of Main Units	12426	6322	6104	12426
No. of MS Units	12426	6322	6104	12426
No. of Service Personnel	12426	6322	6104	12426
Population	60927	31611	29316	60927
Organised Green	35%	35%	35%	35%
Greenbelt	1.5%	1.5%	1.5%	1.5%
Permeability	1.5%	1.5%	1.5%	1.5%

DETAILS OF PARKING & BARRIERS (As per Indian Standards)		POCKET-A		POCKET-B		TOTAL	
Area for Services	1500 sqm	1500	1500	1500	1500	1500	1500
Area for Parking	1500 sqm	1500	1500	1500	1500	1500	1500
Area for Services & Parking	3000 sqm	3000	3000	3000	3000	3000	3000

DETAILS OF PARKING & BARRIERS (As per Indian Standards)		POCKET-A		POCKET-B		TOTAL	
Area for Services	1500 sqm	1500	1500	1500	1500	1500	1500
Area for Parking	1500 sqm	1500	1500	1500	1500	1500	1500
Area for Services & Parking	3000 sqm	3000	3000	3000	3000	3000	3000

BUILDING DESCRIPTION	POCKET-A		POCKET-B		TOTAL	
	NO.	AREA (sqm)	NO.	AREA (sqm)	NO.	AREA (sqm)
POCKET-A	1	1500	1	1500	2	3000
POCKET-B	1	1500	1	1500	2	3000
TOTAL	2	3000	2	3000	4	6000

POCKET-A	POCKET-B	TOTAL
Plot Area	816.24 sqm	316.18 sqm
Plot Area	150.98 sqm	504.24 sqm
Plot Area	216.28 sqm	283.40 sqm
Plot Area	283.40 sqm	283.40 sqm

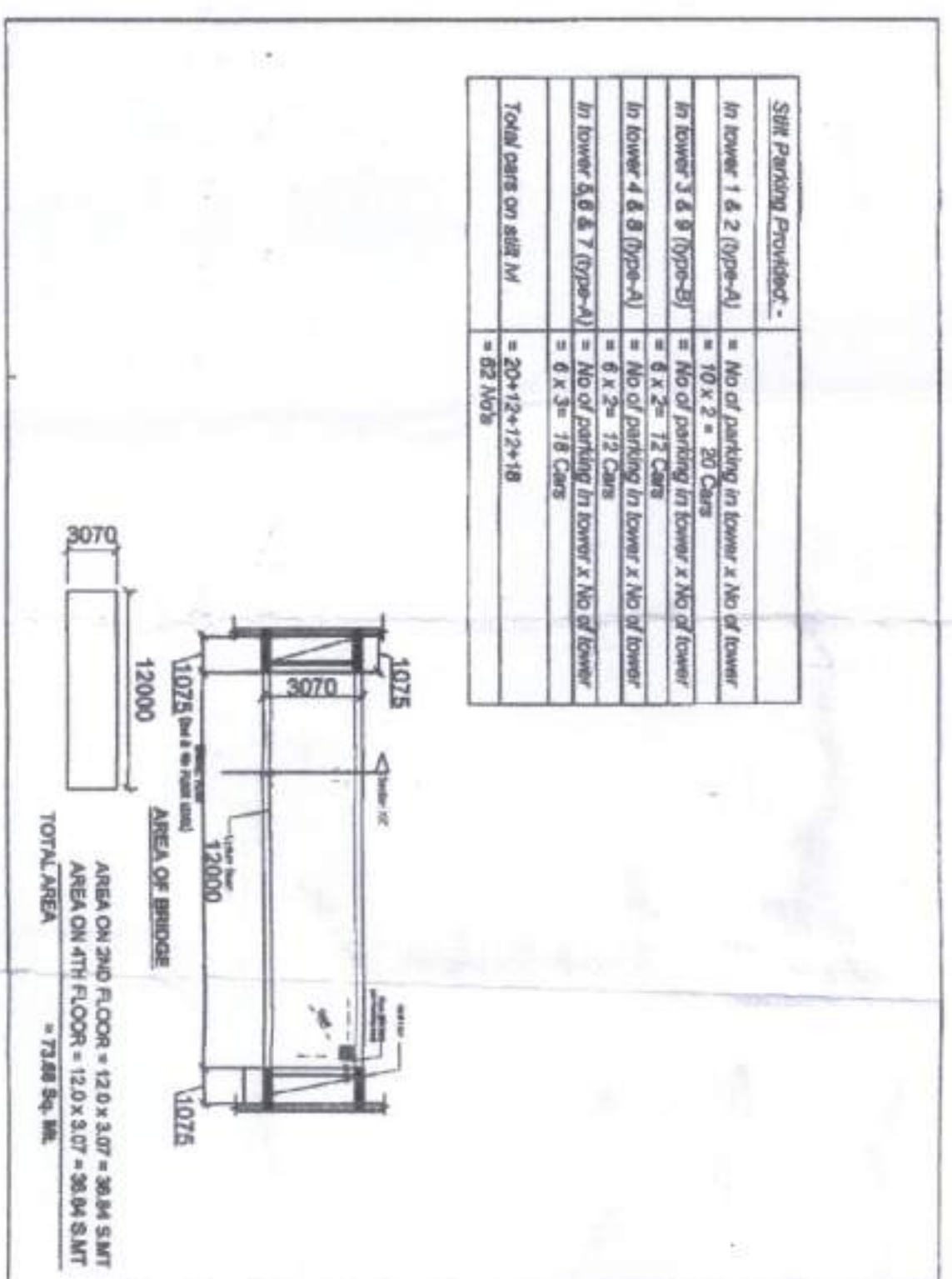

NOTE: 1 TO 29 NO. RESERVED FOR EWS PARKING
15 TO 47 NO. RESERVED FOR EWS PARKING

NO.	DESCRIPTION	AREA (sqm)	NO.	DESCRIPTION	AREA (sqm)
1	TOWER-1 TYPE-A	1500	10	TOWER-10 TYPE-A	1500
2	TOWER-2 TYPE-A	1500	11	TOWER-11 TYPE-A	1500
3	TOWER-3 TYPE-A	1500	12	TOWER-12 TYPE-A	1500
4	TOWER-4 TYPE-A	1500	13	TOWER-13 TYPE-A	1500
5	TOWER-5 TYPE-A	1500	14	TOWER-14 TYPE-A	1500
6	TOWER-6 TYPE-A	1500	15	TOWER-15 TYPE-A	1500
7	TOWER-7 TYPE-A	1500	16	TOWER-16 TYPE-A	1500
8	TOWER-8 TYPE-A	1500	17	TOWER-17 TYPE-A	1500
9	TOWER-9 TYPE-A	1500	18	TOWER-18 TYPE-A	1500

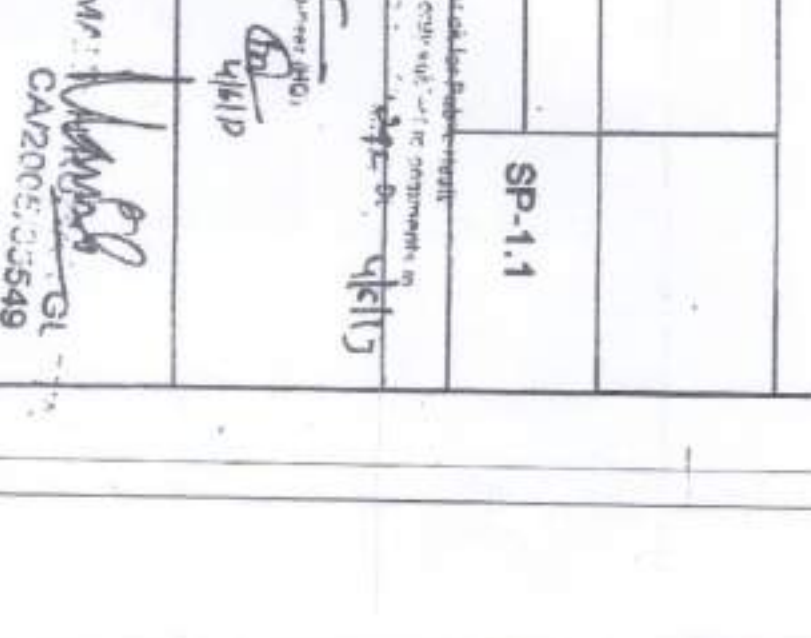
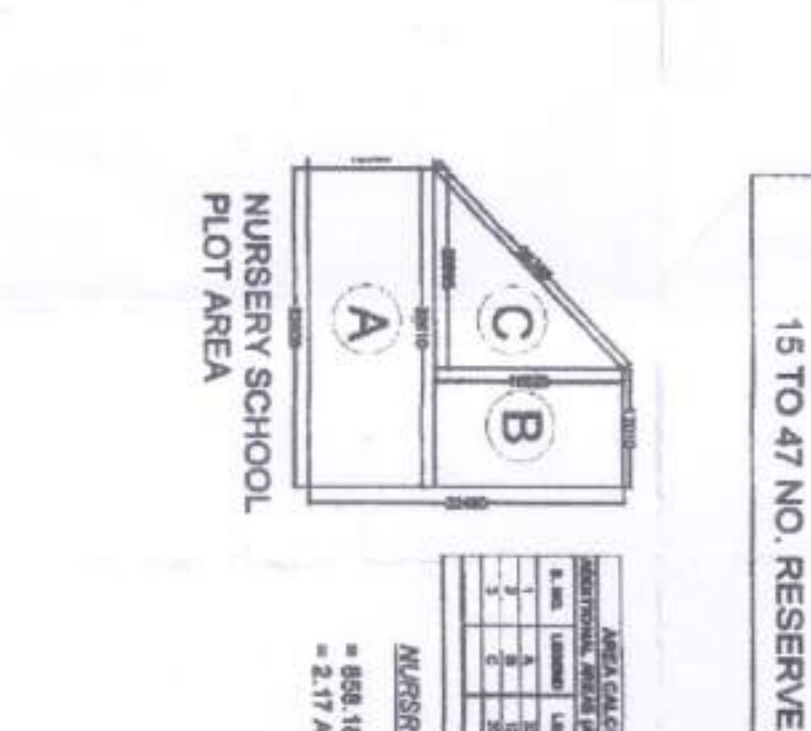
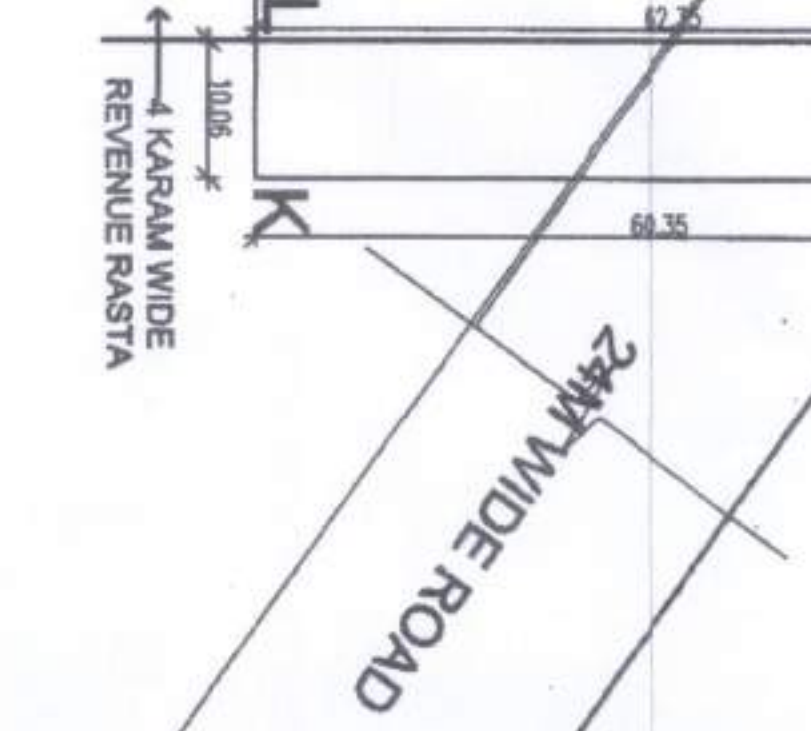
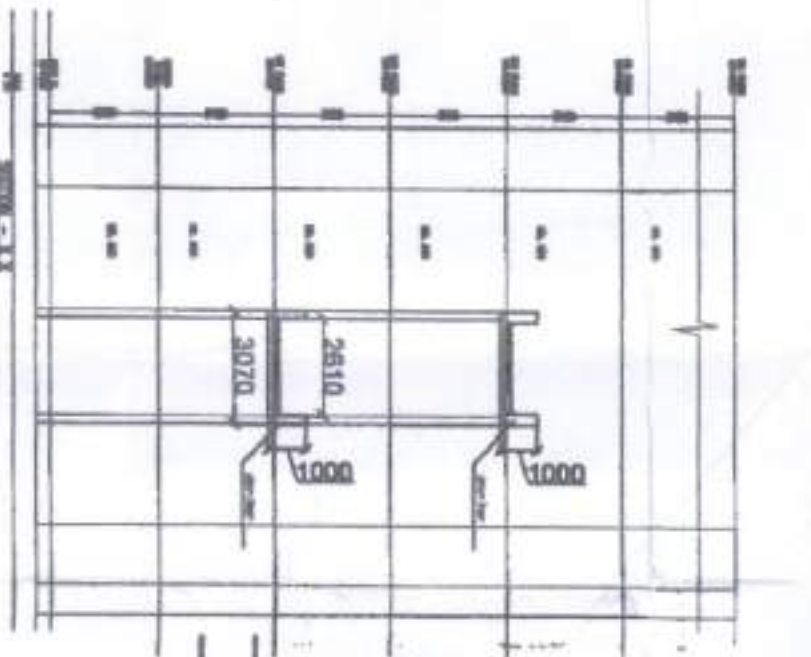
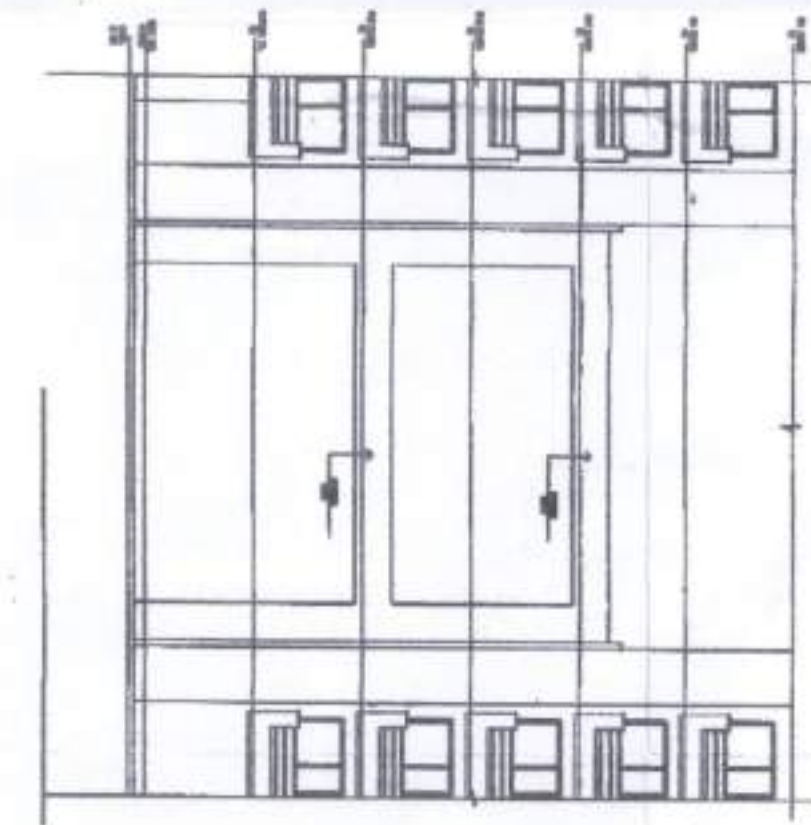

PARAMETERS		POCKET A	POCKET B	TOTAL
Grand Coverage	34.06 %	32.07 %	40.77 %	36.42 %
F.A.R.	1.15	1.15	1.15	1.15
No. of Towers	1	1	2	3
No. of Units	100	100	200	300
No. of Floors	1	1	2	3
No. of Towers	1	1	2	3
Overall coverage	1.15	1.15	1.15	1.15
Commercial Coverage	15 % of Plot Area	15 % of Plot Area	15 % of Plot Area	15 % of Plot Area
Commercial Coverage	15 % of Plot Area	15 % of Plot Area	15 % of Plot Area	15 % of Plot Area
Commercial Coverage	15 % of Plot Area	15 % of Plot Area	15 % of Plot Area	15 % of Plot Area

PARAMETERS		POCKET A	POCKET B	TOTAL
Grand Coverage	34.06 %	32.07 %	40.77 %	36.42 %
F.A.R.	1.15	1.15	1.15	1.15
No. of Towers	1	1	2	3
No. of Units	100	100	200	300
No. of Floors	1	1	2	3
No. of Towers	1	1	2	3
Overall coverage	1.15	1.15	1.15	1.15
Commercial Coverage	15 % of Plot Area	15 % of Plot Area	15 % of Plot Area	15 % of Plot Area
Commercial Coverage	15 % of Plot Area	15 % of Plot Area	15 % of Plot Area	15 % of Plot Area
Commercial Coverage	15 % of Plot Area	15 % of Plot Area	15 % of Plot Area	15 % of Plot Area

PARAMETERS		POCKET A	POCKET B	TOTAL
Grand Coverage	34.06 %	32.07 %	40.77 %	36.42 %
F.A.R.	1.15	1.15	1.15	1.15
No. of Towers	1	1	2	3
No. of Units	100	100	200	300
No. of Floors	1	1	2	3
No. of Towers	1	1	2	3
Overall coverage	1.15	1.15	1.15	1.15
Commercial Coverage	15 % of Plot Area	15 % of Plot Area	15 % of Plot Area	15 % of Plot Area
Commercial Coverage	15 % of Plot Area	15 % of Plot Area	15 % of Plot Area	15 % of Plot Area
Commercial Coverage	15 % of Plot Area	15 % of Plot Area	15 % of Plot Area	15 % of Plot Area

- NOTES**
- DIMENSIONS ARE NOT TO BE SCALED.
 - ALL DIMENSIONS ARE IN METERS.
 - ALL ELECTRICAL INSTALLATIONS SHALL BE AS PER PROVISIONS OF THE ELECTRICAL REGULATIONS.
 - RELEVANT NCC PROVISIONS SHALL BE AS PER RELEVANT NCC PROVISIONS.
 - ALL WALLS ARE 230/115 MM THK. BRICK WALL.
 - BOUNDARY WALL AND GATE AS PER STANDARDS.
 - PROVIDED AS PER CENTRAL GROUND WATER AUTHORITY NORMS/HARYANA GOVT.
 - ALL WINDOWS & VENTILATIONS ARE OPERABLE.
 - ALL MECHANICAL VENTILATIONS SHALL BE WITH TILT PANELS WITH 25MM POWER BLINDS.
 - TOWER 1 (POCKET A) SHALL BE WITH 25MM POWER BLINDS.

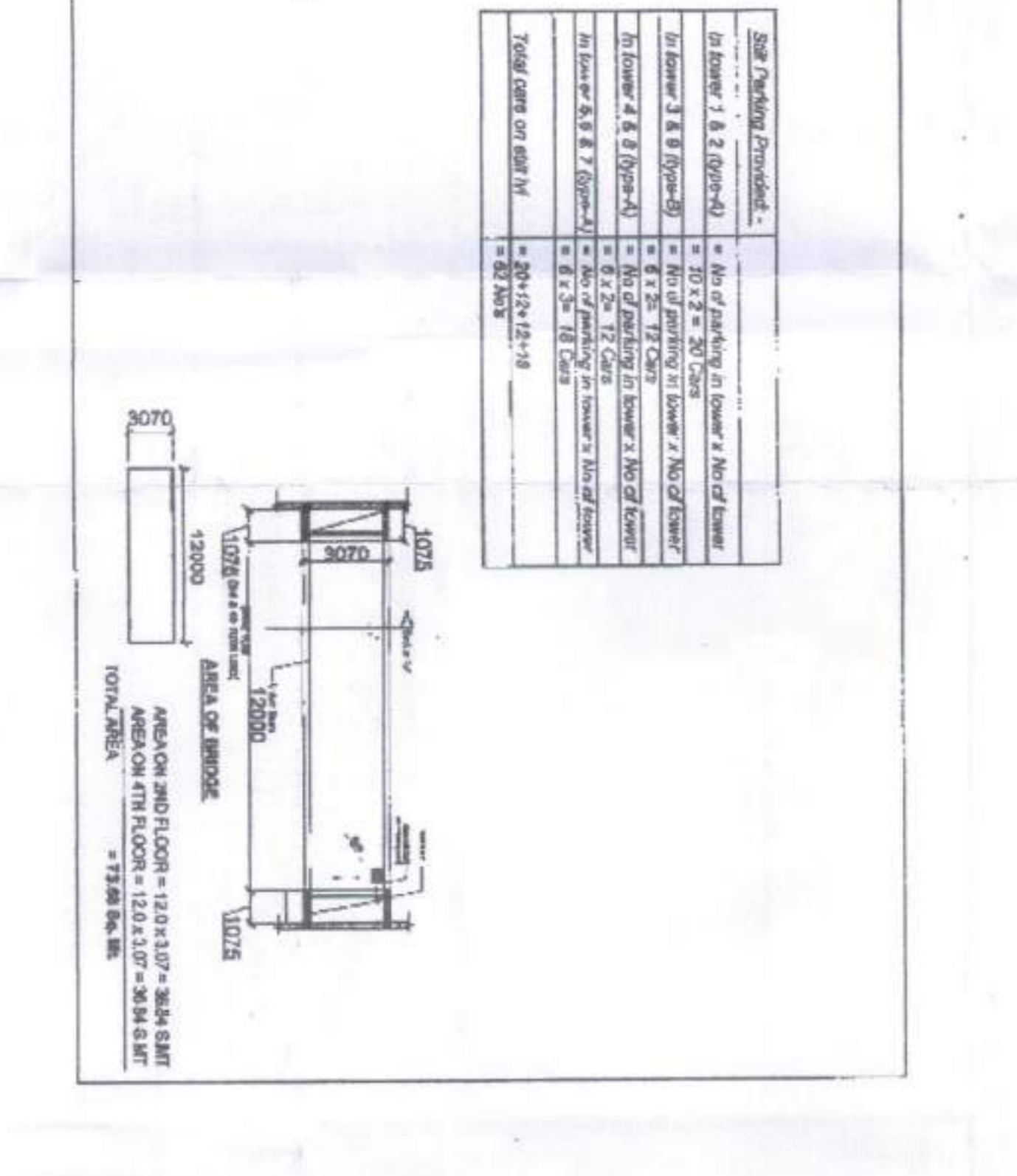
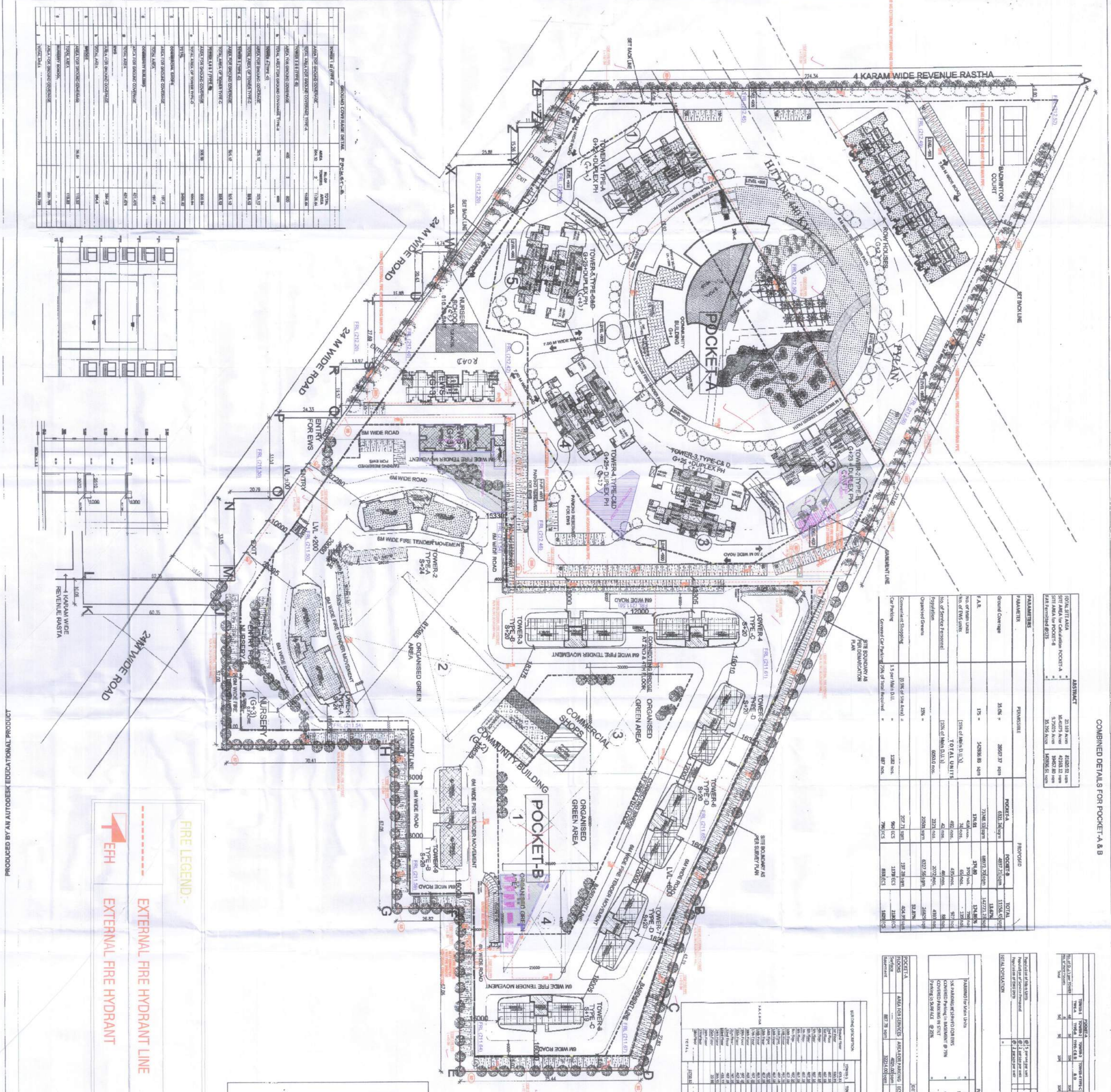

Area Schedule

Room	Area (sqm)	Remarks
POCKET - A	315.30	Handover
POCKET - B	823.18	Handover
Plot Area	150.95	5.00 x 30.19
Plot Area	150.95	5.00 x 30.19
Plot Area	150.95	5.00 x 30.19
Plot Area	150.95	5.00 x 30.19
Plot Area	150.95	5.00 x 30.19

Area Schedule

Room	Area (sqm)	Remarks
POCKET - A	315.30	Handover
POCKET - B	823.18	Handover
Plot Area	150.95	5.00 x 30.19
Plot Area	150.95	5.00 x 30.19
Plot Area	150.95	5.00 x 30.19
Plot Area	150.95	5.00 x 30.19
Plot Area	150.95	5.00 x 30.19

PROJECT INFORMATION

PROPOSED BUILDING PLAN OF GROUP HOUSING

ACRES LICENSE NO.250 OF 2007 DATED 02/11/2007 AND LICENSE NO.50 OF 2012 DATED 07/08/2015 IN BLOTTON ROAD GURGAON HARYANA MGNPLVT. LTD. AND OTHERS IN COLLABORATION WITH CHINTELS INDIA LTD.

DATE: 15/11/2015

SCALE: SP-1:1

DESIGNED BY: [Signature]

CHECKED BY: [Signature]

THROUGH: [Signature]

APPROVED BY: [Signature]

PROJECT NO.: [Number]

DATE: [Date]

SCALE: [Scale]

DESIGNED BY: [Signature]

CHECKED BY: [Signature]

THROUGH: [Signature]

APPROVED BY: [Signature]

PROJECT NO.: [Number]

DATE: [Date]

SCALE: [Scale]

Sd/- [Signature] Executive Engineer, HUDA Gurgaon, Haryana

Sd/- [Signature] Executive Engineer, HUDA Gurgaon, Haryana

NO.	DESCRIPTION	UNIT	QTY	AMOUNT	TOTAL
1	GRASS COVERED DRIVEWAY	Sq. Mtr	1000	1000	1000
2	GRASS COVERED DRIVEWAY	Sq. Mtr	1000	1000	1000
3	GRASS COVERED DRIVEWAY	Sq. Mtr	1000	1000	1000
4	GRASS COVERED DRIVEWAY	Sq. Mtr	1000	1000	1000
5	GRASS COVERED DRIVEWAY	Sq. Mtr	1000	1000	1000
6	GRASS COVERED DRIVEWAY	Sq. Mtr	1000	1000	1000
7	GRASS COVERED DRIVEWAY	Sq. Mtr	1000	1000	1000
8	GRASS COVERED DRIVEWAY	Sq. Mtr	1000	1000	1000
9	GRASS COVERED DRIVEWAY	Sq. Mtr	1000	1000	1000
10	GRASS COVERED DRIVEWAY	Sq. Mtr	1000	1000	1000
11	GRASS COVERED DRIVEWAY	Sq. Mtr	1000	1000	1000
12	GRASS COVERED DRIVEWAY	Sq. Mtr	1000	1000	1000
13	GRASS COVERED DRIVEWAY	Sq. Mtr	1000	1000	1000
14	GRASS COVERED DRIVEWAY	Sq. Mtr	1000	1000	1000
15	GRASS COVERED DRIVEWAY	Sq. Mtr	1000	1000	1000
16	GRASS COVERED DRIVEWAY	Sq. Mtr	1000	1000	1000
17	GRASS COVERED DRIVEWAY	Sq. Mtr	1000	1000	1000
18	GRASS COVERED DRIVEWAY	Sq. Mtr	1000	1000	1000
19	GRASS COVERED DRIVEWAY	Sq. Mtr	1000	1000	1000
20	GRASS COVERED DRIVEWAY	Sq. Mtr	1000	1000	1000
21	GRASS COVERED DRIVEWAY	Sq. Mtr	1000	1000	1000
22	GRASS COVERED DRIVEWAY	Sq. Mtr	1000	1000	1000
23	GRASS COVERED DRIVEWAY	Sq. Mtr	1000	1000	1000
24	GRASS COVERED DRIVEWAY	Sq. Mtr	1000	1000	1000
25	GRASS COVERED DRIVEWAY	Sq. Mtr	1000	1000	1000
26	GRASS COVERED DRIVEWAY	Sq. Mtr	1000	1000	1000
27	GRASS COVERED DRIVEWAY	Sq. Mtr	1000	1000	1000
28	GRASS COVERED DRIVEWAY	Sq. Mtr	1000	1000	1000
29	GRASS COVERED DRIVEWAY	Sq. Mtr	1000	1000	1000
30	GRASS COVERED DRIVEWAY	Sq. Mtr	1000	1000	1000
31	GRASS COVERED DRIVEWAY	Sq. Mtr	1000	1000	1000
32	GRASS COVERED DRIVEWAY	Sq. Mtr	1000	1000	1000
33	GRASS COVERED DRIVEWAY	Sq. Mtr	1000	1000	1000
34	GRASS COVERED DRIVEWAY	Sq. Mtr	1000	1000	1000
35	GRASS COVERED DRIVEWAY	Sq. Mtr	1000	1000	1000
36	GRASS COVERED DRIVEWAY	Sq. Mtr	1000	1000	1000
37	GRASS COVERED DRIVEWAY	Sq. Mtr	1000	1000	1000
38	GRASS COVERED DRIVEWAY	Sq. Mtr	1000	1000	1000
39	GRASS COVERED DRIVEWAY	Sq. Mtr	1000	1000	1000
40	GRASS COVERED DRIVEWAY	Sq. Mtr	1000	1000	1000
41	GRASS COVERED DRIVEWAY	Sq. Mtr	1000	1000	1000
42	GRASS COVERED DRIVEWAY	Sq. Mtr	1000	1000	1000
43	GRASS COVERED DRIVEWAY	Sq. Mtr	1000	1000	1000
44	GRASS COVERED DRIVEWAY	Sq. Mtr	1000	1000	1000
45	GRASS COVERED DRIVEWAY	Sq. Mtr	1000	1000	1000
46	GRASS COVERED DRIVEWAY	Sq. Mtr	1000	1000	1000
47	GRASS COVERED DRIVEWAY	Sq. Mtr	1000	1000	1000
48	GRASS COVERED DRIVEWAY	Sq. Mtr	1000	1000	1000
49	GRASS COVERED DRIVEWAY	Sq. Mtr	1000	1000	1000
50	GRASS COVERED DRIVEWAY	Sq. Mtr	1000	1000	1000

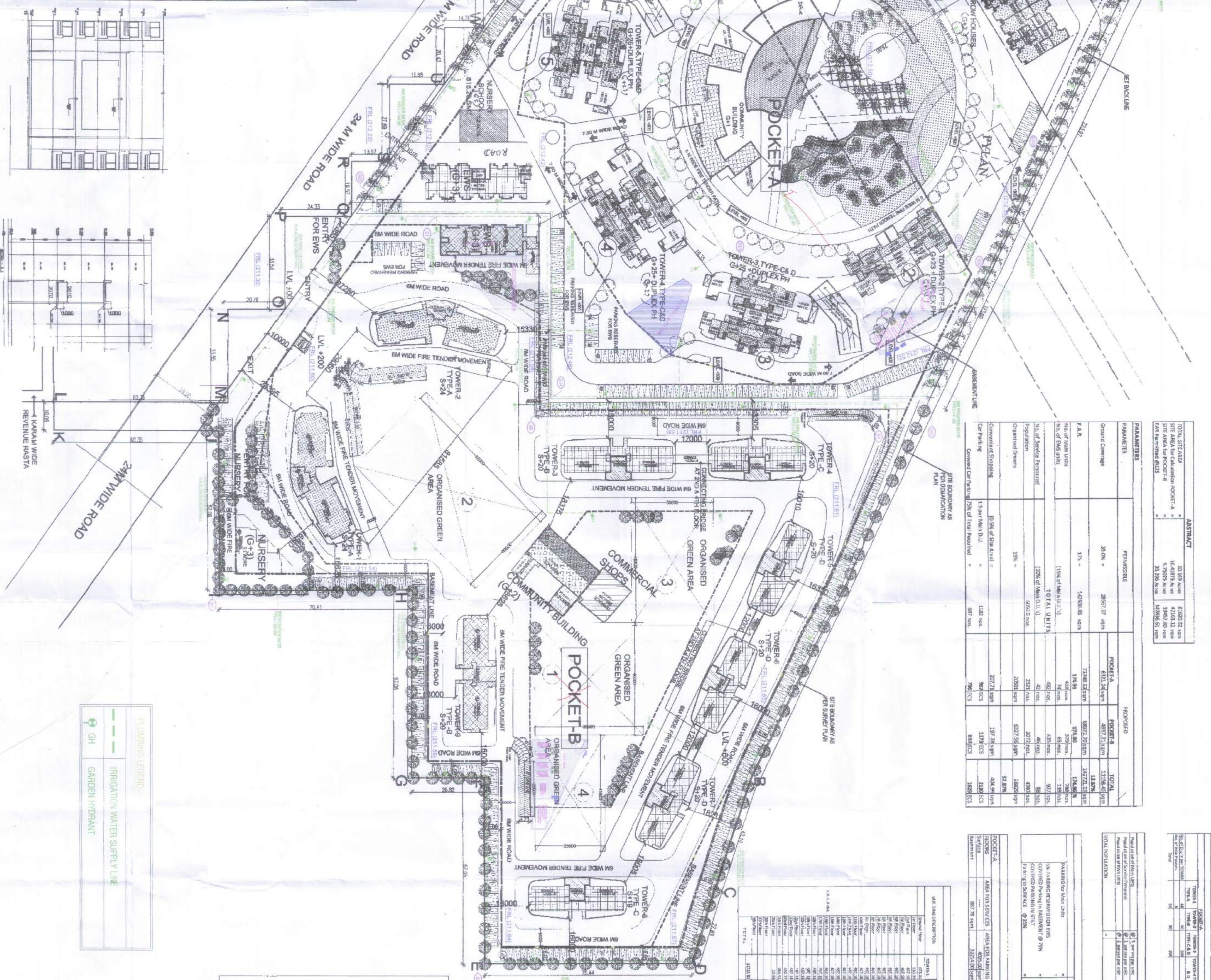

PARAMETER	PROPOSED	POCKET A	POCKET B	TOTAL
GRAND COVERAGE	36.0%	36.0%	36.0%	36.0%
NO. OF TOWERS	13	13	13	13
NO. OF UNITS	1000	1000	1000	1000
TOTAL AREA	10000	10000	10000	10000
NO. OF PARKING SPACES	1000	1000	1000	1000
NO. OF GREEN SPACES	1000	1000	1000	1000
NO. OF FIRE TENDERS	1000	1000	1000	1000
NO. OF WATER SUPPLY LINES	1000	1000	1000	1000
NO. OF IRRIGATION LINES	1000	1000	1000	1000
NO. OF GARDEN IRRIGATION	1000	1000	1000	1000
NO. OF COMMERCIAL SHOPS	1000	1000	1000	1000
NO. OF COMMUNITY BUILDINGS	1000	1000	1000	1000
NO. OF NURSERY PLOTS	1000	1000	1000	1000
NO. OF SCHOOLS	1000	1000	1000	1000
NO. OF PARKS	1000	1000	1000	1000
NO. OF PLAY AREAS	1000	1000	1000	1000
NO. OF SPORTS AREAS	1000	1000	1000	1000
NO. OF HEALTH CENTRES	1000	1000	1000	1000
NO. OF CLINICS	1000	1000	1000	1000
NO. OF PHARMACIES	1000	1000	1000	1000
NO. OF RESTAURANTS	1000	1000	1000	1000
NO. OF CATERING SERVICES	1000	1000	1000	1000
NO. OF RETAIL STORES	1000	1000	1000	1000
NO. OF SERVICE CENTRES	1000	1000	1000	1000
NO. OF OFFICES	1000	1000	1000	1000
NO. OF LABORATORIES	1000	1000	1000	1000
NO. OF STORAGE AREAS	1000	1000	1000	1000
NO. OF WAREHOUSES	1000	1000	1000	1000
NO. OF FACTORIES	1000	1000	1000	1000
NO. OF INDUSTRIAL PARKS	1000	1000	1000	1000
NO. OF BUSINESS CENTRES	1000	1000	1000	1000
NO. OF CONFERENCE CENTRES	1000	1000	1000	1000
NO. OF CONVENTIONS CENTRES	1000	1000	1000	1000
NO. OF EXHIBITION CENTRES	1000	1000	1000	1000
NO. OF TRAINING CENTRES	1000	1000	1000	1000
NO. OF RESEARCH CENTRES	1000	1000	1000	1000
NO. OF DEVELOPMENT CENTRES	1000	1000	1000	1000
NO. OF INNOVATION CENTRES	1000	1000	1000	1000
NO. OF DESIGN CENTRES	1000	1000	1000	1000
NO. OF ARCHITECTURE CENTRES	1000	1000	1000	1000
NO. OF ENGINEERING CENTRES	1000	1000	1000	1000
NO. OF SCIENCE CENTRES	1000	1000	1000	1000
NO. OF ARTS CENTRES	1000	1000	1000	1000
NO. OF CULTURE CENTRES	1000	1000	1000	1000
NO. OF HISTORY CENTRES	1000	1000	1000	1000
NO. OF GEOGRAPHY CENTRES	1000	1000	1000	1000
NO. OF MATHEMATICS CENTRES	1000	1000	1000	1000
NO. OF PHYSICS CENTRES	1000	1000	1000	1000
NO. OF CHEMISTRY CENTRES	1000	1000	1000	1000
NO. OF BIOLOGY CENTRES	1000	1000	1000	1000
NO. OF ENVIRONMENTAL CENTRES	1000	1000	1000	1000
NO. OF SOCIAL SCIENCES CENTRES	1000	1000	1000	1000
NO. OF HUMANITIES CENTRES	1000	1000	1000	1000
NO. OF LANGUAGE CENTRES	1000	1000	1000	1000
NO. OF MUSIC CENTRES	1000	1000	1000	1000
NO. OF DANCE CENTRES	1000	1000	1000	1000
NO. OF THEATRE CENTRES	1000	1000	1000	1000
NO. OF FILM CENTRES	1000	1000	1000	1000
NO. OF TELEVISION CENTRES	1000	1000	1000	1000
NO. OF RADIO CENTRES	1000	1000	1000	1000
NO. OF JOURNALISM CENTRES	1000	1000	1000	1000
NO. OF PUBLIC RELATIONS CENTRES	1000	1000	1000	1000
NO. OF MARKETING CENTRES	1000	1000	1000	1000
NO. OF SALES CENTRES	1000	1000	1000	1000
NO. OF CUSTOMER SERVICE CENTRES	1000	1000	1000	1000
NO. OF SUPPORT SERVICES CENTRES	1000	1000	1000	1000
NO. OF MAINTENANCE CENTRES	1000	1000	1000	1000
NO. OF SECURITY CENTRES	1000	1000	1000	1000
NO. OF CLEANING CENTRES	1000	1000	1000	1000
NO. OF WASTE MANAGEMENT CENTRES	1000	1000	1000	1000
NO. OF ENERGY CENTRES	1000	1000	1000	1000
NO. OF WATER SUPPLY CENTRES	1000	1000	1000	1000
NO. OF SEWERAGE CENTRES	1000	1000	1000	1000
NO. OF GAS SUPPLY CENTRES	1000	1000	1000	1000
NO. OF ELECTRICITY CENTRES	1000	1000	1000	1000
NO. OF TELECOMMUNICATIONS CENTRES	1000	1000	1000	1000
NO. OF DATA CENTRES	1000	1000	1000	1000
NO. OF SOFTWARE CENTRES	1000	1000	1000	1000
NO. OF HARDWARE CENTRES	1000	1000	1000	1000
NO. OF NETWORK CENTRES	1000	1000	1000	1000
NO. OF SYSTEMS CENTRES	1000	1000	1000	1000
NO. OF INTEGRATION CENTRES	1000	1000	1000	1000
NO. OF CONSULTING CENTRES	1000	1000	1000	1000
NO. OF RESEARCH AND DEVELOPMENT CENTRES	1000	1000	1000	1000
NO. OF INNOVATION CENTRES	1000	1000	1000	1000
NO. OF DESIGN CENTRES	1000	1000	1000	1000
NO. OF ARCHITECTURE CENTRES	1000	1000	1000	1000
NO. OF ENGINEERING CENTRES	1000	1000	1000	1000
NO. OF SCIENCE CENTRES	1000	1000	1000	1000
NO. OF ARTS CENTRES	1000	1000	1000	1000
NO. OF CULTURE CENTRES	1000	1000	1000	1000
NO. OF HISTORY CENTRES	1000	1000	1000	1000
NO. OF GEOGRAPHY CENTRES	1000	1000	1000	1000
NO. OF MATHEMATICS CENTRES	1000	1000	1000	1000
NO. OF PHYSICS CENTRES	1000	1000	1000	1000
NO. OF CHEMISTRY CENTRES	1000	1000	1000	1000
NO. OF BIOLOGY CENTRES	1000	1000	1000	1000
NO. OF ENVIRONMENTAL CENTRES	1000	1000	1000	1000
NO. OF SOCIAL SCIENCES CENTRES	1000	1000	1000	1000
NO. OF HUMANITIES CENTRES	1000	1000	1000	1000
NO. OF LANGUAGE CENTRES	1000	1000	1000	1000
NO. OF MUSIC CENTRES	1000	1000	1000	1000
NO. OF DANCE CENTRES	1000	1000	1000	1000
NO. OF THEATRE CENTRES	1000	1000	1000	1000
NO. OF FILM CENTRES	1000	1000	1000	1000
NO. OF TELEVISION CENTRES	1000	1000	1000	1000
NO. OF RADIO CENTRES	1000	1000	1000	1000
NO. OF JOURNALISM CENTRES	1000	1000	1000	1000
NO. OF PUBLIC RELATIONS CENTRES	1000	1000	1000	1000
NO. OF MARKETING CENTRES	1000	1000	1000	1000
NO. OF SALES CENTRES	1000	1000	1000	1000
NO. OF CUSTOMER SERVICE CENTRES	1000	1000	1000	1000
NO. OF SUPPORT SERVICES CENTRES	1000	1000	1000	1000
NO. OF MAINTENANCE CENTRES	1000	1000	1000	1000
NO. OF SECURITY CENTRES	1000	1000	1000	1000
NO. OF CLEANING CENTRES	1000	1000	1000	1000
NO. OF WASTE MANAGEMENT CENTRES	1000	1000	1000	1000
NO. OF ENERGY CENTRES	1000	1000	1000	1000
NO. OF WATER SUPPLY CENTRES	1000	1000	1000	1000
NO. OF SEWERAGE CENTRES	1000	1000	1000	1000
NO. OF GAS SUPPLY CENTRES	1000	1000	1000	1000
NO. OF ELECTRICITY CENTRES	1000	1000	1000	1000
NO. OF TELECOMMUNICATIONS CENTRES	1000	1000	1000	1000
NO. OF DATA CENTRES	1000	1000	1000	1000
NO. OF SOFTWARE CENTRES	1000	1000	1000	1000
NO. OF HARDWARE CENTRES	1000	1000	1000	1000
NO. OF NETWORK CENTRES	1000	1000	1000	1000
NO. OF SYSTEMS CENTRES	1000	1000	1000	1000
NO. OF INTEGRATION CENTRES	1000	1000	1000	1000
NO. OF CONSULTING CENTRES	1000	1000	1000	1000
NO. OF RESEARCH AND DEVELOPMENT CENTRES	1000	1000	1000	1000
NO. OF INNOVATION CENTRES	1000	1000	1000	1000
NO. OF DESIGN CENTRES	1000	1000	1000	1000
NO. OF ARCHITECTURE CENTRES	1000	1000	1000	1000
NO. OF ENGINEERING CENTRES	1000	1000	1000	1000
NO. OF SCIENCE CENTRES	1000	1000	1000	1000
NO. OF ARTS CENTRES	1000	1000	1000	1000
NO. OF CULTURE CENTRES	1000	1000	1000	1000
NO. OF HISTORY CENTRES	1000	1000	1000	1000
NO. OF GEOGRAPHY CENTRES	1000	1000	1000	1000
NO. OF MATHEMATICS CENTRES	1000	1000	1000	1000
NO. OF PHYSICS CENTRES	1000	1000	1000	1000
NO. OF CHEMISTRY CENTRES	1000	1000	1000	1000
NO. OF BIOLOGY CENTRES	1000			

PRODUCED BY AN AUTODESK EDUCATIONAL PRODUCT
COMBINED DETAILS FOR POCKET-A & B

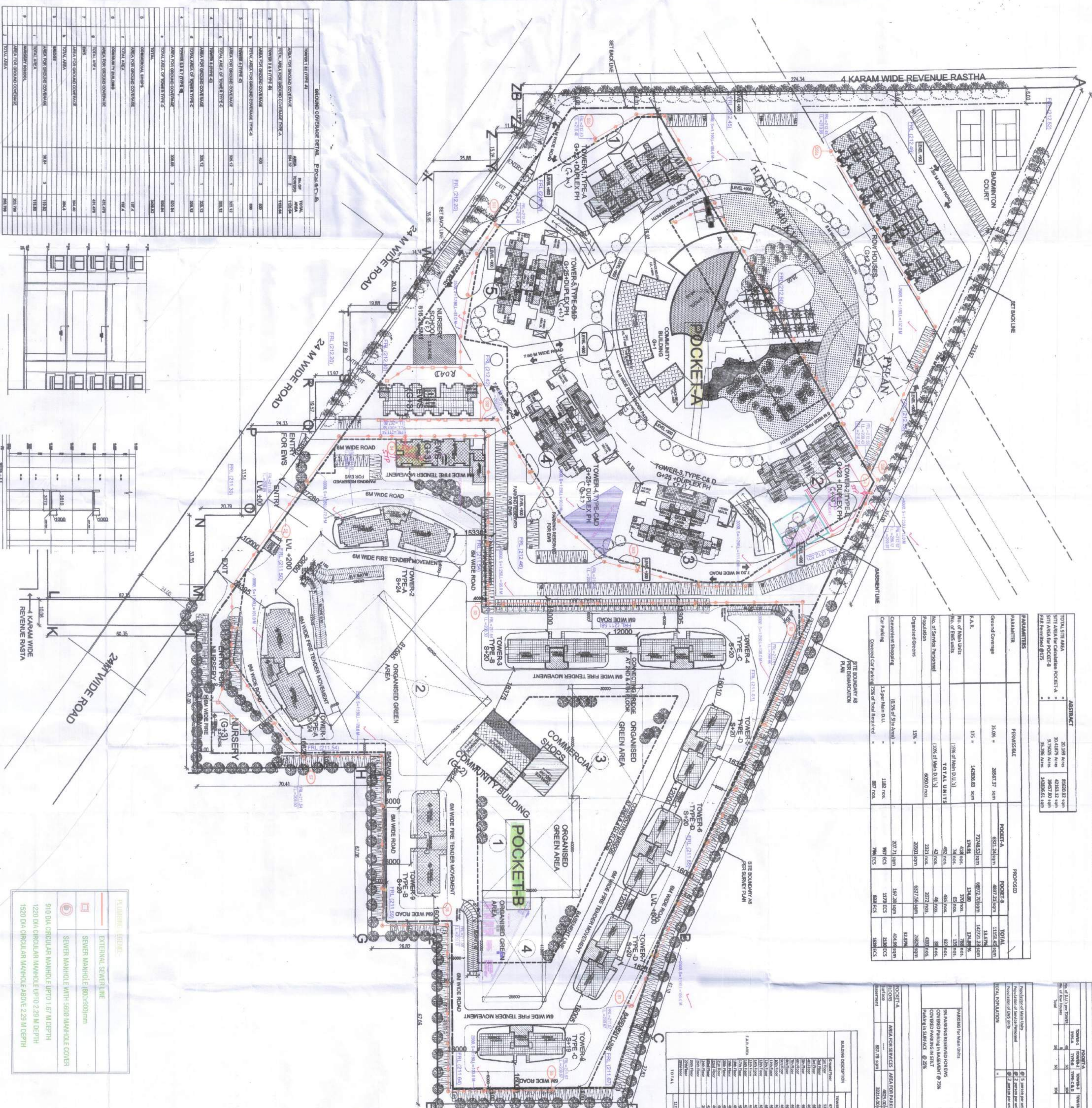

PARAMETERS	PROPOSED	POCKET-A	POCKET-B	TOTAL
Ground Coverage	32.06%	28.81%	35.16%	31.99%
F.A.S.	175	140	135	275
No. of towers	1	1	1	2
No. of floors	17	17	17	17
No. of floors above ground	15	15	15	15
No. of floors below ground	2	2	2	2
Total area	12000 sqm	12000 sqm	12000 sqm	24000 sqm
Population	6000	6000	6000	12000
Optimized opens	15%	15%	15%	15%
Conversion Shopping	0.5%	0.5%	0.5%	0.5%
Covered Car Parking	1.2 per room	1.2 per room	1.2 per room	1.2 per room
Car Parking	148 nos.	148 nos.	148 nos.	296 nos.
Covered Car Parking	887 nos.	887 nos.	887 nos.	1774 nos.

NO.	DESCRIPTION	UNIT	NO.	TOTAL
1	TOWER 1A TYPE-A	SQM	1	12000
2	TOWER 1B TYPE-B	SQM	1	12000
3	TOWER 1C TYPE-C	SQM	1	12000
4	TOWER 1D TYPE-D	SQM	1	12000
5	COMMUNITY BUILDING	SQM	1	12000
6	COMMERCIAL SHOPS	SQM	1	12000
7	ORGANISED GREEN AREA	SQM	1	12000
8	ROADS	SQM	1	12000
9	LANDSCAPING	SQM	1	12000
10	UTILITIES	SQM	1	12000
11	OTHERS	SQM	1	12000
12	TOTAL	SQM	12	144000



POCKET	TOWER TYPE	FLOOR	AREA (SQM)	VOLUME (CU M)
POCKET-A	TYPE-A	1	12000	12000
		2	12000	24000
		3	12000	36000
	TYPE-B	1	12000	12000
		2	12000	24000
		3	12000	36000
POCKET-B	TYPE-C	1	12000	12000
		2	12000	24000
		3	12000	36000
	TYPE-D	1	12000	12000
		2	12000	24000
		3	12000	36000
TOTAL			144000	1440000

NO.	DESCRIPTION	UNIT	NO.	TOTAL
1	POCKET-A	SQM	1	12000
2	POCKET-B	SQM	1	12000
3	COMMUNITY BUILDING	SQM	1	12000
4	COMMERCIAL SHOPS	SQM	1	12000
5	ORGANISED GREEN AREA	SQM	1	12000
6	ROADS	SQM	1	12000
7	LANDSCAPING	SQM	1	12000
8	UTILITIES	SQM	1	12000
9	OTHERS	SQM	1	12000
10	TOTAL	SQM	10	120000

POCKET	FLOOR	AREA (SQM)	VOLUME (CU M)
POCKET-A	1	12000	12000
	2	12000	24000
	3	12000	36000
POCKET-B	1	12000	12000
	2	12000	24000
	3	12000	36000
TOTAL		144000	1440000

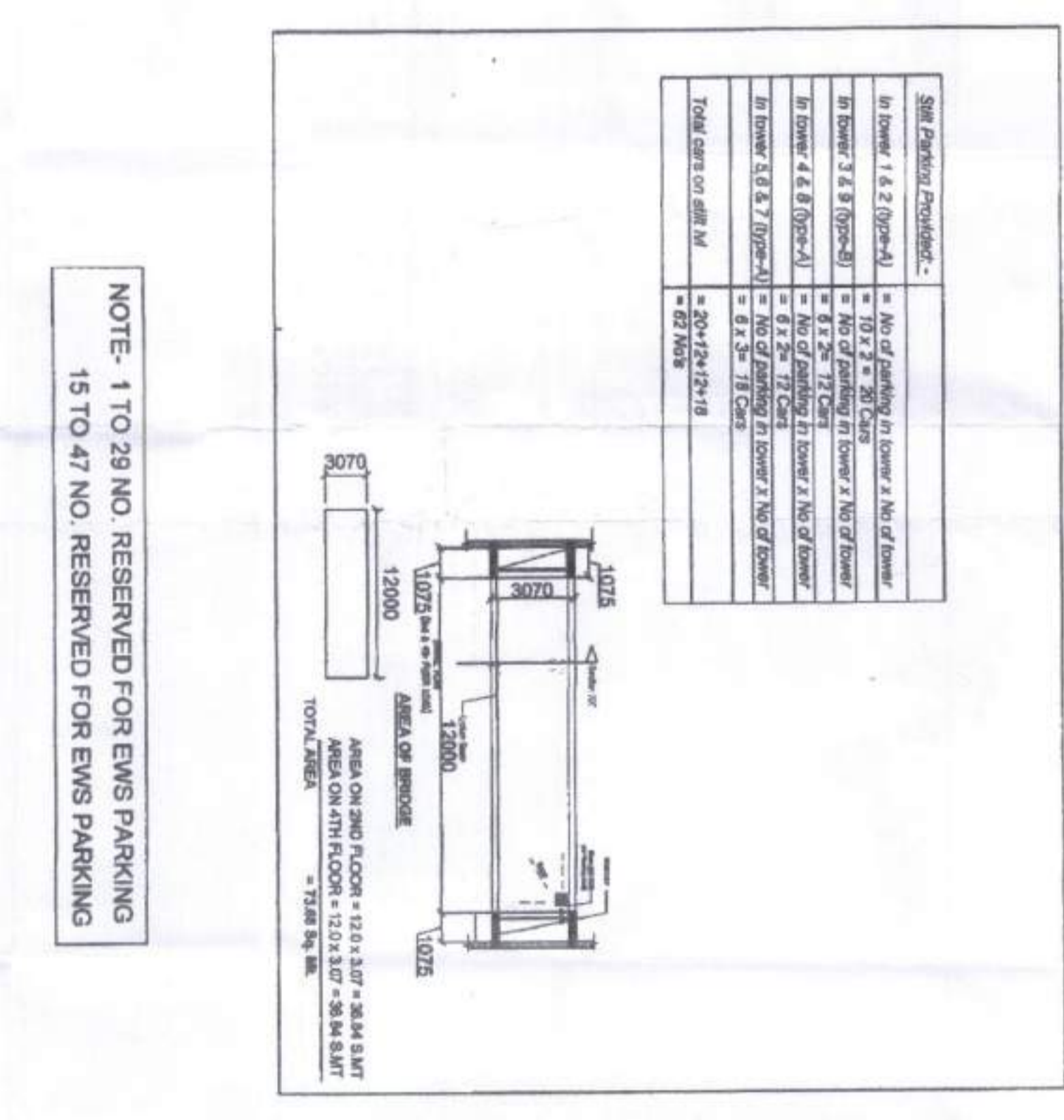

NO.	DESCRIPTION	UNIT	NO.	TOTAL
1	POCKET-A	SQM	1	12000
2	POCKET-B	SQM	1	12000
3	COMMUNITY BUILDING	SQM	1	12000
4	COMMERCIAL SHOPS	SQM	1	12000
5	ORGANISED GREEN AREA	SQM	1	12000
6	ROADS	SQM	1	12000
7	LANDSCAPING	SQM	1	12000
8	UTILITIES	SQM	1	12000
9	OTHERS	SQM	1	12000
10	TOTAL	SQM	10	120000

NOTE - 1 TO 20 NO. RESERVED FOR EMS PARKING
15 TO 47 NO. RESERVED FOR EMS PARKING

PRODUCED BY AN AUTODESK EDUCATIONAL PRODUCT

COMBINED DETAILS FOR POCKET-A & B

ABSTRACT	
TOTAL SITE AREA	81020.02 SQ. METERS
PLANNED AREA	42500.00 SQ. METERS
NET AREA FOR POCKET-A	20110.00 SQ. METERS
NET AREA FOR POCKET-B	22390.00 SQ. METERS

PARAMETERS	
Ground Coverage	30.06%
F.A.R.	1.75
Nos. of main units	10 (101 to 1010)
Nos. of TMS units	1000
Nos. of service apartments	100
Organized Greens	15%

PROVIDED	
POCKET-A	6502.20 SQ. METERS
POCKET-B	4277.20 SQ. METERS
TOTAL	10779.40 SQ. METERS

PARAMETERS	
Ground Coverage	30.06%
F.A.R.	1.75
Nos. of main units	10 (101 to 1010)
Nos. of TMS units	1000
Nos. of service apartments	100
Organized Greens	15%

- NOTES**
- DIMENSIONS ARE NOT TO BE SCALED.
 - ALL DIMENSIONS ARE IN METERS.
 - ALL ELECTRICAL INSTALLATIONS SHALL BE AS PER PROVISIONS OF NBC.
 - FIRE FIGHTING PROVISIONS SHALL BE AS PER PROVISIONS OF NBC.
 - BOUNDARY WALL AND GATE AS PER STANDARDS.
 - RAIN WATER HARVESTING SYSTEM SHALL BE PROVIDED WITH STORAGE TANK WITH COVER.
 - ALL WINDOWS & VENTILATORS ARE OPENABLE.
 - ALL MECHANICALLY VENTILATED & ARTIFICIALLY LIT TOILET PROVIDED WITH 24HR POWER BACKUP.

POPULATION	
POCKET-A	1500
POCKET-B	1500
TOTAL	3000

VEHICLES	
POCKET-A	60
POCKET-B	60
TOTAL	120

TOTAL TOURNAMENT	
POCKET-A	600
POCKET-B	600
TOTAL	1200

DETAILS OF PARKING & BASEMENT	
POCKET-A	100
POCKET-B	100
TOTAL	200

NO.	DESCRIPTION	UNIT	AREA	VOLUME	REMARKS
1	POCKET-A	SQ. METERS	6502.20		
2	POCKET-B	SQ. METERS	4277.20		
3	TOTAL	SQ. METERS	10779.40		

WWW.SKY SCANS

POCKET	PERMITTED PERMITTED (PROVIDED)	PERMITTED PERMITTED (PROVIDED)
POCKET-A	816.30 SMT	833.18 SMT
POCKET-B	161.25 SMT	164.31 SMT
TOTAL	977.55 SMT	997.49 SMT

PLUMBING LEGENDS

EXTERNAL STORM WATER LINE
CATCH BASIN (900x600)mm
STORM WATER MANHOLE (9100)mm
STORM WATER MANHOLE WITH 500 PERFORATED MANHOLE COVER
D.T. DISPERSION TRENCH (2500 x 400)mm
D.C. DESILTING CHAMBER (1000 x 2000)mm
910 DIA CIRCULAR MANHOLE UP TO 1.67 M DEPTH
1220 DIA CIRCULAR MANHOLE UP TO 2.25 M DEPTH
1520 DIA CIRCULAR MANHOLE ABOVE 2.25 M DEPTH

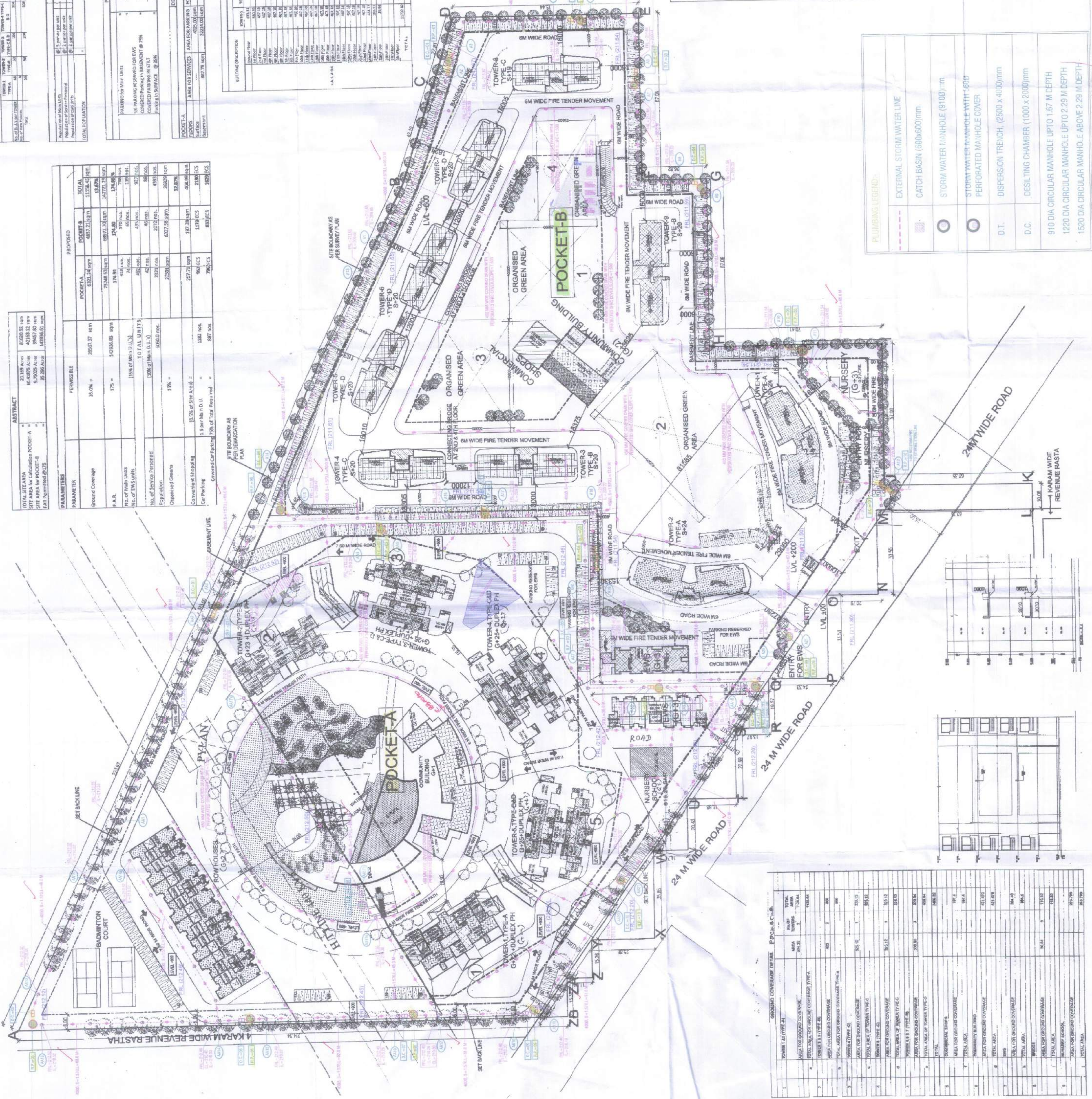
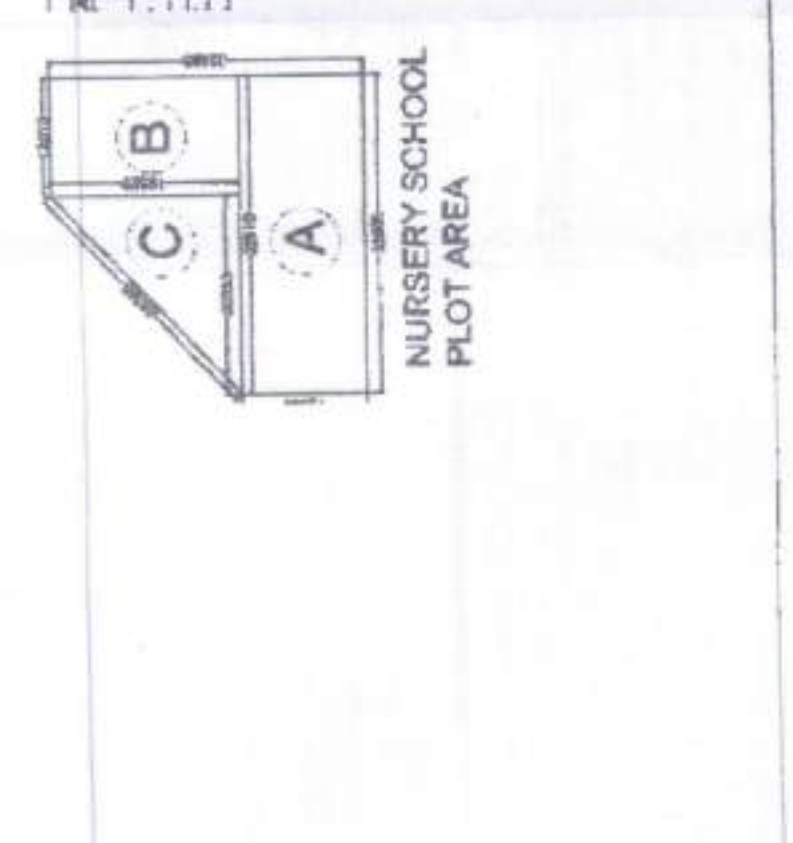

GROUND COVERAGE DETAIL

NO.	DESCRIPTION	UNIT	AREA	VOLUME	REMARKS
1	TOWER-A	SQ. METERS	6502.20		
2	TOWER-B	SQ. METERS	4277.20		
3	TOTAL	SQ. METERS	10779.40		

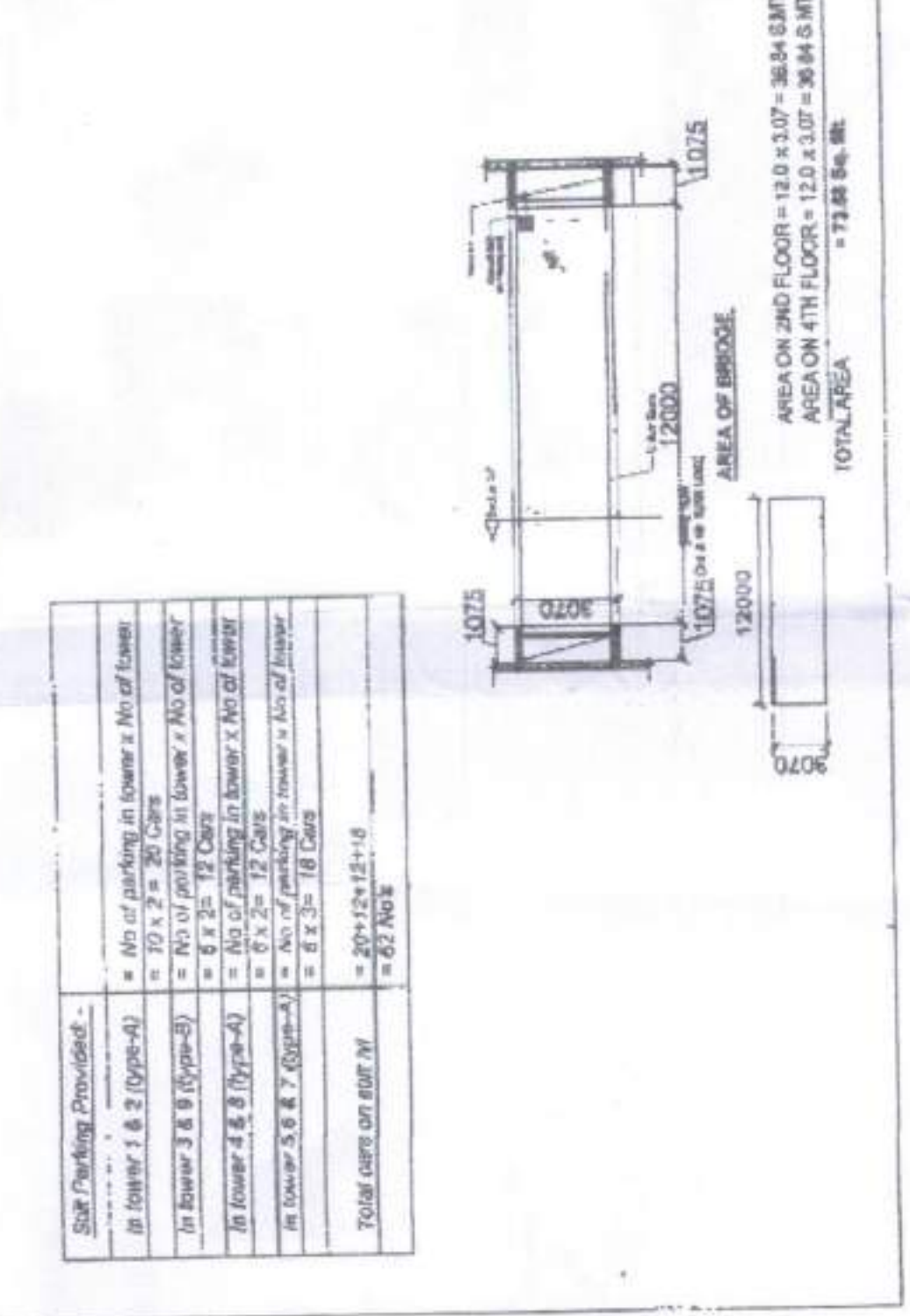

MASTER SITE LAYOUT

NO.	DESCRIPTION	UNIT	AREA	VOLUME	REMARKS
1	Plot Area	SQ. METERS	81020.02		
2	Planned Area	SQ. METERS	42500.00		
3	Net Area	SQ. METERS	20110.00		
4	Net Area	SQ. METERS	22390.00		
5	TOTAL	SQ. METERS	10779.40		

PROJECT: PROPOSED BUILDING PLAN OF GROUP HOUSING FOR AREA MEASURING 1,195 x 8,204 SQ. METERS ACROSS LOCATED AT LOT NO. 80, 80/2 DATED 17/8/2012 IN SECTOR 103 GUWAHATI MANSAR KIRAN PVT. LTD. AND OTHERS IN COLLABORATION WITH CHARTERED SURVEYORS.

DATE: 15/05/2023

SCALE: 1:500

SP-1.1

ROADS

NOTES
1. DIMENSIONS ARE NOT TO BE SCALED.
2. ALL DIMENSIONS ARE IN METERS.
3. ALL ELECTRICAL INSTALLATIONS SHALL BE AS PER RELEVANT IBC PROVISIONS.
4. FIRE FIGHTING SAFETY PROVISIONS SHALL BE AS PER RELEVANT IBC PROVISIONS.
5. BOUNDARY WALL AND GATE AS PER STANDARDS.
6. RAIN WATER HARVESTING SYSTEM SHALL BE PROVIDED AS PER CENTRAL GROUND WATER AUTHORITY NORMS/HARYANA GOVT.
7. ALL WINDOWS & VENTILATORS ARE OPERABLE.
8. ELECTRICAL PANELS SHALL BE LOCATED TO AVOID TOILET PROVIDED WITH 24Hr POWER BACKUP.

POCKET-A	POCKET-B	POCKET-C	POCKET-D	POCKET-E	POCKET-F
2000	2000	2000	2000	2000	2000
1000	1000	1000	1000	1000	1000
1000	1000	1000	1000	1000	1000
1000	1000	1000	1000	1000	1000

POCKET-A	POCKET-B	POCKET-C	POCKET-D	POCKET-E	POCKET-F	TOTAL PAVING
1500	1500	1500	1500	1500	1500	9000
...

POCKET-A	POCKET-B	POCKET-C	POCKET-D	POCKET-E	POCKET-F	TOTAL
...

POCKET-A	POCKET-B	POCKET-C	POCKET-D	POCKET-E	POCKET-F	TOTAL
...
...
...

NON-SEAL CANALS

POCKET-A	POCKET-B
POCKET-A	POCKET-B
...	...

COMBINED DETAILS FOR POCKET-A & B

PARAMETER	POCKET-A	POCKET-B	TOTAL
Ground Coverage
...

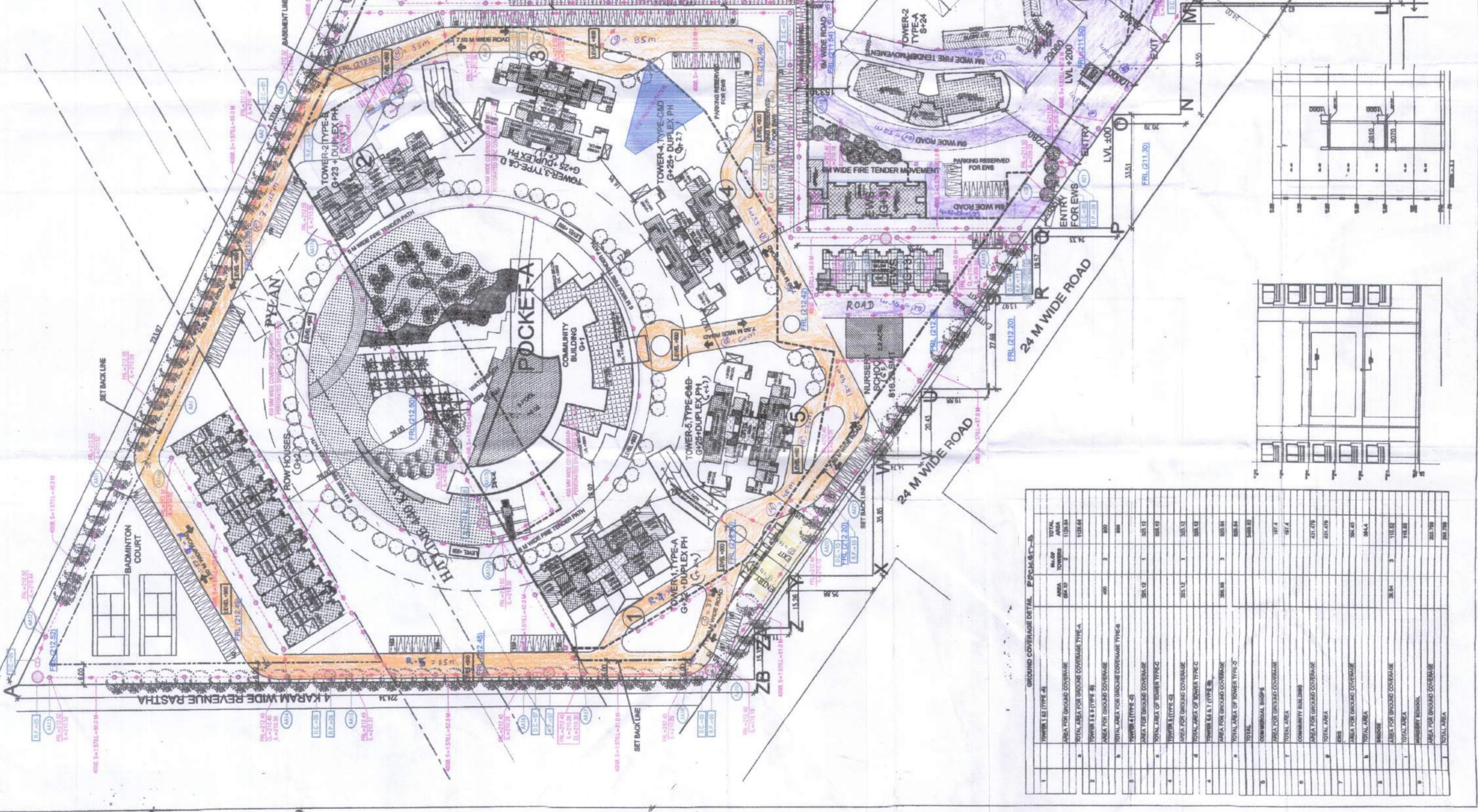

POCKET-A	POCKET-B	POCKET-C	POCKET-D	POCKET-E	POCKET-F	TOTAL
...

MASTER SITE LAYOUT ROADS

SCALE	DATE	DATE
1:1000

DEVELOPED BY: *[Signature]*

PROJECT: PROPOSED BUILDING PLAN OF GROUP HOUSING FOR AREA MEASURING 11.875 x 6.254 x 20.169 ACRES (LICENSE NO. 299 OF 2007 DATED 17/11/2008 IN SECTOR-108 COLONIA MANSAR KIRAN PVT. LTD. AND OTHERS IN COLLABORATION WITH CHINTELS INDIA LTD.

PLUMBING LEGEND

SYMBOL	DESCRIPTION
...	EXTERNAL STORM WATER LINE
...	CATCH BASIN (600x600)mm
...	STORM WATER MANHOLE (910)mm
...	STORM WATER MANHOLE WITH 5600 PERFORATED MANHOLE COVER
...	DISPERSION TRENCH (2500 x 4000)mm
...	D.T.
...	D.C.
...	910 DIA CIRCULAR MANHOLE UPTO 1.67 M DEPTH
...	1220 DIA CIRCULAR MANHOLE UPTO 2.29 M DEPTH
...	1520 DIA CIRCULAR MANHOLE ABOVE 2.29 M DEPTH

NOTE - 1 TO 29 NO. RESERVED FOR EWS PARKING
15 TO 47 NO. RESERVED FOR EWS PARKING

NO.	AREA
1	...
2	...
...	...

STAIR PLAN

LEVEL	AREA
LVL +200	...
LVL +100	...
LVL 000	...
LVL -100	...

SECTION

SECTION	DESCRIPTION
A-A	...
B-B	...
C-C	...
D-D	...
E-E	...
F-F	...
G-G	...
H-H	...
I-I	...
J-J	...
K-K	...
L-L	...
M-M	...
N-N	...
O-O	...
P-P	...
Q-Q	...
R-R	...
S-S	...
T-T	...
U-U	...
V-V	...
W-W	...
X-X	...
Y-Y	...
Z-Z	...