

Checked and found ok for Public Health (Internal) Service why subject to comments in forwarding letter No. SE/HQ/.....D/2016/115 dated 19/07/16

Supervising Engineer (I/O) (DINESH KUMAR) S.D.

CHAIRMAN B.P.C. C.P.(H)

MEMBER B.P.C. S.P.(F)

SECRETARY B.P.C. S.P.(P)

MEMBER B.P.C. S.P.(H)

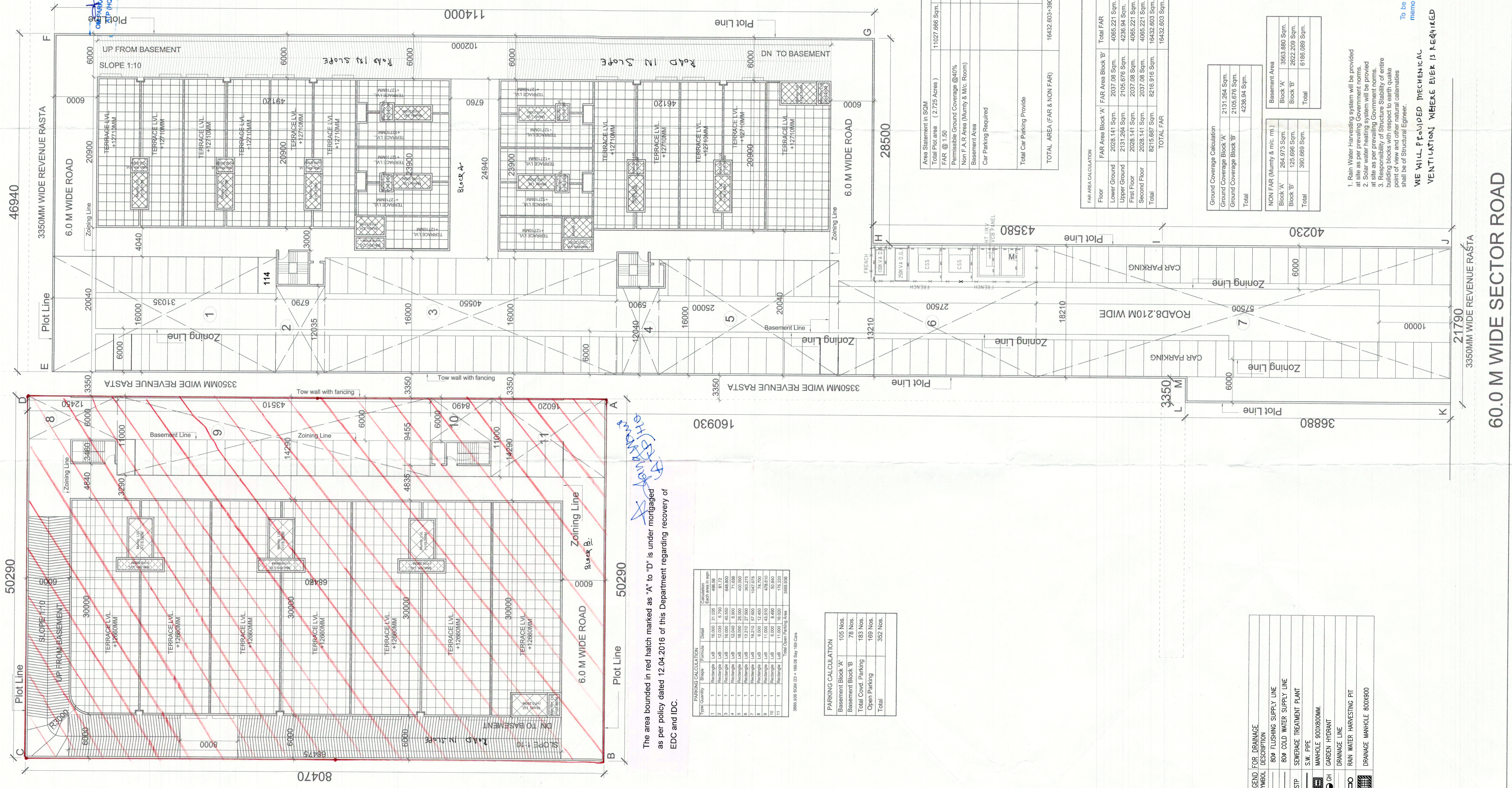

The area bounded in red hatch marked as "A" to "D" is under mortgaged as per policy dated 12.04.2016 of this Department regarding recovery of EDC and IDC.

**PARKING CALCULATION**

Type	Quantity	Shape	Formula	Detail	Calculation	Area (sqm)
1	1	Rectangle	LxB	16,000 x 31,005	496,080	496,080
2	1	Rectangle	LxB	12,035 x 6,700	80,634	80,634
3	1	Rectangle	LxB	16,000 x 40,550	648,800	648,800
4	1	Rectangle	LxB	12,035 x 5,500	66,192	66,192
5	1	Rectangle	LxB	13,210 x 27,500	363,275	363,275
6	1	Rectangle	LxB	18,210 x 57,500	1,047,075	1,047,075
7	1	Rectangle	LxB	6,000 x 12,450	74,700	74,700
8	1	Rectangle	LxB	11,000 x 43,510	478,610	478,610
9	1	Rectangle	LxB	11,000 x 18,000	198,000	198,000
10	1	Rectangle	LxB	11,000 x 18,000	198,000	198,000
11	1	Rectangle	LxB	11,000 x 18,000	198,000	198,000
Total Open Parking Area					3688,838	3688,838

3688.838 SQM (23 = 160.88 Bay 150 Cars)

**PARKING CALCULATION**

Basement Block 'A'	105 Nos.
Basement Block 'B'	78 Nos.
Total Covd. Parking	183 Nos.
Open Parking	169 Nos.
Total	352 Nos.

**Area Statement in SQM**

Area Statement in SQM	Permissible Area	Proposed Area	%
Total Plot area (2.725 Acres)	11027.666 Sqm	16432.603 Sqm	1.490
FAR @ 1.50	16541.499 Sqm	16432.603 Sqm	1.490
Permissible Ground Coverage @40%	4411.066 Sqm	4236.94 Sqm	36.421
Non F.A.R Area (Mummy & M/c. Room)		390.689 Sqm	
Basement Area		6186.089 Sqm	
Car Parking Required		1.6CS Per 50 Sqm. Of Covered Area Per App. Zoning 16432.603/50 = 328.65 SAY = 329 CARS	
Total Car Parking Provide		Open = 169 Cars Covd. = 183 Cars Total = 352 Cars	
TOTAL AREA (FAR & NON FAR)	16432.603+390.689+6186.089	23009.361 Sqm	

**FAR AREA CALCULATION**

Floor	FAR Area Block 'A'	FAR Area Block 'B'	Total FAR
Lower Ground	2028.141 Sqm.	2037.08 Sqm.	4065.221 Sqm.
Upper Ground	2131.264 Sqm.	2105.676 Sqm.	4236.94 Sqm.
First Floor	2028.141 Sqm.	2037.08 Sqm.	4065.221 Sqm.
Second Floor	2028.141 Sqm.	2037.08 Sqm.	4065.221 Sqm.
Total	8215.587 Sqm.	8216.916 Sqm.	16432.603 Sqm.

**Ground Coverage Calculation**

Ground Coverage Block 'A'	Ground Coverage Block 'B'	Total
2131.264 Sqm.	2105.676 Sqm.	4236.94 Sqm.
4236.94 Sqm.	4236.94 Sqm.	8473.88 Sqm.

**NON FAR (Mummy & m/c. rm.)**

Block 'A'	Block 'B'	Total
264.973 Sqm.	125.696 Sqm.	390.669 Sqm.
3663.880 Sqm.	2622.209 Sqm.	6186.089 Sqm.

**LEGEND FOR DRAINAGE SYMBOL DESCRIPTION**

80# FLUSHING SUPPLY LINE
80# COLD WATER SUPPLY LINE
SEWERAGE TREATMENT PLANT
S.W. PIPE
MANHOLE 900X600MM.
GARDEN HYDRANT
DRAINAGE LINE
RAIN WATER HARVESTING PIT
DRAINAGE MANHOLE 800X600

1. Rain Water Harvesting system will be provided at site as per prevailing Government norms.
2. Solar water heating system will be provided at site as per prevailing Government norms.
3. Responsibility of Structure Stability of entire building blocks with respect to earth quake point of view and other natural calamities shall be of Structural Engineer.

SACTIONED

To be read in conjunction with memo no. 27924 Dtd 27/11/2016

WE WILL PROVIDE MECHANICAL VENTILATION WHERE EVER IS REQUIRED

Architects Sign.

Architects  
AAKRITI CONSTRUCTION CONSULTANT  
Architects Engineers & Int. Designers  
SCF 218, First Floor, HUDA Market, Sector-9  
Faridabad -121004  
PH. NO:- 0-9212209774, 0-9999104030