

GROUP HOUSING (FUTURE EXPANSION)

Superintending Engineer,
 HUDA Circle, Rohtak

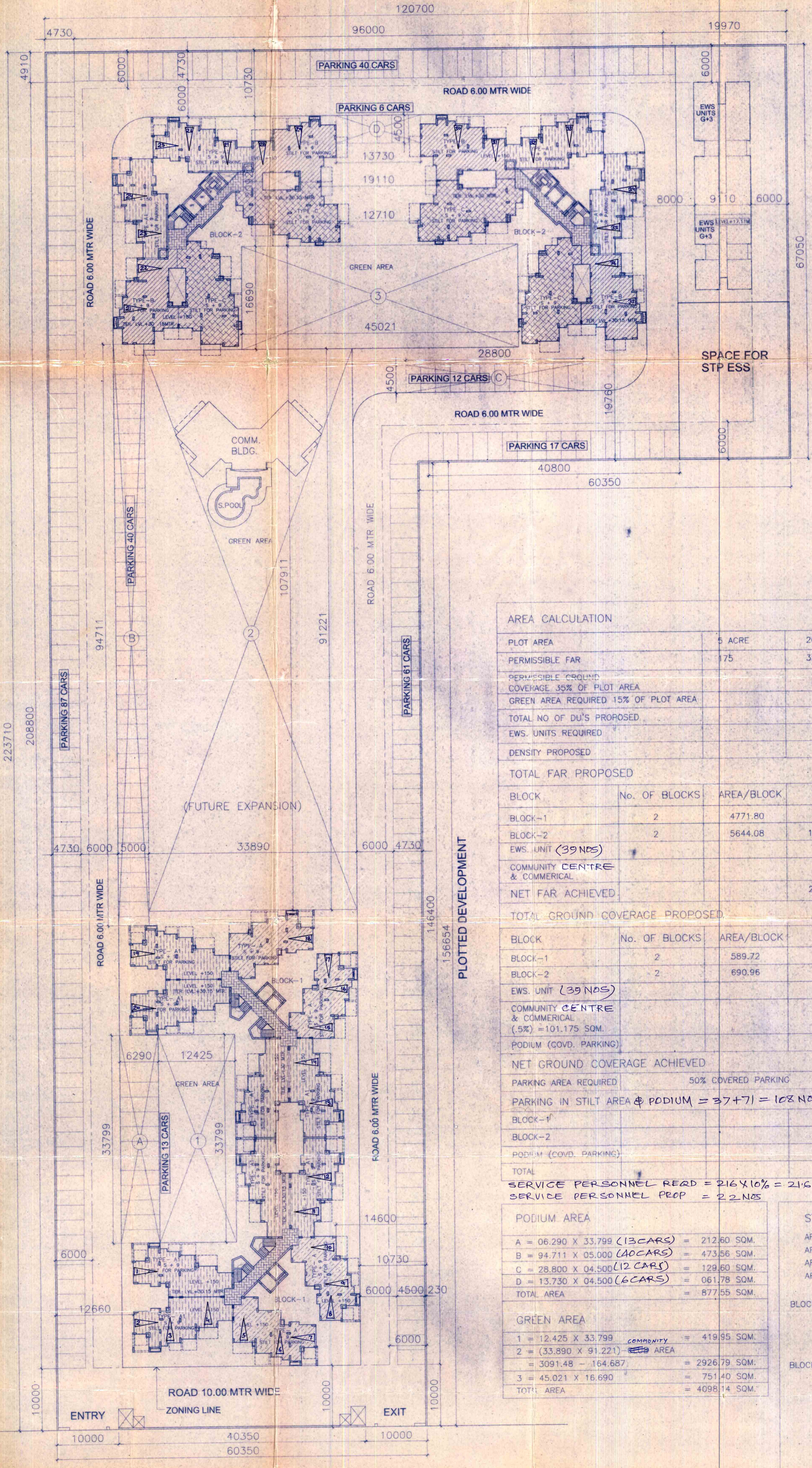

AREA CALCULATION

TYPE OF UNIT	AREA/DU	NO. OF DU'S COVERED FLOOR	AREA OF TOTAL FLOORS (sqm)	NO. OF DU'S PER BLOCK	TOTAL AREA (sqm)	FAR AREA (sqm)
TYPE-A	88.80	1	177.20	18	1963.440	A
TYPE-A1	87.26	1	349.04	36	3141.300	B
UPPER AREA AT GROUND FLR	10.74	25	268.50		66.900	C
NET FAR AREA FOR ONE BLOCK					4771.800	
GROUND COVERAGE FOR TYPE A X 2					668.720	
GROUND COVERAGE FOR TYPE A1 X 4						
TOTAL NO OF DU'S				54		
PROPOSED NO OF BLOCKS				2		
FAR OF TWO BLOCKS					9543.600	
GROUND COVERAGE AT TWO BLOCKS					1179.440	

TYPE OF UNIT	AREA/DU	NO. OF DU'S COVERED FLOOR	AREA OF TOTAL FLOORS (sqm)	NO. OF DU'S PER BLOCK	TOTAL AREA (sqm)	FAR AREA (sqm)
TYPE-A1	87.26	1	174.52	18	1570.680	A
TYPE-B	87.70	1	195.40	18	1758.600	B
TYPE-C	124.61	2	249.22	18	2262.960	C
UPPER AREA AT GROUND FLR	10.74	12	128.88		71.920	D
NET FAR AREA FOR ONE BLOCK					664.000	
GROUND COVERAGE FOR TYPE A1 X 2					668.560	
GROUND COVERAGE FOR TYPE B X 2						
GROUND COVERAGE FOR TYPE C X 2						
TOTAL NO OF DU'S				54		
PROPOSED NO OF BLOCKS				2		
FAR OF TWO BLOCKS					1328.280	
GROUND COVERAGE AT TWO BLOCKS					1381.920	

THE USE OF SOLAR WATER HEATING SYSTEM AS PER NORMS SPECIFIED BY HAREDA WILL BE PROVIDED AND SHALL BE MADE OPERATIONAL IN EACH BUILDING BEFORE APPLYING FOR AN OCCUPATION CERTIFICATE.

AREA CALCULATION

PLOT AREA	5 ACRE	20235.000 SQM.	
PERMISSIBLE FAR	175	35411.250 SQM.	
PERMISSIBLE GROUND COVERAGE 35% OF PLOT AREA		7082.250 SQM.	
GREEN AREA REQUIRED 15% OF PLOT AREA		3035.250 SQM.	
TOTAL NO OF DU'S PROPOSED		216 DU'S	
EWS. UNITS REQUIRED		39 UNITS	
DENSITY PROPOSED		1202 PERSONS	
TOTAL FAR PROPOSED			
BLOCK	No. OF BLOCKS	AREA/BLOCK	TOTAL AREA
BLOCK-1	2	4771.80	9543.600 SQM.
BLOCK-2	2	5644.08	11288.160 SQM.
EWS. UNIT (39 NOS)			750.630 SQM.
COMMUNITY CENTRE & COMMERCIAL			658.748 SQM.
NET FAR ACHIEVED			22241.138 SQM. 109.81%
TOTAL GROUND COVERAGE PROPOSED			
BLOCK	No. OF BLOCKS	AREA/BLOCK	TOTAL AREA
BLOCK-1	2	589.72	1179.440 SQM.
BLOCK-2	2	690.96	1381.920 SQM.
EWS. UNIT (39 NOS)			268.830 SQM.
COMMUNITY CENTRE & COMMERCIAL (5%) = 101.175 SQM.			164.687 SQM.
PODIUM (COVD. PARKING)			877.550 SQM.
NET GROUND COVERAGE ACHIEVED			3872.437 SQM. (19.14 %)
PARKING AREA REQUIRED 50% COVERED PARKING			108 DU'S
PARKING IN STILT AREA & PODIUM = 37+71 = 108 NOS.			
BLOCK-1			1045.52 SQM.
BLOCK-2			1238.28 SQM.
PODIUM (COVD. PARKING)			877.55 SQM.
TOTAL			3161.35 SQM.
SERVICE PERSONNEL REQD = 216 X 10% = 21.6 SAY 22 NOS			
SERVICE PERSONNEL PROP = 2.2 NOS			

PODIUM AREA

A = 06.290 X 33.799 (13CARS)	= 212.60 SQM.
B = 94.711 X 05.000 (10CARS)	= 473.56 SQM.
C = 28.800 X 04.500 (12CARS)	= 129.60 SQM.
D = 13.730 X 04.500 (6CARS)	= 061.78 SQM.
TOTAL AREA	= 877.55 SQM.

GREEN AREA

1 = 12.425 X 33.799 COMMUNITY	= 419.95 SQM.
2 = (33.890 X 91.221) - 164.687	= 2926.79 SQM.
3 = 45.021 X 16.690	= 751.40 SQM.
TOTAL AREA	= 4098.14 SQM.

STILT AREA = SAME AS UNIT AREA

AREA OF TYPE A	= 88.86 SQM.
AREA OF TYPE A1	= 87.26 SQM.
AREA OF TYPE B	= 97.70 SQM.
AREA OF TYPE C	= 124.61 SQM.
BLOCK-1 STILT AREA = (TYPE A X 2) 88.86 X 2 = 177.72 SQM.	
= (TYPE A1 X 4) 87.26 X 4 = 349.04 SQM.	
TOTAL AREA	= 522.76 SQM.
BLOCK-2 STILT AREA = (TYPE A1 X 2) 87.26 X 2 = 174.52 SQM.	
= (TYPE B X 2) 97.70 X 2 = 195.40 SQM.	
= (TYPE C X 2) 124.61 X 2 = 249.22 SQM.	
TOTAL AREA	= 619.14 SQM.
BLOCK-1 STILT AREA X 2 = 522.76 X 2 = 1045.52 SQM.	
BLOCK-2 STILT AREA X 2 = 619.14 X 2 = 1238.28 SQM.	