

SECTION A-A

ELEVATION-C

SECTION B-B

SUBMISSION DRAWING

CLIENT

M/S. SIGNATURE GLOBAL (INDIA) PRIVATE LIMITED Signature
Global, 1308 Dr. Gopal Das Building 28 Barakhamba
Road C.P. New Delhi

PROJECT TITLE

PROPOSED BUILDING PLAN OF AFFORDABLE GROUP HOUSING

COLONY FOR AN AREA MEASURING 5.00 ACRES (LICENCE NO. 89 OF 2019 DATED 02/08/2019) IN SECTOR-89, GURUGRAM

MANESAR URBAN COMPLEX BEING DEVELOPED BY RAMPRAS SARE LAND HOLDING COMPANY ONE PVT.LTD. AND OTHERS

COLLABORATION WITH SIGNATURE GLOBAL INDIA PVT.LTD

MEP Consultant:
Consummate Engineering Services Pvt.

cespi
B-67, Sector 67, Noida,
Uttar Pradesh - 201301
Tel: +91-0120-2303600

E-mail: malgocsi@in
Barbara Conduitt

NNC
NC DESIGN INTERNATIONAL
G-70, 2nd floor, Jiean Plaza, Main Street Yuhai Road,
Qinhuo, Ningbo, Zhejiang, 315000

Call: +91-11-26940734/5/6/7 Fax: +91-11-26940736
E-mail: mwc_consultants@hotmail.com

P K & ASSOCIATES

ARCHITECTS, ENGINEERS & PLANNERS
R-33 GREEN PARK MAIN NEW DELHI - 110016 INDIA

Tel: 2098-3150, 2651-6751, 2656-7367
Fax: (011) 2668-2540 E-mail: na.architects@gmail.com

ARCHITECT'S SIGNATURE	OWNER'S SIGNATURE
-----------------------	-------------------

THE GLOBAL MONITOR

Signature: _____

KOHLT GARG
CA/94/17868

DRAWING TITLE (SUBMISSION DRAWING)	DRAWING NO.
------------------------------------	-------------

TOWER T1

2BHK + STORE (G+8)
ELEVATIONS AND SECTIONS

SCALE 4:100	DATE SEP 2019
-------------	---------------

SCALE - 1:100	DATE - JULY 2017	
---------------	------------------	--

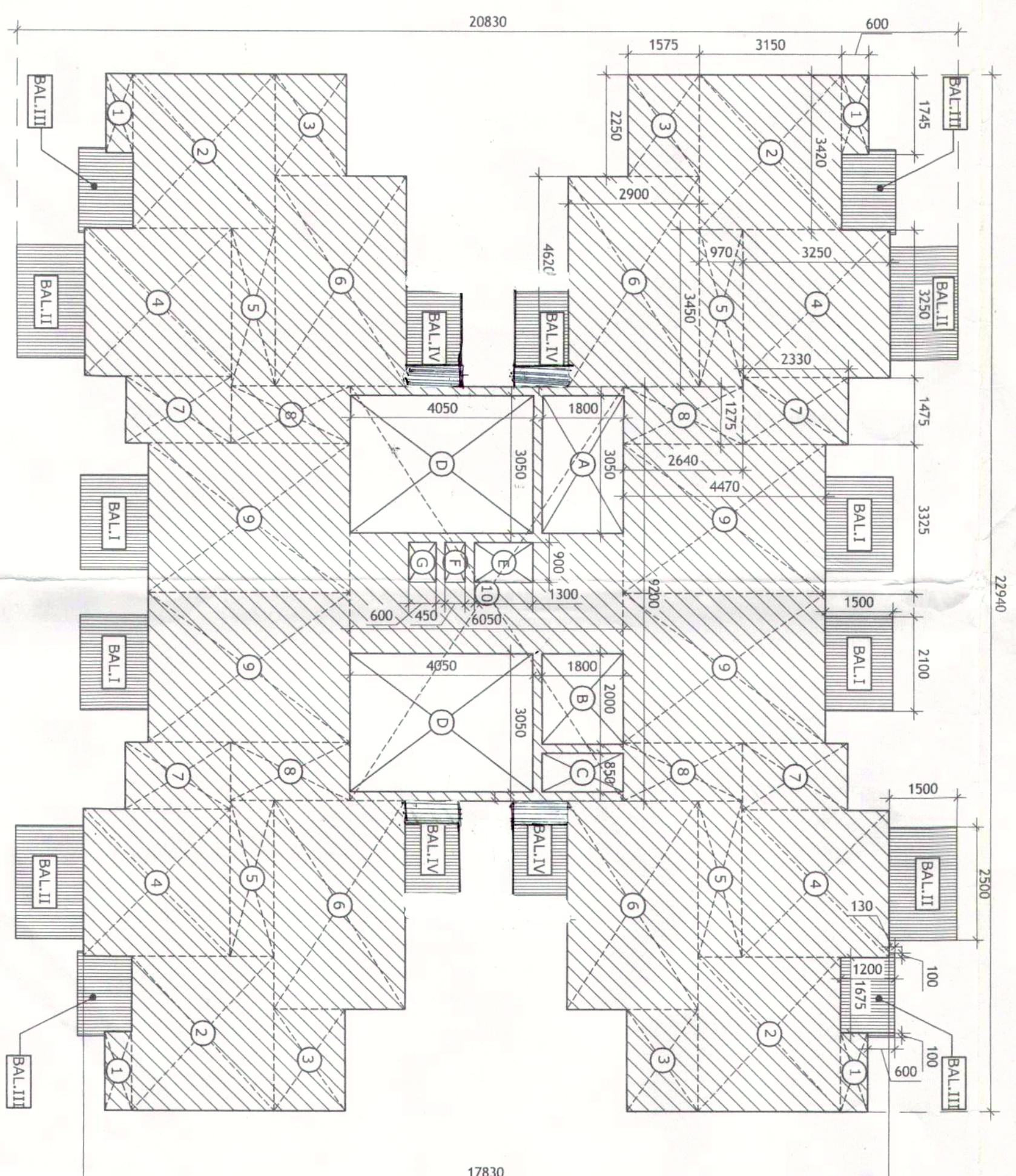
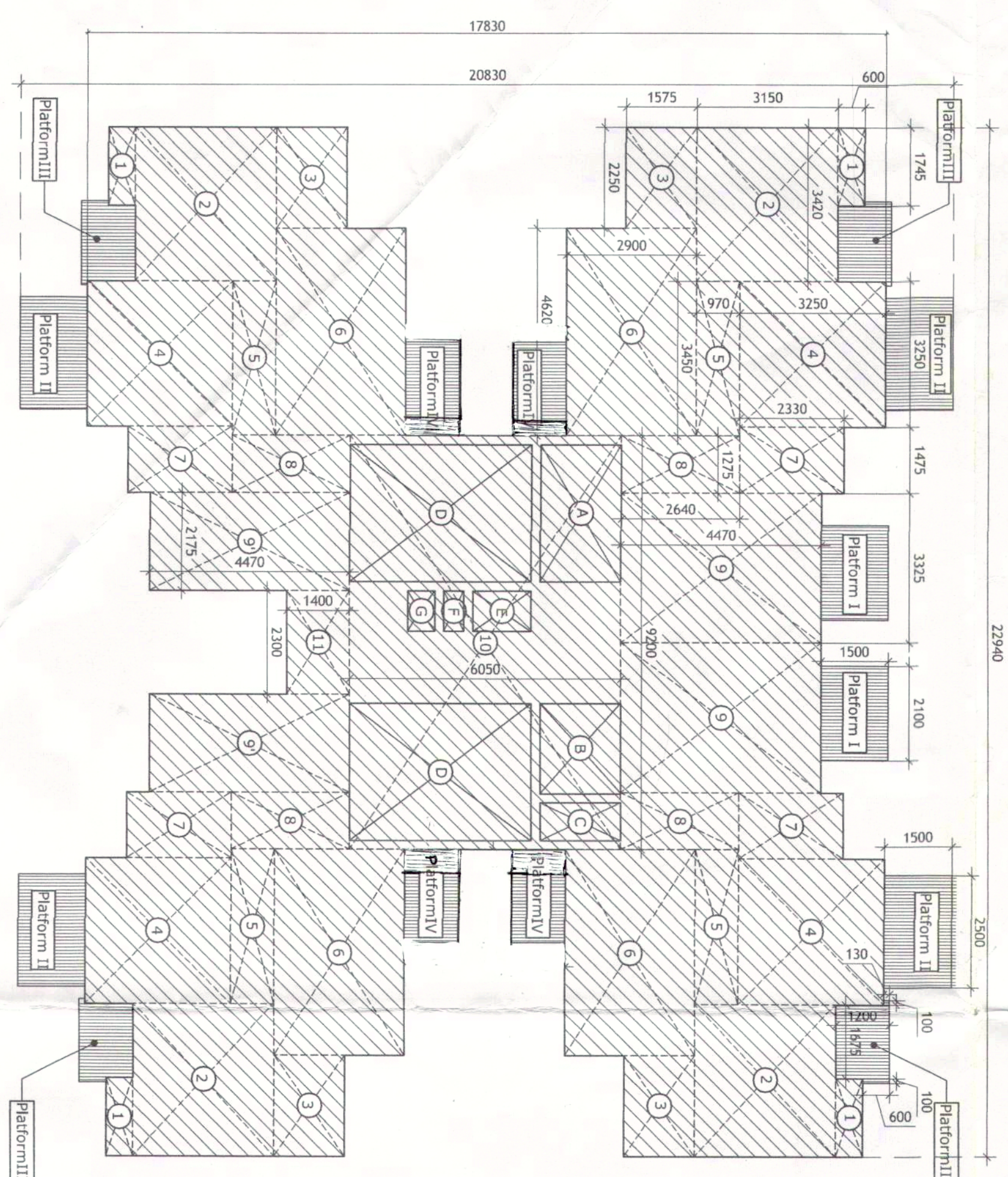
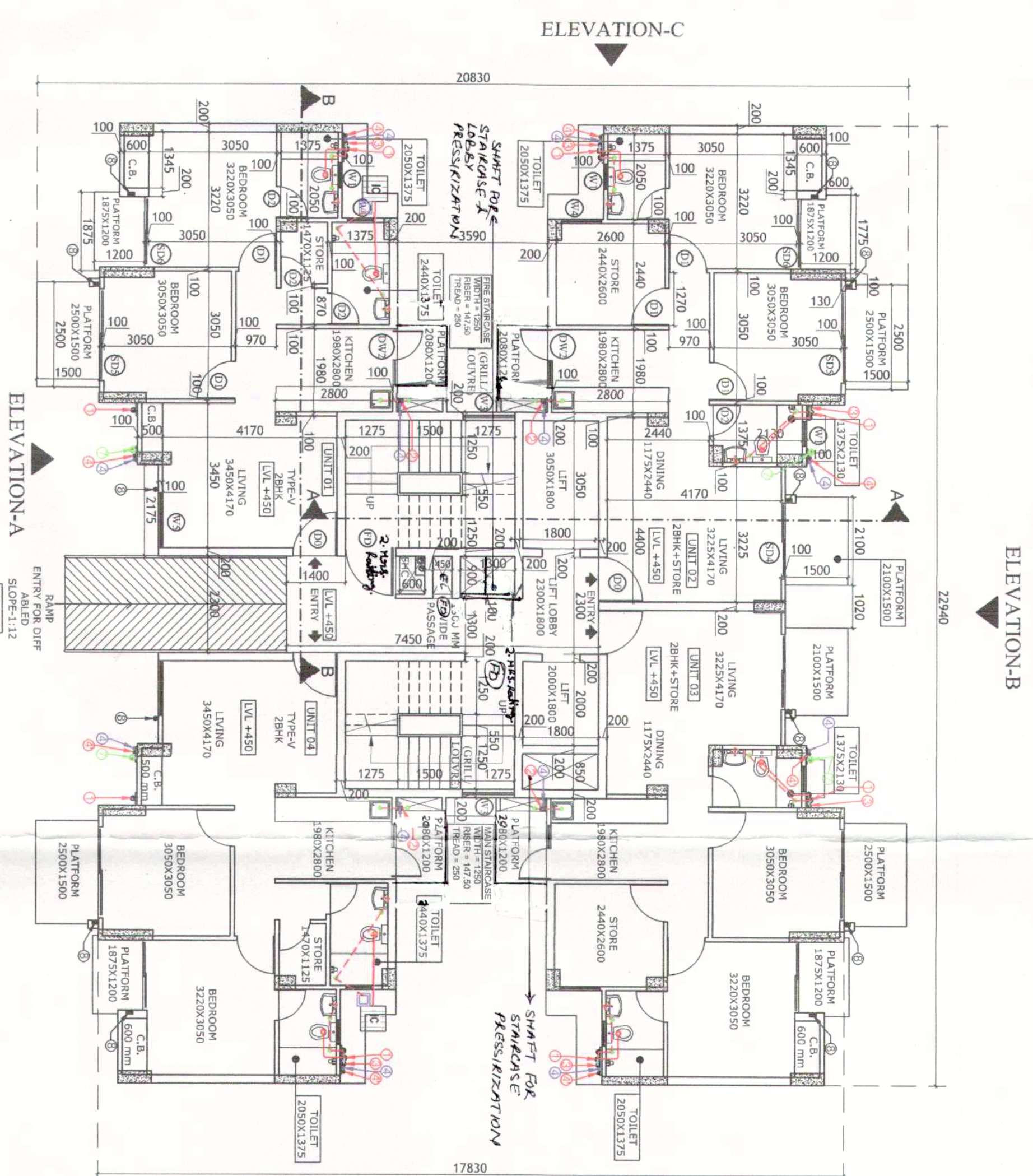

GROUND FLOOR F.A.R. AREA DETAIL						
	1	2	3	4	5	6
	1.745	X	0.600	X	4.186	SQ.M.
	3.320	X	3.150	X	4.302	SQ.M.
	3.250	X	1.575	X	4.1475	SQ.M.
	3.350	X	3.250	X	4.21250	SQ.M.
	3.350	X	0.970	X	4.1386	SQ.M.
	4.620	X	2.900	X	4.53592	SQ.M.
	1.475	X	2.380	X	4.15747	SQ.M.
	8	X	2.660	X	4.15464	SQ.M.
	3.525	X	4.470	X	2.29776	SQ.M.
	97	2.175	X	4.470	X	2.19445
	10	9.600	X	9.600	X	55.660
	11	2.300	X	1.400	X	3.220
	TOTAL					
GROUND FLOOR F.A.R. AREA						305.944
						SQ.M.

TOWER 1: PLATFORM AREA CALCULATION (GROUND FLOOR)							
Platform I	2.100	1.500	X	2	6.300	SQ.M.	
Platform II	2.500	1.500	X	4	15.000	SQ.M.	
Platform III	1.675	1.200	X	4	8.040	SQ.M.	
	0.100	X	0.130	X	0.052	SQ.M.	
	0.100	X	0.600	X	0.240	SQ.M.	
Platform IV	2.080	X	1.200	X	4	9.984	SQ.M.
TOTAL					39.616	SQ.M.	

TYPICAL FLOOR F.A.R. AREA DETAIL									
1	1.245	X	0.690	X		4	4.188	SQ.M.	
2	3.420	X	3.150	X		4	43.092	SQ.M.	
3	2.250	X	1.575	X		4	14.175	SQ.M.	
4	3.350	X	3.250	X		4	42.250	SQ.M.	
5	3.650	X	0.970	X		4	13.866	SQ.M.	
6	4.650	X	2.900	X		4	55.992	SQ.M.	
7	1.475	X	2.330	X		4	13.747	SQ.M.	
8	1.7/5	X	2.640	X		4	13.464	SQ.M.	
9	3.325	X	4.470	X		4	59.451	SQ.M.	
10	9.200	X	6.050	X		1	55.660	SQ.M.	
TOTAL							313.005	SQ.M.	

	NET TYPICAL FLOOR AREA	SQ.M.
A	3,050 X 1,800	5,490
B	X 1,800	1,800
C	X 1,800	1,800
D	X 4,050	4,050
E	X 3,600	3,600
F	X 3,600	3,600
G	X 0,900	0,900
TOTAL		37,440

DWER F-1 BALCONY AREA CALCULATION (TYPICAL FLOOR)						
BALCONY I	2.500	X	1.500	X	4	12.600 S.Q.M.
BALCONY II	2.500	X	1.500	X	4	15.000 S.Q.M.
BALCONY III	1.675	X	1.200	X	4	8.040 S.Q.M.
	0.100	X	0.130	X	4	0.525 S.Q.M.
	0.100	X	0.600	X	4	0.240 S.Q.M.
BALCONY IV	2.080	X	1.200	X	4	9.384 S.Q.M.
TOTAL						45.916 S.Q.M.

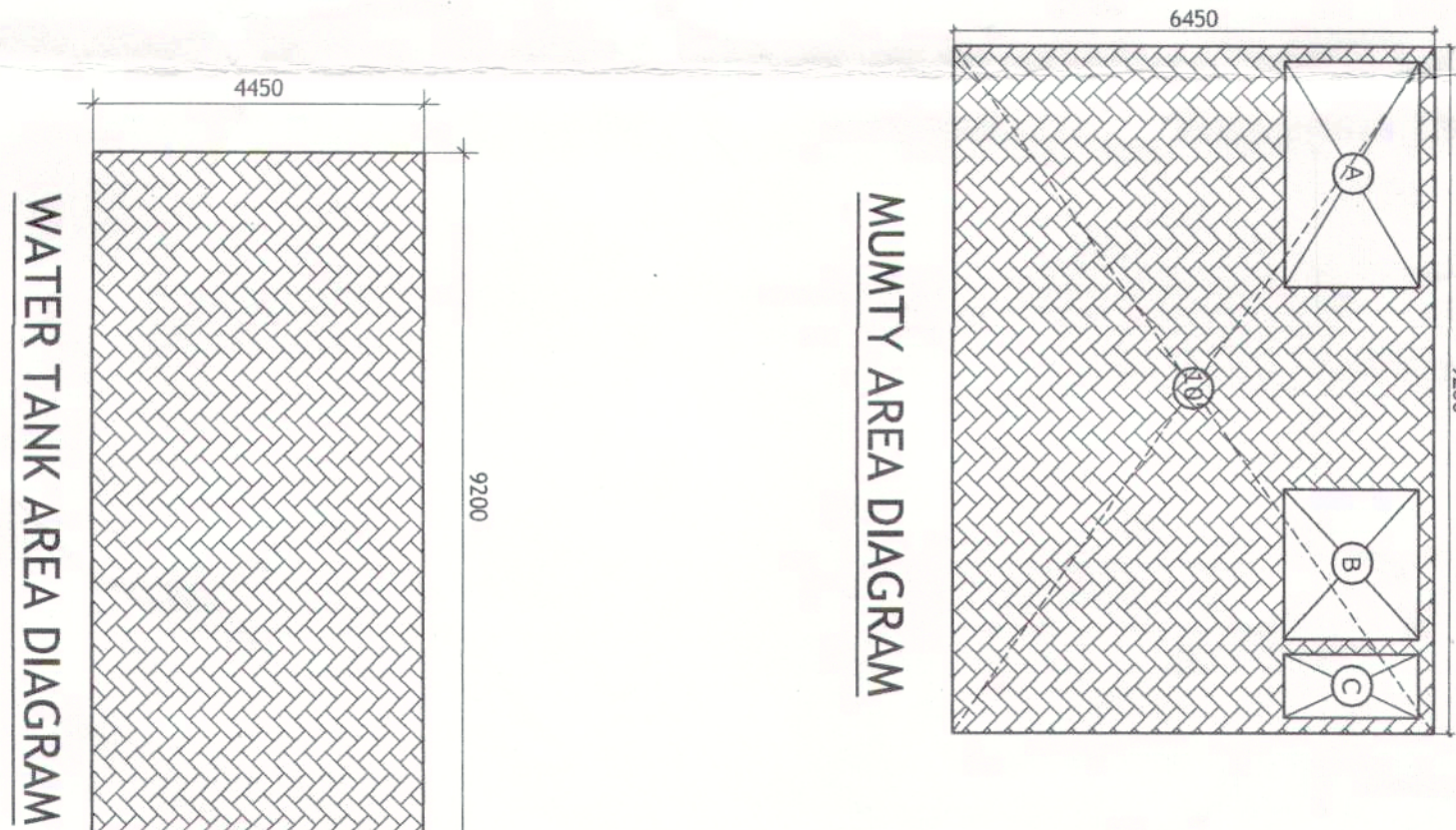
$$10' = 9.200 \times 6.450 = 59.340 \text{ SQ.M.}$$

MUMTY AREA = $10^{+}(A+B+C)$
 = $59,340 - (5,490 + 3,600 + 1,530)$
 = $59,340 - 10,620$
 = $48,720 \text{ SQ.M.}$

WATER TANK AREA = 9.200×4.450
= 40.940 SQ.M.

BUILT UP AREA CALCULATION TOWER T-1

GROUND FLOOR BUILT UP AREA = F.A.R OF GROUND FLOOR
= 305.944 SQ.M(A)

TYPICAL FLOOR BUILT UP AREA = F.A.R. OF TYPICAL FLOOR + (2 X D)
= 275.565 + 24.705 = 300.270 SQ.M(B)



$$\begin{aligned} \text{TOTAL BUILT UP AREA} &= \text{A} + (\text{B} \times 8) + \text{MUMTY AREA} \\ &= 305.944 + (300.270 \times 8) + 48.720 \\ &= 305.944 + 2402.160 + 48.720 \\ &= 2756.824 \text{ SQ. M.} \end{aligned}$$

GROUND COVERAGE CALCULATION TOWER T-1

GROUND COVERAGE = F.A.R. OF GROUND FLOOR
= 305.944 SQ.M.

TOTAL F.A.R. OF TOWER T-1			
F.A.R. ON GROUND FLOOR	305,944	X	1
F.A.R. ON TYPICAL FLOOR	275,565	X	8
TOTAL	2510,464		SQ.M.

DOOR WINDOW SCHEDULE			
DOSE GRANTION			
TYPE	SIZE	CELL	UNITED
FD1	1500X1100	-	2100
FD2	1500X1200	100	2100
FD3	1500X1200	-	2100
FD4	1500X1200	-	2100
FD5	1500X1200	-	2100
FD6	1500X1200	-	2100
FD7	1500X1200	-	2100
FD8	1500X1200	-	2100
FD9	1500X1200	-	2100
FD10	1500X1200	-	2100
FD11	1500X1200	-	2100
FD12	1500X1200	-	2100
FD13	1500X1200	-	2100
FD14	1500X1200	-	2100
FD15	1500X1200	-	2100
FD16	1500X1200	-	2100
FD17	1500X1200	-	2100
FD18	1500X1200	-	2100
FD19	1500X1200	-	2100
FD20	1500X1200	-	2100
FD21	1500X1200	-	2100
FD22	1500X1200	-	2100
FD23	1500X1200	-	2100
FD24	1500X1200	-	2100
FD25	1500X1200	-	2100
FD26	1500X1200	-	2100
FD27	1500X1200	-	2100
FD28	1500X1200	-	2100
FD29	1500X1200	-	2100
FD30	1500X1200	-	2100
FD31	1500X1200	-	2100
FD32	1500X1200	-	2100
FD33	1500X1200	-	2100
FD34	1500X1200	-	2100
FD35	1500X1200	-	2100
FD36	1500X1200	-	2100
FD37	1500X1200	-	2100
FD38	1500X1200	-	2100
FD39	1500X1200	-	2100
FD40	1500X1200	-	2100
FD41	1500X1200	-	2100
FD42	1500X1200	-	2100
FD43	1500X1200	-	2100
FD44	1500X1200	-	2100
FD45	1500X1200	-	2100
FD46	1500X1200	-	2100
FD47	1500X1200	-	2100
FD48	1500X1200	-	2100
FD49	1500X1200	-	2100
FD50	1500X1200	-	2100
FD51	1500X1200	-	2100
FD52	1500X1200	-	2100
FD53	1500X1200	-	2100
FD54	1500X1200	-	2100
FD55	1500X1200	-	2100
FD56	1500X1200	-	2100
FD57	1500X1200	-	2100
FD58	1500X1200	-	2100
FD59	1500X1200	-	2100
FD60	1500X1200	-	2100
FD61	1500X1200	-	2100
FD62	1500X1200	-	2100
FD63	1500X1200	-	2100
FD64	1500X1200	-	2100
FD65	1500X1200	-	2100
FD66	1500X1200	-	2100
FD67	1500X1200	-	2100
FD68	1500X1200	-	2100
FD69	1500X1200	-	2100
FD70	1500X1200	-	2100
FD71	1500X1200	-	2100
FD72	1500X1200	-	2100
FD73	1500X1200	-	2100
FD74	1500X1200	-	2100
FD75	1500X1200	-	2100
FD76	1500X1200	-	2100
FD77	1500X1200	-	2100
FD78	1500X1200	-	2100
FD79	1500X1200	-	2100
FD80	1500X1200	-	2100
FD81	1500X1200	-	2100
FD82	1500X1200	-	2100
FD83	1500X1200	-	2100
FD84	1500X1200	-	2100
FD85	1500X1200	-	2100
FD86	1500X1200	-	2100
FD87	1500X1200	-	2100
FD88	1500X1200	-	2100
FD89	1500X1200	-	2100
FD90	1500X1200	-	2100
FD91	1500X1200	-	2100
FD92	1500X1200	-	2100
FD93	1500X1200	-	2100
FD94	1500X1200	-	2100
FD95	1500X1200	-	2100
FD96	1500X1200	-	2100
FD97	1500X1200	-	2100
FD98	1500X1200	-	2100
FD99	1500X1200	-	2100
FD100	1500X1200	-	2100
FD101	1500X1200	-	2100
FD102	1500X1200	-	2100
FD103	1500X1200	-	2100
FD104	1500X1200	-	2100
FD105	1500X1200	-	2100
FD106	1500X1200	-	2100
FD107	1500X1200	-	2100
FD108	1500X1200	-	2100
FD109	1500X1200	-	2100
FD110	1500X1200	-	2100
FD111	1500X1200	-	2100
FD112	1500X1200	-	2100
FD113	1500X1200	-	2100
FD114	1500X1200	-	2100
FD115	1500X1200	-	2100
FD116	1500X1200	-	2100
FD117	1500X1200	-	2100
FD118	1500X1200	-	2100
FD119	1500X1200	-	2100
FD120	1500X1200	-	2100
FD121	1500X1200	-	2100
FD122	1500X1200	-	2100
FD123	1500X1200	-	2100
FD124	1500X1200	-	2100
FD125	1500X1200	-	2100
FD126	1500X1200	-	2100
FD127	1500X1200	-	2100
FD128	1500X1200	-	2100
FD129	1500X1200	-	2100
FD130	1500X1200	-	2100
FD131	1500X1200	-	2100
FD132	1500X1200	-	2100
FD133	1500X1200	-	2100
FD134	1500X1200	-	2100
FD135	1500X1200	-	2100
FD136	1500X1200	-	2100
FD137	1500X1200	-	2100
FD138	1500X1200	-	2100
FD139	1500X1200	-	2100
FD140	1500X1200	-	2100
FD141	1500X1200	-	2100
FD142	1500X1200	-	2100
FD143	1500X1200	-	2100
FD144	1500X1200	-	2100
FD145	1500X1200	-	2100
FD146	1500X1200	-	2100
FD147	1500X1200	-	2100
FD148	1500X1200	-	2100
FD149	1500X1200	-	2100
FD150	1500X1200	-	2100
FD151	1500X1200	-	2100
FD152	1500X1200	-	2100
FD153	1500X1200	-	2100
FD154	1500X1200	-	2100
FD155	1500X1200	-	2100
FD156	1500X1200	-	2100
FD157	1500X1200	-	2100
FD158	1500X1200	-	2100
FD159	1500X1200	-	2100
FD160	1500X1200	-	2100
FD161	1500X1200	-	2100
FD162	1500X1200	-	2100
FD163	1500X1200	-	2100
FD164	1500X1200	-	2100
FD165	1500X1200	-	2100
FD166	1500X1200	-	2100
FD167	1500X1200	-	2100
FD168	1500X1200	-	2100
FD169	1500X1200	-	2100
FD170	1500X1200	-	2100
FD171	1500X1200	-	2100
FD172	1500X1200	-	2100
FD173	1500X1200	-	2100
FD174	1500X1200	-	2100
FD175	1500X1200	-	2100
FD176	1500X1200	-	2100
FD177	1500X1200	-	2100
FD178	1500X1200	-	2100
FD179	1500X1200	-	2100
FD180	1500X1200	-	2100
FD181	1500X1200	-	2100
FD182	1500X1200	-	2100
FD183	1500X1200	-	2100
FD184	1500X1200	-	2100
FD185	1500X1200	-	2100
FD186	1500X1200	-	2100
FD187	1500X1200	-	2100
FD188	1500X1200	-	2100
FD189	1500X1200	-	2100
FD190	1500X1200	-	2100
FD191	1500X1200	-	2100
FD192	1500X1200	-	2100
FD193	1500X1200	-	2100
FD194	1500X1200	-	2100
FD195	1500X1200	-	2100
FD196	1500X1200	-	2100
FD197	1500X1200	-	2100
FD198	1500X1200	-	2100
FD199	1500X1200	-	2100
FD200	1500X1200	-	2100
FD201	1500X1200	-	2100
FD202	1500X1200	-	2100
FD203	1500X1200	-	2100
FD204	1500X1200	-	2100
FD205	1500X1200	-	2100
FD206	1500X1200	-	2100
FD207	1500X1200	-	2100
FD208	1500X1200	-	2100
FD209	1500X1200	-	2100
FD210	1500X1200	-	2100
FD211	1500X1200	-	2100
FD212	1500X1200	-	2100
FD213	1500X1200	-	2100
FD214	1500X1200	-	2100
FD215	1500X1200	-	2100
FD216	1500X1200	-	2100
FD217	1500X1200	-	2100
FD218	1500X1200	-	2100
FD219	1500X1200	-	2100
FD220	1500X1200	-	2100
FD221	1500X1200	-	2100
FD222	1500X1200	-	2100
FD223	1500X1200	-	2100
FD224	1500X1200	-	2100
FD225	1500X1200	-	2100
FD226	1500X1200	-	2100
FD227	1500X1200	-	2100
FD228	1500X1200	-	2100
FD229	1500X1200	-	2100
FD230	1500X1200	-	2100
FD231	1500X1200	-	2100
FD232	1500X1200	-	2100
FD233	1500X1200	-	2100
FD234	1500X1200	-	2100
FD235	1500X1200	-	2100
FD236	1500X1200	-	2100
FD237	1500X1200	-	2100
FD238	1500X1200	-	2100
FD239	1500X1200	-	2100
FD240	1500X1200	-	2100
FD241	1500X1200	-	2100
FD242	1500X1200	-	2100
FD243	1500X1200	-	2100
FD244	1500X1200	-	2100
FD245	1500X1200	-	2100
FD246	1500X1200	-	2100
FD247	1500X1200	-	2100
FD248	1500X1200	-	2100
FD249	1500X1200	-	2100
FD250	1500X1200	-	2100
FD251	1500X1200	-	2100
FD252	1500X1200	-	2100
FD253	1500X1200	-	2100
FD254	1500X1200	-	2100
FD255	1500X1200	-	2100
FD256	1500X1200	-	2100
FD257	1500X1200	-	2100
FD258	1500X1200	-	2100
FD259	1500X1200	-	2100
FD260	1500X1200	-	2100
FD261	1500X1200	-	2100
FD262	1500X1200	-	2100
FD263	1500X1200	-	2100
FD264	1500X1200	-	2100
FD265	1500X1200	-	2100
FD266	1500X1200	-	2100
FD267	1500X1200	-	2100
FD268	1500X1200	-	2100
FD269	1500X1200	-	2100
FD270	1500X1200	-	2100
FD271	1500X1200	-	2100
FD272	1500X1200	-	2100
FD273	1500X1200	-	2100
FD274	1500X1200	-	2100
FD275	1500X1200	-	2100
FD276	1500X1200	-	2100
FD277	1500X1200	-	2100
FD278	1500X1200	-	2100
FD279	1500X1200	-	2100
FD280	1500X1200	-	2100
FD281	1500X1200	-	2100
FD282	1500X1200	-	2100
FD283	1500X1200	-	2100
FD284	1500X1200	-	2100
FD285	1500X1200	-	2100
FD286	1500X1200	-	2100
FD287	1500X1200	-	2100
FD288	1500X1200	-	2100
FD289	1500X1200	-	2100
FD290	1500X1200	-	2100
FD291	1500X1200	-	2100
FD292	1500X1200	-	2100
FD293	1500X1200	-	2100
FD294	1500X1200	-	2100
FD295	1500X1200	-	2100
FD296	1500X1200	-	2100
FD297	1500X1200	-	2100
FD298	1500X1200	-	2100
FD299	1500X1200	-	2100
FD300	1500X1200	-	2100
FD301	1500X1200	-	2100
FD302	1500X1200	-	2100
FD303	1500X1200	-	2100

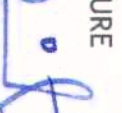
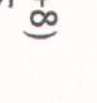
		Fax: (416) 392-6645 Email: 416ask@cityoftoronto.com	
ARCHITECT'S SIGNATURE 		OWNER'S SIGNATURE 	
D DAVID S. KING CIVIL ENGINEER CIVIL/94/127865		E 	
DRAWING TITLE (DISCUSSION DRAWING) TOWER T1 28th FLOOR (G+8) PLANS & AREAS		REC. NO. 04	
SCALE - 1:100		DATE - SEP 2019	
			

[illegible]

PROJECT TITLE
PROPOSED BUILDING PLAN OF AFFORDABLE GROUP HOUSING
COLONY FOR AN AREA MEASURING 5.00 ACRES (GULENRU
89 OF 2019 DATED 02/08/2019, IN SECTION-87 CLAUSE-6M,
MANEASA URBAN COMPLEX BEING DEVELOPED BY RAMPASTHA
SARE LAND HOLDING COMPANY ONE PVT. LTD. AND OTHERS IN
COLLABORATION WITH SIGNATURE GLOBAL INDIA PVT. LTD.

THEY LOCATED:
Coimbatore, Environmental Services Pvt Ltd







PROJECT TITLE	CLIENT
	M/S. SIGNATURE GLOBAL (INDIA) PRIVATE LIMITED Signature Global, 1308 D-1, Gopold Das Building, 28 Barakhamba Road, C.P., New Delhi

SUBMISSION DRAWING

Deputy Director
 Old Directorate Fire Service
 Member B.P.C.
 8
 DANISH RITE
 SO

STC	STC	STC
10	RA	ATP
		AD

Ram Avatar B

 J. J. J. J. J.
 S. J. S. J. S.
 S. J. S. J. S.
 S. J. S. J. S.
 S. J. S. J. S.
 S. J. S. J. S.