

SUBMISSION DRAWING
NOTES:-
 1. BUILDING HAS AUTOMATIC SPRINKLER SYSTEM WHEREVER REQD. AS/NBC.
 2. BUILDING WILL BE DESIGNED (STRUCTURES) AS PER RELEVANT IS CODES FOR EARTH QUAKE RESISTANCE.
 3. 100 PERCENT POWER BACK UP.
 4. GATE AND BOUNDARY WALL AS PER STANDARD DESIGN.

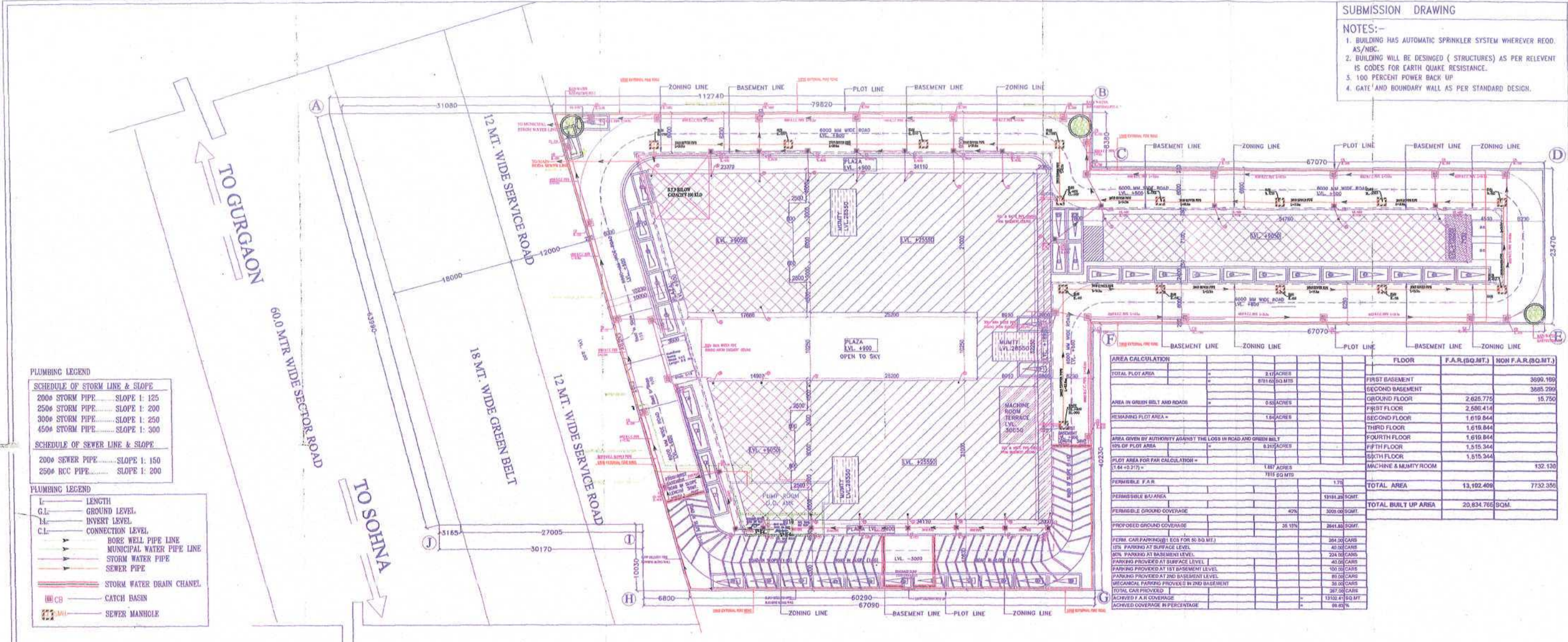

PLUMBING LEGEND

SCHEDULE OF STORM LINE & SLOPE

200# STORM PIPE.....SLOPE 1: 125
 250# STORM PIPE.....SLOPE 1: 200
 300# STORM PIPE.....SLOPE 1: 250
 450# STORM PIPE.....SLOPE 1: 300

SCHEDULE OF SEWER LINE & SLOPE

200# SEWER PIPE.....SLOPE 1: 150
 250# R/C PIPE.....SLOPE 1: 200

PLUMBING LEGEND

L.....LENGTH
 G.L.....GROUND LEVEL
 I.L.....INVERT LEVEL
 C.L.....CONNECTION LEVEL

--- BORE WELL PIPE LINE
 --- MUNICIPAL WATER PIPE LINE
 --- STORM WATER PIPE
 --- SEWER PIPE
 --- STORM WATER DRAIN CHANNEL

CB.....CATCH BASIN
 MH.....SEWER MANHOLE

AREA CALCULATION

	FLOOR	F.A.R.(SQ.MT.)	NON F.A.R.(SQ.MT.)
TOTAL PLOT AREA	2.17 ACRES		
AREA IN GREEN BELT AND ROAD	0.53 ACRES		
REMARKING PLOT AREA	1.64 ACRES		
AREA GIVEN BY AUTHORITY AMOUNT THE LOSS IN ROAD AND GREEN BELT	0.317 ACRES		
10% OF PLOT AREA	0.217 ACRES		
PLOT AREA FOR F.A.R. CALCULATION = (1.64 - 0.217)	1.423 ACRES		
PERMISSIBLE F.A.R.	1.75		
PERMISSIBLE B.A. AREA	2481.25 SQ.MT.		
PERMISSIBLE GROUND COVERAGE	40%	3009.00 SQ.MT.	
PROPOSED GROUND COVERAGE	35.15%	2641.80 SQ.MT.	
FORM CAR PARKING (ECS FOR 90 SQ.MT.)	284.20 CARS		
10% PARKING AT SURFACE LEVEL	40.00 CARS		
10% PARKING AT BASEMENT LEVEL	204.00 CARS		
PARKING PROVIDED AT SURFACE LEVEL	40.00 CARS		
PARKING PROVIDED AT 1ST BASEMENT LEVEL	60.00 CARS		
PARKING PROVIDED AT 2ND BASEMENT LEVEL	80.00 CARS		
MECHANICAL PARKING PROVIDED BY 2ND BASEMENT	38.00 CARS		
TOTAL CAR PROVIDED	387.00 CARS		
ACQUIRED F.A.R. COVERAGE	1310.25 SQ.MT.		
ACHIEVED COVERAGE IN PERCENTAGE	53.45%		

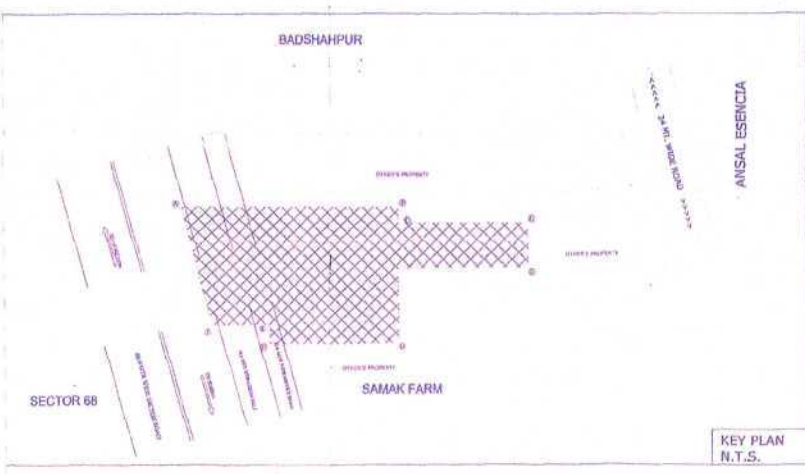
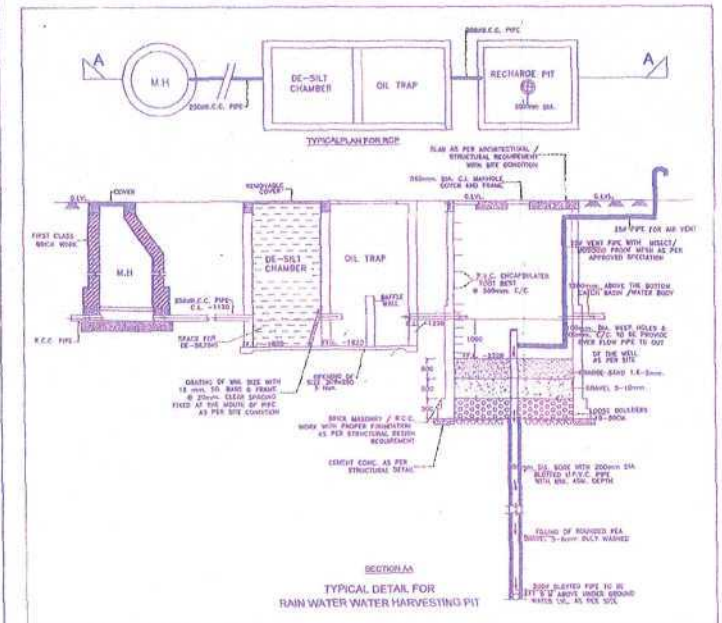

AREA DETAIL OF SURFACE PARKING

Area of Parking = Addition - subtraction 1

ADDITION:-

S.NO.	TYPE	LENGTH (MTRS)	BREADTH (MTRS)	NO.	AREA (SQ.MTRS)
1	A (TRIANGLE)	15.10.547	72.08	1	704.2097
2	B (RECTANGLE)	60.276	72.08	1	4344.694
3	C (RECTANGLE)	97.07	23.47	1	2274.333
TOTAL AREA:-					
6623.121					

SUBTRACTION 1:-

S.NO.	TYPE	LENGTH (MTRS)	BREADTH (MTRS)	NO.	AREA (SQ.MTRS)
1	1 (TRIANGLE)	1.585.699	21	2	319.553
2	2 (RECTANGLE)	53.796	21	1	1129.716
3	3 (RECTANGLE)	45.324	21	1	951.804
4	4 (RECTANGLE)	6.5	4.36	1	28.34
5	5 (circle)			1	7.469
6	6 (RECTANGLE)	51.29	7.1	1	364.373
7	7 (RECTANGLE)	1.53	7.13	1	10.896
8	8 (RECTANGLE)	2.51	11.01	1	27.666
9	9 (RECTANGLE)	2	7.01	1	14.02
10	10 (circle)			2	6.284
11	11 (RECTANGLE)	3	8.25	1	24.75
TOTAL AREA:-					
2689.469					
TOTAL SURFACE PARKING AREA =					
3933.652					
1 PARKING @ 25 SQ.MT. =					
157.346					
TOTAL PARKING =					
157.346					
PROVIDED =					
40 CARS					

PROJECT:-
 PROPOSED BUILDING PLAN FOR COMMERCIAL COLONY ON KHASRA NOS131//11/2, 11/3,132//14/2/2/2,15/2/2,16/1,17/1 MEASURING 2.17 (LICENSE NO. 107 DATED 12.08.2011) ACRES IN SECTOR 67

DRAWING TITLE:-
 SITE PLAN & AREA DETAIL

SCALE:-
 1:200

SCALE:-
 04.06.2012

ARCHITECT:-

OWNER SIGNATURE:-

ARCHITECT SIGNATURE:-