

Design Director (D)
Civil Engineering
Member 10170

Senior Architect (SA)
Architect
Member 10170

24 M WIDE ROAD

Plot Area Detail	
(In Sq.Mts)	(In Sq.Mts)
Total Plot Area	5,000
Commercial Plot Area @ 4%	202.544,450
Residential Plot Area @ 96%	4,797.455,550

Summary of E.A.R.	
(In Sq.Mts)	Proposed Area (In Sq.Mts)
Permissible Residential E.A.R. @ 2.25%	43,705.980
ADDITIONAL F.A.R. - (S.I.P) FOR COMMERCIAL @ 3%	582.746
TOTAL PERMISSIBLE RESIDENTIAL E.A.R. @ 2.28 %	44,288.726
ADDITIONAL F.A.R. @ 1.75% FOR COMMERCIAL @ 3%	1,416.398
Total Permissible Commercial E.A.R. @ 1.78%	24,281
Total Permissible Commercial E.A.R. @ 1.78%	1,440.68

Commercial E.A.R. Detail	
Area (In Sq.Mts)	Proposed Area (In Sq.Mts)
Commercial E.A.R. Detail	1,440.68
COMMERCIAL E.A.R. REMAINING	0.280

Residential E.A.R. Detail	
Area (In Sq.Mts)	Proposed Area (In Sq.Mts)
Tower A	7582.526
Tower B	7585.545
Tower C	7582.526
Tower D	7582.526
Tower E	7582.526
Tower F	7582.526
TOWER F.A.R.	44,288.726
RESIDENTIAL F.A.R. REMAINING	12.116

Summary of Ground Coverage	
(In Sq.Mts)	Proposed Area (In Sq.Mts)
Permissible Area	10,117.125
Proposed Area	5,193.128
Percentage	25.67%

Ground Coverage Detail	
Area (In Sq.Mts)	Unit
Tower A	277.494
Tower B	577.494
Tower C	577.494
Tower D	577.494
Tower E	577.494
Tower F	491.294
COMMERCIAL	1,440.399
COMMUNITY	187.804
CRICHE	185.983
Total Ground Coverage	5,193.128

Density Calculation	
Permissible (in Nos.)	Proposed (in PPA)
750 to 900	758

Density Detail	
Total Nos. of Dwelling Unit	Nos.
Population per Dwelling Unit	728
Total Population	3640
Area of Plot for Density	4.800
Population per Acre	758

Green Area Summary	
Permissible	Proposed
30.85,138	3,432,187
15.2%	16.66%

Plot Area Summary	
Area in Sq.Mts	Percentage
3,193,128	25.67%
5,193,128	29.90%
5,963,562	20.26%
53,000	27.61%
5,887,573	100.00%

Built-up Area Summary	
Typology	Nos.
Tower A	8767,714
Tower B	8767,714
Tower C	8767,714
Tower D	8767,714
Tower E	8767,714
Tower F	7756,767
Commercial	1,440,399
Community	187,804
Crèche	185,983
Total Built-up Area	52,488,974

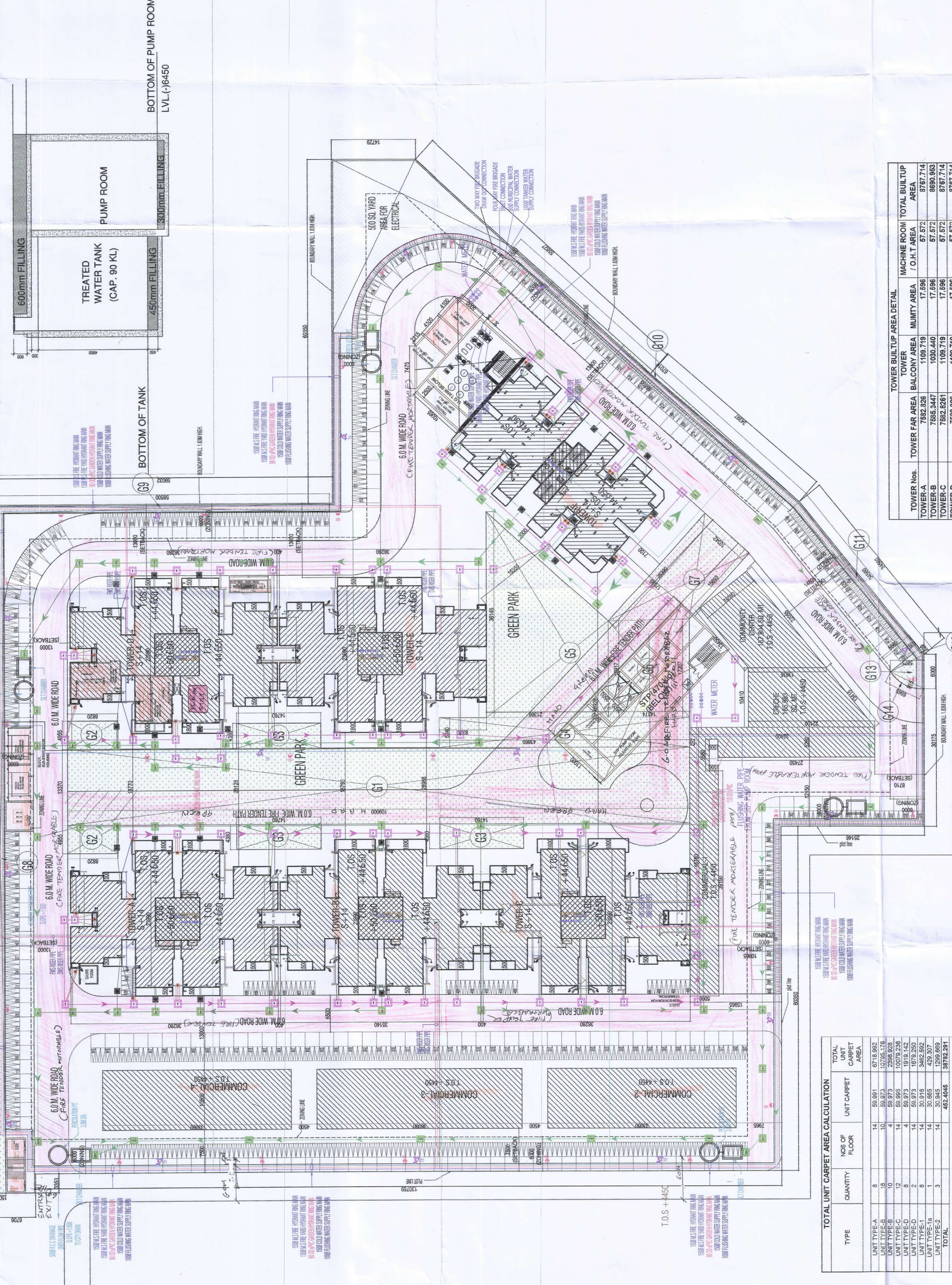

TOTAL UNIT CARPET AREA CALCULATION	
TYPE	TOTAL UNIT CARPET AREA
UNIT TYPE-A	67,16,892
UNIT TYPE-B	10,26,178
UNIT TYPE-C	10,26,178
UNIT TYPE-D	10,26,178
UNIT TYPE-E	10,26,178
UNIT TYPE-F	10,26,178
UNIT TYPE-1A	429,307
UNIT TYPE-2	30,945
TOTAL	42,46,446

UNITS & POPULATION STATEMENT				
S/NO	DISCRPTIONS	TOTAL NOS OF APARTMENT	NO OF UNIT PER FLOOR	POPULATION
1	TOWER-A (8 FLOORS)	14	14	140
	TOWER-B (8 FLOORS)	14	14	140
	TOWER-C (8 FLOORS)	14	14	140
	TOWER-D (8 FLOORS)	14	14	140
	TOWER-E (8 FLOORS)	14	14	140
	TOWER-F (8 FLOORS)	14	14	140
2	TOWER-G (8 FLOORS)	14	14	140
	TOWER-H (8 FLOORS)	14	14	140
	TOWER-I (8 FLOORS)	14	14	140
	TOWER-J (8 FLOORS)	14	14	140
	TOWER-K (8 FLOORS)	14	14	140
	TOWER-L (8 FLOORS)	14	14	140
3	TOWER-M (8 FLOORS)	14	14	140
	TOWER-N (8 FLOORS)	14	14	140
	TOWER-O (8 FLOORS)	14	14	140
	TOWER-P (8 FLOORS)	14	14	140
	TOWER-Q (8 FLOORS)	14	14	140
	TOWER-R (8 FLOORS)	14	14	140
4	TOWER-S (8 FLOORS)	14	14	140
	TOWER-T (8 FLOORS)	14	14	140
	TOWER-U (8 FLOORS)	14	14	140
	TOWER-V (8 FLOORS)	14	14	140
	TOWER-W (8 FLOORS)	14	14	140
	TOWER-X (8 FLOORS)	14	14	140
5	TOWER-Y (8 FLOORS)	14	14	140
	TOWER-Z (8 FLOORS)	14	14	140
	TOWER-AA (8 FLOORS)	14	14	140
	TOWER-AB (8 FLOORS)	14	14	140
	TOWER-AC (8 FLOORS)	14	14	140
	TOWER-AD (8 FLOORS)	14	14	140
6	TOWER-AE (8 FLOORS)	14	14	140
	TOWER-AF (8 FLOORS)	14	14	140
	TOWER-AG (8 FLOORS)	14	14	140
	TOWER-AH (8 FLOORS)	14	14	140
	TOWER-AI (8 FLOORS)	14	14	140
	TOWER-AJ (8 FLOORS)	14	14	140
TOTAL		728		7280

STILL AREA CALCULATION	
TOWER NOS.	STILL AREA
TOWER-A	662,8843
TOWER-B	662,8843
TOWER-C	662,8843
TOWER-D	662,8843
TOWER-E	662,8843
TOWER-F	662,8843
TOTAL STILL AREA	3,983,76258

TOTAL NOS. OF APARTMENTS	
TOWER NOS.	TOTAL NOS. OF APARTMENTS
TOWER-A	14
TOWER-B	14
TOWER-C	14
TOWER-D	14
TOWER-E	14
TOWER-F	14
TOWER-G	14
TOWER-H	14
TOWER-I	14
TOWER-J	14
TOWER-K	14
TOWER-L	14
TOWER-M	14
TOWER-N	14
TOWER-O	14
TOWER-P	14
TOWER-Q	14
TOWER-R	14
TOWER-S	14
TOWER-T	14
TOWER-U	14
TOWER-V	14
TOWER-W	14
TOWER-X	14
TOWER-Y	14
TOWER-Z	14
TOWER-AA	14
TOWER-AB	14
TOWER-AC	14
TOWER-AD	14
TOWER-AE	14
TOWER-AF	14
TOWER-AG	14
TOWER-AH	14
TOWER-AI	14
TOWER-AJ	14
TOTAL	728

TOTAL NOS. OF APARTMENTS	
TOWER NOS.	TOTAL NOS. OF APARTMENTS
TOWER-A	14
TOWER-B	14
TOWER-C	14
TOWER-D	14
TOWER-E	14
TOWER-F	14
TOWER-G	14
TOWER-H	14
TOWER-I	14
TOWER-J	14
TOWER-K	14
TOWER-L	14
TOWER-M	14
TOWER-N	14
TOWER-O	14
TOWER-P	14
TOWER-Q	14
TOWER-R	14
TOWER-S	14
TOWER-T	14
TOWER-U	14
TOWER-V	14
TOWER-W	14
TOWER-X	14
TOWER-Y	14
TOWER-Z	14
TOWER-AA	14
TOWER-AB	14
TOWER-AC	14
TOWER-AD	14
TOWER-AE	14
TOWER-AF	14
TOWER-AG	14
TOWER-AH	14
TOWER-AI	14
TOWER-AJ	14
TOTAL	728

TOTAL NOS. OF APARTMENTS	
TOWER NOS.	TOTAL NOS. OF APARTMENTS
TOWER-A	14
TOWER-B	14
TOWER-C	14
TOWER-D	14
TOWER-E	14
TOWER-F	14
TOWER-G	14
TOWER-H	14
TOWER-I	14
TOWER-J	14
TOWER-K	14
TOWER-L	14
TOWER-M	14
TOWER-N	14
TOWER-O	14
TOWER-P	14
TOWER-Q	14
TOWER-R	14
TOWER-S	14
TOWER-T	14
TOWER-U	14
TOWER-V	14
TOWER-W	14
TOWER-X	14
TOWER-Y	14
TOWER-Z	14
TOWER-AA	14
TOWER-AB	14
TOWER-AC	14
TOWER-AD	14
TOWER-AE	14
TOWER-AF	14
TOWER-AG	14
TOWER-AH	14
TOWER-AI	14
TOWER-AJ	14
TOTAL	728

TOTAL NOS. OF APARTMENTS	
TOWER NOS.	TOTAL NOS. OF APARTMENTS
TOWER-A	14
TOWER-B	14
TOWER-C	14
TOWER-D	14
TOWER-E	14
TOWER-F	14
TOWER-G	14
TOWER-H	14
TOWER-I	14
TOWER-J	14
TOWER-K	14
TOWER-L	14
TOWER-M	14
TOWER-N	14
TOWER-O	14
TOWER-P	14
TOWER-Q	14
TOWER-R	14
TOWER-S	14
TOWER-T	14
TOWER-U	14
TOWER-V	14
TOWER-W	14
TOWER-X	14
TOWER-Y	14
TOWER-Z	14
TOWER-AA	14
TOWER-AB	14
TOWER-AC	14
TOWER-AD	14
TOWER-AE	14
TOWER-AF	14
TOWER-AG	14
TOWER-AH	14
TOWER-AI	14
TOWER-AJ	14
TOTAL	728

TOTAL NOS. OF APARTMENTS	
TOWER NOS.	TOTAL NOS. OF APARTMENTS
TOWER-A	14
TOWER-B	14
TOWER-C	14
TOWER-D	14
TOWER-E	14
TOWER-F	14
TOWER-G	14
TOWER-H	14
TOWER-I	14
TOWER-J	14
TOWER-K	14
TOWER-L	14
TOWER-M	14
TOWER-N	14
TOWER-O	14
TOWER-P	14
TOWER-Q	14
TOWER-R	14
TOWER-S	14
TOWER-T	14
TOWER-U	14
TOWER-V	14
TOWER-W	14
TOWER-X	14
TOWER-Y	14
TOWER-Z	14
TOWER-AA	14
TOWER-AB	14
TOWER-AC	14
TOWER-AD	14
TOWER-AE	14
TOWER-AF	14
TOWER-AG	14
TOWER-AH	14
TOWER-AI	14
TOWER-AJ	14
TOTAL	728

TOTAL NOS. OF APARTMENTS	
TOWER NOS.	TOTAL NOS. OF APARTMENTS
TOWER-A	14
TOWER-B	14
TOWER-C	14
TOWER-D	14
TOWER-E	14
TOWER-F	14
TOWER-G	14
TOWER-H	14
TOWER-I	14
TOWER-J	14
TOWER-K	14
TOWER-L	14
TOWER-M	14
TOWER-N	14
TOWER-O	14
TOWER-P	14
TOWER-Q	14
TOWER-R	14
TOWER-S	14
TOWER-T	14
TOWER-U	14
TOWER-V	14
TOWER-W	14
TOWER-X	14
TOWER-Y	14
TOWER-Z	14
TOWER-AA	14
TOWER-AB	14
TOWER-AC	14
TOWER-AD	14
TOWER-AE	14
TOWER-AF	14
TOWER-AG	14
TOWER-AH	14
TOWER-AI	14
TOWER-AJ	14
TOTAL	728

TOTAL NOS. OF APARTMENTS	
TOWER NOS.	TOTAL NOS. OF APARTMENTS
TOWER-A	14
TOWER-B	14
TOWER-C	14
TOWER-D	14
TOWER-E	14
TOWER-F	14
TOWER-G	14
TOWER-H	14
TOWER-I	14
TOWER-J	14
TOWER-K	14
TOWER-L	14
TOWER-M	14
TOWER-N	14
TOWER-O	14
TOWER-P	14
TOWER-Q	14
TOWER-R	14
TOWER-S	14
TOWER-T	14
TOWER-U	14
TOWER-V	14
TOWER-W	14
TOWER-X	14
TOWER-Y	14
TOWER-Z	14
TOWER-AA	14
TOWER-AB	14
TOWER-AC	14
TOWER-AD	14
TOWER-AE	14
TOWER-AF	14
TOWER-AG	14
TOWER-AH	14
TOWER-AI	14
TOWER-AJ	14
TOTAL	728