

NOTES

1. ALL DIMENSIONS IN MILLIMETERS UNLESS OTHERWISE SPECIFIED.
2. ALL MOUNTING AREAS SHALL BE MECHANICALLY LIT AND VENTILATED WITH 100% POWER BACK-UP.
3. GATE AND BOUNDARY WALL SHALL BE AS PER STANDARD DESIGN.
4. ALL ELECTRICAL AND WATER FITTINGS SYSTEMS TO BE AS PER NORMS SPECIFIED BY HARYANA AND MADE OPERATIONAL BEFORE APPLYING FOR OCCUPANCY CERTIFICATE.
5. RAIN WATER HARVESTING SYSTEM SHALL BE AS PER HARYANA GOVT. WATER AUTHORITY NORMS.
6. FIRE FIGHTING PROVISIONS INCLUDING FIRE SPRINKLERS SHALL BE AS PER NBC GUIDELINES.

REVISIONS	NO.	DESCRIPTION	DATE	REMARK



Architect's Signature
 Owners Signature

Architect: *Amul*
 M/s. Amul Projects, Connaught Place, New Delhi
 Registration No. CA/59/18859

Owner: *[Signature]*

Structure:
 M/s. Technical Project Consultants Pvt. Ltd.
 Plot - 366, Sec-26, Gurgaon - 122001
 T: +91 (0) 8200820 | D: +91 (0) 8200884 | www.tpc.in

MEP:
 Paradise Consultants
 G-76C, Shaheen Bagh, Noida road near
 Kailashji, New Delhi - 110025
 P: +91 (0) 11 26100000
 Email: paradiseconsultants@gmail.com

Structure:
 M/s. Technical Project Consultants Pvt. Ltd.
 Plot - 366, Sec-26, Gurgaon - 122001
 T: +91 (0) 8200820 | D: +91 (0) 8200884 | www.tpc.in

MEP:
 Paradise Consultants
 G-76C, Shaheen Bagh, Noida road near
 Kailashji, New Delhi - 110025
 P: +91 (0) 11 26100000
 Email: paradiseconsultants@gmail.com

AREA CALCULATIONS FOR UPPER BASEMENT CUT OUTS

A (M)	B (M)	Nos.	AREA (SqM) = Z = A X B
ADDITIONS FOR U. BASEMENT FAR			
a	1.000	1.600	6.400
b	1.920	3.750	7.200
c	1.450	6.665	9.623
d	1.330	5.130	6.823
e	1.330	1.800	2.388
f	4.660	0.930	4.331
g	1.915	2.500	4.788
h	3.825	1.285	4.915
i	1.805	3.555	6.408
j	1.300	0.600	0.780
k	2.580	2.825	7.289
l	1.500	4.770	7.155
m	3.975	1.540	6.122
n	2.110	4.940	10.423
o	3.805	2.035	7.743
TOTAL			123.190
TOTAL ADDITIONS			123.190
SUBTRACTIONS FOR U. BASEMENT FAR			
TOTAL			0.000
TOTAL CUT OUTS' AREA			123.190

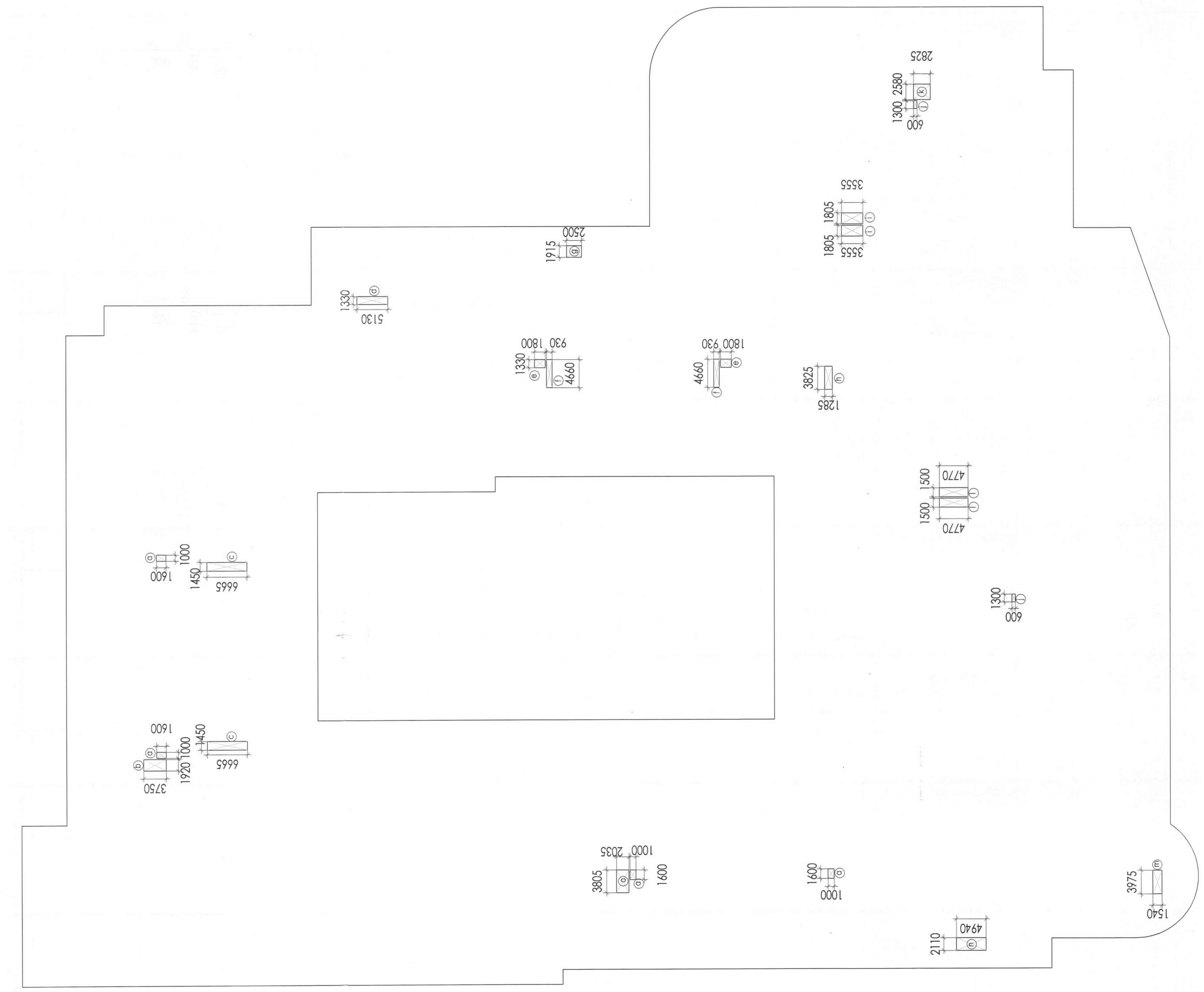

UPPER BASEMENT CUT-OUT AREA