

DOOR, WINDOW & VENTILATOR SCHEDULE

| S.No. | TYPE | WIDTH | CILL | LINTEL |
|-------|------|-------|-------|--------|
| 1 | D | 1.075 | 0 | 2.450 |
| 2 | D1 | 1.000 | 0 | 2.450 |
| 3 | D2 | 0.750 | 0 | 2.450 |
| 4 | D3 | 0.995 | 0 | 2.450 |
| 5 | DW1 | 1.750 | 0 | 2.450 |
| 6 | W/EF | 1.850 | 0 | 2.450 |
| 7 | W1 | 1.525 | 900 | 2.450 |
| 8 | VPV | 0.750 | 1.550 | 2.450 |

AREA STATEMENT

| | | | | |
|--|------------------|---------------------|----------------|----------------|
| TOTAL PLOT AREA = 8.650 M X 15.000 M | 129.750 | sq.mts. | | |
| ERMISSIBLE COVERED F.A.R @ 200% | 259.500 | sq.mts. | | |
| TOTAL PERMISSIBLE GROUND COVERAGE @ 75% | 97.313 | sq.mts. | | |
| ACHIVED F.A.R @ 64% | 83.040 | sq.mts. | | |
| TOTAL FAR 264% | 342.540 | sq.mts. | | |
| PROPOSED F.A.R. AREA OF STILT | | | | |
| A | 1.730 X 1.535 | = 2.656 sq.mts. | | |
| B | 2.195 X 4.535 | = 9.954 sq.mts. | | |
| C | 1.730 X 1.730 | = 2.993 sq.mts. | | |
| TOTAL FAR AREA OF A+B+C | = 15.603 | sq.mts. | | |
| NON F.A.R. AREA OF STILT | | | | |
| AA | 8.650 X 11.320 | = 97.918 sq.mts. | | |
| 1+2+A+B+C | = 20.316 | sq.mts. | | |
| TOTAL AREA FAR + NON FAR (AA - 1+2) | = 77.602 | sq.mts. | | |
| PROPOSED F.A.R. ON FIRST FLOOR 8.854 | | | | |
| AA | 8.850 X 11.320 | = 99.918 sq.mts. | | |
| 1 | 2.485 X 1.565 | = 3.889 sq.mts. | | |
| 2 | 6.340 X 0.130 | = 0.824 sq.mts. | | |
| 3 | 1.850 X 4.075 | = 7.539 sq.mts. | | |
| 4 | 0.230 X 1.075 | = 0.247 sq.mts. | | |
| 5 | 1.500 X 1.075 | = 1.613 sq.mts. | | |
| 6 | 1.500 X 1.500 | = 2.250 sq.mts. | | |
| TOTAL OF 1 TO 6 | = 16.362 | sq.mts. | | |
| PROPOSED F.A.R. ON FIRST FLOOR | = 81.556 | sq.mts. | | |
| PROPOSED F.A.R. ON SECOND FLOOR | = 81.556 | sq.mts. | | |
| PROPOSED F.A.R. ON THIRD FLOOR | = 81.556 | sq.mts. | | |
| PROPOSED F.A.R. ON FOURTH FLOOR | = 81.556 | sq.mts. | | |
| TOTAL PROPOSED F.A.R. AREA ON ALL FLOORS (STILT + FF + SF + TF + 4TH) | = 341.827 | sq.mts. | | |
| NON F.A.R. AREA OF MUMTY | | | | |
| A | 1.730 X 1.535 | = 2.656 sq.mts. | | |
| B | 2.195 X 4.535 | = 9.954 sq.mts. | | |
| C | 1.730 X 1.730 | = 2.993 sq.mts. | | |
| TOTAL AREA (A+B+C) | = 15.603 | sq.mts. | | |
| FLOORS | FAR AREA | NON FAR AREA | TOTAL | SQ.MTS. |
| STILT AREA | 15.603 | 77.602 | 93.205 | sq.mts. |
| FIRST FLOOR | 81.556 | 3+4+5+6 | 93.205 | sq.mts. |
| SECOND FLOOR | 81.556 | 3+4+5+6 | 93.205 | sq.mts. |
| THIRD FLOOR | 81.556 | 3+4+5+6 | 93.205 | sq.mts. |
| FOURTH FLOOR | 81.556 | 3+4+5+6 | 93.205 | sq.mts. |
| MUMTY AREA = | | 15.603 | 15.603 | sq.mts. |
| TOTAL ALL FLOOR AREA (FAR AREA + NON FAR AREA) | | | 481.620 | sq.mts. |

ELEVATION



SECTION

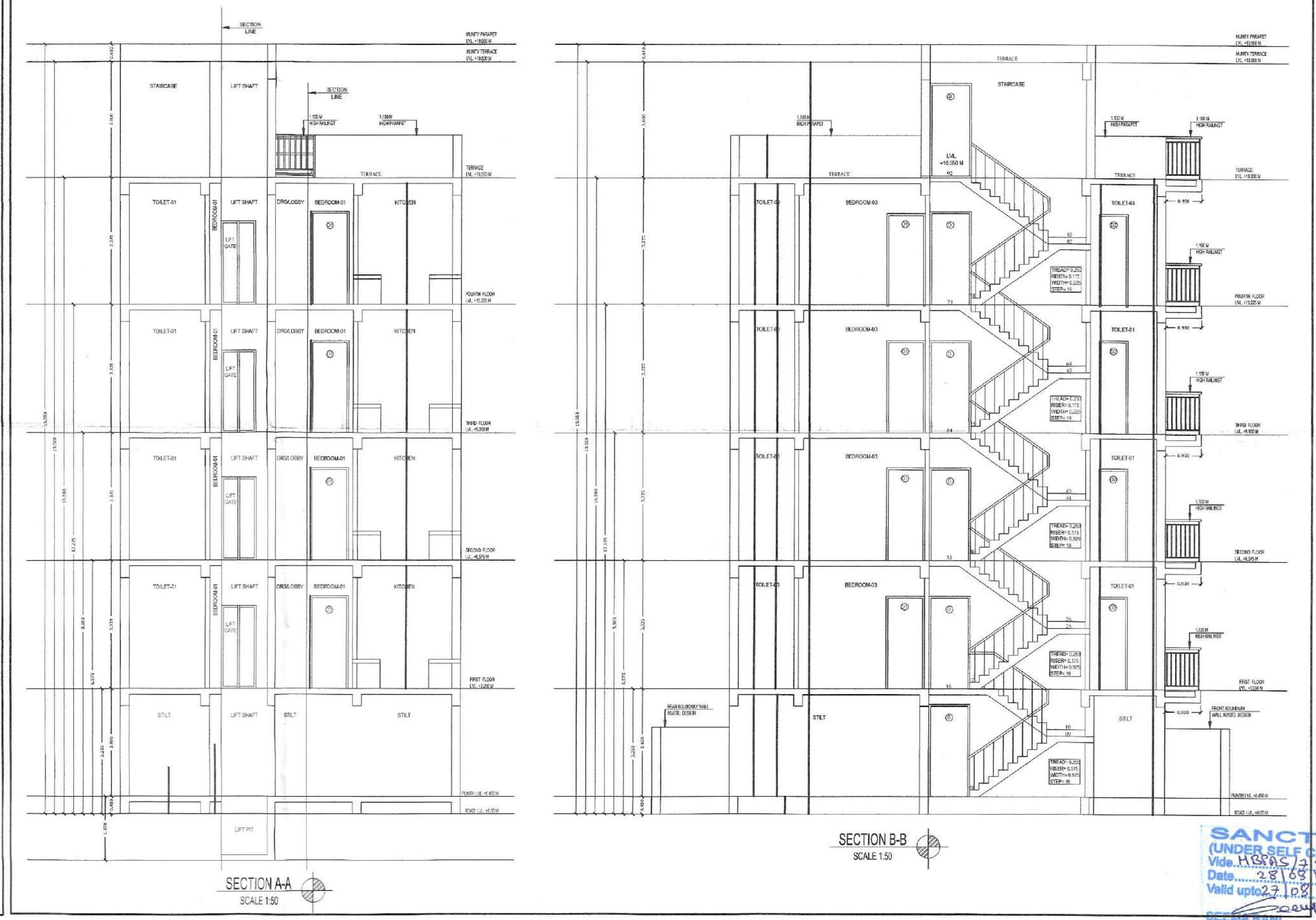

OWNER NAME:- LION INFRADEVELOPERS LLP
 PLOT NO= A-05
 at Sector 06, Sohna, Haryana

PROJECT NAME:- RESIDENTIAL PLOTTED COLONY UNDER DDJAY MERASURING 12.505 ACRES (LICENCE NO. 188 OF 2023 DATED 15.09.2023) IN SECTOR-06, SOHNA BEING DEVELOPED BY LION INFRADEVELOPERS LLP.

STILT FLOOR PLAN, FIRST FLOOR PLAN, SECOND FLOOR PLAN, THIRD FLOOR PLAN, FOURTH FLOOR PLAN, TERRACE PLAN, MUMTY PLAN, D/W SCHEDULE, AREA CHART, ELEVATION & SECTION

Drq. No.- AR/PLOT NO-A-05/SHEET 01 OF 01 Scale 1:50

ARCHITECTS SIGN: *Seema Rani*
 Signature of Architect
SEEMA RANI
 CA/2015/72259

OWNER'S SIGN: *Pankaj Kapoor*
 FOR LION INFRADEVELOPERS LLP
 AUTHORIZED SIGNATORY

Drawn by:- PANKAJ KAPOOR Mob. No. - 8800093157

SANCTIONED
 (UNDER SELF CERTIFICATION)
 Vide H.O.S. No. J/2947/2024
 Date: 28.08.2024
 Valid upto: 27.08.2025
 (ARCHITECT) CA/2015/2259