



DOOR, WINDOW & VENTILATOR SCHEDULE

S.No.	TYPE	WIDTH	CILL	LINTEL
1	D	1.075	0	2.450
2	D1	1.000	0	2.450
3	D2	0.750	0	2.450
4	D3	0.995	0	2.450
5	DW1	1.750	0	2.450
6	WEF	1.850	0	2.450
7	W1	1.525	900	2.450
8	V/PV	0.750	1.550	2.450

AREA STATEMENT

TOTAL PLOT AREA = 8.650 M X 16.000 M	129.750	sq.mts.	
PERMISSIBLE COVERED F.A.R. @ 200%	259.500	sq.mts.	
TOTAL PERMISSIBLE GROUND COVERAGE @ 75%	97.313	sq.mts.	
ACHIVED F.A.R. @ 64%	83.040	sq.mts.	
TOTAL FAR 264%	342.640	sq.mts.	
PROPOSED F.A.R. AREA OF STILT			
A	1.730 X 1.535	= 2.656 sq.mts.	
B	2.195 X 4.535	= 9.954 sq.mts.	
C	1.730 X 1.730	= 2.993 sq.mts.	
TOTAL FAR AREA OF A+B+C		16.603 sq.mts.	
NON F.A.R. AREA OF STILT			
AA	8.650 X 11.320	= 97.918 sq.mts.	
1+2+A+B+C		20.316 sq.mts.	
TOTAL AREA FAR + NON FAR (AA - 1+2)		77.602 sq.mts.	
PROPOSED F.A.R. ON FIRST FLOOR 81.556			
AA	8.650 X 11.320	= 97.918 sq.mts.	
or	97.918	LESS 16.362	= 81.556 sq.mts.
1	2.485 X 1.585	= 3.889 sq.mts.	
2	6.340 X 0.130	= 0.824 sq.mts.	
3	1.850 X 4.075	= 7.539 sq.mts.	
4	0.230 X 1.075	= 0.247 sq.mts.	
5	1.500 X 1.075	= 1.613 sq.mts.	
6	1.500 X 1.500	= 2.250 sq.mts.	
TOTAL OF 1 TO 6		16.362 sq.mts.	
PROPOSED F.A.R. ON FIRST FLOOR		81.556 sq.mts.	
PROPOSED F.A.R. ON SECOND FLOOR		81.556 sq.mts.	
PROPOSED F.A.R. ON THIRD FLOOR		81.556 sq.mts.	
PROPOSED F.A.R. ON FOURTH FLOOR		81.556 sq.mts.	
TOTAL PROPOSED F.A.R. AREA ON ALL FLOORS (STILT + FF + SF + TP+ 4TH)		341.827 sq.mts.	
NON F.A.R. AREA OF MUMTY			
A	1.730 X 1.535	= 2.656 sq.mts.	
B	2.195 X 4.535	= 9.954 sq.mts.	
C	1.730 X 1.730	= 2.993 sq.mts.	
TOTAL AREA (A+B+C)		16.603 sq.mts.	
FLOORS	FAR AREA	+ NON FAR AREA	TOTAL SQ.MTS.
STILT AREA	16.603	+ 77.602	= 94.205 sq.mts.
FIRST FLOOR	81.556	+ 3+4+5+6	= 93.205 sq.mts.
SECOND FLOOR	81.556	+ 11.649	= 93.205 sq.mts.
THIRD FLOOR	81.556	+ 3+4+5+6	= 93.205 sq.mts.
FOURTH FLOOR	81.556	+ 11.649	= 93.205 sq.mts.
MUMTY AREA	16.603		= 16.603 sq.mts.
TOTAL ALL FLOOR AREA (FAR AREA + NON FAR AREA)			481.628 sq.mts.

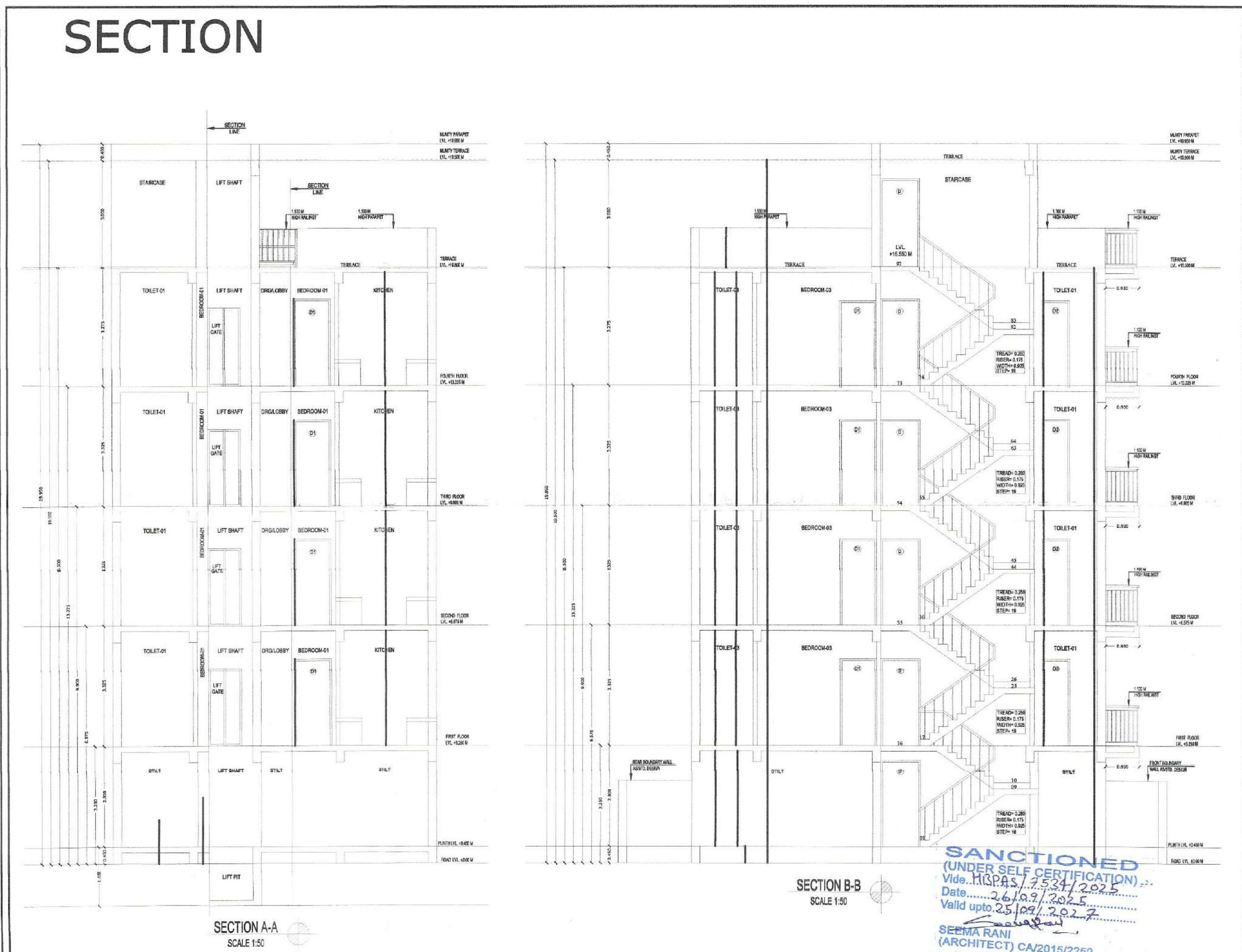

OWNER NAME:- LION INFRADEVELOPERS LLP
 PLOT NO= A-17
 at Sector 06, Sohna, Haryana

PROJECT NAME:- RESIDENTIAL PLOTTED COLONY UNDER DDJAY MERASURING 12.505 ACRES (LICENCE NO. 188 OF 2023 DATED 15.09.2023) IN SECTOR-06, SOHNA BEING DEVELOPED BY LION INFRADEVELOPERS LLP.

STILT FLOOR PLAN, FIRST FLOOR PLAN, SECOND FLOOR PLAN, THIRD FLOOR PLAN, FOURTH FLOOR PLAN, TERRACE PLAN, MUMTY PLAN, D/W SCHEDULE, AREA CHART, ELEVATION & SECTION

Drq. No.- AR/PLOT NO=A-17/SHEET 01 OF 01 Scale 1:50

ARCHITECT'S SIGN OWNER'S SIGN

Signature of Architect
SEEMA RANI
CA/2015/72259

FOR LION INFRADEVELOPERS LLP
AUTHORISED SIGNATORY

Drawn by:- PANKAJ KAPOOR Mob. No. - 8800093157

SANCTIONED
 (UNDER SELF CERTIFICATION)
 Vide HSPAS/7534/2025
 Date: 26/09/2025
 Valid upto 25/09/2027

SEEMA RANI
 (ARCHITECT) CA/2015/2259