

SEWERAGE SCHEME

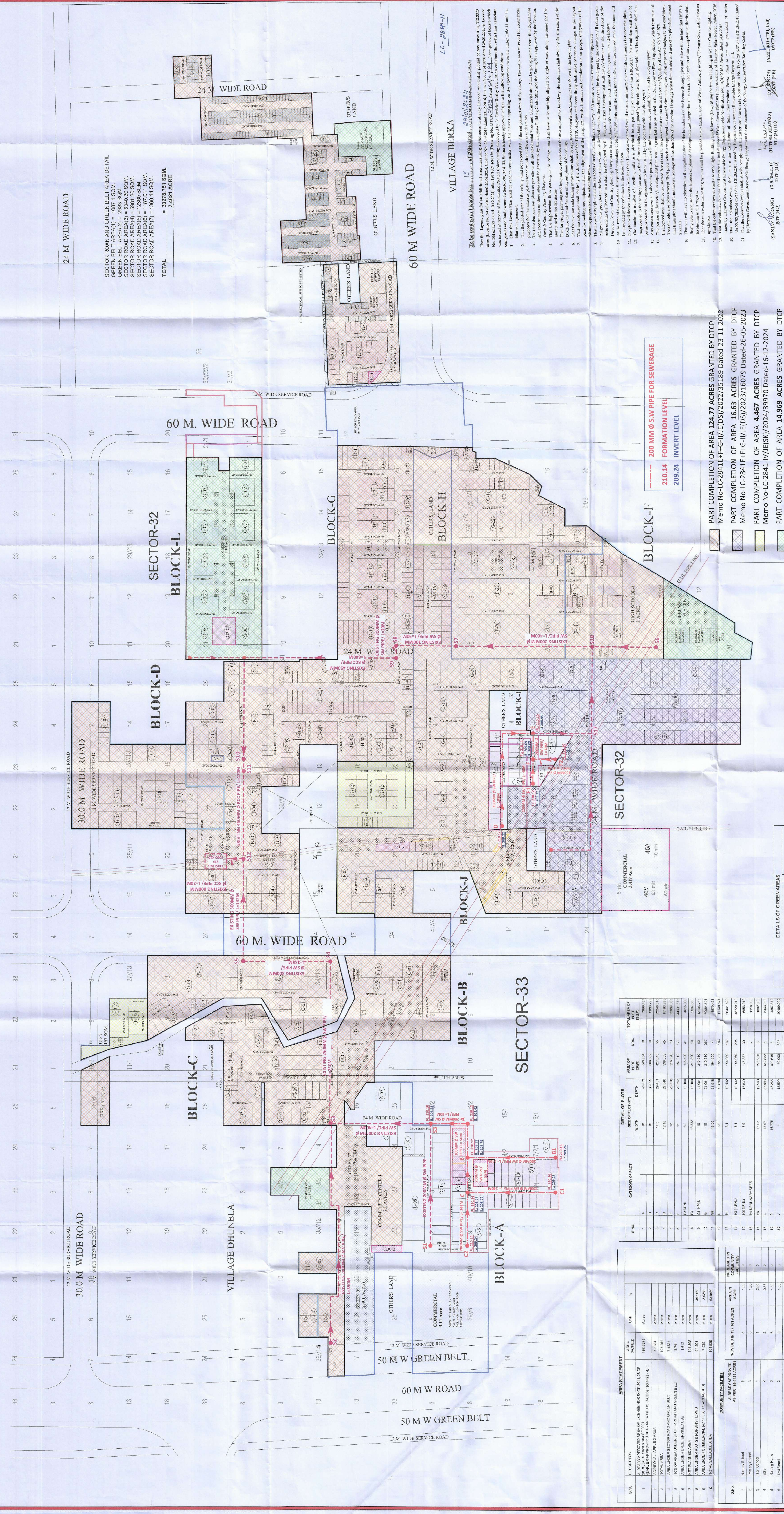

SECTOR ROAN AND GREEN BELT AREA DETAIL
 GREEN BELT AREA(1) = 1087.7 SQM
 SECTOR ROAD AREA(2) = 544.30 SQM
 SECTOR ROAD AREA(3) = 544.30 SQM
 SECTOR ROAD AREA(4) = 5861.20 SQM
 SECTOR ROAD AREA(5) = 1259.34 SQM
 SECTOR ROAD AREA(6) = 1259.34 SQM
 SECTOR ROAD AREA(7) = 1360.14 SQM
TOTAL = 8927.54 SQM = 2.4621 ACRE

VILLAGE BERKA
 L.C. - 284H-17

The layout plan for an additional sewerage scheme covering 4.24 acres in Village Berka, District of Patkote, is shown. The layout plan is prepared in accordance with the provisions of the Patkote Municipal Corporation Act, 1972 and the Patkote Municipal Corporation (Amendment) Act, 2018. The layout plan is prepared in accordance with the provisions of the Patkote Municipal Corporation Act, 1972 and the Patkote Municipal Corporation (Amendment) Act, 2018. The layout plan is prepared in accordance with the provisions of the Patkote Municipal Corporation Act, 1972 and the Patkote Municipal Corporation (Amendment) Act, 2018.

- PART COMPLETION OF AREA 124.77 ACRES GRANTED BY DTCP
 Memo No-LC-2841E-FG-II/E(S)/2022/35189 Dated-23-11-2022
- PART COMPLETION OF AREA 16.63 ACRES GRANTED BY DTCP
 Memo No-LC-2841E-FG-II/E(S)/2023/16079 Dated-26-05-2023
- PART COMPLETION OF AREA 4.467 ACRES GRANTED BY DTCP
 Memo No-LC-2841-V/E(S)/2024/59970 Dated-16-12-2024
- PART COMPLETION OF AREA 14.969 ACRES GRANTED BY DTCP
 Memo No-LC-2841-V/E(S)/2024/41688 Dated-27-12-2024

OWNER'S SIGNATURE AUTHORIZED SIGNATURE:
 ARCHITECT'S SIGNATURE:
 DRAWING TITLE:
LAYOUT PLAN
 REVISION:
R 0
 NORTH
 SCALE:
1 : 1800
 OWNER NAME:
ST. PATRICKS REALTY PRIVATE LIMITED
 Office: The Station, Coimbatore - 641005

LEGEND

DETAIL	AREA (IN ACRE)
NWP PLOTS	105.4083 ACRES
LICENSE NO.54 OF 2014	23.05 ACRES
LICENSE NO.28 OF 2016	20.225 ACRES
LICENSE NO.07 OF 2020	47.759 ACRES
LICENSE NO.104 OF 2021	4.8284 ACRES
ADDITIONAL AREA APPLIED	0.94 ACRES
AREA CHANGE	

Checked and approved by:
 D. Srinivasan, Jt. Commr.
 for Coimbatore City Municipal Corporation
 Coimbatore

DETAILS OF PLOTS

S. NO.	DESCRIPTION	AREA (SQ. M)	NO. OF PLOTS	NO. OF HOUSES
1	GREEN-1	462.500	2,401	1,197
2	GREEN-2	870.000	2,152	1,004
3	GREEN-3	295.500	1,004	482
4	GREEN-4	415.500	1,004	482
5	GREEN-5	208.800	1,004	482
6	GREEN-6	208.800	1,004	482
7	GREEN-7	208.800	1,004	482
8	GREEN-8	208.800	1,004	482
9	GREEN-9	208.800	1,004	482
10	GREEN-10	208.800	1,004	482
11	GREEN-11	208.800	1,004	482
12	GREEN-12	208.800	1,004	482
13	GREEN-13	208.800	1,004	482
14	GREEN-14	208.800	1,004	482
15	GREEN-15	208.800	1,004	482
16	GREEN-16	208.800	1,004	482
17	GREEN-17	208.800	1,004	482
18	GREEN-18	208.800	1,004	482
19	GREEN-19	208.800	1,004	482
20	GREEN-20	208.800	1,004	482
21	GREEN-21	208.800	1,004	482
22	GREEN-22	208.800	1,004	482
23	GREEN-23	208.800	1,004	482
24	GREEN-24	208.800	1,004	482
25	GREEN-25	208.800	1,004	482
26	GREEN-26	208.800	1,004	482
27	GREEN-27	208.800	1,004	482
28	GREEN-28	208.800	1,004	482
29	GREEN-29	208.800	1,004	482
30	GREEN-30	208.800	1,004	482
31	GREEN-31	208.800	1,004	482
32	GREEN-32	208.800	1,004	482
33	GREEN-33	208.800	1,004	482
34	GREEN-34	208.800	1,004	482
35	GREEN-35	208.800	1,004	482
36	GREEN-36	208.800	1,004	482
37	GREEN-37	208.800	1,004	482
38	GREEN-38	208.800	1,004	482
39	GREEN-39	208.800	1,004	482
40	GREEN-40	208.800	1,004	482
41	GREEN-41	208.800	1,004	482
42	GREEN-42	208.800	1,004	482
43	GREEN-43	208.800	1,004	482
44	GREEN-44	208.800	1,004	482
45	GREEN-45	208.800	1,004	482
46	GREEN-46	208.800	1,004	482
47	GREEN-47	208.800	1,004	482
48	GREEN-48	208.800	1,004	482
49	GREEN-49	208.800	1,004	482
50	GREEN-50	208.800	1,004	482
51	GREEN-51	208.800	1,004	482
52	GREEN-52	208.800	1,004	482
53	GREEN-53	208.800	1,004	482
54	GREEN-54	208.800	1,004	482
55	GREEN-55	208.800	1,004	482
56	GREEN-56	208.800	1,004	482
57	GREEN-57	208.800	1,004	482
58	GREEN-58	208.800	1,004	482
59	GREEN-59	208.800	1,004	482
60	GREEN-60	208.800	1,004	482
61	GREEN-61	208.800	1,004	482
62	GREEN-62	208.800	1,004	482
63	GREEN-63	208.800	1,004	482
64	GREEN-64	208.800	1,004	482
65	GREEN-65	208.800	1,004	482
66	GREEN-66	208.800	1,004	482
67	GREEN-67	208.800	1,004	482
68	GREEN-68	208.800	1,004	482
69	GREEN-69	208.800	1,004	482
70	GREEN-70	208.800	1,004	482
71	GREEN-71	208.800	1,004	482
72	GREEN-72	208.800	1,004	482
73	GREEN-73	208.800	1,004	482
74	GREEN-74	208.800	1,004	482
75	GREEN-75	208.800	1,004	482
76	GREEN-76	208.800	1,004	482
77	GREEN-77	208.800	1,004	482
78	GREEN-78	208.800	1,004	482
79	GREEN-79	208.800	1,004	482
80	GREEN-80	208.800	1,004	482
81	GREEN-81	208.800	1,004	482
82	GREEN-82	208.800	1,004	482
83	GREEN-83	208.800	1,004	482
84	GREEN-84	208.800	1,004	482
85	GREEN-85	208.800	1,004	482
86	GREEN-86	208.800	1,004	482
87	GREEN-87	208.800	1,004	482
88	GREEN-88	208.800	1,004	482
89	GREEN-89	208.800	1,004	482
90	GREEN-90	208.800	1,004	482
91	GREEN-91	208.800	1,004	482
92	GREEN-92	208.800	1,004	482
93	GREEN-93	208.800	1,004	482
94	GREEN-94	208.800	1,004	482
95	GREEN-95	208.800	1,004	482
96	GREEN-96	208.800	1,004	482
97	GREEN-97	208.800	1,004	482
98	GREEN-98	208.800	1,004	482
99	GREEN-99	208.800	1,004	482
100	GREEN-100	208.800	1,004	482

DETAILS OF PLOTS

S. NO.	DESCRIPTION	AREA (SQ. M)	NO. OF PLOTS	NO. OF HOUSES
1	GREEN-1	462.500	2,401	1,197
2	GREEN-2	870.000	2,152	1,004
3	GREEN-3	295.500	1,004	482
4	GREEN-4	415.500	1,004	482
5	GREEN-5	208.800	1,004	482
6	GREEN-6	208.800	1,004	482
7	GREEN-7	208.800	1,004	482
8	GREEN-8	208.800	1,004	482
9	GREEN-9	208.800	1,004	482
10	GREEN-10	208.800	1,004	482
11	GREEN-11	208.800	1,004	482
12	GREEN-12	208.800	1,004	482
13	GREEN-13	208.800	1,004	482
14	GREEN-14	208.800	1,004	482
15	GREEN-15	208.800	1,004	482
16	GREEN-16	208.800	1,004	482
17	GREEN-17	208.800	1,004	482
18	GREEN-18	208.800	1,004	482
19	GREEN-19	208.800	1,004	482
20	GREEN-20	208.800	1,004	482
21	GREEN-21	208.800	1,004	482
22	GREEN-22	208.800	1,004	482
23	GREEN-23	208.800	1,004	482
24	GREEN-24	208.800	1,004	482
25	GREEN-25	208.800	1,004	482
26	GREEN-26	208.800	1,004	482
27	GREEN-27	208.800	1,004	482
28	GREEN-28	208.800	1,004	482
29	GREEN-29	208.800	1,004	482
30	GREEN-30	208.800	1,004	482
31	GREEN-31	208.800	1,004	482
32	GREEN-32	208.800	1,004	482
33	GREEN-33	208.800	1,004	482
34	GREEN-34	208.800	1,004	482
35	GREEN-35	208.800	1,004	482
36	GREEN-36	208.800	1,004	482
37	GREEN-37	208.800	1,004	482
38	GREEN-38	208.800	1,004	482
39	GREEN-39	208.800	1,004	482
40	GREEN-40	208.800	1,004	482
41	GREEN-41	208.800	1,004	482
42	GREEN-42	208.800	1,004	482
43	GREEN-43	208.800	1,004	482
44	GREEN-44	208.800	1,004	482
45	GREEN-45	208.800	1,004	482
46	GREEN-46	208.800	1,004	482
47	GREEN-47	208.800	1,004	482
48	GREEN-48	208.800	1,004	482
49	GREEN-49	208.800	1,004	482
50	GREEN-50	208.800	1,004	482
51	GREEN-51	208.800	1,004	482
52	GREEN-52	208.800	1,004	482
53	GREEN-53	208.800	1,004	482
54	GREEN-54	208.800	1,004	482
55	GREEN-55	208.800	1,004	482
56	GREEN-56	208.800	1,004	482
57	GREEN-57	208.800	1,004	482
58	GREEN-58	208.800	1,004	482
59	GREEN-59	208.800	1,004	482
60	GREEN-60	208.800	1,004	482
61	GREEN-61	208.800	1,004	482
62	GREEN-62	208.800	1,004	482
63	GREEN-63	208.800	1,004	482
64	GREEN-64	208.800	1,004	482
65	GREEN-65	208.800	1,004	482
66	GREEN-66	208.800	1,004	482
67	GREEN-67	208.800	1,004	482
68	GREEN-68	208.800	1,004	482
69	GREEN-69	208.800	1,004	482
70	GREEN-70	208.800	1,004	482
71	GREEN-71	208.800	1,004	482
72	GREEN-72	208.800	1,004	482
73	GREEN-73	208.800	1,004	482
74	GREEN-74	208.800	1,004	482
75	GREEN-75	208.800	1,004	482
76	GREEN-76	208.800	1,004	482
77	GREEN-77	208.800	1,004	482
78	GREEN-78	208.800	1,004	482
79	GREEN-79	208.800	1,004	482
80	GREEN-80	208.800	1,004	482
81	GREEN-81	208.800	1,004	482
82	GREEN-82	208.800	1,004	482
83	GREEN-83	208.800	1,004	482
84	GREEN-84	208.800	1,004	482
85	GREEN-85	208.800	1,004	482
86	GREEN-86	208.800	1,004	482
87	GREEN-87	208.800	1,004	482
88	GREEN-88	208.800	1,004	482
89	GREEN-89	208.800	1,004	482
90	GREEN-90	208.800	1,004	482
91	GREEN-91	208.800	1,004	482
92	GREEN-92	208.800	1,004	482
93	GREEN-93	208.800	1,004	482
94	GREEN-94	208.800	1,004	482
95	GREEN-95	208.800	1,004	482
96	GREEN-96	208.800	1,004	482
97	GREEN-97	208.800	1,004	482
98	GREEN-98	208.800	1,004	482
99	GREEN-99	208.800	1,004	482
100	GREEN-100	208.800	1,004	482

Supernormal Engineering
 HSP, Coimbatore

Checked and approved by:
 D. Srinivasan, Jt. Commr.
 for Coimbatore City Municipal Corporation
 Coimbatore

DETAILS OF PLOTS

S. NO.	DESCRIPTION	AREA (SQ. M)	NO. OF PLOTS	NO. OF HOUSES
1	GREEN-1	462.500	2,401	1,197
2	GREEN-2	870.000	2,152	1,004
3	GREEN-3	295.500	1,004	482
4	GREEN-4	415.500	1,004	482
5	GREEN-5	208.800	1,004	482