

PHASE-WISE DIVISION PLAN
 27-483-AD(V)K/2023/1517, DATED: 22.05.2024

	PHASE-1 AREA: 4.328 ACRES	TOWER-1, 2, 3, 4, 5, 10x11
	PHASE-2 AREA: 1.894 ACRES	TOWER-5, 6, 7, 8, 9, 10x11 LOCK & SWIMMING POOL
	PHASE-3 AREA: 0.829 ACRES	ROW HOUSE 1 TO 6
	PHASE-4 AREA: 0.559 ACRES	EWS & NURSERY SCHOOL
	PHASE-5 AREA: 2.752 ACRES	COMMERCIAL BUILDING
TOTAL AREA = 13.079 ACRE		

NOTE:
 BUILDING PLAN ALREADY SANCTIONED (PHASE-1, 2, 3, 4 & 5)
 VIDE MEMO NO. 27-483-AD(V)K/2023/1517, DATED: 22.05.2024

NOTE:
 BUILDING PLAN ALREADY SANCTIONED (PHASE-1, 2, 3, 4 & 5)
 VIDE MEMO NO. 27-483-AD(V)K/2023/1517, DATED: 22.05.2024

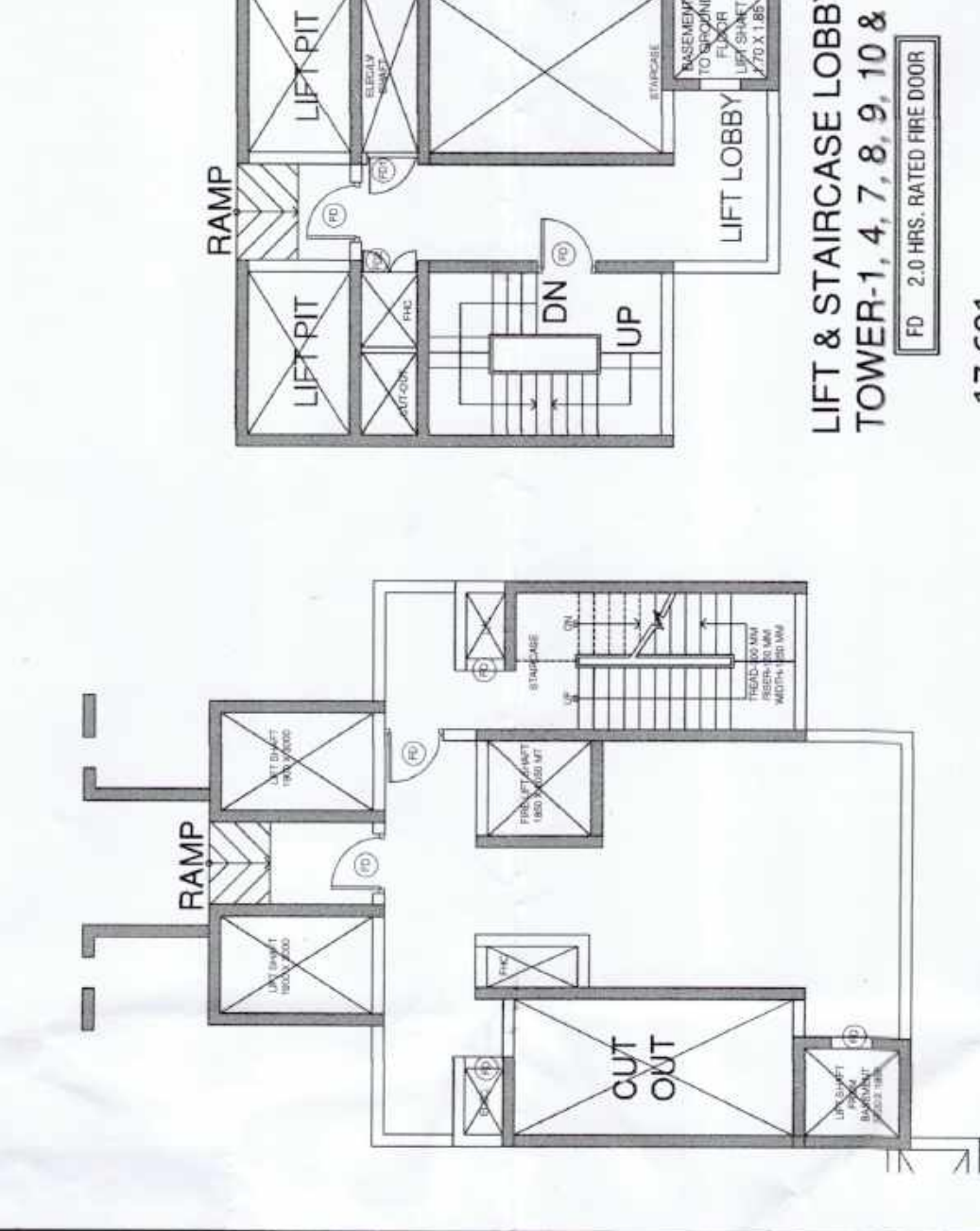

LIFT & STAIRCASE LOBBY
 TOWER-1, 4, 7, 8, 9, 10 & 11
 (TO 2 FIRE RATED FLOOR)

LIFT & STAIRCASE LOBBY
 TOWER-2, 3, 5 & 6
 (TO 2 FIRE RATED FLOOR)

NOTE:
 BUILDING PLAN ALREADY SANCTIONED (PHASE-1, 2, 3, 4 & 5)
 VIDE MEMO NO. 27-483-AD(V)K/2023/1517, DATED: 22.05.2024

	PLOT LINE FOR HOUSING
	SET BACK LINE
	BASEMENT LINE
	SERVICES AREA LINE

NOTE:
 BUILDING PLAN ALREADY SANCTIONED (PHASE-1, 2, 3, 4 & 5)
 VIDE MEMO NO. 27-483-AD(V)K/2023/1517, DATED: 22.05.2024

NOTE:
 BUILDING PLAN ALREADY SANCTIONED (PHASE-1, 2, 3, 4 & 5)
 VIDE MEMO NO. 27-483-AD(V)K/2023/1517, DATED: 22.05.2024

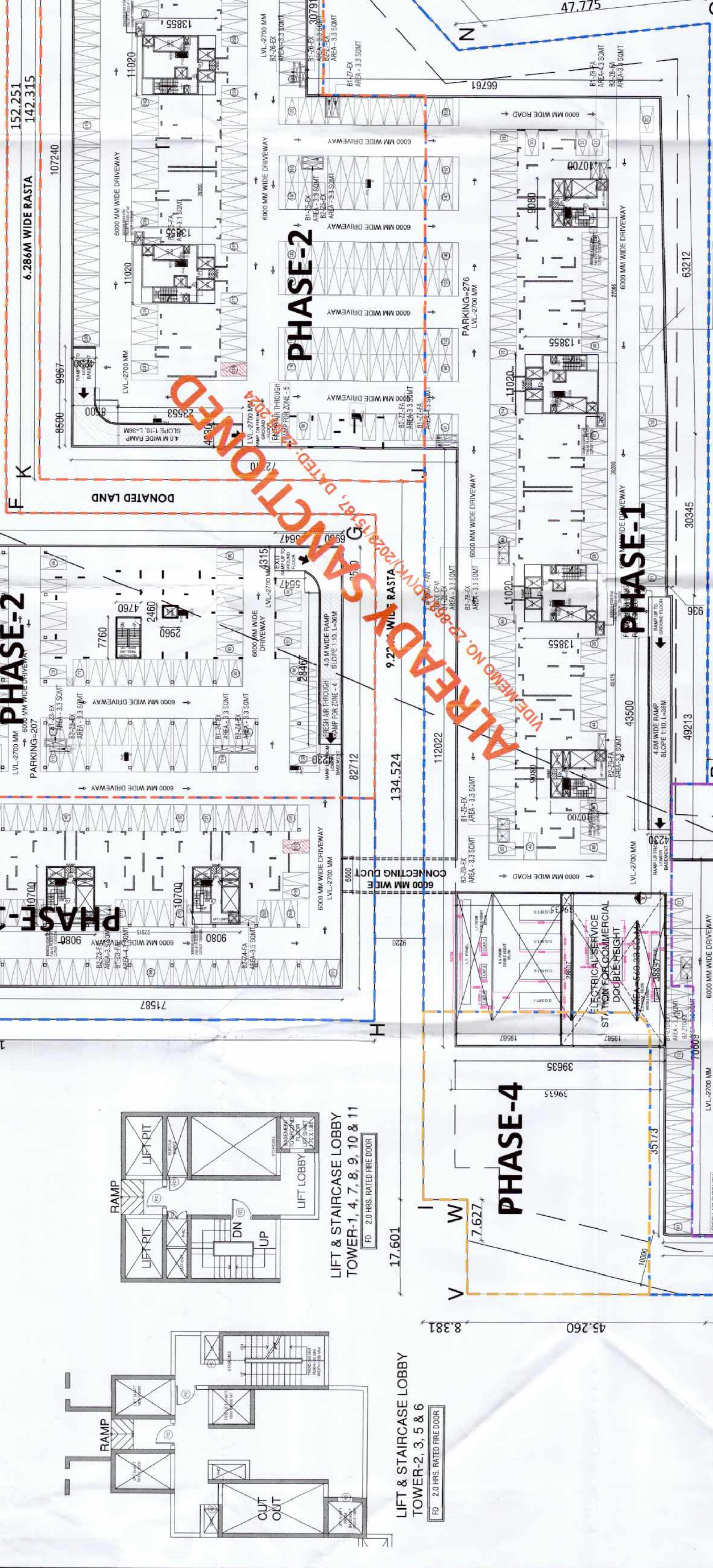

NOTE:
 BUILDING PLAN ALREADY SANCTIONED (PHASE-1, 2, 3, 4 & 5)
 VIDE MEMO NO. 27-483-AD(V)K/2023/1517, DATED: 22.05.2024

NOTE:
 BUILDING PLAN ALREADY SANCTIONED (PHASE-1, 2, 3, 4 & 5)
 VIDE MEMO NO. 27-483-AD(V)K/2023/1517, DATED: 22.05.2024

NOTE:
 BUILDING PLAN ALREADY SANCTIONED (PHASE-1, 2, 3, 4 & 5)
 VIDE MEMO NO. 27-483-AD(V)K/2023/1517, DATED: 22.05.2024

NOTE:
 BUILDING PLAN ALREADY SANCTIONED (PHASE-1, 2, 3, 4 & 5)
 VIDE MEMO NO. 27-483-AD(V)K/2023/1517, DATED: 22.05.2024

NOTE:
 BUILDING PLAN ALREADY SANCTIONED (PHASE-1, 2, 3, 4 & 5)
 VIDE MEMO NO. 27-483-AD(V)K/2023/1517, DATED: 22.05.2024

NOTE:
 BUILDING PLAN ALREADY SANCTIONED (PHASE-1, 2, 3, 4 & 5)
 VIDE MEMO NO. 27-483-AD(V)K/2023/1517, DATED: 22.05.2024

NOTE:
 BUILDING PLAN ALREADY SANCTIONED (PHASE-1, 2, 3, 4 & 5)
 VIDE MEMO NO. 27-483-AD(V)K/2023/1517, DATED: 22.05.2024

NOTE:
 BUILDING PLAN ALREADY SANCTIONED (PHASE-1, 2, 3, 4 & 5)
 VIDE MEMO NO. 27-483-AD(V)K/2023/1517, DATED: 22.05.2024

NOTE:
 BUILDING PLAN ALREADY SANCTIONED (PHASE-1, 2, 3, 4 & 5)
 VIDE MEMO NO. 27-483-AD(V)K/2023/1517, DATED: 22.05.2024

NOTE:
 BUILDING PLAN ALREADY SANCTIONED (PHASE-1, 2, 3, 4 & 5)
 VIDE MEMO NO. 27-483-AD(V)K/2023/1517, DATED: 22.05.2024

NOTE:
 BUILDING PLAN ALREADY SANCTIONED (PHASE-1, 2, 3, 4 & 5)
 VIDE MEMO NO. 27-483-AD(V)K/2023/1517, DATED: 22.05.2024

NOTE:
 BUILDING PLAN ALREADY SANCTIONED (PHASE-1, 2, 3, 4 & 5)
 VIDE MEMO NO. 27-483-AD(V)K/2023/1517, DATED: 22.05.2024

NOTE:
 BUILDING PLAN ALREADY SANCTIONED (PHASE-1, 2, 3, 4 & 5)
 VIDE MEMO NO. 27-483-AD(V)K/2023/1517, DATED: 22.05.2024

NOTE:
 BUILDING PLAN ALREADY SANCTIONED (PHASE-1, 2, 3, 4 & 5)
 VIDE MEMO NO. 27-483-AD(V)K/2023/1517, DATED: 22.05.2024

SHEET NO. -04/19

THE JAY PRAKASHAN BUILDING PLAN
 APPROVED FOR PHASE-WISE PLAN

DATE: 14.12.2023

DATE: 14.12.2023

DATE: 14.12.2023

DATE: 14.12.2023

DATE: 14.12.2023

DATE: 14.12.2023

DATE: 14.12.2023

DATE: 14.12.2023

DATE: 14.12.2023

DATE: 14.12.2023

DATE: 14.12.2023

DATE: 14.12.2023

DATE: 14.12.2023

DATE: 14.12.2023

DATE: 14.12.2023

DATE: 14.12.2023

DATE: 14.12.2023

DATE: 14.12.2023

DATE: 14.12.2023

DATE: 14.12.2023

DATE: 14.12.2023

DATE: 14.12.2023

DATE: 14.12.2023

DATE: 14.12.2023

DATE: 14.12.2023

DATE: 14.12.2023

PHASE-WISE DIVISION PLAN
 27-483-AD(V)K/2023/1517, DATED: 22.05.2024

NOTE:
 BUILDING PLAN ALREADY SANCTIONED (PHASE-1, 2, 3, 4 & 5)
 VIDE MEMO NO. 27-483-AD(V)K/2023/1517, DATED: 22.05.2024

REVISIONS

SR. NO	TYPE	DATE	BY	REMARKS	
1	D	2000	X	2100	

NOTES:
 1. DIMENSIONS ARE NOT TO BE SCALED.
 2. ALL DIMENSIONS ARE IN MM.
 3. FIRE FIGHTING SAFETY PROVISIONS SHALL BE AS PER RELEVANT FIRE PROVISIONS.
 4. ALL WINDOWS AND DOORS SHALL BE PROVIDED AS PER CENTRAL GOVT. PROVISIONS.
 5. ALL WINDOWS AND DOORS SHALL BE PROVIDED AS PER CENTRAL GOVT. PROVISIONS.
 6. ALL WINDOWS AND DOORS SHALL BE PROVIDED AS PER CENTRAL GOVT. PROVISIONS.
 7. RAIN WATER HARVESTING SYSTEM SHALL BE PROVIDED AS PER CENTRAL GOVT. PROVISIONS.
 8. ALL WINDOWS AND VENTILATORS ARE OPERABLE.
 9. BASEMENT IS TO BE PROVIDED WITH SUFFICIENT LIGHTING AND VENTILATION FOR FIRE FIGHTING.

PROJECT:
 APPROVAL OF REVISED BUILDING PLAN OF PHASE-3 (COMMERCIAL BLOCK) OF MIX LAND USE COLONY (88% RESIDENTIAL COMPONENT & 12% COMMERCIAL COMPONENT) UNDER TRANSIT ORIENTED DEVELOPMENT (TOD) POLICY FOR THE AREA MEASURING 7.0653 ACRES (FALLING WITHIN TRANSITION ZONE) PART OF GROUP-HOUSING COLONY MEASURING 33.076 ACRES (LICENCE NO. 27-483-AD(V)K/2023/1517) AT THE SITE OF GROUP-HOUSING COLONY, MANWAR URBAN COMPLEX BEING DEVELOPED BY SH. KANWAR SINGH & OTHERS IN COLLABORATION WITH 1000 TREES HOUSING PRIVATE LIMITED.

REVISED SUBMISSION DRAWING

DRAWING TITLE:
 BASEMENT-1 PLAN AND AREA DIAGRAM

SCALE: 1:500

DRG. NO.: AR-12

DATE: 14.12.2023

PROJECT ENGINEER (PE)
 HSPV, Patancheru

PROJECT SUPERVISOR (PS)
 HSPV, Patancheru

PROJECT ARCHITECT (PA)
 HSPV, Patancheru

PROJECT CHECKER (PC)
 HSPV, Patancheru

PROJECT DRAWING OFFICER (DO)
 HSPV, Patancheru

PROJECT SUPERVISOR (PS)
 HSPV, Patancheru

PROJECT ARCHITECT (PA)
 HSPV, Patancheru

PROJECT CHECKER (PC)
 HSPV, Patancheru

PROJECT DRAWING OFFICER (DO)
 HSPV, Patancheru

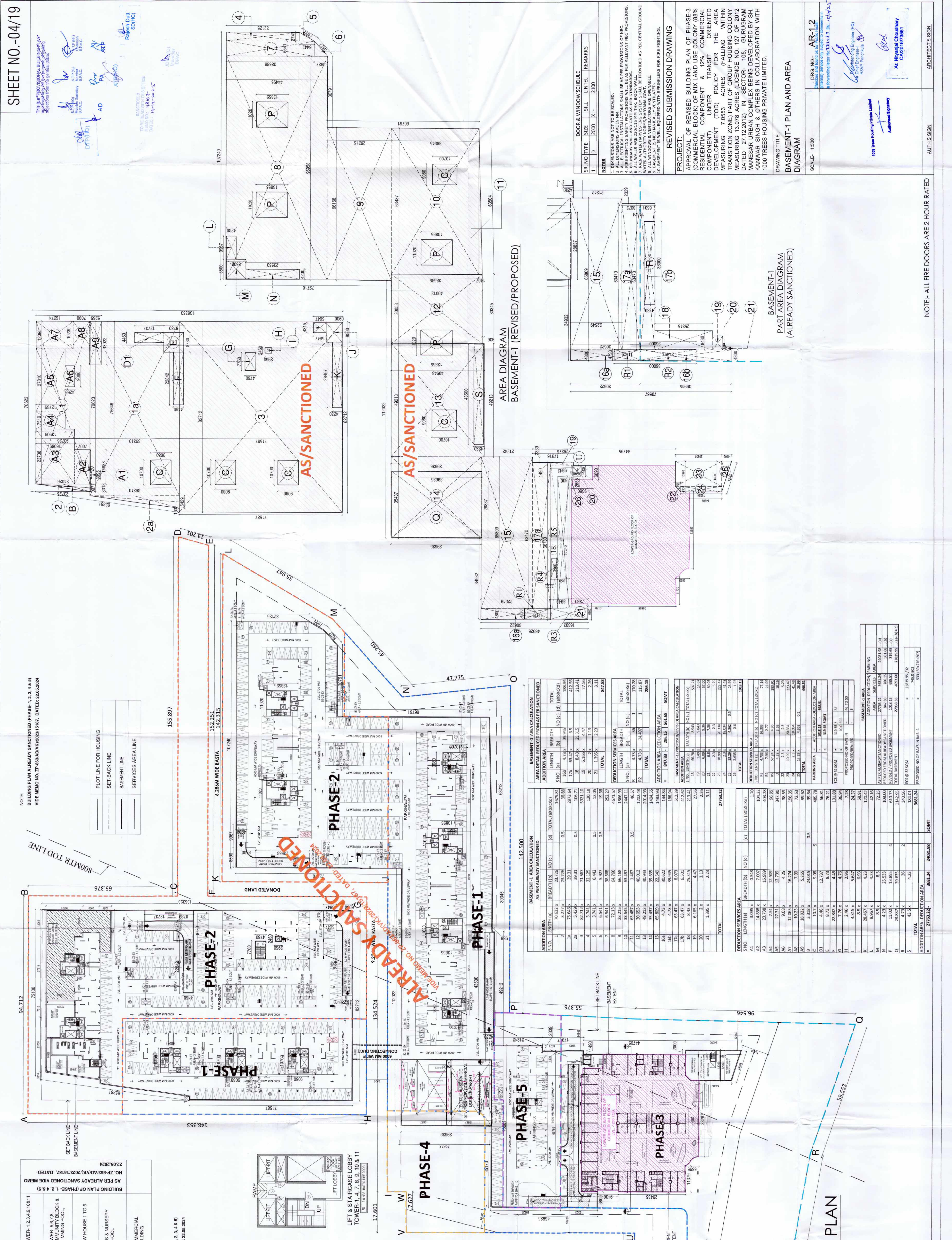

BASEMENT-1 AREA CALCULATION			
S.NO.	LENGTH (L)	BREADTH (B)	TOTAL AREA (A)
1	70.632	23.776	1679.61
2	3.277	23.776	77.94
3	7.458	38.111	284.24
4	7.458	38.111	284.24
5	82.713	71.587	5921.10
6	3.741	32.125	120.18
7	3.741	6.442	24.06
8	6.541	3.927	25.68
9	71.133	64.766	4607.57
10	38.543	64.487	2484.11
11	69.487	1.467	101.47
12	20.628	40.012	825.48
13	35.437	39.635	1404.55
14	65.809	22.649	1489.93
15	4.733	30.622	144.84
16	4.733	39.945	189.54
17	63.277	6.079	384.77
18	8.833	25.315	223.41
19	6.165	4.47	27.56
20	2.4	2.25	5.4
21	1.395	2.23	3.11
TOTAL			27763.23

BASEMENT-1 AREA CALCULATION AFTER REMOVAL OF SANCTIONED AREA			
S.NO.	LENGTH (L)	BREADTH (B)	TOTAL AREA (A)
1	70.632	23.776	1679.61
2	3.277	23.776	77.94
3	7.458	38.111	284.24
4	7.458	38.111	284.24
5	82.713	71.587	5921.10
6	3.741	32.125	120.18
7	3.741	6.442	24.06
8	6.541	3.927	25.68
9	71.133	64.766	4607.57
10	38.543	64.487	2484.11
11	69.487	1.467	101.47
12	20.628	40.012	825.48
13	35.437	39.635	1404.55
14	65.809	22.649	1489.93
15	4.733	30.622	144.84
16	4.733	39.945	189.54
17	63.277	6.079	384.77
18	8.833	25.315	223.41
19	6.165	4.47	27.56
20	2.4	2.25	5.4
21	1.395	2.23	3.11
TOTAL			27763.23

BASEMENT-1 AREA CALCULATION AFTER REMOVAL OF SANCTIONED AREA (CONTINUED)			
S.NO.	LENGTH (L)	BREADTH (B)	TOTAL AREA (A)
22	1.395	2.23	3.11
23	2.4	2.25	5.4
24	6.165	4.47	27.56
25	8.833	25.315	223.41
26	63.277	6.079	384.77
27	4.733	30.622	144.84
28	4.733	39.945	189.54
29	63.277	6.079	384.77
30	8.833	25.315	223.41
31	6.165	4.47	27.56
32	2.4	2.25	5.4
33	1.395	2.23	3.11
TOTAL			27763.23

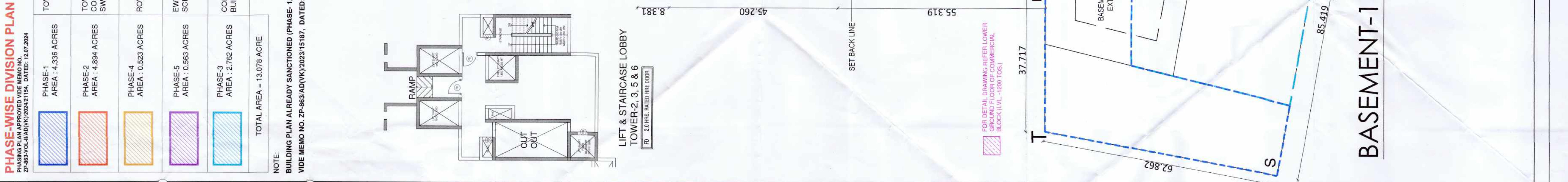
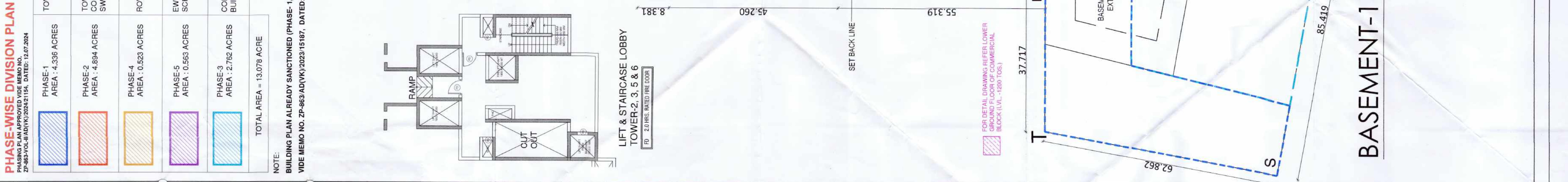

BASEMENT-1 AREA CALCULATION			
S.NO.	LENGTH (L)	BREADTH (B)	TOTAL AREA (A)
1	70.632	23.776	1679.61
2	3.277	23.776	77.94
3	7.458	38.111	284.24
4	7.458	38.111	284.24
5	82.713	71.587	5921.10
6	3.741	32.125	120.18
7	3.741	6.442	24.06
8	6.541	3.927	25.68
9	71.133	64.766	4607.57
10	38.543	64.487	2484.11
11	69.487	1.467	101.47
12	20.628	40.012	825.48
13	35.437	39.635	1404.55
14	65.809	22.649	1489.93
15	4.733	30.622	144.84
16	4.733	39.945	189.54
17	63.277	6.079	384.77
18	8.833	25.315	223.41
19	6.165	4.47	27.56
20	2.4	2.25	5.4
21	1.395	2.23	3.11
TOTAL			27763.23

BASEMENT-1 AREA CALCULATION AFTER REMOVAL OF SANCTIONED AREA			
S.NO.	LENGTH (L)	BREADTH (B)	TOTAL AREA (A)
1	70.632	23.776	1679.61
2	3.277	23.776	77.94
3	7.458	38.111	284.24
4	7.458	38.111	284.24
5	82.713	71.587	5921.10
6	3.741	32.125	120.18
7	3.741	6.442	24.06
8	6.541	3.927	25.68
9	71.133	64.766	4607.57
10	38.543	64.487	2484.11
11	69.487	1.467	101.47
12	20.628	40.012	825.48
13	35.437	39.635	1404.55
14	65.809	22.649	1489.93
15	4.733	30.622	144.84
16	4.733	39.945	189.54
17	63.277	6.079	384.77
18	8.833	25.315	223.41
19	6.165	4.47	27.56
20	2.4	2.25	5.4
21	1.395	2.23	3.11
TOTAL			27763.23

BASEMENT-1 AREA CALCULATION AFTER REMOVAL OF SANCTIONED AREA (CONTINUED)			
S.NO.	LENGTH (L)	BREADTH (B)	TOTAL AREA (A)
22	1.395	2.23	3.11
23	2.4	2.25	5.4
24	6.165	4.47	27.56
25	8.833	25.315	223.41
26	63.277	6.079	384.77
27	4.733	30.622	144.84
28	4.733	39.945	189.54
29	63.277	6.079	384.77
30	8.833	25.315	223.41
31	6.165	4.47	27.56
32	2.4	2.25	5.4
33	1.395	2.23	3.11
TOTAL			27763.23

BASEMENT-1 AREA CALCULATION AFTER REMOVAL OF SANCTIONED AREA (CONTINUED)			
S.NO.	LENGTH (L)	BREADTH (B)	TOTAL AREA (A)
34	1.395	2.23	3.11
35	2.4	2.25	5.4
36	6.165	4.47	27.56
37	8.833	25.315	223.41
38	63.277	6.079	384.77
39	4.733	30.622	144.84
40	4.733	39.945	189.54
41	63.277	6.079	384.77
42	8.833	25.315	223.41
43	6.165	4.47	27.56
44	2.4	2.25	5.4
45	1.395	2.23	3.11
TOTAL			27763.23

BASEMENT-1 AREA CALCULATION AFTER REMOVAL OF SANCTIONED AREA (CONTINUED)			
S.NO.	LENGTH (L)	BREADTH (B)	TOTAL AREA (A)
46	1.395	2.23	3.11
47	2.4	2.25	5.4
48	6.165	4.47	27.56
49	8.833	25.315	223.41

