

DOOR, WINDOW & VENTILATOR SCHEDULE				
S.No.	TYPE	WIDTH	CILL	LINTEL
1	D	1.075	0	2.450
2	D1	1.000	0	2.450
3	D2	0.750	0	2.450
4	D3	0.995	0	2.450
5	DW1	1.750	0	2.450
6	W/EF	1.850	0	2.450
7	W1	1.525	900	2.450
8	VPV	0.750	1.550	2.450

AREA STATEMENT					
TOTAL PLOT AREA = 8.650 M X 15.000 M		129.750	sq.mts.		
PERMISSIBLE COVERED F.A.R @ 200%		259.500	sq.mts.		
TOTAL PERMISSIBLE GROUND COVERAGE @ 75%		97.313	sq.mts.		
ACHIVED F.A.R @ 64%		83.040	sq.mts.		
<b>TOTAL FAR 264%</b>		<b>342.540</b>	<b>sq.mts.</b>		
<b>PROPOSED F.A.R. AREA OF STILT</b>					
A	1.730 X 1.535	=	2.656 sq.mts.		
B	2.195 X 4.535	=	9.954 sq.mts.		
C	1.730 X 1.730	=	2.993 sq.mts.		
<b>TOTAL FAR AREA OF A+B+C</b>		<b>=</b>	<b>15.603 sq.mts.</b>		
<b>NON F.A.R. AREA OF STILT</b>					
AA	8.650 X 11.320	=	97.918 sq.mts.		
<b>1*2*A+B+C</b>		<b>=</b>	<b>20.316 sq.mts.</b>		
<b>TOTAL AREA FAR + NON FAR (AA - 1*2)</b>		<b>=</b>	<b>77.602 sq.mts.</b>		
<b>PROPOSED F.A.R. ON FIRST FLOORS 854</b>					
AA	8.650 X 11.320	=	97.918 sq.mts.		
1	2.485 X 1.565	=	3.889 sq.mts.		
2	6.340 X 0.130	=	0.824 sq.mts.		
3	1.850 X 4.075	=	7.539 sq.mts.		
4	0.230 X 1.075	=	0.247 sq.mts.		
5	1.500 X 1.075	=	1.613 sq.mts.		
6	1.500 X 1.500	=	2.250 sq.mts.		
<b>TOTAL OF 1 TO 6</b>		<b>=</b>	<b>16.362 sq.mts.</b>		
<b>PROPOSED F.A.R. ON FIRST FLOOR</b>		<b>=</b>	<b>81.556 sq.mts.</b>		
<b>PROPOSED F.A.R. ON SECOND FLOOR</b>		<b>=</b>	<b>81.556 sq.mts.</b>		
<b>PROPOSED F.A.R. ON THIRD FLOOR</b>		<b>=</b>	<b>81.556 sq.mts.</b>		
<b>PROPOSED F.A.R. ON FOURTH FLOOR</b>		<b>=</b>	<b>81.556 sq.mts.</b>		
<b>TOTAL PROPOSED F.A.R. AREA ON ALL FLOORS (STILT + FF + SF + TF+ 4TH)</b>		<b>=</b>	<b>341.827 sq.mts.</b>		
<b>NON F.A.R. AREA OF MUMTY</b>					
A	1.730 X 1.535	=	2.656 sq.mts.		
B	2.195 X 4.535	=	9.954 sq.mts.		
C	1.730 X 1.730	=	2.993 sq.mts.		
<b>TOTAL AREA (A+B+C)</b>		<b>=</b>	<b>15.603 sq.mts.</b>		
<b>FLOORS</b>	<b>FAR AREA</b>	<b>+</b>	<b>NON FAR AREA</b>	<b>TOTAL</b>	<b>SQ. MTS.</b>
STILT AREA	15.603	+	77.602	=	93.205 sq.mts.
FIRST FLOOR	81.556	+	11.649	=	93.205 sq.mts.
SECOND FLOOR	81.556	+	11.649	=	93.205 sq.mts.
THIRD FLOOR	81.556	+	11.649	=	93.205 sq.mts.
FOURTH FLOOR	81.556	+	11.649	=	93.205 sq.mts.
MUMTY AREA			15.603	=	15.603 sq.mts.
<b>TOTAL ALL FLOOR AREA (FAR AREA + NON FAR AREA)</b>		<b>=</b>	<b>481.628</b>	<b>sq.mts.</b>	

**ELEVATION**



**SECTION**

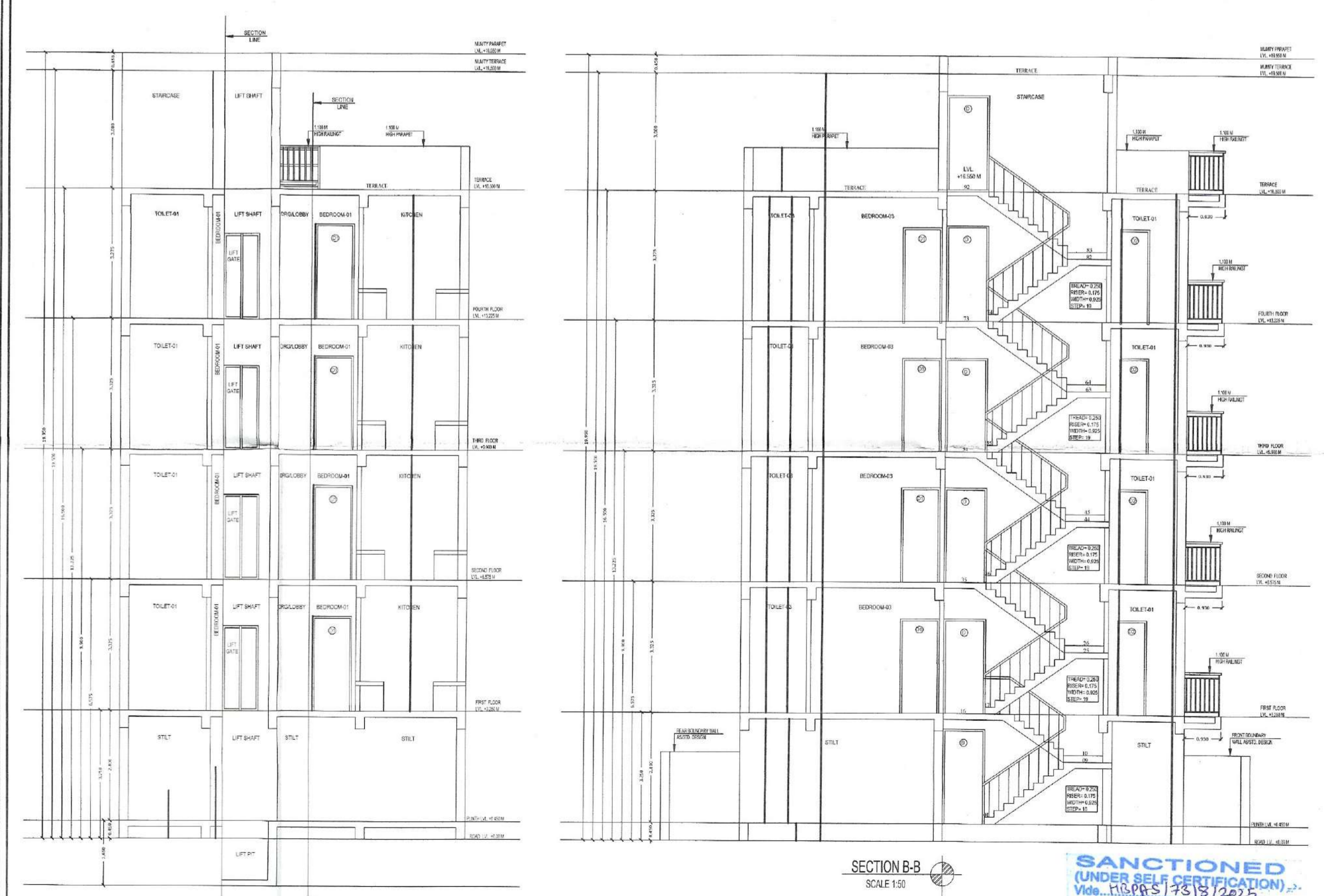

**SANCTIONED**  
(UNDER SELF CERTIFICATION)  
Vide. H.O.P.S. 7518/2025  
Date: 23.08.2025  
Valid upto: 27.08.2027  
SEEMA RANI  
(ARCHITECT) CA/2015/2259

**OWNER NAME:-** LION INFRADEVELOPERS LLP  
PLOT NO:- A-11  
at Sector 06, Sohna, Haryana

**PROJECT NAME:-** RESIDENTIAL PLOTTED COLONY UNDER DDJAY MERASURING 12.505 ACRES (LICENCE NO. 186 OF 2023 DATED 15.09.2023) IN SECTOR-06, SOHNA BEING DEVELOPED BY LION INFRADEVELOPERS LLP.

STILT FLOOR PLAN, FIRST FLOOR PLAN, SECOND FLOOR PLAN, THIRD FLOOR PLAN, FOURTH FLOOR PLAN, TERRACE PLAN, MUMTY PLAN, D/W SCHEDULE, AREA CHART, ELEVATION & SECTION

Drg. No:- AR/PLOT NO-A-11/SHEET 01 OF 01      Scale      1:50

ARCHITECTS SIGN      OWNER'S SIGN

Signature of Architect  
**SEEMA RANI**  
CA/2015/2259

FOR LION INFRADEVELOPERS LLP  
AUTHORISED SIGNATORY

Drawn by:- PANKAJ KAPOOR      Mob. No. - 8800093157