

ARCHITECT (R.O.) STP
 MEMBER
 EPC

DDA (T) MEMBER
 BPAC

J.D.
 P.A.

A.T.P.

01 SITE PLAN
 Scale: 1:300

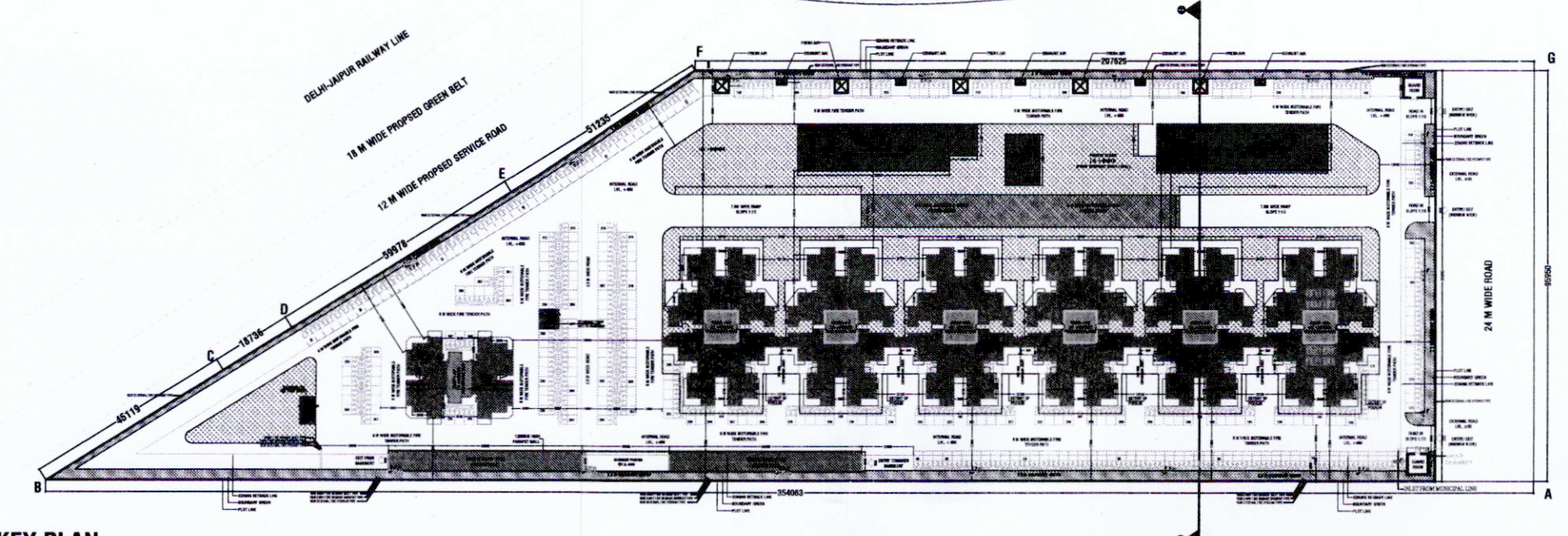

02 KEY PLAN
 Scale: 1:300

PRINCIPAL ARCHITECT:	
 DESIGN FORUM INTERNATIONAL	
K-47, KAILASH COLONY, NEW DELHI-110048 PHONE NO: 011-46556600	
OWNER'S SIGNATURE	ARCHITECT'S SIGNATURE
CLIENT: MAHIRA HOMES PRIVATE LIMITED PROJECT: PROPOSED BUILDING PLANS OF AFFORDABLE GROUP HOUSING COLONY ADMEASURING 6.675 ACRES (LICENSE NO. 09 OF 2022 DATED 31-01-2022) BEING DEVELOPED IN VILLAGE HARSARU, SECTOR 88-B, GURUDRAM BY M/S BLOSSOM PROPERTIES PVT. LTD. AND OTHER LAND OWNERS IN COLLABORATION WITH M/S MAHIRA HOMES PVT. LTD.	
DRAWING TITLE:	
SITE PLAN	
SCALE: 1:112	SHEET NO.
DATE: 24.02.2022	21