

MACHINE ROOM  
TOS LVL (+12100)

25TH FLOOR  
F.F.L (+12000)

26TH FLOOR  
F.F.L (+11900)

27TH FLOOR  
F.F.L (+11800)

28TH FLOOR  
F.F.L (+11700)

29TH FLOOR  
F.F.L (+11600)

30TH FLOOR  
F.F.L (+11500)

31ST FLOOR  
F.F.L (+11400)

32ND FLOOR  
F.F.L (+11300)

33RD FLOOR  
F.F.L (+11200)

34TH FLOOR  
F.F.L (+11100)

35TH FLOOR  
F.F.L (+11000)

36TH FLOOR  
F.F.L (+10900)

37TH FLOOR  
F.F.L (+10800)

38TH FLOOR  
F.F.L (+10700)

39TH FLOOR  
F.F.L (+10600)

40TH FLOOR  
F.F.L (+10500)

41ST FLOOR  
F.F.L (+10400)

42ND FLOOR  
F.F.L (+10300)

43RD FLOOR  
F.F.L (+10200)

44TH FLOOR  
F.F.L (+10100)

45TH FLOOR  
F.F.L (+10000)

46TH FLOOR  
F.F.L (+9900)

47TH FLOOR  
F.F.L (+9800)

48TH FLOOR  
F.F.L (+9700)

49TH FLOOR  
F.F.L (+9600)

50TH FLOOR  
F.F.L (+9500)

51ST FLOOR  
F.F.L (+9400)

52ND FLOOR  
F.F.L (+9300)

53RD FLOOR  
F.F.L (+9200)

54TH FLOOR  
F.F.L (+9100)

55TH FLOOR  
F.F.L (+9000)

56TH FLOOR  
F.F.L (+8900)

57TH FLOOR  
F.F.L (+8800)

58TH FLOOR  
F.F.L (+8700)

59TH FLOOR  
F.F.L (+8600)

60TH FLOOR  
F.F.L (+8500)

61ST FLOOR  
F.F.L (+8400)

62ND FLOOR  
F.F.L (+8300)

63RD FLOOR  
F.F.L (+8200)

64TH FLOOR  
F.F.L (+8100)

65TH FLOOR  
F.F.L (+8000)

66TH FLOOR  
F.F.L (+7900)

67TH FLOOR  
F.F.L (+7800)

68TH FLOOR  
F.F.L (+7700)

69TH FLOOR  
F.F.L (+7600)

70TH FLOOR  
F.F.L (+7500)

71ST FLOOR  
F.F.L (+7400)

72ND FLOOR  
F.F.L (+7300)

73RD FLOOR  
F.F.L (+7200)

74TH FLOOR  
F.F.L (+7100)

75TH FLOOR  
F.F.L (+7000)

76TH FLOOR  
F.F.L (+6900)

77TH FLOOR  
F.F.L (+6800)

78TH FLOOR  
F.F.L (+6700)

79TH FLOOR  
F.F.L (+6600)

80TH FLOOR  
F.F.L (+6500)

81ST FLOOR  
F.F.L (+6400)

82ND FLOOR  
F.F.L (+6300)

83RD FLOOR  
F.F.L (+6200)

84TH FLOOR  
F.F.L (+6100)

85TH FLOOR  
F.F.L (+6000)

86TH FLOOR  
F.F.L (+5900)

87TH FLOOR  
F.F.L (+5800)

88TH FLOOR  
F.F.L (+5700)

89TH FLOOR  
F.F.L (+5600)

90TH FLOOR  
F.F.L (+5500)

91ST FLOOR  
F.F.L (+5400)

92ND FLOOR  
F.F.L (+5300)

93RD FLOOR  
F.F.L (+5200)

94TH FLOOR  
F.F.L (+5100)

95TH FLOOR  
F.F.L (+5000)

96TH FLOOR  
F.F.L (+4900)

97TH FLOOR  
F.F.L (+4800)

98TH FLOOR  
F.F.L (+4700)

99TH FLOOR  
F.F.L (+4600)

100TH FLOOR  
F.F.L (+4500)

EXTERNAL ROAD  
L.V.L (+4)

TOWER-A5

TOWER-A4  
ELEVATION 2

TOWER-A3

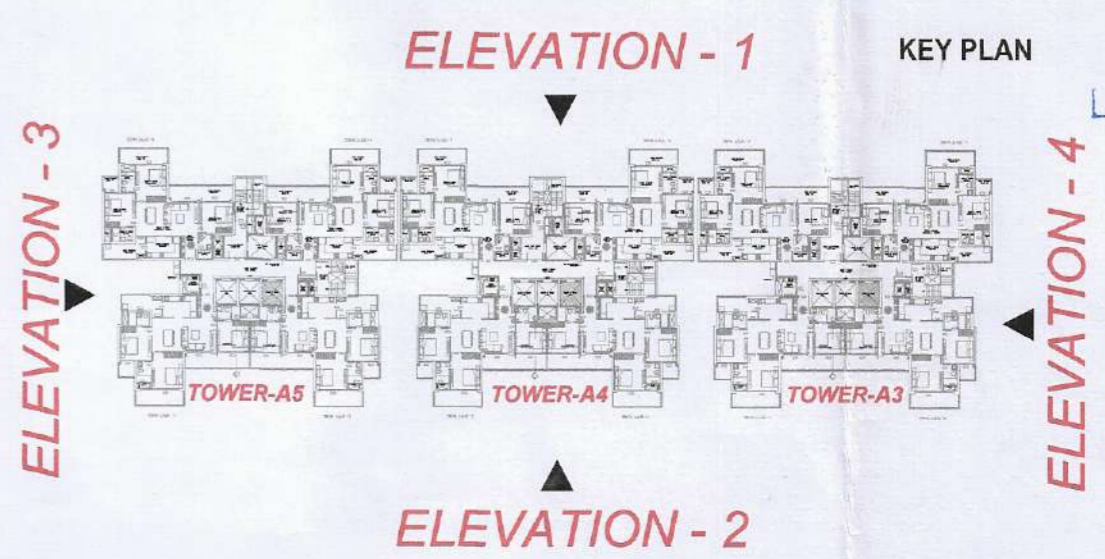

ELEVATION - 1

KEY PLAN

ELEVATION - 2

ELEVATION - 3

ELEVATION - 4

Member Secretary  
B.P.A.C.

Member  
B.P.A.C.

Chairman  
B.P.A.C.

DT (HQ)

ATP (HQ)

PA.

DINESH KUMAR  
PA (HQ)

SANCTIONED  
MEMO NO.: 46660  
DATED: 9/12/25

F.S. (HQ)

- NOTE:
- BUILDING HAS AUTOMATIC SPRINKLER SYSTEM WHEREVER REQUIRED BY NBC.
  - BUILDING WILL BE DESIGNER (STRUCTURES) AS PER RELEVANT IS CODES FOR EARTH QUAKE RESISTANCE.
  - 100% POWER BACKUP/ MECHANICAL VENTILATED SHAFTS.

PROJECT:  
PROPOSED BUILDING PLAN FOR AFFORDABLE GROUP HOUSING - I (POCKET-A) OVER AN AREA MEASURING 16.47276 ACRES PART OF INDUSTRIAL PLOTTED COLONY OVER AN AREA MEASURING 130.75510 ACRES (SCHEME NO. 108 OF 2015 DATED 06/09/2015) IN THE REVENUE ESTATE OF VILAGE BAS HATHA AND JI-IND GUDA ROAD, IN SECTOR M9, M10 AND M11 GURUGRAM MANESAR URBAN COMPLEX.

OWNER:  
M3M INDIA INFRASTRUCTURES PVT. LTD.

ARCHITECTS:  
**STUDIO SYMBIOSIS**  
INDIA | GERMANY | UK  
INDIA  
1301 TOWER, SKYMARK ONE  
SECTOR 88, NOIDA, U.P. 201301, NOIDA  
TEL: +91 0120 4286779  
E-MAIL: INFO@STUDIOSYMBIOSIS.COM  
WWW.STUDIOSYMBIOSIS.COM

OWNERS SEAL & SIGNATURE:  
For M3M India Infrastructures Pvt. Ltd.  
*(Signature)*  
Authorised Signatory

ARCHITECT'S SEAL & SIGNATURE:  
**AMIT GUPTA**  
Architect  
DA / 2004 / 33147

DATE: \_\_\_\_\_ SCALE: \_\_\_\_\_ DWG NO: ELE-A3A4A5-02  
DWG TITLE: ELEVATION - 2 (TOWER A3, A4, A5)