

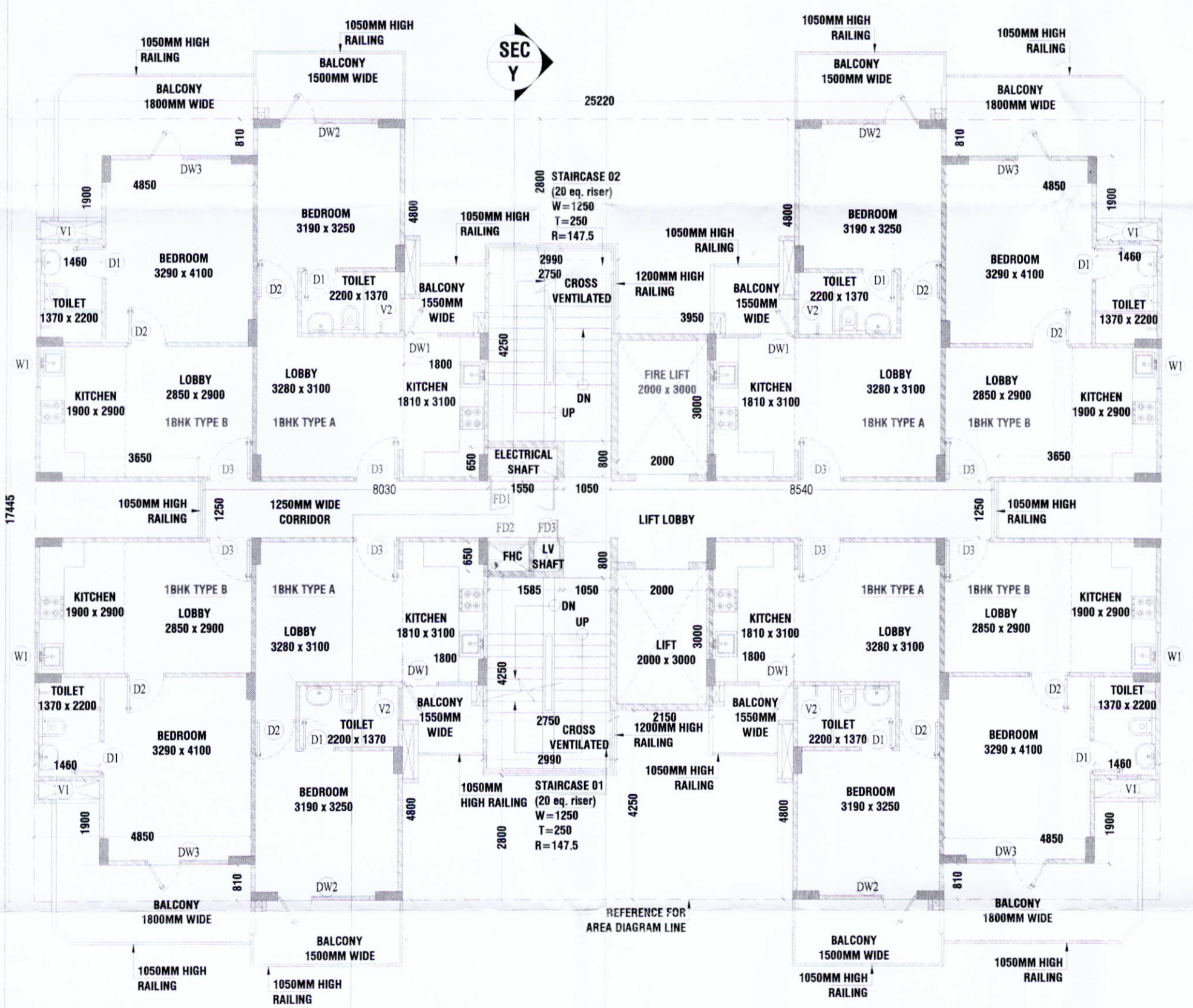

1 STILT FLOOR PLAN
Scale:1:100



4 TYPICAL FLOOR PLAN (1ST TO 12TH FLOOR)
Scale:1:100

STILT FLOOR FAR CALCULATION OF TOWER B									
1. ADDITION - XX									
S.No.	NAME	SHAPE	LENGTH (L)	WIDTH (B)	HEIGHT (H)	FORMULA	AREA	QUANTITY	TOTAL AREA
1	1	Rectangle	2.990	2.500	-	L X B	7.475	2	14.95
2	2	Rectangle	3.050	7.850	-	L X B	23.943	1	23.943
3	3	Rectangle	2.060	8.000	-	L X B	16.480	1	16.480
4	4	Rectangle	5.280	3.300	-	L X B	17.424	2	34.848
5	5	Rectangle	3.390	4.800	-	L X B	16.272	2	32.544
6	6	Rectangle	3.040	1.250	-	L X B	3.800	2	7.600
7	7	Rectangle	0.090	0.550	-	L X B	0.050	1	0.050
TOTAL AREA									130.414
STILT FLOOR FAR OF TOWER B									130.414 SQM.

GROUND COVERAGE CALCULATION OF TOWER B									
1. ADDITION - XX									
S.No.	NAME	SHAPE	LENGTH (L)	WIDTH (B)	HEIGHT (H)	FORMULA	AREA	QUANTITY	TOTAL AREA
1	A	Rectangle	25.220	17.445	-	L X B	439.963	1	439.963
1. TOTAL ADDITION									439.963
2. DEDUCTION - YY									
5	5	Rectangle	1.460	1.900	-	L X B	2.774	4	11.096
6	6	Rectangle	4.850	0.810	-	L X B	3.929	4	15.714
7	7	Rectangle	3.650	1.250	-	L X B	4.563	2	9.125
8	8	Rectangle	1.800	4.800	-	L X B	8.640	3	25.920
10	10	Rectangle	3.950	4.800	-	L X B	18.960	1	18.960
11	11	Rectangle	2.150	4.250	-	L X B	9.138	1	9.138
13	13	Rectangle	2.990	2.300	-	L X B	6.877	2	13.754
2. TOTAL DEDUCTION									103.707
GROUND COVERAGE OF TOWER B									336.256 SQM.

TYPICAL FLOOR NON-F.A.R. CALCULATION OF TOWER B									
1. ADDITION - XX									
S.No.	NAME	SHAPE	LENGTH (L)	WIDTH (B)	HEIGHT (H)	FORMULA	AREA	QUANTITY	TOTAL AREA
1	1	Rectangle	2.750	4.250	-	L X B	11.688	2	23.375
2	2	Rectangle	1.050	0.800	-	L X B	0.840	2	1.680
3	3	Rectangle	1.550	0.650	-	L X B	1.008	2	2.015
4	12	Rectangle	2.000	3.000	-	L X B	6.000	2	12.000
TOTAL NON-F.A.R. ON TYPICAL FLOOR OF TOWER B									39.070

AREA SUMMARY - TOWER B		
A	Ground Coverage	336.256 SQM.
B	Stilt Floor FAR	130.414 SQM.
C	Typical Floor FAR	294.174 SQM.
D	Nos of Typical Floors	12 NO.S
E	Total FAR (E = B + (C*D))	3660.498 SQM.
F	1BHK Type A (Balcony Area)	7.495 SQM.
G	No. of 1BHK Type A Units	4 NO.S
H	1BHK Type B (Balcony Area)	9.697 SQM.
I	No. of 1BHK Type B Units	4 NO.S
J	Non-FAR (Balcony) in One Floor (J = (F*G) + (H*I))	68.767 SQM.
K	Non-FAR (Common Area) of One Tower	39.070 SQM.
L	Stilt Floor Non-FAR (P = (A-B))	205.842 SQM.
M	Total Non-FAR in Tower - Stilt, Typ. Floor Balcony & Core (M = D*(J+K)+L)	1499.886 SQM.
N	Murmy Built-up Area	15.133 SQM.
O	Overhead Tank Built-up Area	54.203 SQM.
P	Total Built-up Area in One Tower (P = E+M+N+O)	5229.719 SQM.

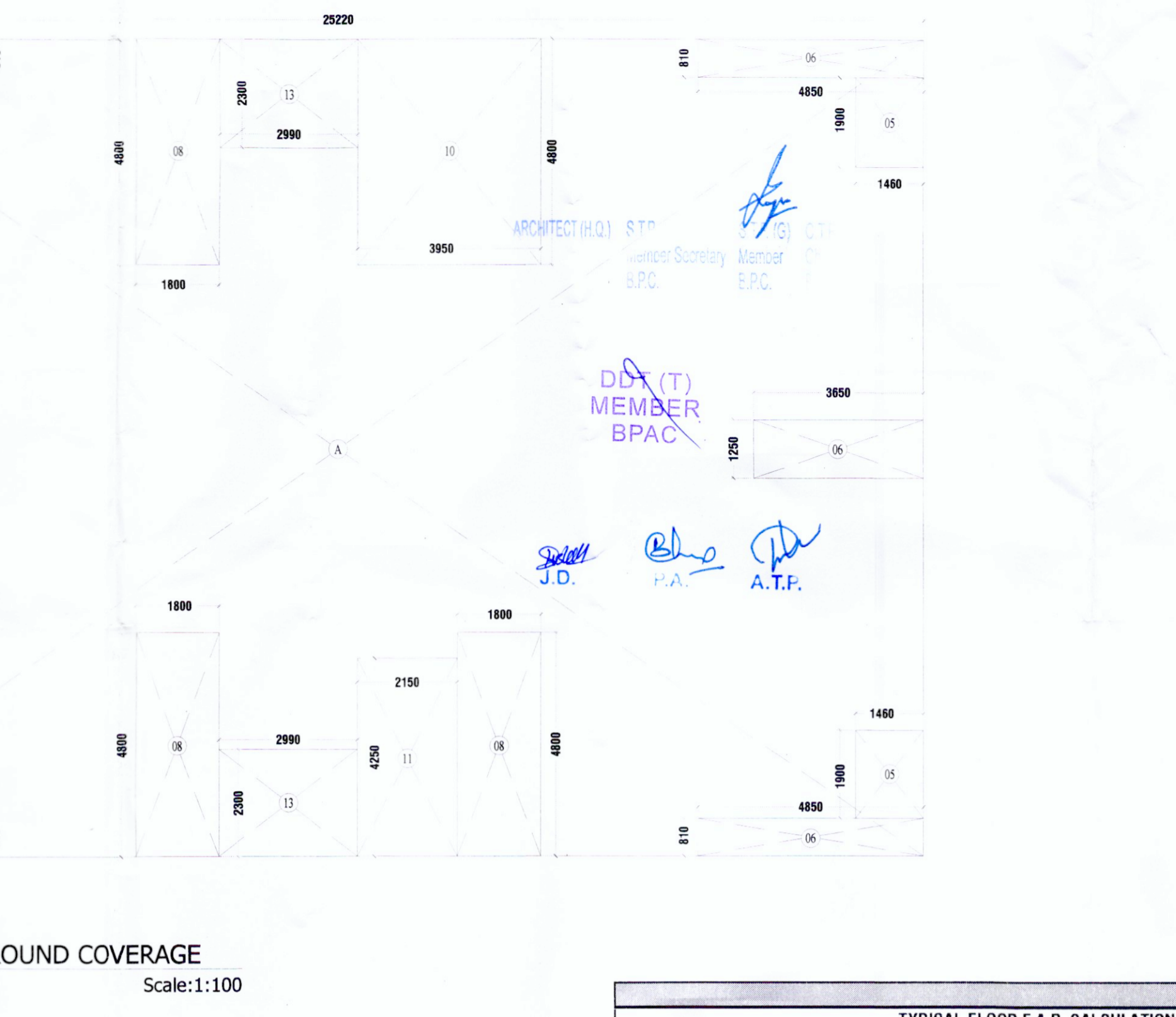

3 AREA DIAG.: GROUND COVERAGE
Scale:1:100

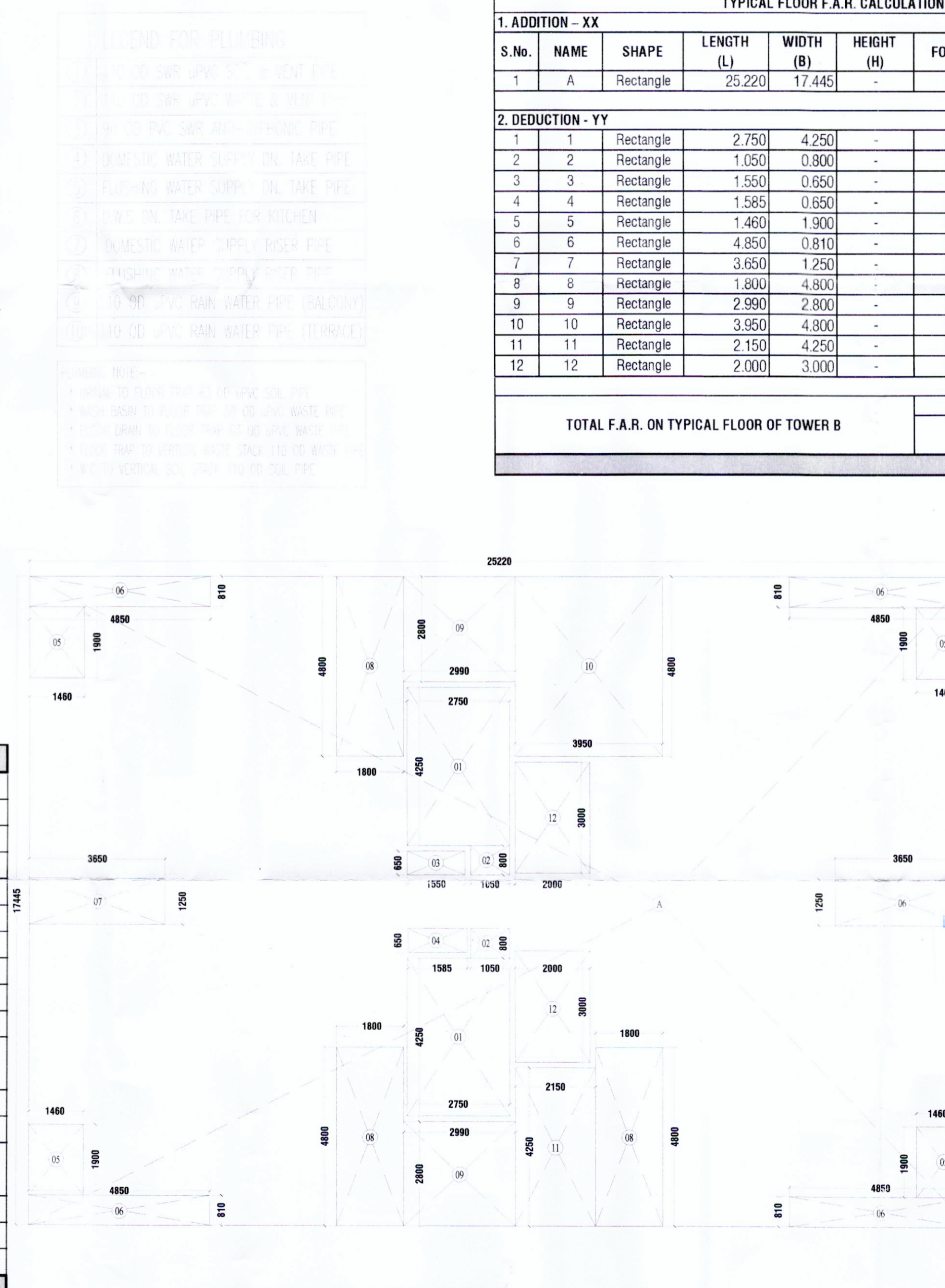

5 AREA DIAG.: F.A.R. TYPICAL FLOOR
Scale:1:100

DOOR WINDOW SCHEDULE - TOWER B						
S.No.	Type	Opening Size	sill Level	Lintel Level	Description	
01	D1	790x2250	00	2250	Toilet	
03	D2	900x2250	00	2250	Bedroom	
04	D3	1000x2250	00	2250	Entrance Lobby	
05	D4	1200x2250	00	2250	Service Provider & Tower Panel Room	
06	DW1	800/290x2250	00/400	2250	Balcony	
07	DW2	800/1250x2250	00/400	2250	Balcony	
08	DW3	800/1110x2250	00/400	2250	Balcony	
09	W1	900x1250	1000	2250	Kitchen	
10	V1	450x1050	1200	2250	WC	
11	V2	710x1050	1200	2250	WC	
12	FD1	1550x2150	150	2250	Electrical Shaft	
13	FD2	925x1800	450	2250	FHC	
14	FD3	650x1800	450	2250	LV Shaft	
15	FD4	1050x2250	00	2250	Murmy	
16	FD5	1250x2250	00	2250	Machine Room	

TYPICAL FLOOR F.A.R. CALCULATION OF TOWER B									
1. ADDITION - XX									
S.No.	NAME	SHAPE	LENGTH (L)	WIDTH (B)	HEIGHT (H)	FORMULA	AREA	QUANTITY	TOTAL AREA
1	A	Rectangle	25.220	17.445	-	L X B	439.963	1	439.963
1. TOTAL ADDITION									439.963
2. DEDUCTION - YY									
1	1	Rectangle	2.750	4.250	-	L X B	11.688	2	23.375
2	2	Rectangle	1.050	0.800	-	L X B	0.840	2	1.680
3	3	Rectangle	1.550	0.650	-	L X B	1.008	1	1.008
4	4	Rectangle	1.585	0.650	-	L X B	1.030	1	1.030
5	5	Rectangle	1.460	1.900	-	L X B	2.774	4	11.096
6	6	Rectangle	4.850	0.810	-	L X B	3.929	4	15.714
7	7	Rectangle	3.650	1.250	-	L X B	4.563	2	9.125
8	8	Rectangle	1.800	4.800	-	L X B	8.640	3	25.920
9	9	Rectangle	2.990	2.800	-	L X B	8.372	2	16.744
10	10	Rectangle	3.950	4.800	-	L X B	18.960	1	18.960
11	11	Rectangle	2.150	4.250	-	L X B	9.138	1	9.138
12	12	Rectangle	2.000	3.000	-	L X B	6.000	2	12.000
2. TOTAL DEDUCTION									145.789
TOTAL F.A.R. ON TYPICAL FLOOR OF TOWER B									294.174 SQM.

PRINCIPAL ARCHITECT:
DESIGN FORUM INTERNATIONAL
K-47, KAILASH COLONY, NEW DELHI-110048
PHONE NO.: 011-46556600

OWNER'S SIGNATURE _____ ARCHITECT'S SIGNATURE _____

CLIENT: **M/S BLOSSOM PVT. LTD.**
Bhahira Homes Private Limited
ANJOI TEVATIA
B.Arch. (Hons.)
CA/95/18739

PROJECT:
PROPOSED BUILDING PLANS OF AFFORDABLE GROUP HOUSING COLONY ADMEASURING 6.675 ACRES (LICENSE NO.09 OF 2022 DATED 31-01-2022) BEING DEVELOPED IN VILLAGE HARSARU, SECTOR 88-B, GURUGRAM BY M/S BLOSSOM PROPERTIES PVT. LTD. AND OTHER LAND OWNERS IN COLLABORATION WITH M/S MAHIRA HOMES PVT. LTD.

DRAWING TITLE:
Tower - B: Typical Floor Plan, Area Diagrams & Area Chart

SCALE: 1:100
DATE: 24.02.2022

SHEET NO. **15**