

REFUGE FLOOR PLAN
17TH, 26TH & 36TH FLOOR
TOWER-1

FLOOR	FLOOR LEVEL	AREA
17th FLOOR	LVL-412.000	2
26th FLOOR	LVL-412.000	2
36th FLOOR	LVL-411.500	2
TOTAL AREA = 4		

SYMBOL	DESCRIPTION
1	1100 R/SOL PIPE
2	1100 WASTE PIPE
3	1100 VENT PIPE
4	1100 RAIN WATER PIPE FROM TERRACE
5	1100 RAIN WATER PIPE FROM BALCONY
6	DOMESTIC WATER DOWN TAKE PIPE
7	FLUSHING WATER DOWN TAKE PIPE
8	HYDRO-PNEUMATIC DOMESTIC WATER PIPE FOR R/SOL PRESS FLOOR
9	DOMESTIC WATER RISER PIPE
10	FLUSHING WATER RISER PIPE

SYMBOL	DESCRIPTION
A	1500 FIRE HYDRANT PIPE FOR LOWER ZONE
B	1500 FIRE HYDRANT PIPE FOR MIDDLE ZONE
C	1500 FIRE HYDRANT PIPE FOR UPPER ZONE
D	1500 FIRE SPRINKLER PIPE FOR LOWER ZONE
E	1500 FIRE SPRINKLER PIPE STAND BY FOR LOWER ZONE
F	1500 FIRE SPRINKLER PIPE FOR MIDDLE ZONE
G	1500 FIRE SPRINKLER PIPE STAND BY FOR MIDDLE ZONE
H	1500 FIRE SPRINKLER PIPE FOR UPPER ZONE
I	1500 FIRE SPRINKLER PIPE STAND BY FOR UPPER ZONE
J	800 FIC DRAIN PIPE

S. NO.	TAGS	DOOR/WINDOW SCHEDULE (TOWER-1)	LOCATION	FIRE RATINGS
1	D	1200	Handicap WC	
2	D1	1050	Bedroom, Bedroom	
3	D2	900	Kitchen, Dining, Bedroom, Study, Balcony	
4	D3	800	P.Balcony, Toilet, Partry	
5	D4	840	Study	
6	SD	930	Living	
7	SD1	6200	Living	
8	SD2	3000	M.Bedroom 1A, M.Bedroom 2	
9	SD3	2800	Bedroom 1	
10	SD4	2700	Dining, Bedroom 1	
11	SD5	2000	Study, Dining	
12	SD6	2200	Family Lounge	
13	SD7	1800	Bedroom 2	
14	SD8	1500	Study	
15	SD9	1450	Bedroom 2	
16	DW	2300	Kitchen	
17	DW1	2300	Kitchen	
18	DW2	1600	Dining	
19	DW3	1600	Kitchen	
20	DW4	1250	W.Balcony, Jockey	

S. NO.	TAGS	DOOR/WINDOW SCHEDULE (TOWERS)	LOCATION	FIRE RATINGS
1	GL1	930	Lobby	
2	GL2	930	Lobby	
3	V1	1200	Vent Door	
4	V2	900	L. Toilet Service	
5	V3	800	L. Toilet Service	
6	V4	600	Handicap WC, WC, Balcony	
7	W	2845	Staircase	
8	W1	2700	Staircase	
9	W2	1600	M. Stair	
10	W3	1200	Staircase	
11	W4	800	Stair	
12	W5	600	Stair	
13	W6	600	Stair	

S. NO.	TAGS	DOOR/WINDOW SCHEDULE (TOWERS)	LOCATION	FIRE RATINGS
1	FD1	1200	Fire Staircase	
2	FD2	1050	Fire Staircase	
3	FD3	1000	Fire Staircase	
4	FD4	900	Fire Staircase	
5	FD5	1025	Fire Staircase	

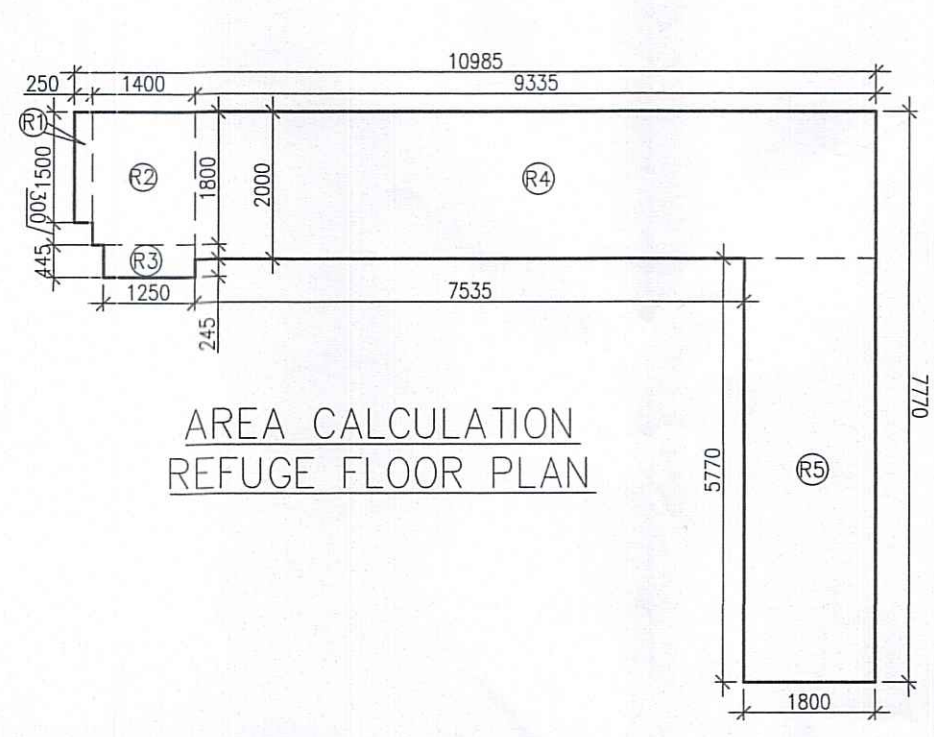

AREA CALCULATION
REFUGE FLOOR PLAN

17TH, 26TH & 36TH FLOOR REFUGE AREA TOWER-1				
GROSS - D				
RT	=	1	X	0.200 X 1.800 = 0.360 SQM
RE	=	1	X	1.400 X 1.800 = 2.520 SQM
RS	=	1	X	1.200 X 0.445 = 0.534 SQM
RF	=	1	X	6.335 X 2.300 = 14.570 SQM
RD	=	1	X	1.800 X 5.770 = 10.386 SQM
GROSS AREA OF 17TH, 26TH & 36TH FLOOR	=			28.276 SQM
GROSS AREA OF 3RD & 36TH FLOOR	=			637.276 SQM
GROSS AREA	=			665.552 SQM
REFUGE AREA REQUIRED	=	(1074.652 X 0.3) / 2	+ ADDITIONAL SPACE TO ACCOMMODATE WHEEL CHAIR SPACE @ 0.9 SQM PER 200 POPULATION	161.933 SQM
REFUGE AREA PROVIDED	=	28.276		28.276 SQM
DEFICIT	=			133.657 SQM

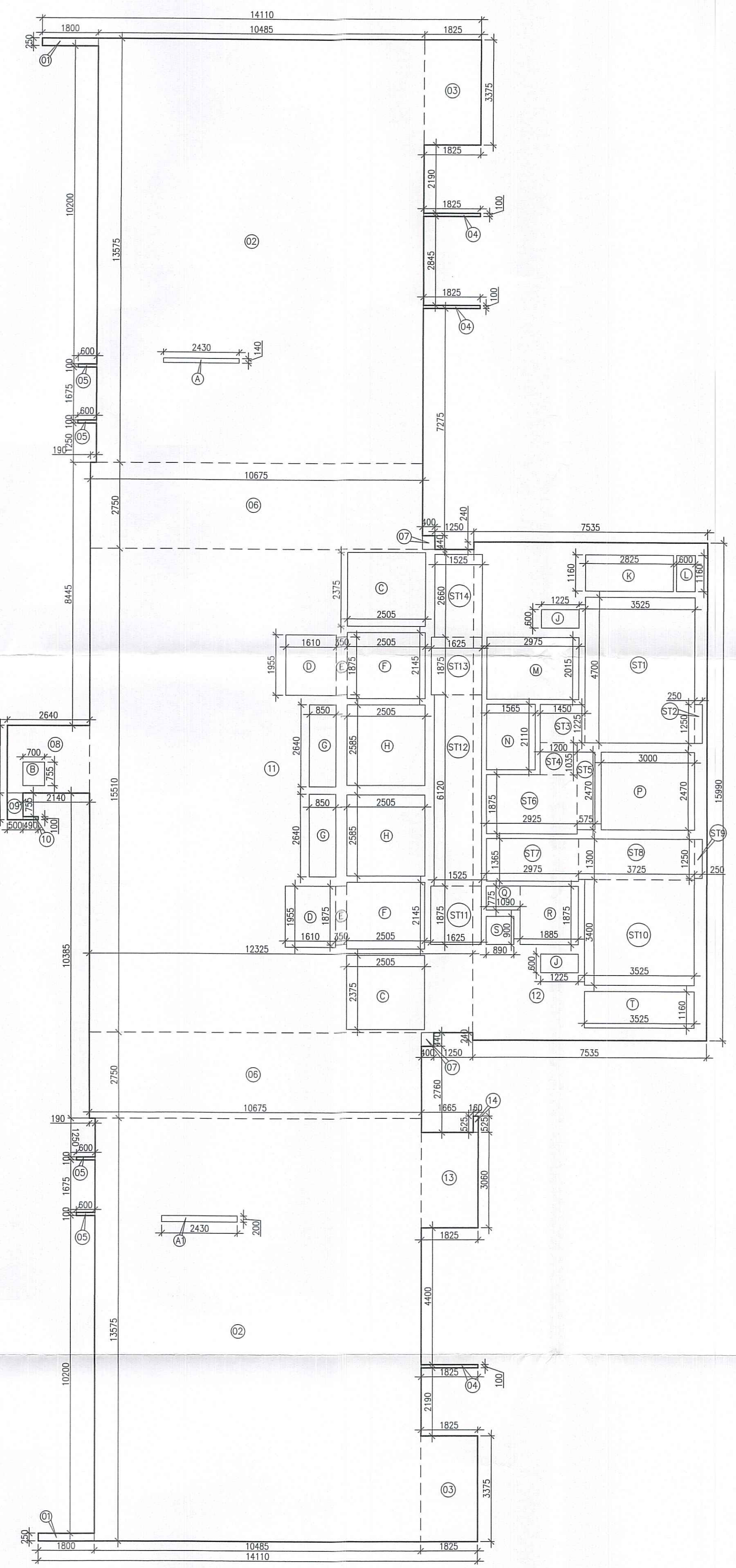

AREA CALCULATION
REFUGE FLOOR PLAN

FAR AREA CALCULATION OF TOWER 1 (REFUGE FLOOR)					
GROSS - A					
Sr. No	Nos	Length	Width	Area (SQM)	
1	2	1.800	0.250	0.900	
2	2	10.450	13.575	141.863	
3	2	1.825	3.375	12.319	
4	3	1.825	0.100	0.548	
5	4	0.900	0.100	0.360	
6	2	10.875	2.750	59.719	
7	2	0.400	0.440	0.352	
8	1	2.540	2.180	5.536	
9	1	0.500	0.855	0.428	
10	1	0.440	0.100	0.044	
11	1	15.200	15.910	191.161	
12	1	7.530	15.960	120.450	
13	1	1.825	3.600	6.570	
14	1	0.180	0.525	0.094	
TOTAL				891.284	
DEDUCTIONS					
Sr. No	Nos	Length	Width	Area (SQM)	
A	1	2.430	0.140	0.340	
A1	1	2.430	0.300	0.729	
B	1	0.700	0.750	0.525	
C	2	2.505	2.375	11.866	
D	2	1.810	1.550	5.595	
E	2	0.350	1.875	1.313	
F	2	2.505	2.145	10.746	
G	2	2.540	2.540	12.852	
H	2	2.505	2.565	12.821	
J	2	1.225	0.800	1.970	
K	1	2.825	1.150	3.247	
L	1	0.600	1.150	0.690	
M	1	2.975	2.015	5.995	
N	1	1.565	2.110	3.302	
P	1	3.000	2.470	7.410	
Q	1	1.080	0.770	0.832	
R	1	1.865	1.875	3.494	
S	1	0.880	0.800	0.704	
T	1	3.525	1.160	4.089	
TOTAL				86.448	
STAIRCASE AREA CALCULATION					
Sr. No	Nos	Length	Width	Area (SQM)	
ST1	1	3.525	4.700	16.586	
ST2	1	0.250	1.200	0.300	
ST3	1	1.450	1.225	1.776	
ST4	1	1.300	1.025	1.333	
ST5	1	0.575	2.470	1.420	
ST6	1	2.825	1.875	5.284	
ST7	1	2.975	1.365	4.059	
ST8	1	3.725	1.300	4.843	
ST9	1	0.250	1.200	0.300	
ST10	1	3.525	3.400	12.006	
ST11	1	1.625	1.875	3.047	
ST12	1	1.625	8.120	13.333	
ST13	1	1.625	1.875	3.047	
ST14	1	1.525	2.860	4.362	
TOTAL				67.487	
NET FAR - TOWER 1 (REFUGE FLOOR)					
NET FAR AREA OF TYPICAL FLOOR	=	GROSS - A	- GROSS - B	- GROSS - C	
	=	891.284	- 87.487	- 30.465	773.332 SQM
BUILT-UP AREA - TOWER 1 (REFUGE FLOOR)	=	773.332			773.332 SQM
NET BUILT AREA OF TYPICAL FLOOR	=	GROSS - 1	+ GROSS - B	+ GROSS - C	
	=	533.332	+ 67.487	+ 32.507	633.326 SQM
GROSS - 2	=	533.326			533.326 SQM
NON FAR AREA - TOWER 1 (REFUGE FLOOR)					
NON FAR AREA OF TYPICAL FLOOR	=	GROSS - 2	- GROSS - 1	- GROSS - D	
	=	533.326	- 533.326	-	0.000 SQM
GROSS - 3	=	99.994			99.994 SQM

Note:-
 1. BUILDING HAS AUTOMATIC SPRINKLER SYSTEM WHEREVER REQUIRED BY NBC.
 2. BUILDING WILL BE DESIGNED (STRUCTURES) AS PER RELEVANT IS CODES FOR EARTH QUAKE RESISTANCE.
 3. ALL BUILDING 100% POWER BACKUP.

PROJECT:-
 PROPOSED BUILDING PLAN OF G.H. SITE NO.24 IN SECTOR-53 GURUGRAM OF AREA MEASURING 7.413 ACRES BEING DEVELOPED BY M/S GODREJ PROPERTIES LTD.

134, First floor, Vipul Business Park, Sohna Road, Sector-48, Gurugram-122018 (Hr.) (PH-9560794794, 9871004573)

OWNER'S SEAL & SIGNATURE
 For Godrej Properties Ltd.
 Authorized Signatory

ARCHITECT'S SEAL & SIGNATURE

FEB-2028
 Tower-01
 REFUGE FLOOR PLAN & AREA CALCULATION
 Drawing No. T1-05