

2BHK+STORE TYPE B1 UNIT - BALCONY AREA DETAIL									
S.No.	NAME	SHAPE	LENGTH (L)	WIDTH (B)	HEIGHT (H)	FORMULA	AREA	QUANTITY	TOTAL AREA
1		Rectangle	3.170	6.190	-	L X B	19.622	1	19.622
2		Rectangle	0.325	3.050	-	L X B	0.991	1	0.991
3		Rectangle	1.900	3.100	-	L X B	5.890	1	5.890
4		Rectangle	2.335	1.540	-	L X B	3.595	1	3.595
5		Rectangle	1.250	0.990	-	L X B	1.238	1	1.238
6		Rectangle	3.280	0.980	-	L X B	3.214	1	3.214
TOTAL BALCONY AREA OF 2BHK+STORE TYPE B1 UNIT									34.561

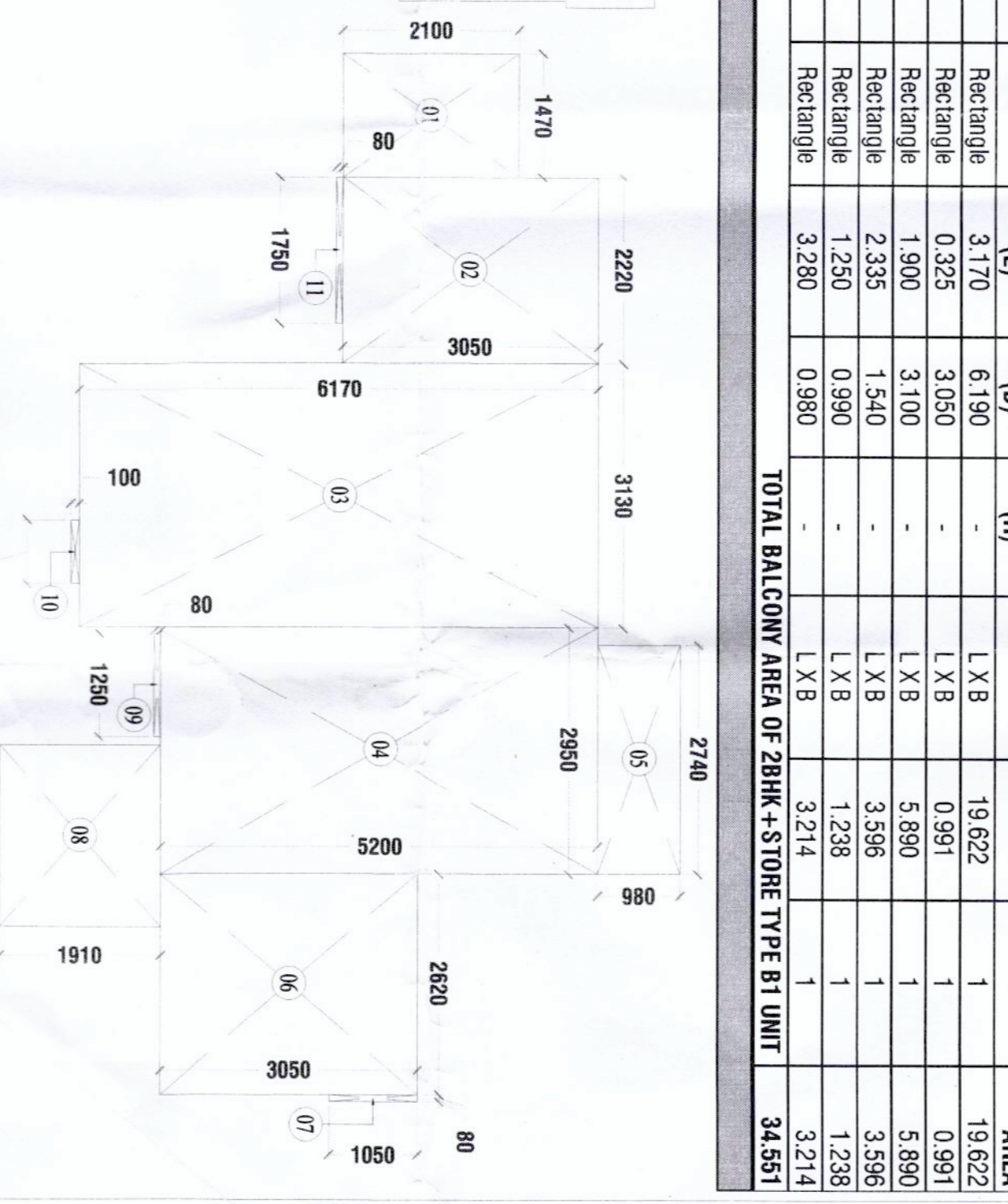
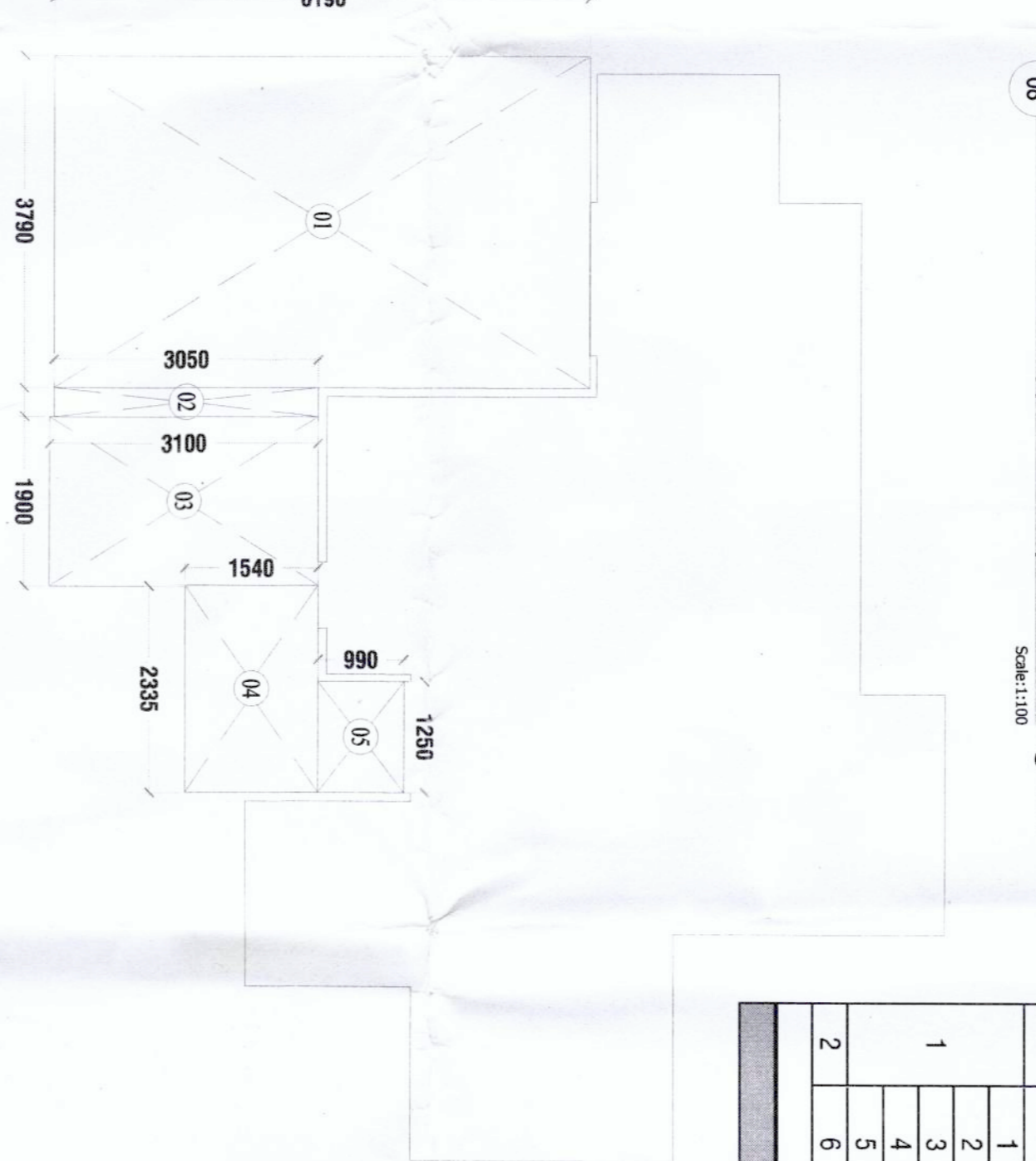
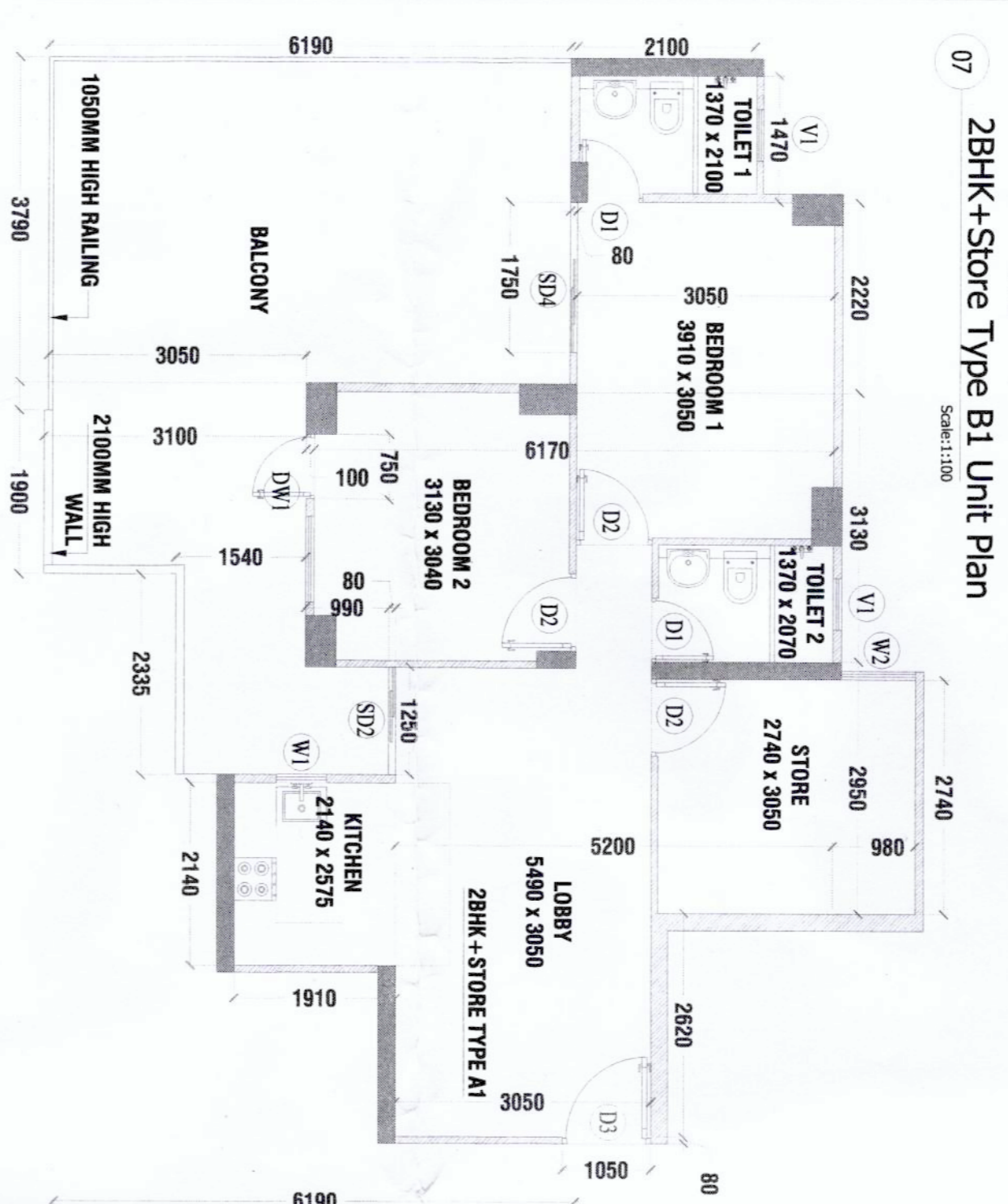

2BHK+STORE TYPE B1 UNIT - BALCONY AREA DETAIL									
S.No.	NAME	SHAPE	LENGTH (L)	WIDTH (B)	HEIGHT (H)	FORMULA	AREA	QUANTITY	TOTAL AREA
1		Rectangle	3.170	6.190	-	L X B	19.622	1	19.622
2		Rectangle	0.325	3.050	-	L X B	0.991	1	0.991
3		Rectangle	1.900	3.100	-	L X B	5.890	1	5.890
4		Rectangle	2.335	1.540	-	L X B	3.595	1	3.595
5		Rectangle	1.250	0.990	-	L X B	1.238	1	1.238
6		Rectangle	3.280	0.980	-	L X B	3.214	1	3.214
TOTAL BALCONY AREA OF 2BHK+STORE TYPE B1 UNIT									34.561

2BHK+STORE TYPE A1 - CARPET AREA DETAIL									
S.No.	NAME	SHAPE	LENGTH (L)	WIDTH (B)	HEIGHT (H)	FORMULA	AREA	QUANTITY	TOTAL AREA
1		Rectangle	1.470	2.100	-	L X B	3.087	1	3.087
2		Rectangle	2.220	3.050	-	L X B	6.771	1	6.771
3		Rectangle	3.130	6.170	-	L X B	19.312	1	19.312
4		Rectangle	2.990	5.200	-	L X B	15.340	1	15.340
5		Rectangle	2.740	0.980	-	L X B	2.685	1	2.685
6		Rectangle	2.620	3.050	-	L X B	7.991	1	7.991
7		Rectangle	0.080	1.050	-	L X B	0.084	1	0.084
8		Rectangle	2.140	1.910	-	L X B	4.087	1	4.087
9		Rectangle	1.250	0.080	-	L X B	0.100	1	0.100
10		Rectangle	0.730	0.100	-	L X B	0.075	1	0.075
11		Rectangle	1.750	0.080	-	L X B	0.140	1	0.140
TOTAL CARPET AREA OF 2BHK+STORE TYPE A1							59.673		59.673

2BHK+STORE TYPE B1 - CARPET AREA DETAIL									
S.No.	NAME	SHAPE	LENGTH (L)	WIDTH (B)	HEIGHT (H)	FORMULA	AREA	QUANTITY	TOTAL AREA
1		Rectangle	2.130	4.520	-	L X B	9.628	1	9.628
2		Rectangle	1.800	0.080	-	L X B	0.144	1	0.144
3		Rectangle	3.130	3.120	-	L X B	9.766	1	9.766
4		Rectangle	0.750	0.100	-	L X B	0.075	1	0.075
5		Rectangle	1.250	0.080	-	L X B	0.100	1	0.100
6		Rectangle	2.950	2.150	-	L X B	6.343	1	6.343
7		Rectangle	2.140	1.910	-	L X B	4.087	1	4.087
8		Rectangle	2.620	3.050	-	L X B	7.991	1	7.991
9		Rectangle	0.080	1.050	-	L X B	0.084	1	0.084
10		Rectangle	6.220	3.050	-	L X B	18.971	1	18.971
11		Rectangle	2.740	0.980	-	L X B	2.685	1	2.685
TOTAL CARPET AREA OF 2BHK+STORE TYPE B1							59.873		59.873

DOOR WINDOW SCHEDULE - TOWER A1-106			
S.No.	Type	Opening Size	Unit Level
01	BT	750x250	00
02	BT	900x250	00
03	BT	750x250	00
04	BT	1500x250	00
05	BT	1000x750x250	00
06	BT	1150x250	00
07	BT	1250x250	00
08	BT	1450x250	00
09	BT	1450x250	00
10	BT	1750x250	00
11	BT	1800x250	00
12	BT	807	00
13	BT	800x1750	1000
14	BT	800x1800	450
15	BT	1800x1800	450
16	BT	1800x1800	450
17	BT	800x1800	1200
18	BT	1500x2150	1100
19	BT	1200x1800	450
20	BT	1800x1800	450
21	BT	1800x2250	00
22	BT	1250x2250	00
23	BT	1800x2100	00
24	BT	900x2250	00

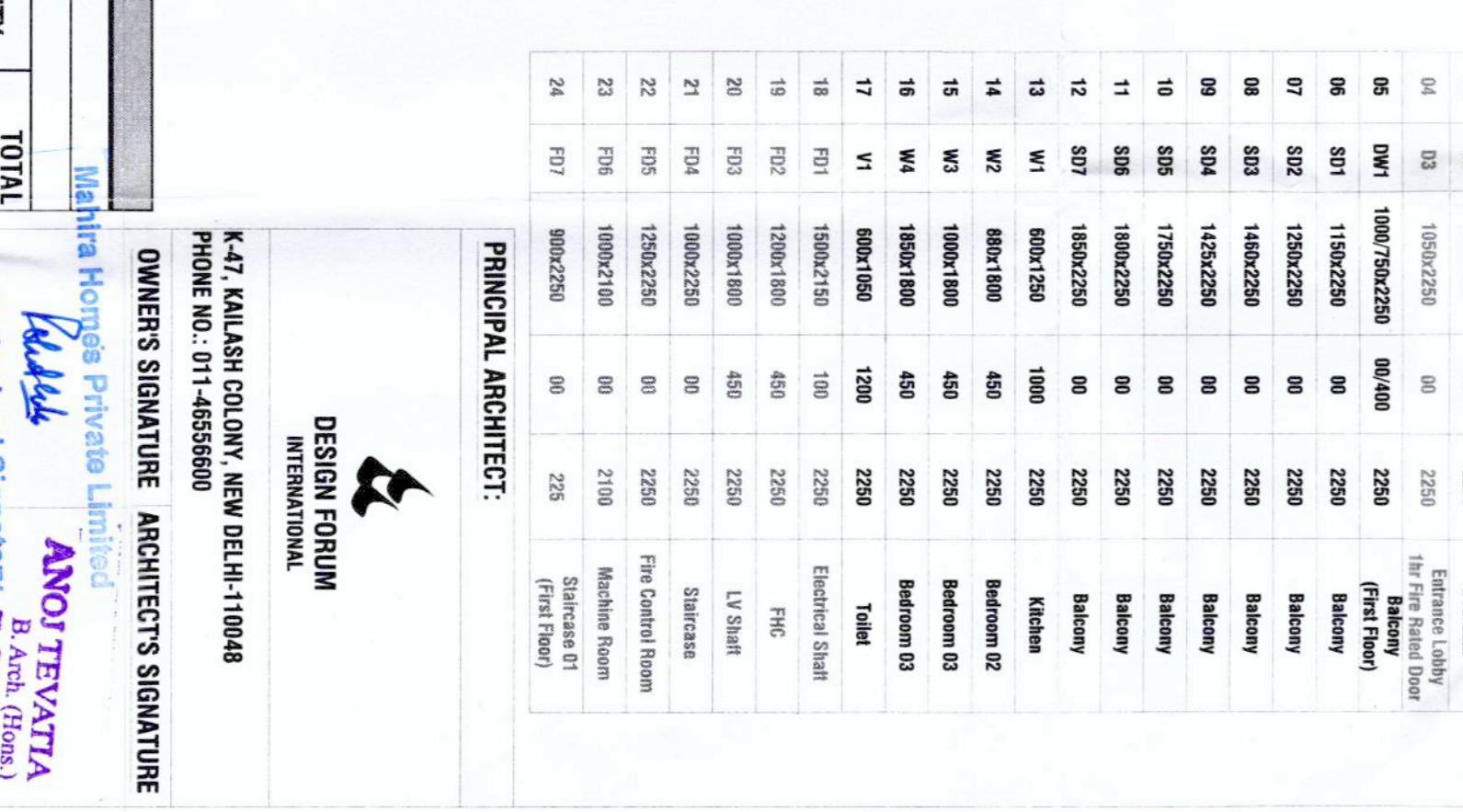
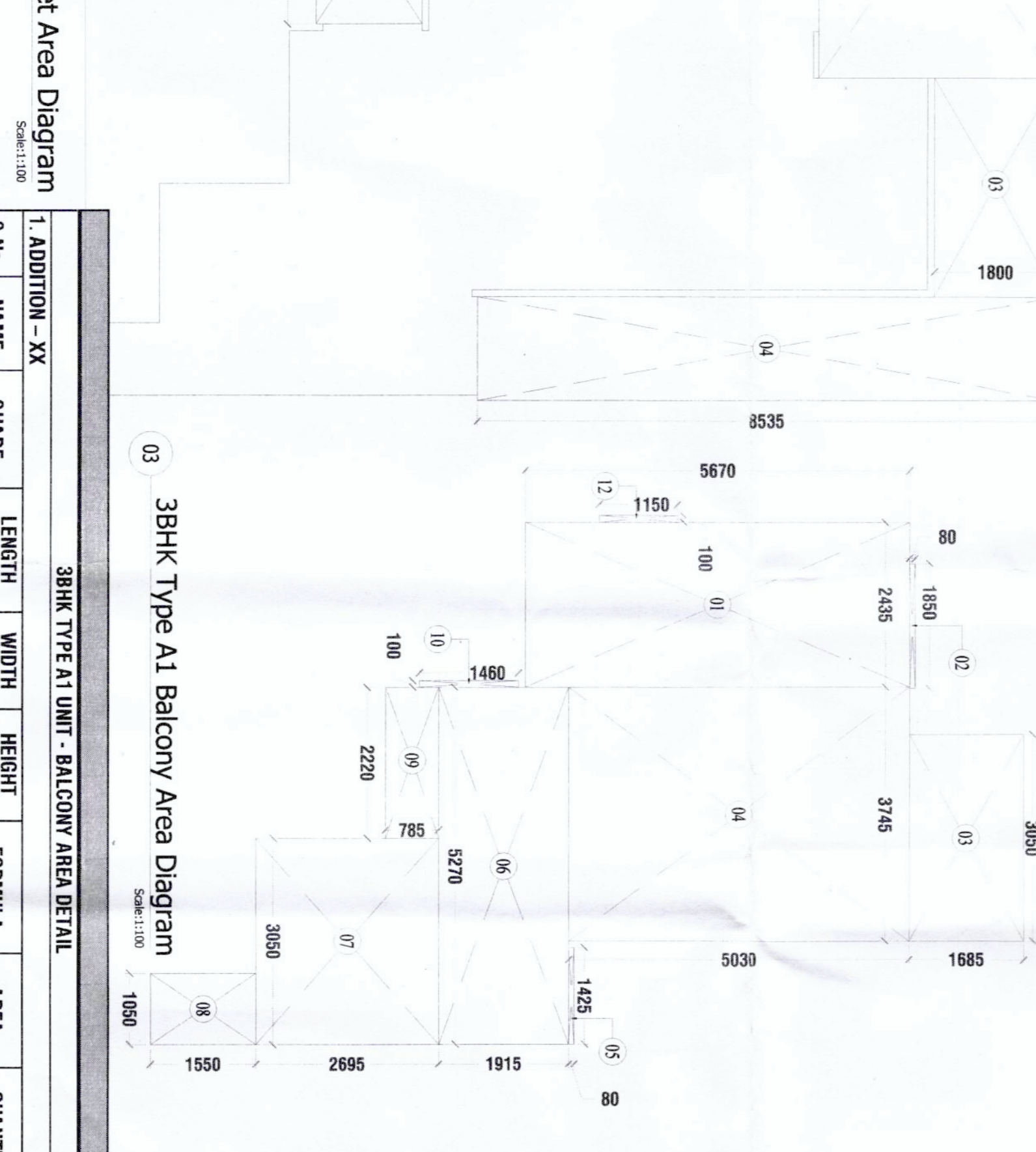
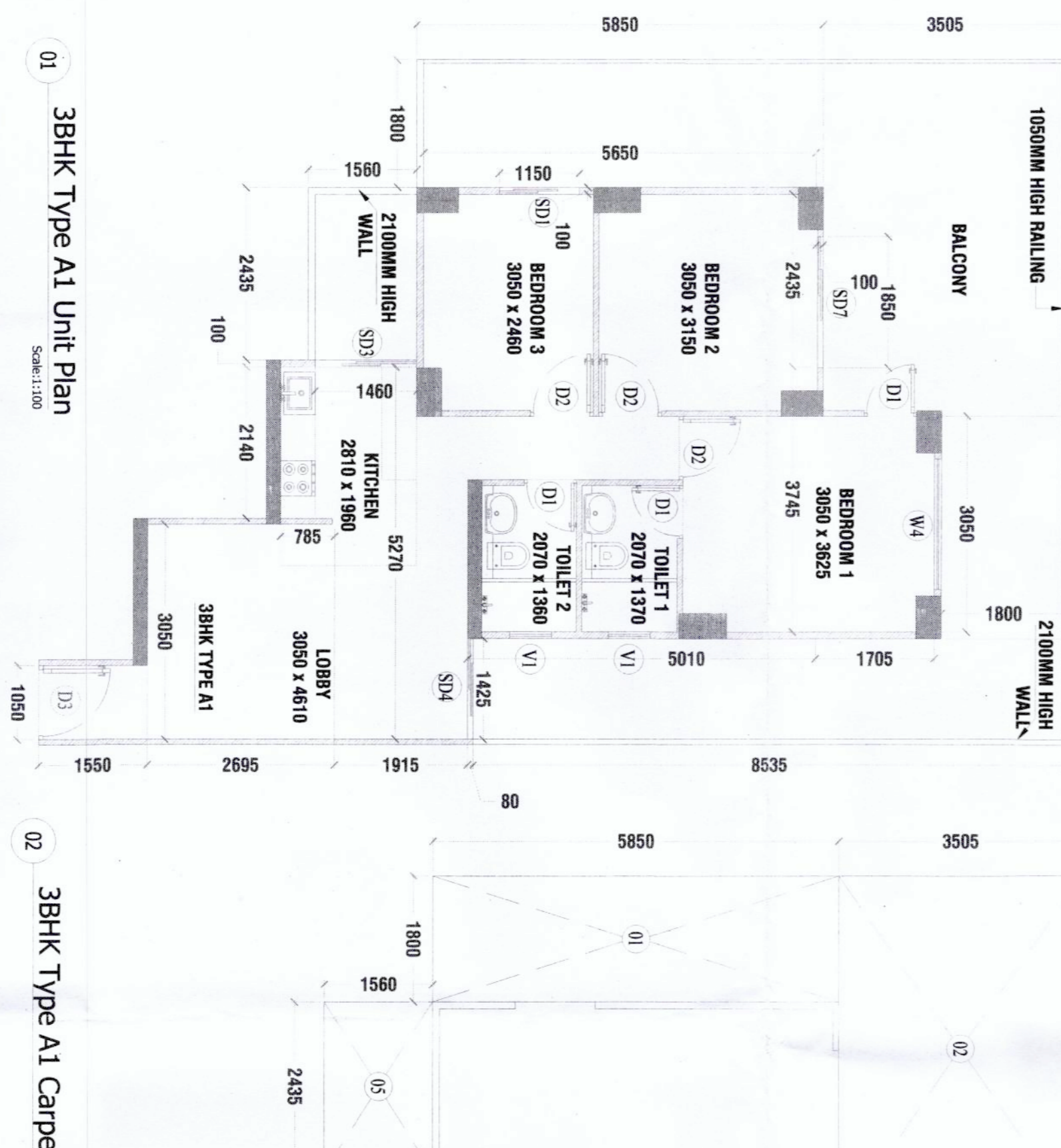

3BHK TYPE A1 UNIT - CARPET AREA DETAIL									
S.No.	NAME	SHAPE	LENGTH (L)	WIDTH (B)	HEIGHT (H)	FORMULA	AREA	QUANTITY	TOTAL AREA
1		Rectangle	2.455	5.670	-	L X B	13.806	1	13.806
2		Rectangle	1.850	0.080	-	L X B	0.148	1	0.148
3		Rectangle	3.030	1.885	-	L X B	5.139	1	5.139
4		Rectangle	3.745	3.030	-	L X B	18.837	1	18.837
5		Rectangle	1.425	0.080	-	L X B	0.114	1	0.114
6		Rectangle	5.270	1.915	-	L X B	10.092	1	10.092
7		Rectangle	3.050	2.695	-	L X B	8.220	1	8.220
8		Rectangle	1.050	1.550	-	L X B	1.628	1	1.628
9		Rectangle	2.220	0.785	-	L X B	1.743	1	1.743
10		Rectangle	0.100	1.460	-	L X B	0.146	1	0.146
11		Rectangle	0.100	1.150	-	L X B	0.115	1	0.115
TOTAL CARPET AREA OF 3BHK TYPE A1							59.988		59.988

3BHK TYPE A1 UNIT - BALCONY AREA DETAIL									
S.No.	NAME	SHAPE	LENGTH (L)	WIDTH (B)	HEIGHT (H)	FORMULA	AREA	QUANTITY	TOTAL AREA
1		Rectangle	1.630	5.650	-	L X B	10.530	1	10.530
2		Rectangle	5.030	3.505	-	L X B	17.630	1	17.630
3		Rectangle	3.150	1.800	-	L X B	5.670	1	5.670
4		Rectangle	1.500	8.535	-	L X B	12.803	1	12.803
5		Rectangle	2.435	1.550	-	L X B	3.799	1	3.799
TOTAL BALCONY AREA OF 3BHK TYPE A1 UNIT							50.431		50.431

2BHK+STORE TYPE A1 UNIT - BALCONY AREA DETAIL									
S.No.	NAME	SHAPE	LENGTH (L)	WIDTH (B)	HEIGHT (H)	FORMULA	AREA	QUANTITY	TOTAL AREA
1		Rectangle	3.750	6.190	-	L X B	23.460	1	23.460
2		Rectangle	0.325	3.050	-	L X B	0.991	1	0.991
3		Rectangle	1.900	3.100	-	L X B	5.890	1	5.890
4		Rectangle	2.335	1.540	-	L X B	3.595	1	3.595
5		Rectangle	1.250	0.990	-	L X B	1.238	1	1.238
TOTAL BALCONY AREA OF 2BHK+STORE TYPE A1 UNIT							35.175		35.175

MAHIRA HOMES PRIVATE LIMITED
 Authorised Signatory
 C/095/18739

ANOSTEVANTIA
 B Arch. (Hons.)
 C/095/18739

DESIGN FORUM INTERNATIONAL

OWNER'S SIGNATURE ARCHITECT'S SIGNATURE

PROPOSED BUILDING PLANS OF AFFORDABLE GROUP HOUSING COLONY ADAMSURING 6.675 ACRES (LICENSE NO.09 OF 2022 DATED 31-01-2022) BEING DEVELOPED IN VILLAGE HARASARU, SECTOR 88-B, GURUPURAM BY M/S BLOSSOM PROPERTIES PVT. LTD. AND OTHER LAND OWNERS IN COLLABORATION WITH M/S MAHIRA HOMES PVT. LTD.

DRAWING TITLE:
 First Floor Unit Plans, Carpet Area Diagram & Area Chart (TOWER A)

SCALE: 1:100

SHEET NO. 10A

DATE: 24.02.2022