

TOWER - A3, A4, A5, A6, A7, A8 & A9
REFUGE FLOOR PLAN
(18th, 28th & 37th FLOOR)

TOWER - A3, A4, A5, A6, A7, A8 & A9
REFUGE FLOOR PLAN
AREA DIAGRAM

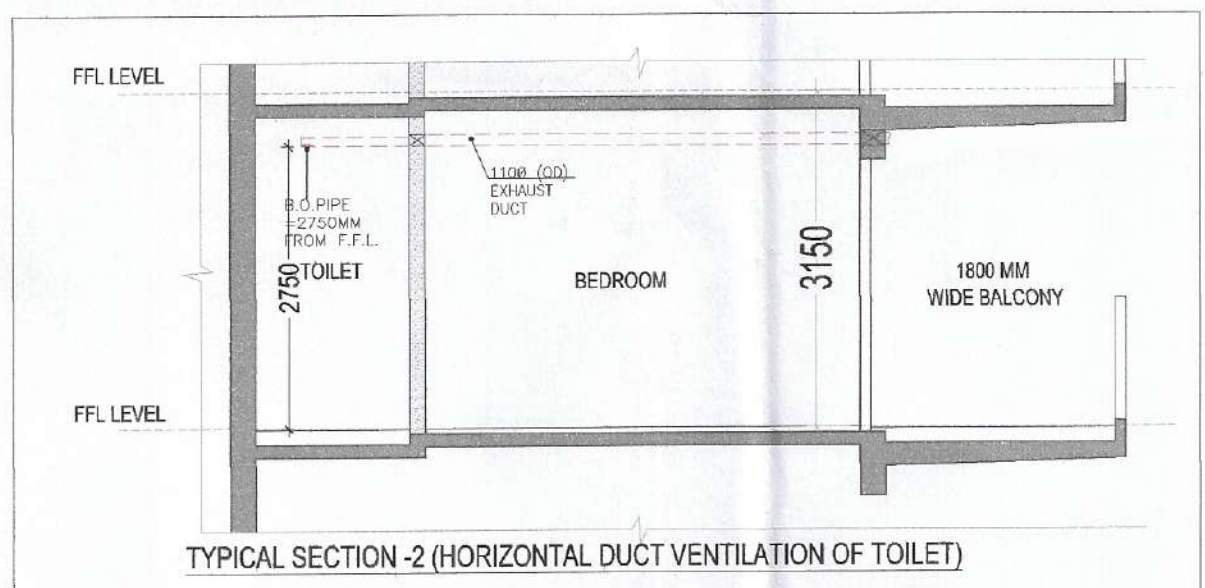

TYPICAL SECTION-2 (HORIZONTAL DUCT VENTILATION OF TOILET)

LEGEND:-

| SYB | TITLE | W | H | SILL | NOTES |
|------|--------------|------|------|--------|-----------------|
| S101 | SLIDING DOOR | 3550 | 2500 | ± 00 | |
| S102 | SLIDING DOOR | 3540 | 2500 | ± 00 | |
| S103 | SLIDING DOOR | 3440 | 2500 | ± 00 | |
| S104 | SLIDING DOOR | 3410 | 2500 | ± 00 | |
| S105 | SLIDING DOOR | 3338 | 2500 | ± 00 | |
| S106 | SLIDING DOOR | 2990 | 2500 | ± 00 | |
| S107 | SLIDING DOOR | 2850 | 2500 | ± 00 | |
| S108 | SLIDING DOOR | 2700 | 2500 | ± 00 | |
| S109 | SLIDING DOOR | 2620 | 2500 | ± 00 | |
| S110 | SLIDING DOOR | 2440 | 2500 | ± 00 | |
| S111 | SLIDING DOOR | 1825 | 2500 | ± 00 | |
| S112 | SLIDING DOOR | 1475 | 2500 | ± 00 | |
| S113 | SLIDING DOOR | 1450 | 2500 | ± 00 | |
| D1 | FLUSH DOOR | 1200 | 2500 | ± 00 | 1 HR FIRE RATED |
| D2 | FLUSH DOOR | 1000 | 2250 | ± 00 | |
| D3 | FLUSH DOOR | 1200 | 2250 | ± 00 | |
| D4 | FLUSH DOOR | 800 | 2250 | ± 00 | |
| F101 | FIRE DOOR | 1800 | 2250 | ± 00 | 2 HR FIRE RATED |
| F102 | FIRE DOOR | 1500 | 2250 | ± 00 | 2 HR FIRE RATED |
| F103 | FIRE DOOR | 1500 | 2250 | ± 100 | 2 HR FIRE RATED |
| F104 | FIRE DOOR | 1250 | 2250 | ± 00 | 2 HR FIRE RATED |
| F105 | FIRE DOOR | 900 | 2150 | ± 100 | 2 HR FIRE RATED |
| F106 | FIRE DOOR | 700 | 2150 | ± 100 | 2 HR FIRE RATED |
| F107 | FIRE DOOR | 1000 | 2150 | ± 100 | 2 HR FIRE RATED |
| W1 | DOOR WINDOW | 800 | 2250 | ± 00 | |
| W2 | GLASS DOOR | 2000 | 2500 | ± 00 | |
| W3 | WINDOW | 1500 | 1350 | + 900 | |
| W4 | WINDOW | 1075 | 1350 | + 900 | |
| V1 | VENTILATOR | 600 | 1700 | + 1850 | |

PLUMBING LEGEND

| S.NO. | DESCRIPTION |
|-------|--|
| 1 | 1000 SOIL & VENT PIPE |
| 2 | 1000 WASTE & VENT PIPE |
| 3 | 1000 ANTISYPHONAGE PIPE |
| 4 | 110 OD RAIN WATER PIPE |
| 5 | 180 OD RAIN WATER PIPE |
| 6 | DOMESTIC WATER SUPPLY DOWN TAKE FOR TOP FOUR FLOOR (35-32) |
| 7 | DOMESTIC WATER SUPPLY DOWN TAKE FOR (31-17) FLOOR |
| 8 | DOMESTIC WATER SUPPLY DOWN TAKE FOR (16-GRO.) FLOOR |
| 9 | FLUSHING WATER SUPPLY DOWN TAKE FOR (35-24) FLOOR |
| 10 | FLUSHING WATER SUPPLY DOWN TAKE FOR (23-12) FLOOR |
| 11 | FLUSHING WATER SUPPLY DOWN TAKE FOR (11-GROUND) FLOOR |
| 12 | DOMESTIC WATER RISER PIPE TO OHT |
| 13 | FLUSHING WATER RISER PIPE TO OHT |

LEGEND

| | |
|-----------|----------------------------|
| [Pattern] | FAR AREA |
| [Pattern] | NON FAR AREA |
| [Pattern] | SERVICE AREA |
| [Pattern] | SHAFT AREA UNDER DEDUCTION |
| [Pattern] | FIRE TENDER PATH |
| [Pattern] | TOWER LINE |

HORIZONTAL PIPE CONNECTIONS SHALL BE AS FOLLOWS.

| | |
|---------------------------|-----------|
| FROM WASH BASIN TO FT | 320 PIPE |
| FROM SINK TO FT | 400 PIPE |
| FROM FD TO FT | 500 PIPE |
| FROM FT TO VERTICAL STACK | 1000 PIPE |
| FROM WC TO VERTICAL STACK | 1000 PIPE |

PLUMBING LEGEND

| S.NO. | DESCRIPTION |
|-------|---|
| A | 1500 FIRE PIPE LOWE ZONE BASEMENT TO 9th FLOOR |
| B | 1500 FIRE PIPE MIDDLE ZONE 10th TO 23rd FLOOR |
| C | 1500 FIRE PIPE HIGH ZONE 24th TO TERRACE LVL. |
| D | 1500 SPRINKLER PIPE LOWE ZONE BASEMENT TO 9th FLOOR |
| E | 1500 SPRINKLER PIPE MIDDLE ZONE 10th TO 23rd FLOOR |
| F | 1500 SPRINKLER PIPE HIGH ZONE 24th TO TERRACE LVL. |
| G | 1500 ALTERNATE SPRINKLER PIPE LOWE ZONE BASEMENT TO 9th FLOOR |
| H | 1500 ALTERNATE SPRINKLER PIPE MIDDLE ZONE 10th TO 23rd FLOOR |
| J | 1500 ALTERNATE SPRINKLER PIPE HIGH ZONE 24th TO TERRACE LVL. |
| K | 1500 FIRE DOWN COMER PIPE |
| L | 800 DRAIN PIPE |

SUMMARY OF MECHANICAL VENTILATION

| Floor | Area Sq Ft | Intrusive FT | Volume CFM | Air Change Per Hour | Exhaust CFM | Inlet CFM | Application | No. of Fan & Fan Capacity | Type of Fan | Remark |
|---|------------|--------------|------------|---------------------|-------------|-----------|-------------|---------------------------|-------------|-------------|
| General Ventilation | | | | | | | | | | |
| 1 Toilet For Bedroom 3 - Typical | 42 | 9 | 378 | 10 | 63 | 100 | Exhaust | 1x 100 CFM | Inline Fan | Normal Mode |
| 2 Common Toilet For Bedroom 3 - Typical | 45 | 9 | 405 | 10 | 68 | 100 | Exhaust | 1x 100 CFM | Inline Fan | Normal Mode |

REFUGE AREA CALCULATION AT 18TH, 27TH & 36TH FLOOR

| TAG | LENGTH (L) In Mts | WIDTH (W) In Mts | N.O.S (N) | AREA(SqM) (L x W x N) |
|-----------|-------------------|------------------|-----------|-----------------------|
| R1 | 1.250 | 0.160 | 1 | 0.200 |
| R2 | 0.090 | 3.770 | 1 | 0.339 |
| R3 | 1.335 | 6.120 | 1 | 8.170 |
| R4 | 2.260 | 3.350 | 1 | 7.571 |
| R5 | 3.340 | 0.240 | 1 | 0.802 |
| R6 | 3.920 | 1.660 | 1 | 6.507 |
| R7 | 0.240 | 1.250 | 1 | 0.300 |
| TOTAL (R) | | | | 23.889 |

GROSS AREA at 18th/27th/36th FLOOR 469.545
 GROSS AREA at 17th/26th/35th FLOOR 486.224
 TOTAL GROSS AREA at 18th/27th/36th & 17th/26th/35th FLOOR (G) 955.769
 B = GROSS AREA (G)/12.5 76.462
 C = B * 0.3 22.938
 ADDITIONAL SPACE REQUIRED TO 0.900
 TOTAL REFUGE AREA REQUIRED 23.838
 TOTAL REFUGE AREA PROVIDED = (RF1) 23.889

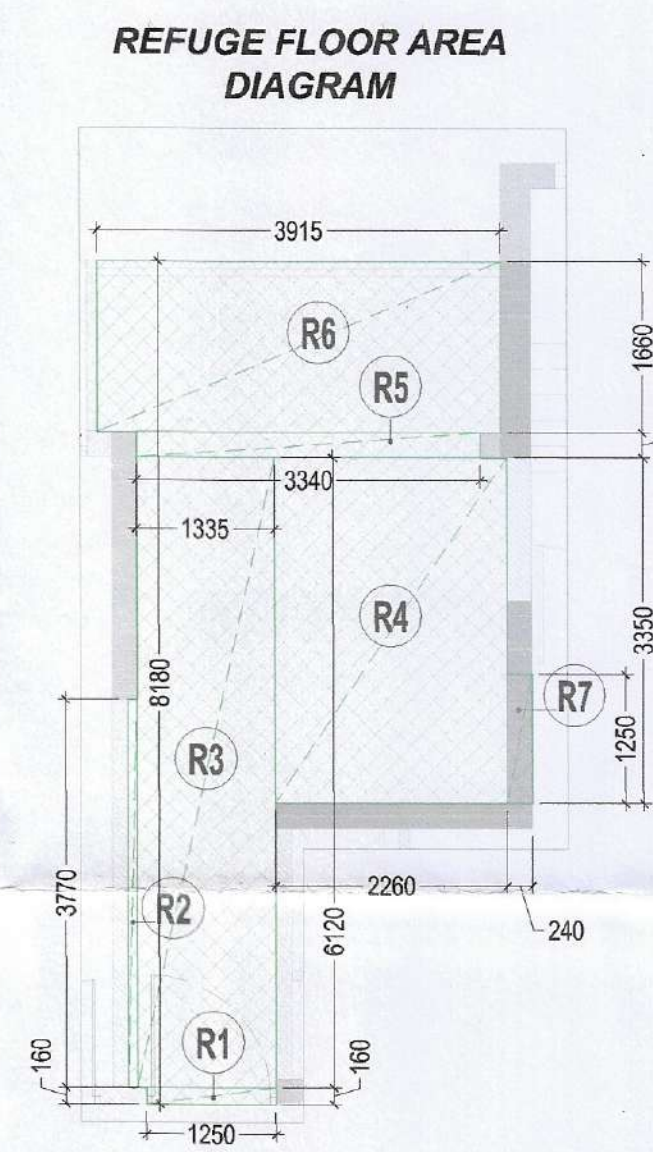

FAR AREA OF TOWER TYPE AT REFUGE FLOOR LEVEL

| TAG | LENGTH (L) In Mts | WIDTH (W) In Mts | N.O.S (N) | AREA(SqM) (L x W x N) |
|-----------|-------------------|------------------|-----------|-----------------------|
| A | 32.140 | 24.740 | 1 | 795.144 |
| TOTAL (A) | | | | 795.144 |

DEDUCTIONS

| TAG | LENGTH (L) In Mts | WIDTH (W) In Mts | N.O.S (N) | AREA(SqM) (L x W x N) |
|-----------|-------------------|------------------|-----------|-----------------------|
| D1 | 34.080 | 4.025 | 1 | 56.672 |
| D2 | 2.620 | 0.340 | 1 | 0.367 |
| D3 | 7.260 | 0.340 | 1 | 1.016 |
| D4 | 2.800 | 0.340 | 1 | 0.367 |
| D5 | 4.555 | 0.340 | 2 | 1.163 |
| D6 | 3.575 | 2.770 | 2 | 19.806 |
| D7 | 1.450 | 0.340 | 2 | 0.406 |
| D8 | 1.775 | 4.230 | 2 | 14.625 |
| D9 | 2.685 | 1.600 | 2 | 8.576 |
| D10 | 1.075 | 0.510 | 2 | 1.097 |
| D11 | 1.315 | 1.800 | 1 | 2.367 |
| D12 | 5.200 | 5.895 | 1 | 29.514 |
| D13 | 3.250 | 3.655 | 1 | 11.879 |
| D14 | 4.170 | 2.040 | 1 | 8.507 |
| D15 | 0.570 | 1.800 | 2 | 2.052 |
| D16 | 1.075 | 0.515 | 2 | 1.107 |
| D17 | 1.475 | 0.340 | 2 | 0.413 |
| D18 | 1.825 | 2.775 | 2 | 10.129 |
| D19 | 4.130 | 0.340 | 2 | 1.156 |
| D20 | 2.845 | 0.340 | 1 | 0.398 |
| D21 | 2.610 | 0.340 | 1 | 0.395 |
| D22 | 3.340 | 0.340 | 1 | 0.468 |
| D23 | 2.970 | 1.660 | 1 | 4.930 |
| D24 | 6.890 | 4.025 | 1 | 27.731 |
| D25 | 6.890 | 2.365 | 1 | 16.295 |
| D26 | 3.850 | 1.415 | 1 | 5.448 |
| D27 | 2.340 | 1.800 | 1 | 4.212 |
| D28 | 4.170 | 7.735 | 1 | 32.255 |
| R1 | 1.250 | 0.160 | 1 | 0.200 |
| R2 | 0.090 | 3.770 | 1 | 0.339 |
| R3 | 1.335 | 6.120 | 1 | 8.170 |
| R4 | 2.260 | 3.350 | 1 | 7.571 |
| R5 | 3.340 | 0.240 | 1 | 0.802 |
| R6 | 3.920 | 1.660 | 1 | 6.507 |
| R7 | 0.240 | 1.250 | 1 | 0.300 |
| TOTAL (D) | | | | 285.947 |

LIFT & SERVICES SHAFTS AT REFUGE FLOOR LEVEL

| TAG | LENGTH (L) In Mts | WIDTH (W) In Mts | N.O.S (N) | AREA(SqM) (L x W x N) |
|-----------|-------------------|------------------|-----------|-----------------------|
| S1 | 1.860 | 1.360 | 1 | 2.530 |
| S2 | 2.500 | 2.500 | 3 | 17.250 |
| S3 | 1.345 | 1.365 | 1 | 1.458 |
| S4 | 0.860 | 0.500 | 1 | 0.430 |
| S5 | 0.860 | 1.850 | 1 | 1.591 |
| S6 | 1.000 | 1.365 | 1 | 1.395 |
| S7 | 0.590 | 1.365 | 1 | 0.823 |
| S8 | 1.890 | 0.540 | 1 | 0.365 |
| S9 | 0.460 | 0.300 | 2 | 0.294 |
| S10 | 1.085 | 0.420 | 2 | 0.935 |
| S11 | 0.530 | 1.765 | 2 | 2.871 |
| S12 | 0.670 | 0.340 | 2 | 0.322 |
| S13 | 0.750 | 1.525 | 2 | 2.288 |
| S14 | 0.460 | 0.335 | 2 | 0.308 |
| S15 | 1.040 | 0.435 | 2 | 0.905 |
| S16 | 1.890 | 1.030 | 1 | 2.054 |
| S17 | 2.020 | 0.365 | 1 | 0.737 |
| TOTAL (S) | | | | 87.406 |

FIRE STAIRCASE & NON FAR AREA

| TAG | LENGTH (L) In Mts | WIDTH (W) In Mts | N.O.S (N) | AREA(SqM) (L x W x N) |
|-----------|-------------------|------------------|-----------|-----------------------|
| N1 | 4.250 | 3.655 | 1 | 15.534 |
| N2 | 1.045 | 1.175 | 1 | 1.228 |
| N3 | 4.550 | 2.570 | 1 | 11.694 |
| N4 | 1.480 | 2.570 | 1 | 3.804 |
| N5 | 3.750 | 6.440 | 1 | 24.090 |
| TOTAL (N) | | | | 58.146 |

FIRE STAIRCASE WELL

| TAG | LENGTH (L) In Mts | WIDTH (W) In Mts | N.O.S (N) | AREA(SqM) (L x W x N) |
|-----------|-------------------|------------------|-----------|-----------------------|
| W1 | 0.750 | 1.500 | 1 | 1.125 |
| W2 | 1.750 | 1.155 | 1 | 2.021 |
| TOTAL (W) | | | | 3.146 |

NON FAR AREA (NF) = (N) - (W)

TOTAL FAR AREA (F) = (A) - (D) - (S) - (N) 419.502
 TOTAL COVERED AREA = (F) + (NF) 488.545
 G.TOTAL NON FAR AREA (NF) = (N) - (W) + (RF1) 73.932

Checked and found ok for Public Health
(Internal) Service only subject to comments in forwarding letter No. 3665/11... D.V. 28/11/25

Superintending Engineer (HQ)
for Chief Engineer-I
HSVP, Panchkula

SACTIONED TO BE READ WITH THIS OFFICE MEMO NO. 46660 DATED: 9/12/25

M. K. SINGH S.T.P. (HQ) Member Secretary B.P.A.C.
 S. P. GUPTA S.T.P. (G) Member B.P.A.C.
 T. P. (H) Chairman B.P.A.C.

U.P. (HQ) A.T.P. (HQ) A.T.P. DINE KUMAR PA (HQ) F.C. (H) A.P.A.C.

NOTE:
 1. BUILDING HAS AUTOMATIC SPRINKLER SYSTEM WHEREVER REQUIRED BY NBC.
 2. BUILDING WILL BE DESIGNED (STRUCTURES) AS PER RELEVANT IS CODES FOR EARTH QUAKE RESISTANCE.
 3. 100% POWER BACKUP/ MECHANICAL VENTILATED SHAFTS.
 4. ALL RESIDENTIAL UNITS ENTRANCE DOOR-1HR FIRE RATED.

KEY PLAN:

PROJECT
 PROPOSED BUILDING PLAN FOR AFFORDABLE GROUP HOUSING-1 (PROJECT-A) OVER AN AREA MEASURING 16.4378 ACRES, PART OF INDUSTRIAL PLOTTED COLONY OVER AN AREA MEASURING 138.7875 ACRES (LICENSE NO. 188 OF 2025 DATED 06.08.2025) IN THE RESERVE ESTATE OF VILLAGE BAHAW AND JHUND SARAI ABAD, IN SECTOR M3, M10 AND M11 SURROUNDING MANESAR URBAN COMPLEX.

OWNER
 M3M INDIA INFRASTRUCTURES PVT. LTD.

ARCHITECTS
 STUDIO SYMBIOSIS
 INDIA | GERMANY | UK
 1301, TOWER-E, SKYMARK ONE
 SECTOR 38, NOIDA, U.P. 201301, NOIDA
 TEL: +91 9126 428679
 E-MAIL: INFO@STUDIOSYMBIOSIS.COM
 WWW.STUDIOSYMBIOSIS.COM

OWNERS SEAL & SIGNATURE
 For M3M India Infrastructures Pvt. Ltd.
 (Authorized Signatory)

ARCHITECTS SEAL & SIGNATURE
 AMIT GUPTA Architect
 CA / 2004 / 33147

DATE: SCALE: 1:100 DWG NO: FP-A3A4A5A6A7A8A9-RE-01
 DWG TITLE: REFUGE FLOOR PLAN & AREA DIAGRAM (TOWER - A3, A4, A5, A6, A7, A8 & A9)