

DOOR, WINDOW & VENTILATOR SCHEDULE

S.No.	TYPE	WIDTH	CILL	LINTEL
1	D	1.165	0	2.450
2	D1	1.000	0	2.450
3	D2	0.750	0	2.450
4	SD1	2.125	0	2.450
5	W/EF	1.200	0.9	2.450
6	W1	1.525	1.900	2.450
7	V/PV	0.600	1.550	2.450

AREA STATEMENT

DESCRIPTION	AREA (sq.mts)	UNIT		
TOTAL PLOT AREA = 7.000 M X 15.000 M	105,000	sq.mts.		
PERMISSIBLE COVERED F.A.R. @ 200%	210,000	sq.mts.		
TOTAL PERMISSIBLE GROUND COVERAGE @ 76%	78,750	sq.mts.		
ACHIEVED F.A.R. @ 84%	67,200	sq.mts.		
TOTAL FAR 284%	277,200	sq.mts.		
PROPOSED F.A.R. AREA OF STILT				
A	1.845 X 1.730	= 3,192 sq.mts.		
B	2.195 X 4.625	= 10,152 sq.mts.		
TOTAL FAR AREA OF A+B		= 13,344 sq.mts.		
NON F.A.R. AREA OF STILT				
AA	7.000 X 11.500	= 80,500 sq.mts.		
1+2+A+B		= 18,576 sq.mts.		
TOTAL AREA FAR + NON FAR (AA - 1+2)		= 81,824 sq.mts.		
PROPOSED F.A.R. ON FIRST FLOOR				
AA	7.000 X 11.500	= 80,500 sq.mts.		
1	2.115 X 1.565	= 3,310 sq.mts.		
2	4.805 X 0.400	= 1,922 sq.mts.		
3	1.850 X 4.165	= 7,705 sq.mts.		
4	1.500 X 1.500	= 2,250 sq.mts.		
TOTAL OF 1 TO 4		= 18,187 sq.mts.		
PROPOSED F.A.R. ON FIRST FLOOR		= 88,313 sq.mts.		
PROPOSED F.A.R. ON SECOND FLOOR		= 88,313 sq.mts.		
PROPOSED F.A.R. ON THIRD FLOOR		= 88,313 sq.mts.		
PROPOSED F.A.R. ON FOURTH FLOOR		= 88,313 sq.mts.		
TOTAL PROPOSED F.A.R. AREA ON ALL FLOORS (STILT + FF + SF + TF + 4TH)		= 274,898 sq.mts.		
NON F.A.R. AREA OF MUMMY				
A	1.845 X 1.730	= 3,192 sq.mts.		
B	2.195 X 4.625	= 10,152 sq.mts.		
TOTAL FAR AREA OF A+B		= 13,344 sq.mts.		
FLOORS	FAR AREA	NON FAR AREA	TOTAL	SQ.MTS.
STILT AREA	13,344	81,824		75,288
FIRST FLOOR	65,313	9,955	3+4+5+6	75,268
SECOND FLOOR	65,313	9,955	3+4+5+6	75,268
THIRD FLOOR	65,313	9,955	3+4+5+6	75,268
FOURTH FLOOR	65,313	9,955	3+4+5+6	75,268
MUMMY AREA		13,344		13,344
TOTAL ALL FLOOR AREA (FAR AREA + NON FAR AREA)				389,884



SECTION

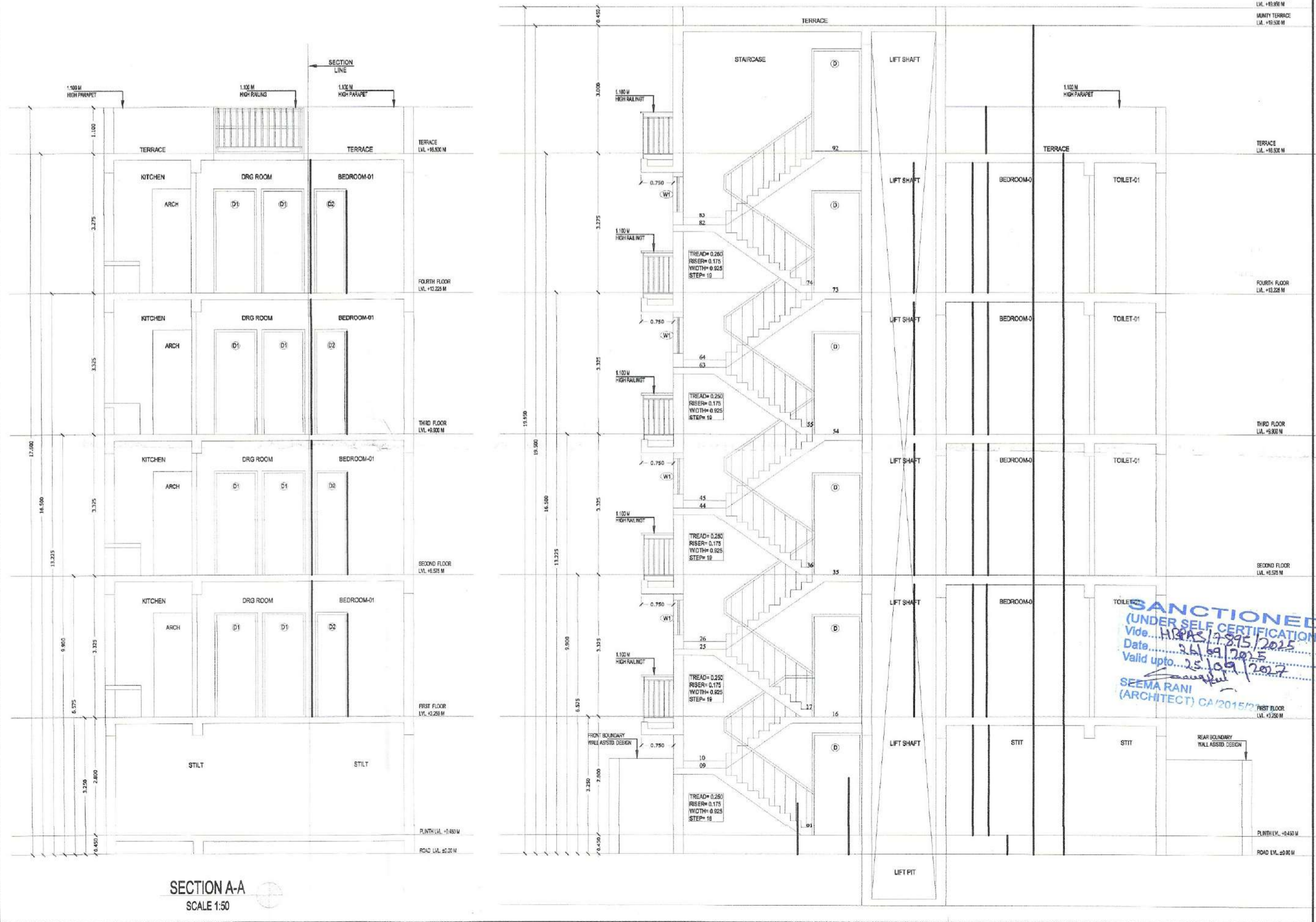

SANCTIONED
(UNDER SELF CERTIFICATION)
Via. LIAISON DT-215/2025
Date. 11/11/2025
Valid upto. 12/10/2025
SEEMA RANI
(ARCHITECT) CA/2015/72259

OWNER NAME:- LION INFRADEVELOPERS LLP
PLOT NO= B-163
at Sector 06, Sohna, Haryana

PROJECT NAME:- RESIDENTIAL PLOTTED COLONY UNDER DDJAY MERASURING 12.505 ACRES (LICENCE NO. 188 OF 2023 DATED 15.09.2023) IN SECTOR-06, SOHNA BEING DEVELOPED BY LION INFRADEVELOPERS LLP.

STILT FLOOR PLAN, FIRST FLOOR PLAN, SECOND FLOOR PLAN, THIRD FLOOR PLAN, FOURTH FLOOR PLAN, TERRACE PLAN, MUMMY PLAN, D/W SCHEDULE, AREA CHART, ELEVATION & SECTION

Dwg. No. - AR/PLOT NO=B-163/SHEET 01 OF 01 Scale 1:50

ARCHITECTS SIGN: *Seema Rani*
Signature of Architect **SEEMA RANI**
CA/2015/72259

OWNER'S SIGN: *Pankaj Kapoor*
FOR LION INFRADEVELOPERS LLP
AUTHORISED SIGNATORY

Drawn by:- PANKAJ KAPOOR Mod. No. - 8800093157