

S.T.P. (H)
 Member Secretary / Member
 B.P.A.C.

S.T.P. (G)
 Chairman
 B.P.A.C.

AD

PA

ATP

(H) Member
 B.P.A.C.

SANCTIONED
 TO BE READ WITH THIS OFFICE
 NO. 107
 10/10/24

GURPREET
 JI (H)

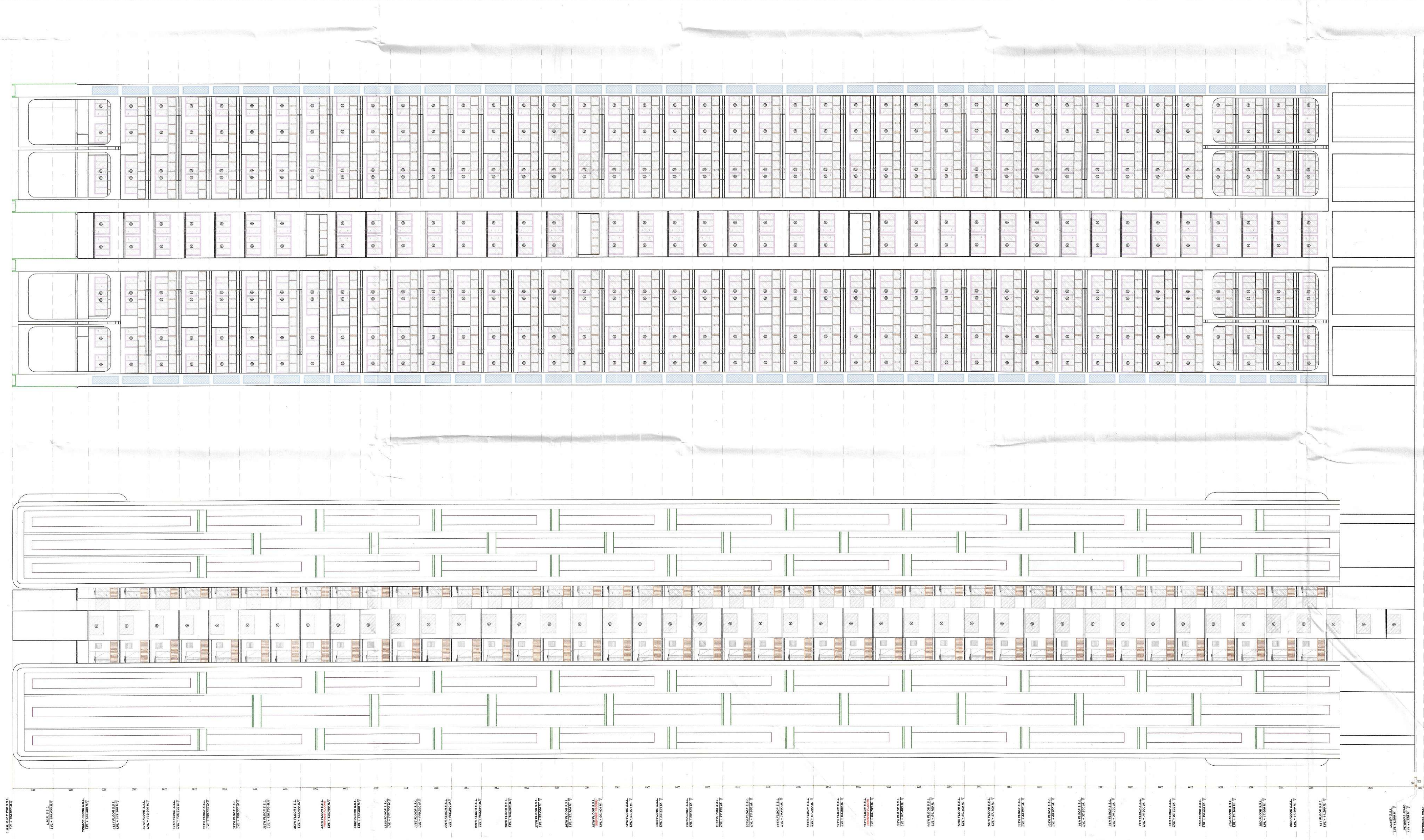

ROAD SIDE ELEVATION

LEFT SIDE ELEVATION

CLIENT: SIGNATUREGLOBAL HOMES PVT. LTD.

ARCHITECT: NISAR AHMED ANSARI
 ARCHITECT (B.ARCH)
 CA/200538034

PROJECT: PROPOSED MIXED LAND USE COLONY (96% RESIDENTIAL COMPONENT & 4% COMMERCIAL COMPONENT) UNDER TOD POLICY ON THE AREA MEASURING 13.5856 ACRES IN THE REVENUE ESTATE GADAUJI KALAN, SECTOR 37D, GURUGRAM MANESAR URBAN COMPLEX, LICENSE NO.172 OF 2024, DATED 03.12.2024, BEING DEVELOPED BY SIGNATUREGLOBAL HOMES PVT. LTD.

DRAWING TITLE: (TOWER - 6)
 LEFT SIDE & ROAD SIDE ELEVATION

SHEET NO. 107
 ARCHITECT'S SIGN
 OWNERS SIGN

SCALE: 1:100
 NISAR AHMED ANSARI
 ARCHITECT (B.ARCH)
 DATE: 2025.08. CA/200538034