

S.No.	TYPE	WIDTH	CILL	LINTEL
1	D	1.075	0	2.450
2	D1	1.000	0	2.450
3	D2	0.750	0	2.450
4	D3	0.995	0	2.450
5	DW1	1.750	0	2.450
6	W/EF	1.850	0	2.450
7	W1	1.525	900	2.450
8	VPV	0.750	1.550	2.450

AREA STATEMENT					
TOTAL PLOT AREA = 8.650 M X 15.000 M		129.750	sq.mts.		
ERMSSIBLE COVERED F.A.R. @ 200%		259.500	sq.mts.		
TOTAL PERMISSIBLE GROUND COVERAGE @ 75%		97.313	sq.mts.		
ACHIVED F.A.R. @ 64%		83.040	sq.mts.		
TOTAL FAR 264%		342.540	sq.mts.		
PROPOSED F.A.R. AREA OF STILT					
A	1.730 X 1.535	=	2.656 sq.mts.		
B	2.195 X 4.535	=	9.954 sq.mts.		
C	1.730 X 1.730	=	2.993 sq.mts.		
TOTAL FAR AREA OF A+B+C		=	15.603 sq.mts.		
NON F.A.R. AREA OF STILT					
AA	8.650 X 11.320	=	97.918 sq.mts.		
1+2+A+B+C		=	20.316 sq.mts.		
TOTAL AREA FAR + NON FAR (AA - 1+2)		=	77.602 sq.mts.		
PROPOSED F.A.R. ON FIRST FLOOR 5.854					
AA	8.650 X 11.320	=	97.918 sq.mts.		
or	97.918 LESS 16.362	=	81.556 sq.mts.		
1	2.485 X 1.565	=	3.889 sq.mts.		
2	6.340 X 0.130	=	0.824 sq.mts.		
3	1.850 X 4.075	=	7.539 sq.mts.		
4	0.230 X 1.075	=	0.247 sq.mts.		
5	1.500 X 1.075	=	1.613 sq.mts.		
6	1.500 X 1.500	=	2.250 sq.mts.		
TOTAL OF 1 TO 6		=	16.362 sq.mts.		
PROPOSED F.A.R. ON FIRST FLOOR		=	81.556 sq.mts.		
PROPOSED F.A.R. ON SECOND FLOOR		=	81.556 sq.mts.		
PROPOSED F.A.R. ON THIRD FLOOR		=	81.556 sq.mts.		
PROPOSED F.A.R. ON FOURTH FLOOR		=	81.556 sq.mts.		
TOTAL PROPOSED F.A.R. AREA ON ALL FLOORS (STILT + FF + SF + TF + 4TH)		=	341.827 sq.mts.		
NON F.A.R. AREA OF MUMTY					
A	1.730 X 1.535	=	2.656 sq.mts.		
B	2.195 X 4.535	=	9.954 sq.mts.		
C	1.730 X 1.730	=	2.993 sq.mts.		
TOTAL AREA (A+B+C)		=	15.603 sq.mts.		
FLOORS	FAR AREA	+	NON FAR AREA	TOTAL	SQ.MTS.
STILT AREA	15.603	+	77.602	=	93.205 sq.mts.
FIRST FLOOR	81.556	+	3+4+5+6	=	93.205 sq.mts.
SECOND FLOOR	81.556	+	3+4+5+6	=	93.205 sq.mts.
THIRD FLOOR	81.556	+	3+4+5+6	=	93.205 sq.mts.
FOURTH FLOOR	81.556	+	3+4+5+6	=	93.205 sq.mts.
MUMTY AREA			15.603	=	15.603 sq.mts.
TOTAL ALL FLOOR AREA (FAR AREA + NON FAR AREA)				=	481.628 sq.mts.

ELEVATION



SECTION

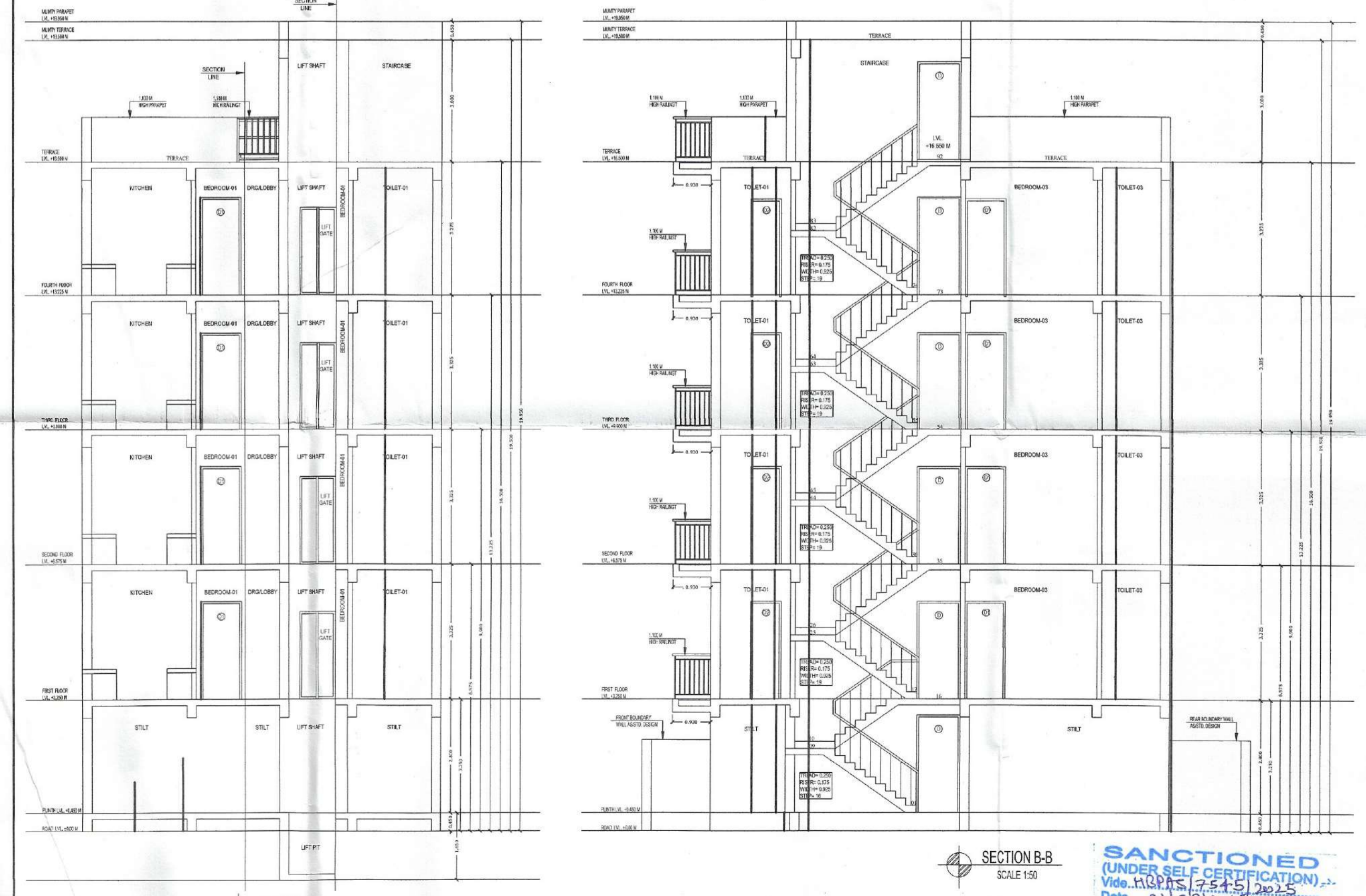

OWNER NAME:- LION INFRADEVELOPERS LLP  
 PLOT NO= A-22  
 at Sector 06, Sohna, Haryana

PROJECT NAME:- RESIDENTIAL PLOTTED COLONY UNDER DDJAY MERASURING 12.505 ACRES (LICENCE NO. 188 OF 2023 DATED 15.09.2023) IN SECTOR-06, SOHNA BEING DEVELOPED BY LION INFRADEVELOPERS LLP.

STILT FLOOR PLAN, FIRST FLOOR PLAN, SECOND FLOOR PLAN, THIRD FLOOR PLAN, FOURTH FLOOR PLAN, TERRACE PLAN, MUMTY PLAN, D/W SCHEDULE, AREA CHART, ELEVATION & SECTION

Drig. No.- AR/PLOT NO=A-22/SHEET D1 OF 01 Scale 1:50

ARCHITECTS SIGN  
 Signature of Architect  
**SEEMA RANI**  
 CA/2015/72259

OWNER'S SIGN  
 FOR LION INFRADEVELOPERS LLP  
 AUTHORIZED SIGNATORY

Drawn by:- PANKAJ KAPOOR Mob. No. - 880093157

SANCTIONED  
 (UNDER SELF CERTIFICATION)  
 Video, 11/08/2025  
 Date, 01/09/2025  
 Valid upto, 01/09/2027

SEEMA RANI  
 (ARCHITECT) CA/2015/72259