

S.T.P (Hq) Member Secretary B.P.A.C.  
 S.T.P (G) Member B.P.A.C.  
 C.T.P (Hr.) Chairman B.P.A.C.

S.D. B.P. A.P.

DTP(HQ)

ATP(HQ)

MEMBER B.P.A.C.  
 Ram Avtar Bassi JD(HQ)

SANCTIONED  
 TO BE READ WITH THIS OFFICE  
 MEMO NO.:  
 DATED :

**N O T E S**

1. Dimensions are not to be scaled.
2. All dimensions are in mm.
3. All windows and ventilators are openable.
4. Lift well are mechanically Pressurized.
5. Fire services install as per NBC.
6. 100% power backup for emergency services.

key plan

Owner's Sign&Stamp

For ROF Infratech and Housing Pvt. Ltd.

Authorised Signatory

Architect's Sign&Stamp

JYOTI PRAKASH SHARMA  
 CA2008443101

Architects :



Electrical, Plumbing, HVAC & Fire Fighting

BEHERA ASSOCIATES PVT LTD  
 F-623a, LADO SARAI  
 BEHIND CNG FILLING STATION  
 NEW DELHI - 110030  
 EMAIL-behera.associates@gmail.com

Project Title :

PROPOSED BUILDING PLAN OF AFFORDABLE GROUP  
 HOUSING COLONY OVER AN AREA MEASURING  
 11.1875 ACRE (LICENCE NO. 182 OF 2024 DATED  
 10/12/2024 IN SECTOR 07, SOHNA, BEING DEVELOPED  
 BY ROF INFRA TECH & HOUSING PVT. LTD.

Drawing Title :

TOWER-10&11,12 & 12A  
 SECTIONS

Scale :	1:125	Rev :	
Date :	27-12-2024	Drawn By :	Piyush Sharma
Drawn By :	Piyush Sharma	Checked By :	J.P. SHARMA
Checked By :	J.P. SHARMA	Sheet Size :	A0 841x1189mm
		Drawing Status :	Submission Drawing

SD/AH/8A

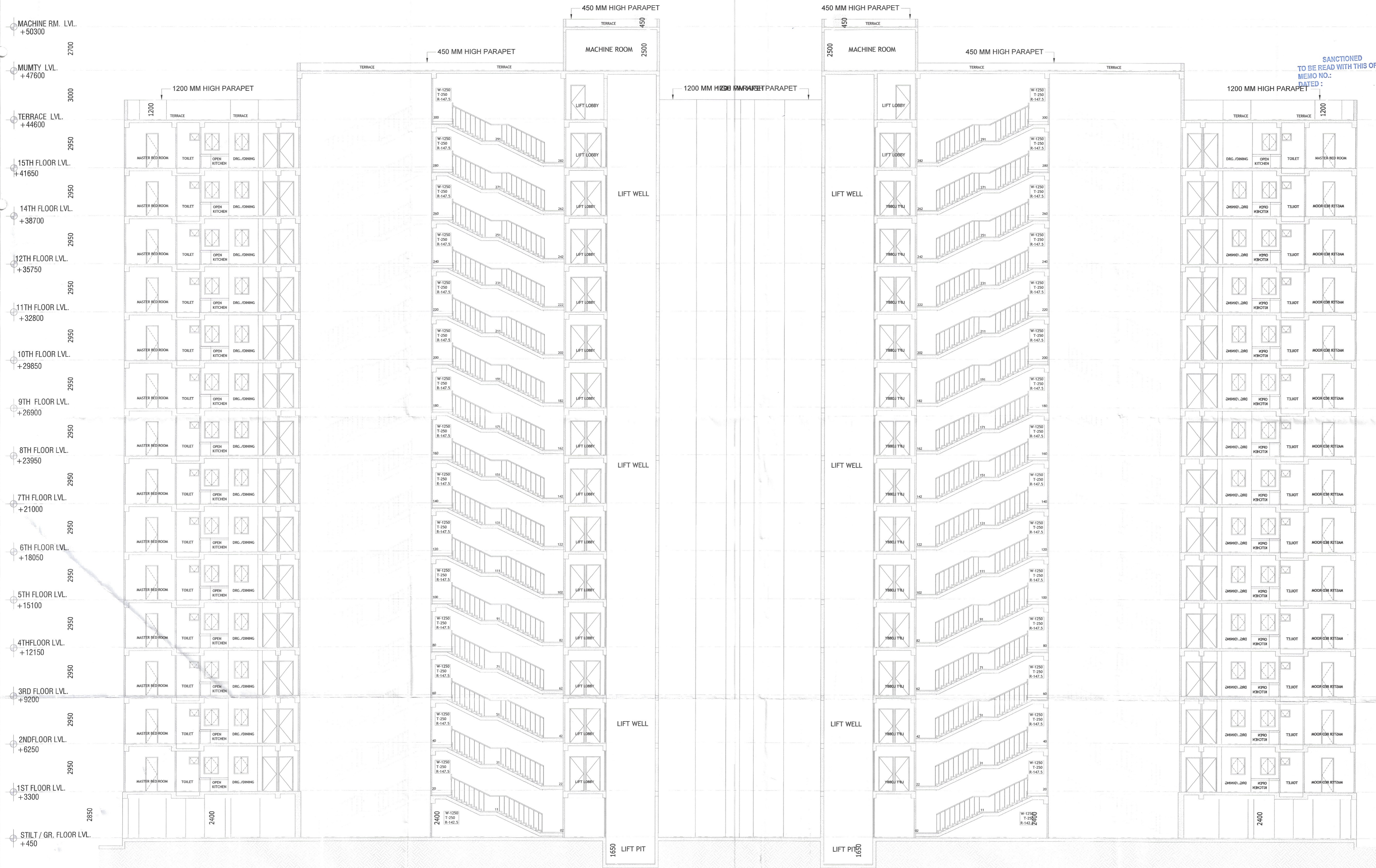

**TYPICAL BUILDING SECTION - B  
 TOWER-10&11,12 & 12A**