

NO.	DESCRIPTION	AREA	UNIT
1	TOTAL SITE AREA (25.4 ACRES)	1082445	SQ.MET
2	CONCRETE DRIVEWAY	2000	SQ.MET
3	CONCRETE DRIVEWAY	2000	SQ.MET
4	CONCRETE DRIVEWAY	2000	SQ.MET
5	CONCRETE DRIVEWAY	2000	SQ.MET
6	CONCRETE DRIVEWAY	2000	SQ.MET
7	CONCRETE DRIVEWAY	2000	SQ.MET
8	CONCRETE DRIVEWAY	2000	SQ.MET
9	CONCRETE DRIVEWAY	2000	SQ.MET
10	CONCRETE DRIVEWAY	2000	SQ.MET
11	CONCRETE DRIVEWAY	2000	SQ.MET
12	CONCRETE DRIVEWAY	2000	SQ.MET
13	CONCRETE DRIVEWAY	2000	SQ.MET
14	CONCRETE DRIVEWAY	2000	SQ.MET
15	CONCRETE DRIVEWAY	2000	SQ.MET
16	CONCRETE DRIVEWAY	2000	SQ.MET
17	CONCRETE DRIVEWAY	2000	SQ.MET
18	CONCRETE DRIVEWAY	2000	SQ.MET
19	CONCRETE DRIVEWAY	2000	SQ.MET
20	CONCRETE DRIVEWAY	2000	SQ.MET
21	CONCRETE DRIVEWAY	2000	SQ.MET
22	CONCRETE DRIVEWAY	2000	SQ.MET
23	CONCRETE DRIVEWAY	2000	SQ.MET
24	CONCRETE DRIVEWAY	2000	SQ.MET
25	CONCRETE DRIVEWAY	2000	SQ.MET
26	CONCRETE DRIVEWAY	2000	SQ.MET
27	CONCRETE DRIVEWAY	2000	SQ.MET
28	CONCRETE DRIVEWAY	2000	SQ.MET
29	CONCRETE DRIVEWAY	2000	SQ.MET
30	CONCRETE DRIVEWAY	2000	SQ.MET
31	CONCRETE DRIVEWAY	2000	SQ.MET
32	CONCRETE DRIVEWAY	2000	SQ.MET
33	CONCRETE DRIVEWAY	2000	SQ.MET
34	CONCRETE DRIVEWAY	2000	SQ.MET

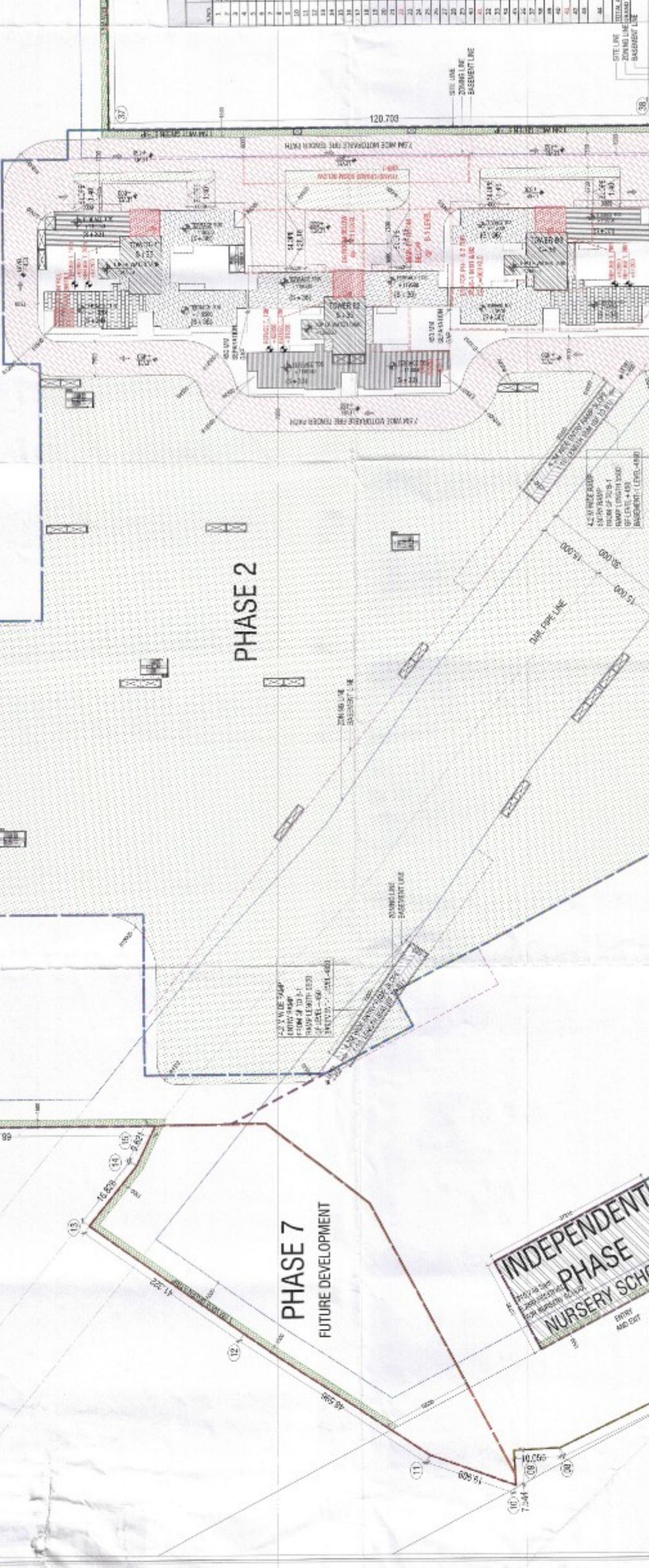

NO.	DESCRIPTION	AREA	UNIT	TOTAL AREA		TOTAL UNIT	
				NO.	UNIT	NO.	UNIT
1	PHASE 1	100000	SQ.MET	100000	SQ.MET	100000	SQ.MET
2	PHASE 2	100000	SQ.MET	100000	SQ.MET	100000	SQ.MET
3	PHASE 3	100000	SQ.MET	100000	SQ.MET	100000	SQ.MET
4	PHASE 4	100000	SQ.MET	100000	SQ.MET	100000	SQ.MET
5	PHASE 5	100000	SQ.MET	100000	SQ.MET	100000	SQ.MET
6	PHASE 6	100000	SQ.MET	100000	SQ.MET	100000	SQ.MET
7	PHASE 7	100000	SQ.MET	100000	SQ.MET	100000	SQ.MET
8	TOTAL	700000	SQ.MET	700000	SQ.MET	700000	SQ.MET



NO.	DESCRIPTION	AREA	UNIT	TOTAL AREA		TOTAL UNIT	
				NO.	UNIT	NO.	UNIT
1	PHASE 1	100000	SQ.MET	100000	SQ.MET	100000	SQ.MET
2	PHASE 2	100000	SQ.MET	100000	SQ.MET	100000	SQ.MET
3	PHASE 3	100000	SQ.MET	100000	SQ.MET	100000	SQ.MET
4	PHASE 4	100000	SQ.MET	100000	SQ.MET	100000	SQ.MET
5	PHASE 5	100000	SQ.MET	100000	SQ.MET	100000	SQ.MET
6	PHASE 6	100000	SQ.MET	100000	SQ.MET	100000	SQ.MET
7	PHASE 7	100000	SQ.MET	100000	SQ.MET	100000	SQ.MET
8	TOTAL	700000	SQ.MET	700000	SQ.MET	700000	SQ.MET



NO.	DESCRIPTION	AREA	UNIT	TOTAL AREA		TOTAL UNIT	
				NO.	UNIT	NO.	UNIT
1	PHASE 1	100000	SQ.MET	100000	SQ.MET	100000	SQ.MET
2	PHASE 2	100000	SQ.MET	100000	SQ.MET	100000	SQ.MET
3	PHASE 3	100000	SQ.MET	100000	SQ.MET	100000	SQ.MET
4	PHASE 4	100000	SQ.MET	100000	SQ.MET	100000	SQ.MET
5	PHASE 5	100000	SQ.MET	100000	SQ.MET	100000	SQ.MET
6	PHASE 6	100000	SQ.MET	100000	SQ.MET	100000	SQ.MET
7	PHASE 7	100000	SQ.MET	100000	SQ.MET	100000	SQ.MET
8	TOTAL	700000	SQ.MET	700000	SQ.MET	700000	SQ.MET

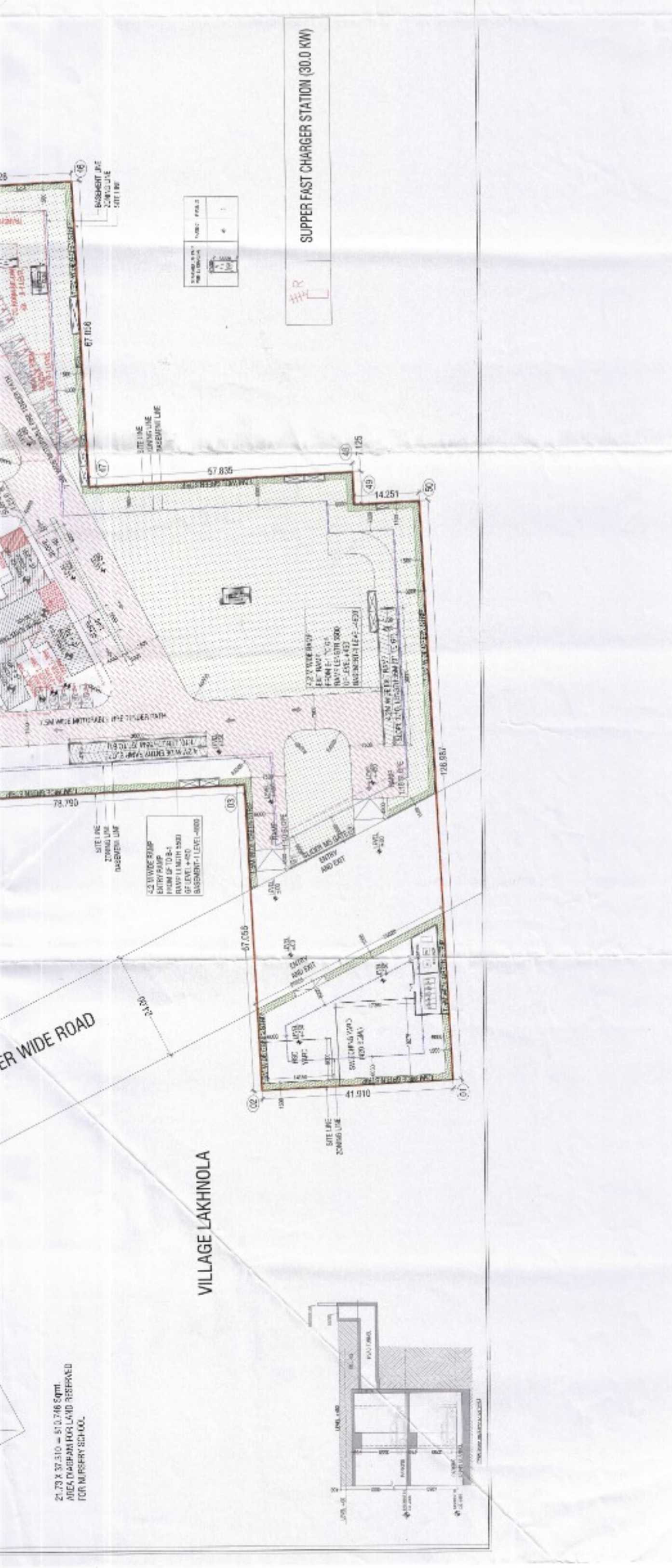

ACPL

ARCHITECTS

PROPOSED RESIDENTIAL DEVELOPMENT PHASE 1 TO PHASE 7

11/05/2020 THE APPLICANT HAS SUBMITTED THE PROPOSAL FOR THE DEVELOPMENT OF THE PROJECT AT THE ABOVE ADDRESS TO THE APPLICANT'S OFFICE FOR THE DEVELOPMENT OF THE PROJECT AT THE ABOVE ADDRESS.

TOTAL AREA: 700,000 SQ.MET

BEING DEVELOPED BY: Emaar India Ltd.

DATE: 11/05/2020

SCALE: 1:1000

SITE PLAN

PHASE 1

PHASE 2

PHASE 3

PHASE 4

PHASE 5

PHASE 6

PHASE 7

OTHERS VACANT LAND

SUPPER FAST CHARGER STATION (300 KW)

24 METER WIDE ROAD

12.0 M. WIDE CONSTRUCTED SERVICE ROAD

75.0 M. CONSTRUCTED SECTOR DIVIDING ROAD

EXISTING 60.0 M WIDE ROAD

SECTOR 85

SECTOR 86

SECTOR 87

VILLAGE LAKHNOOLA

INDEPENDENT PHASE NURSERY SCHOOL