

DOOR, WINDOW & VENTILATOR SCHEDULE

S.No.	TYPE	WIDTH	CHL	LINTEL
1	D	1.075	0	2.450
2	D1	1.000	0	2.450
3	D2	0.750	0	2.450
4	D3	0.995	0	2.450
5	DW1	1.750	0	2.450
6	W/E	1.850	0	2.450
7	W1	1.525	900	2.450
8	V/PV	0.750	1.550	2.450

AREA STATEMENT

TOTAL PLOT AREA = 8.650 M X 15.000 M	129.750	sq.mts.
PERMISSIBLE COVERED F.A.R. @ 200%	259.500	sq.mts.
TOTAL PERMISSIBLE GROUND COVERAGE @ 75%	97.313	sq.mts.
ACHIEVED F.A.R. @ 64%	83.040	sq.mts.
TOTAL FAR 264%	342.540	sq.mts.

PROPOSED F.A.R. AREA OF STILT

A	1.730	X	1.535	=	2.656	sq.mts.
B	2.195	X	4.535	=	9.954	sq.mts.
C	1.730	X	1.730	=	2.993	sq.mts.
TOTAL FAR AREA OF A+B+C				=	15.603	sq.mts.

NON F.A.R. AREA OF STILT

AA	8.650	X	11.320	=	97.918	sq.mts.
1+2+A+B+C				=	20.316	sq.mts.
TOTAL AREA FAR + NON FAR (AA - 1+2)				=	77.602	sq.mts.

PROPOSED F.A.R. ON FIRST FLOOR 8.854

AA	8.650	X	11.320	=	97.918	sq.mts.
1	2.485	X	1.565	=	3.889	sq.mts.
2	6.340	X	0.130	=	0.824	sq.mts.
3	1.850	X	4.075	=	7.539	sq.mts.
4	0.230	X	1.075	=	0.247	sq.mts.
5	1.500	X	1.075	=	1.613	sq.mts.
6	1.500	X	1.500	=	2.250	sq.mts.
TOTAL OF 1 TO 6				=	16.362	sq.mts.

PROPOSED F.A.R. ON FIRST FLOOR = 81.556 sq.mts.
PROPOSED F.A.R. ON SECOND FLOOR = 81.556 sq.mts.
PROPOSED F.A.R. ON THIRD FLOOR = 81.556 sq.mts.
PROPOSED F.A.R. ON FOURTH FLOOR = 81.556 sq.mts.

TOTAL PROPOSED F.A.R. AREA ON ALL FLOORS (STILT + FF + SF + TF + 4TH)	=	341.827	sq.mts.
--	----------	----------------	----------------

NON F.A.R. AREA OF MUMTY

A	1.730	X	1.535	=	2.656	sq.mts.
B	2.195	X	4.535	=	9.954	sq.mts.
C	1.730	X	1.730	=	2.993	sq.mts.
TOTAL AREA (A+B+C)				=	15.603	sq.mts.

FLOORS	FAR AREA	+	NON FAR AREA	TOTAL	sq.mts.
STILT AREA	15.603	+	77.602	=	93.205
FIRST FLOOR	81.556	+	3+4+5+6	=	93.205
SECOND FLOOR	81.556	+	3+4+5+6	=	93.205
THIRD FLOOR	81.556	+	3+4+5+6	=	93.205
FOURTH FLOOR	81.556	+	3+4+5+6	=	93.205
MUMTY AREA =			15.603	=	15.603
TOTAL ALL FLOOR AREA (FAR AREA + NON FAR AREA)				=	481.628

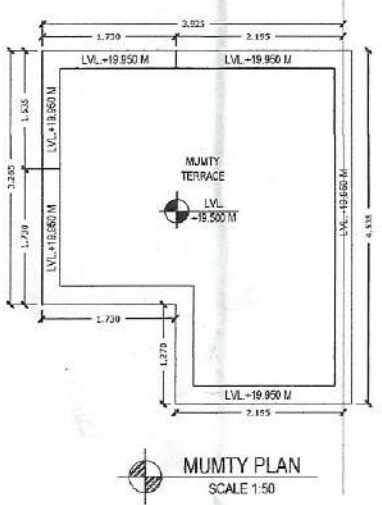

ELEVATION



SECTION

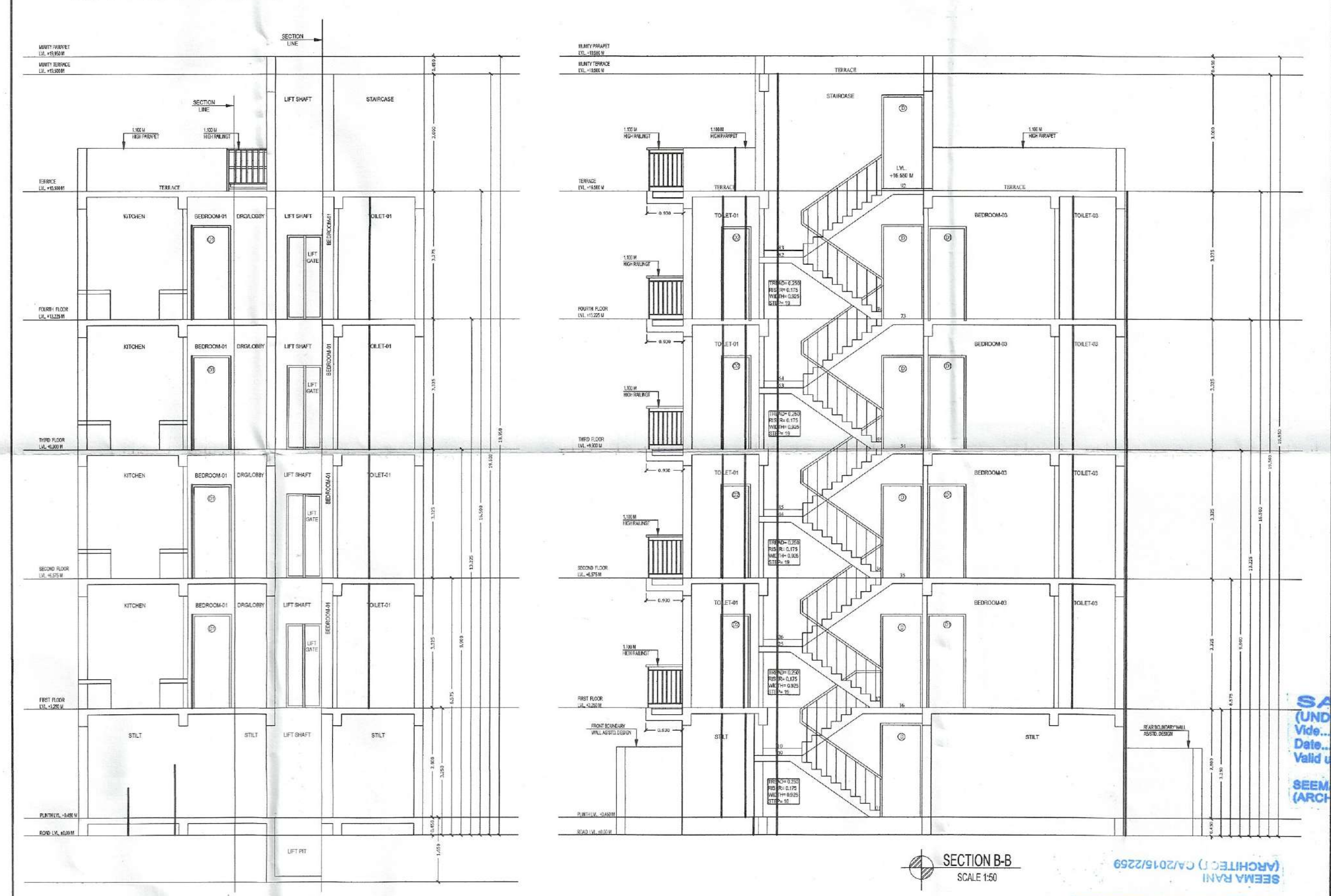

SANCTIONED
 (UNDER SELF CERTIFICATION)
 Date: 12.09.2023
 Valid upto: 12.09.2025
SEEMA RANI
 (ARCHITECT) CA/2015/2259

OWNER NAME:- LION INFRADEVELOPERS LLP
 PLOT NO- A-24
 at Sector 06, Sohna, Haryana
PROJECT NAME:- RESIDENTIAL PLOTTED COLONY UNDER DJJAY MERASURING
 12.505 ACRES (LICENCE NO. 188 OF 2023 DATED 15.09.2023) IN SECTOR-06, SOHNA
 BEING DEVELOPED BY LION INFRADEVELOPERS LLP.

STILT FLOOR PLAN, FIRST FLOOR PLAN, SECOND FLOOR PLAN, THIRD FLOOR PLAN,
 FOURTH FLOOR PLAN, TERRACE PLAN, MUMTY PLAN, D/W SCHEDULE, AREA CHART,
 ELEVATION & SECTION
 Dwg. No.- AR/PLOT NO-A-24/SHEET 01 OF 01 Scale 1:50
 ARCHITECT'S SIGN: **SEEMA RANI**
 Signature of Architect
SEEMA RANI
 CA/2015/2259
 OWNER'S SIGN: **LION INFRADEVELOPERS LLP**
 AUTHORIZED SIGNATORY
 Drawn by:- PANKAJ KAPOOR Mob. No. - 8800093157