

01 STILT FLOOR PLAN (TOWER A2-A6)  
Scale: 1:200



03 STILT FAR DIAGRAM (TOWER A2-A6)  
Scale: 1:200

STILT FLOOR FAR CALCULATION OF TOWER (A2-A6)									
S.No.	NAME	SHAPE	LENGTH (L)	WIDTH (B)	HEIGHT (H)	FORMULA	AREA	QUANTITY	TOTAL AREA
1	A	Rectangle	7.650	7.550	-	L X B	57.758	1	57.758
									<b>TOTAL AREA</b>
									<b>57.758</b>
									<b>SQM.</b>

TYPICAL FLOOR NON-F.A.R. CALCULATION OF TOWER (A2-A6)									
S.No.	NAME	SHAPE	LENGTH (L)	WIDTH (B)	HEIGHT (H)	FORMULA	AREA	QUANTITY	TOTAL AREA
1	2	Rectangle	2.600	4.950	-	L X B	12.870	1	12.870
2	4	Rectangle	2.500	1.760	-	L X B	4.400	2	8.800
3	5	Rectangle	1.685	1.430	-	L X B	2.410	2	4.820
									<b>TOTAL NON-F.A.R. ON TYPICAL FLOOR OF TOWER A2-A6</b>
									<b>24.080</b>



02 GROUND COVER DIAGRAM (TOWER A2-A6)  
Scale: 1:200

GROUND COVER CALCULATION OF TOWER (A2-A6)									
1. ADDITION - XX									
S.No.	NAME	SHAPE	LENGTH (L)	WIDTH (B)	HEIGHT (H)	FORMULA	AREA	QUANTITY	TOTAL AREA
1	A	Rectangle	27.590	36.900	-	L X B	1018.071	1	1018.071
									<b>1. TOTAL ADDITION</b>
									<b>1018.071</b>
2. DEDUCTION - YY									
1	8	Rectangle	3.150	1.705	-	L X B	5.371	4	21.483
2	9	Rectangle	5.915	7.555	-	L X B	44.688	4	178.751
3	10	Rectangle	8.350	3.000	-	L X B	25.050	4	100.200
4	11	Rectangle	1.250	0.990	-	L X B	1.238	4	4.950
5	12	Rectangle	3.730	3.140	-	L X B	11.901	4	47.602
6	13	Rectangle	1.520	7.230	-	L X B	10.960	2	21.920
7	14	Rectangle	2.840	1.090	-	L X B	3.096	2	6.191
8	15	Rectangle	3.280	1.470	-	L X B	4.822	2	9.643
9	16	Rectangle	5.610	1.580	-	L X B	8.864	2	17.728
10	17	Rectangle	0.050	0.950	-	L X B	0.048	2	0.095
11	18	Rectangle	3.000	6.735	-	L X B	20.205	2	40.410
									<b>2. TOTAL DEDUCTION</b>
									<b>449.033</b>
<b>GROUND COVER OF TOWER (A2-A6)</b>							<b>ADDITION (XX) - DEDUCTION (YY)</b>	<b>SQM.</b>	
							<b>569.038</b>	<b>SQM.</b>	

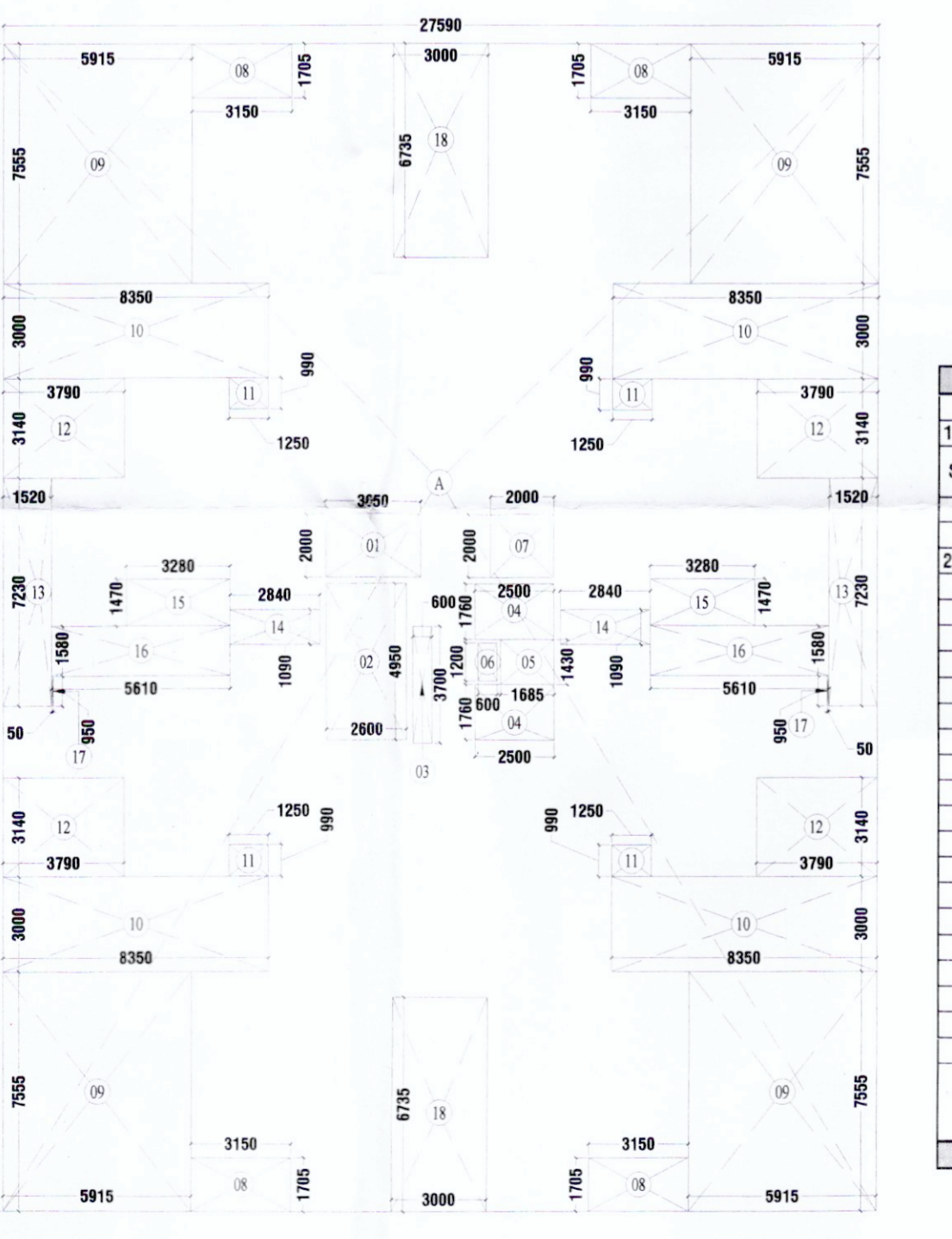

05 TYPICAL FLOOR FAR DIAGRAM (TOWER A2-A6)  
Scale: 1:200

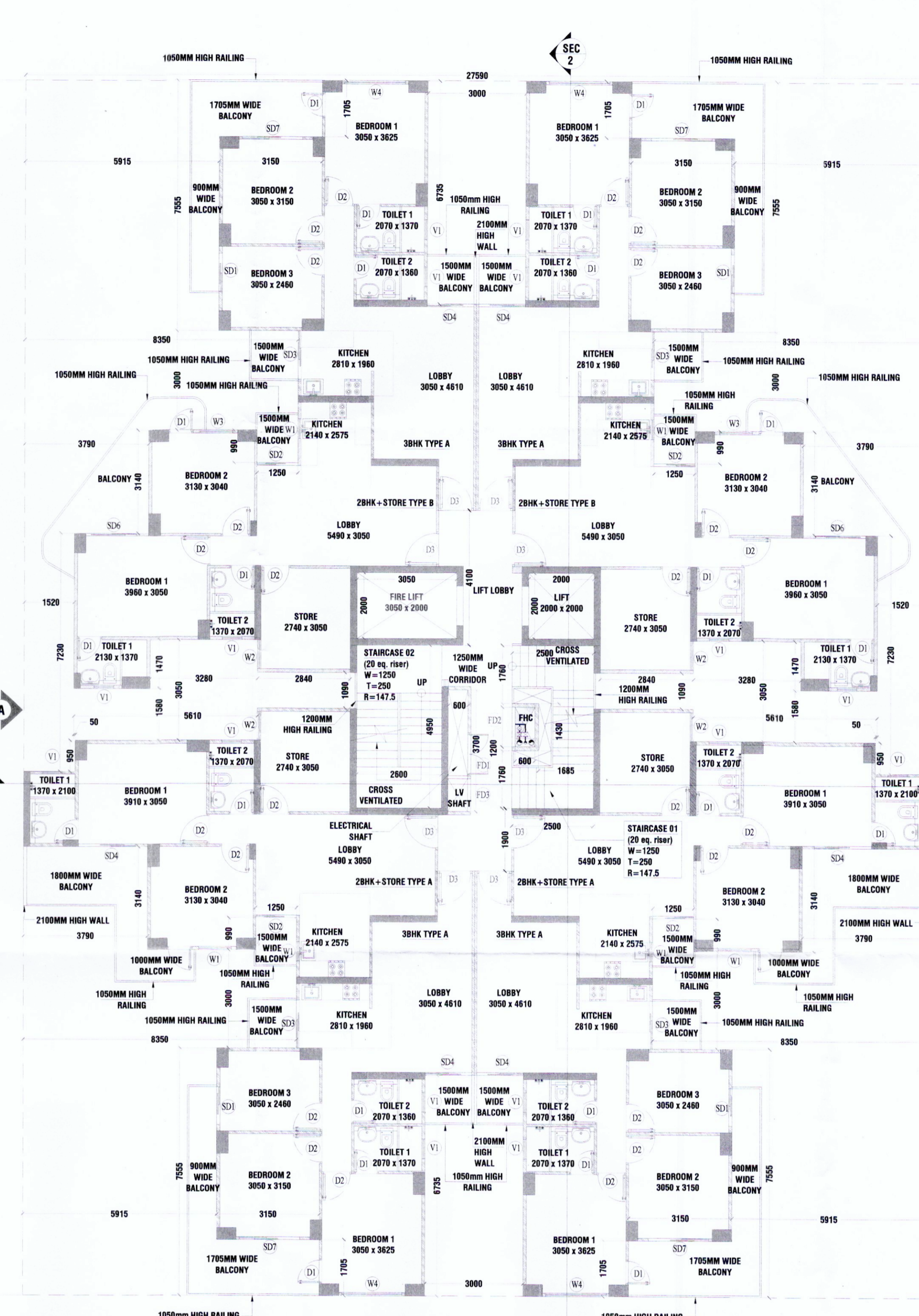

04 TYPICAL FLOOR PLAN (TOWER A2-A6) 2nd to 19th Floor  
Scale: 1:300

TYPICAL FLOOR F.A.R. CALCULATION OF TOWER (A2-A6)									
1. ADDITION - XX									
S.No.	NAME	SHAPE	LENGTH (L)	WIDTH (B)	HEIGHT (H)	FORMULA	AREA	QUANTITY	TOTAL AREA
1	A	Rectangle	27.590	36.900	-	L X B	1018.071	1	1018.071
									<b>1. TOTAL ADDITION</b>
									<b>1018.071</b>
2. DEDUCTION - YY									
1	1	Rectangle	3.650	2.000	-	L X B	7.300	1	7.300
2	2	Rectangle	2.600	4.950	-	L X B	12.870	1	12.870
3	3	Rectangle	0.600	3.700	-	L X B	2.220	1	2.220
4	4	Rectangle	2.500	1.760	-	L X B	4.400	2	8.800
5	5	Rectangle	1.685	1.430	-	L X B	2.410	1	2.410
6	6	Rectangle	0.600	1.200	-	L X B	0.720	1	0.720
7	7	Rectangle	2.000	2.000	-	L X B	4.000	1	4.000
8	8	Rectangle	3.150	1.705	-	L X B	5.371	4	21.483
9	9	Rectangle	5.915	7.555	-	L X B	44.688	4	178.751
10	10	Rectangle	8.350	3.000	-	L X B	25.050	4	100.200
11	11	Rectangle	1.250	0.990	-	L X B	1.238	4	4.950
12	12	Rectangle	3.730	3.140	-	L X B	11.901	4	47.602
13	13	Rectangle	1.520	7.230	-	L X B	10.960	2	21.920
14	14	Rectangle	2.840	1.090	-	L X B	3.096	2	6.191
15	15	Rectangle	3.280	1.470	-	L X B	4.822	2	9.643
16	16	Rectangle	5.610	1.580	-	L X B	8.864	2	17.728
17	17	Rectangle	0.050	0.950	-	L X B	0.048	2	0.095
18	18	Rectangle	3.000	6.735	-	L X B	20.205	2	40.410
									<b>2. TOTAL DEDUCTION</b>
									<b>486.152</b>
<b>TOTAL F.A.R. ON TYPICAL FLOOR OF TOWER (A2-A6)</b>							<b>ADDITION (XX) - DEDUCTION (YY)</b>	<b>SQM.</b>	
							<b>531.919</b>	<b>SQM.</b>	

AREA SUMMARY - (TOWER A2-A6)		
A	Ground Coverage	901.013 SQM.
B	Stilt Floor FAR	57.758 SQM.
C	Typical Floor FAR	531.919 SQM.
D	No. of Typical Floors (A2-A6)	19
E	Total FAR of Tower A2-A6 (E = B + (C * D))	10164.210 SQM.
F	No. of 2BHK + Store Type A Units	15.688
G	No. of 3BHK Type A Units	4
H	No. of 3BHK Type A1 (Balcony Area)	50.431
I	No. of 3BHK Type A1 Units	4
J	No. of 2BHK + Store Type A (Balcony Area)	12.538
K	No. of 2BHK + Store Type A1 Units	2
L	No. of 2BHK + Store Type A1 (Balcony Area)	35.175
M	No. of 2BHK + Store Type A1 Units	2
N	No. of 2BHK + Store Type B (Balcony Area)	11.284
O	No. of 2BHK + Store Type B Units	2
P	No. of 2BHK + Store Type B1 (Balcony Area)	34.551
Q	No. of 2BHK + Store Type B1 Units	2
R	Non-FAR (Balcony) in One Typical Floor (18 Floors) (R = (F * G) + (J * K) + (N * D))	110.393
S	Non-FAR (Balcony) in First Floor (S = (H * I) + (L * M) + (P * D))	341.177
T	Non-FAR (Balcony) in One Tower (T = (R * H) + S)	2328.244
U	Non-FAR (Common Area) of One Typical Floor	24.080
V	Non-FAR (Common Area) of One Tower (U * 19)	457.511
W	Stilt Floor Non-FAR (W = A - B)	842.255
X	Total Non-FAR in Tower A1 (Stilt, First, Typical Floor Balcony & Core) (P = (T + V + W))	3629.011
Y	Mummy Built-up Area	57.758
Z	Overhead Tank Built-up Area	57.758
Z1	Total Built-up Area in One Tower (Z1 = E + X + Y + Z)	13908.736

DOOR WINDOW SCHEDULE - TOWER A1-A6					
S.No.	Type	Opening Size	CR Level	Level Level	Description
01	D1	750x2250	00	2250	Door
02	D2	900x2250	00	2250	Door
03	D3	1050x2250	00	2250	Door
04	D4	1200x2250	00	2250	Door
05	D5	1350x2250	00	2250	Door
06	D6	1500x2250	00	2250	Door
07	D7	1650x2250	00	2250	Door
08	D8	1800x2250	00	2250	Door
09	D9	1950x2250	00	2250	Door
10	D10	2100x2250	00	2250	Door
11	D11	2250x2250	00	2250	Door
12	D12	2400x2250	00	2250	Door
13	D13	2550x2250	00	2250	Door
14	D14	2700x2250	00	2250	Door
15	D15	2850x2250	00	2250	Door
16	D16	3000x2250	00	2250	Door
17	D17	3150x2250	00	2250	Door
18	D18	3300x2250	00	2250	Door
19	D19	3450x2250	00	2250	Door
20	D20	3600x2250	00	2250	Door
21	D21	3750x2250	00	2250	Door
22	D22	3900x2250	00	2250	Door
23	D23	4050x2250	00	2250	Door
24	D24	4200x2250	00	2250	Door

**PRINCIPAL ARCHITECT:**

**DESIGN FORUM INTERNATIONAL**

K-47, KAILASH COLONY, NEW DELHI-110048  
PHONE NO.: 011-46556600

**OWNER'S SIGNATURE**      **ARCHITECT'S SIGNATURE**

**CLIENT:** **M/S Blossom Pvt. Ltd.**

**PROJECT:** **HOUSING COLONY PLANS OF AFFORDABLE GROUP HOUSING COLONY MEASURING 6.675 ACRES (LICENSE NO.09 OF 2022 DATED 31-01-2022) BEING DEVELOPED IN VILLAGE BHARSARU, SECTOR 88-B, GURUGRAM BY M/S BLOSSOM PROPERTIES PVT. LTD. AND OTHER LAND OWNERS IN COLLABORATION WITH M/S MAHIRA HOMES PVT. LTD.**

**DRAWING TITLE:** **Tower - A2-A6: Floor Plans, Area Diagrams & Area Chart**

**SHEET NO.** **07**

SCALE: 1:100  
DATE: 24.02.2022