

Note :-
1. BUILDING WILL BE DESIGNED (STRUCTURES)
AS PER RELEVANT IS CODES FOR EARTH QUAKE
RESISTANCE.

PROJECT
REVISED BUILDING PLANS OF COMMERCIAL
OFFICE BUILDING WITH A TOTAL COVERAGE
AREA OF 10.2007 AND 6.98025 ACRES
(LICENCE NO. 239 OF 2007 DATED 25.10.2007, LICENCE
NO. 241 OF 2007 DATED 25.10.2007 & LICENCE NO. 242
OF 2007 DATED 25.10.2007) IN THE
SECTOR-62, GURUGRAM MANESAR URBAN COMPLEX
BEING DEVELOPED BY PIONEER URBAN LAND &
INFRASTRUCTURE LTD.

CLIENT
PIONEER URBAN LAND & INFRASTRUCTURE LTD.
Pioneer Urban
Ground Floor
Near GOLF Course Extension Road,
Sector-62, 122001 Gurugram

DESIGN ARCHITECT
RSP
RSP Design consultants
(India) Pvt. Ltd.
103, First Floor, Beetha Business Tower, Sector-46, Sohna Road
Gurgaon-122016, India TEL: 4709886 FAX: 4708880
REG. NO. RA/2007/1063, DELHI/REG-590 (01)
TEL: 26599881 FAX: 26599882
EMAIL: rsp@rspindia.net ; www.rspindia.net

ASSOCIATE ARCHITECT
RISIMIS
ARCHITECTS
RISIMS ARCHITECTS PVT. LTD.
69, Nara Niwas Bhowani Kunj
(Behind D2), Vasant Kunj
New Delhi-110070.
Tel:-011-26898616, 26898617
www.risims-arch.com

Scale: 1:200
Drawing Title: BASEMENT OF AREA CALCULATION
JUNE-2024
Drawing No: BS-08
28032024-3

ARCHITECT'S SEAL & SIGNATURE
OWNER'S SEAL & SIGNATURE

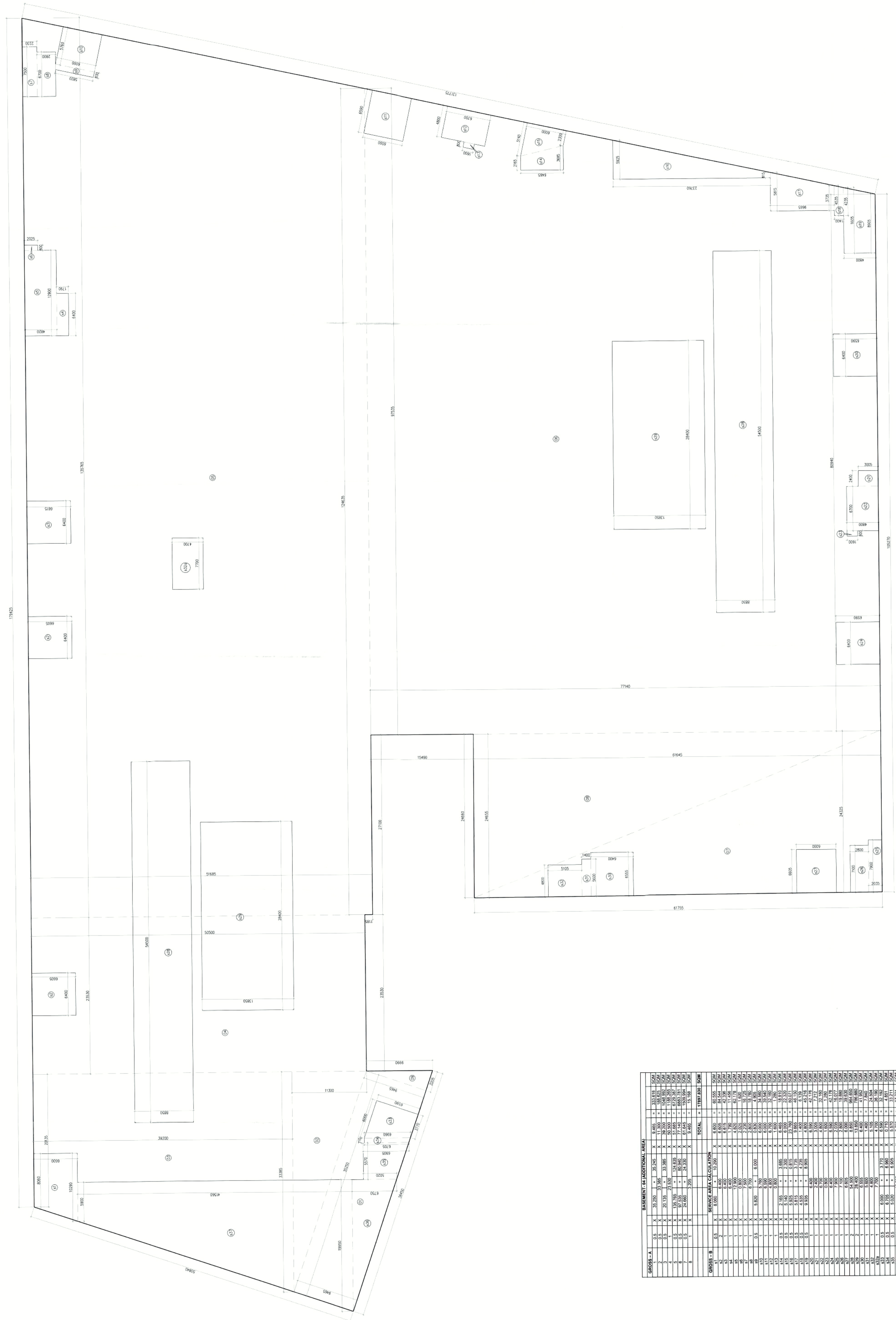

BASEMENT-4 (ADDITIONAL AREA)	
GRSSE - A	1. 0.5 X 31.250 = 15.625
	2. 0.5 X 31.250 = 15.625
	3. 0.5 X 31.250 = 15.625
	4. 0.5 X 31.250 = 15.625
	5. 0.5 X 31.250 = 15.625
	6. 0.5 X 31.250 = 15.625
	7. 0.5 X 31.250 = 15.625
	8. 0.5 X 31.250 = 15.625
	9. 0.5 X 31.250 = 15.625
	10. 0.5 X 31.250 = 15.625
	11. 0.5 X 31.250 = 15.625
	12. 0.5 X 31.250 = 15.625
	13. 0.5 X 31.250 = 15.625
	14. 0.5 X 31.250 = 15.625
	15. 0.5 X 31.250 = 15.625
	16. 0.5 X 31.250 = 15.625
	17. 0.5 X 31.250 = 15.625
	18. 0.5 X 31.250 = 15.625
	19. 0.5 X 31.250 = 15.625
	20. 0.5 X 31.250 = 15.625
	21. 0.5 X 31.250 = 15.625
	22. 0.5 X 31.250 = 15.625
	23. 0.5 X 31.250 = 15.625
	24. 0.5 X 31.250 = 15.625
	25. 0.5 X 31.250 = 15.625
	26. 0.5 X 31.250 = 15.625
	27. 0.5 X 31.250 = 15.625
	28. 0.5 X 31.250 = 15.625
	29. 0.5 X 31.250 = 15.625
	30. 0.5 X 31.250 = 15.625
	31. 0.5 X 31.250 = 15.625
	32. 0.5 X 31.250 = 15.625
	33. 0.5 X 31.250 = 15.625
	34. 0.5 X 31.250 = 15.625
	35. 0.5 X 31.250 = 15.625
	36. 0.5 X 31.250 = 15.625
	37. 0.5 X 31.250 = 15.625
	38. 0.5 X 31.250 = 15.625
	39. 0.5 X 31.250 = 15.625
	40. 0.5 X 31.250 = 15.625
	41. 0.5 X 31.250 = 15.625
	42. 0.5 X 31.250 = 15.625
	43. 0.5 X 31.250 = 15.625
	44. 0.5 X 31.250 = 15.625
	45. 0.5 X 31.250 = 15.625
	46. 0.5 X 31.250 = 15.625
	47. 0.5 X 31.250 = 15.625
	48. 0.5 X 31.250 = 15.625
	49. 0.5 X 31.250 = 15.625
	50. 0.5 X 31.250 = 15.625
	51. 0.5 X 31.250 = 15.625
	52. 0.5 X 31.250 = 15.625
	53. 0.5 X 31.250 = 15.625
	54. 0.5 X 31.250 = 15.625
	55. 0.5 X 31.250 = 15.625
	56. 0.5 X 31.250 = 15.625
	57. 0.5 X 31.250 = 15.625
	58. 0.5 X 31.250 = 15.625
	59. 0.5 X 31.250 = 15.625
	60. 0.5 X 31.250 = 15.625
	61. 0.5 X 31.250 = 15.625
	62. 0.5 X 31.250 = 15.625
	63. 0.5 X 31.250 = 15.625
	64. 0.5 X 31.250 = 15.625
	65. 0.5 X 31.250 = 15.625
	66. 0.5 X 31.250 = 15.625
	67. 0.5 X 31.250 = 15.625
	68. 0.5 X 31.250 = 15.625
	69. 0.5 X 31.250 = 15.625
	70. 0.5 X 31.250 = 15.625
	71. 0.5 X 31.250 = 15.625
	72. 0.5 X 31.250 = 15.625
	73. 0.5 X 31.250 = 15.625
	74. 0.5 X 31.250 = 15.625
	75. 0.5 X 31.250 = 15.625
	76. 0.5 X 31.250 = 15.625
	77. 0.5 X 31.250 = 15.625
	78. 0.5 X 31.250 = 15.625
	79. 0.5 X 31.250 = 15.625
	80. 0.5 X 31.250 = 15.625
	81. 0.5 X 31.250 = 15.625
	82. 0.5 X 31.250 = 15.625
	83. 0.5 X 31.250 = 15.625
	84. 0.5 X 31.250 = 15.625
	85. 0.5 X 31.250 = 15.625
	86. 0.5 X 31.250 = 15.625
	87. 0.5 X 31.250 = 15.625
	88. 0.5 X 31.250 = 15.625
	89. 0.5 X 31.250 = 15.625
	90. 0.5 X 31.250 = 15.625
	91. 0.5 X 31.250 = 15.625
	92. 0.5 X 31.250 = 15.625
	93. 0.5 X 31.250 = 15.625
	94. 0.5 X 31.250 = 15.625
	95. 0.5 X 31.250 = 15.625
	96. 0.5 X 31.250 = 15.625
	97. 0.5 X 31.250 = 15.625
	98. 0.5 X 31.250 = 15.625
	99. 0.5 X 31.250 = 15.625
	100. 0.5 X 31.250 = 15.625
	TOTAL = 1587.830 SQM

AREA OF BASEMENT-04	
GRSSE-1	1787.830 SQM
GRSSE-2	1787.830 SQM
GRSSE-3	1787.830 SQM
GRSSE-4	1787.830 SQM
GRSSE-5	1787.830 SQM
GRSSE-6	1787.830 SQM
GRSSE-7	1787.830 SQM
GRSSE-8	1787.830 SQM
GRSSE-9	1787.830 SQM
GRSSE-10	1787.830 SQM
GRSSE-11	1787.830 SQM
GRSSE-12	1787.830 SQM
GRSSE-13	1787.830 SQM
GRSSE-14	1787.830 SQM
GRSSE-15	1787.830 SQM
GRSSE-16	1787.830 SQM
GRSSE-17	1787.830 SQM
GRSSE-18	1787.830 SQM
GRSSE-19	1787.830 SQM
GRSSE-20	1787.830 SQM
GRSSE-21	1787.830 SQM
GRSSE-22	1787.830 SQM
GRSSE-23	1787.830 SQM
GRSSE-24	1787.830 SQM
GRSSE-25	1787.830 SQM
GRSSE-26	1787.830 SQM
GRSSE-27	1787.830 SQM
GRSSE-28	1787.830 SQM
GRSSE-29	1787.830 SQM
GRSSE-30	1787.830 SQM
GRSSE-31	1787.830 SQM
GRSSE-32	1787.830 SQM
GRSSE-33	1787.830 SQM
GRSSE-34	1787.830 SQM
GRSSE-35	1787.830 SQM
GRSSE-36	1787.830 SQM
GRSSE-37	1787.830 SQM
GRSSE-38	1787.830 SQM
GRSSE-39	1787.830 SQM
GRSSE-40	1787.830 SQM
GRSSE-41	1787.830 SQM
GRSSE-42	1787.830 SQM
GRSSE-43	1787.830 SQM
GRSSE-44	1787.830 SQM
GRSSE-45	1787.830 SQM
GRSSE-46	1787.830 SQM
GRSSE-47	1787.830 SQM
GRSSE-48	1787.830 SQM
GRSSE-49	1787.830 SQM
GRSSE-50	1787.830 SQM
GRSSE-51	1787.830 SQM
GRSSE-52	1787.830 SQM
GRSSE-53	1787.830 SQM
GRSSE-54	1787.830 SQM
GRSSE-55	1787.830 SQM
GRSSE-56	1787.830 SQM
GRSSE-57	1787.830 SQM
GRSSE-58	1787.830 SQM
GRSSE-59	1787.830 SQM
GRSSE-60	1787.830 SQM
GRSSE-61	1787.830 SQM
GRSSE-62	1787.830 SQM
GRSSE-63	1787.830 SQM
GRSSE-64	1787.830 SQM
GRSSE-65	1787.830 SQM
GRSSE-66	1787.830 SQM
GRSSE-67	1787.830 SQM
GRSSE-68	1787.830 SQM
GRSSE-69	1787.830 SQM
GRSSE-70	1787.830 SQM
GRSSE-71	1787.830 SQM
GRSSE-72	1787.830 SQM
GRSSE-73	1787.830 SQM
GRSSE-74	1787.830 SQM
GRSSE-75	1787.830 SQM
GRSSE-76	1787.830 SQM
GRSSE-77	1787.830 SQM
GRSSE-78	1787.830 SQM
GRSSE-79	1787.830 SQM
GRSSE-80	1787.830 SQM
GRSSE-81	1787.830 SQM
GRSSE-82	1787.830 SQM
GRSSE-83	1787.830 SQM
GRSSE-84	1787.830 SQM
GRSSE-85	1787.830 SQM
GRSSE-86	1787.830 SQM
GRSSE-87	1787.830 SQM
GRSSE-88	1787.830 SQM
GRSSE-89	1787.830 SQM
GRSSE-90	1787.830 SQM
GRSSE-91	1787.830 SQM
GRSSE-92	1787.830 SQM
GRSSE-93	1787.830 SQM
GRSSE-94	1787.830 SQM
GRSSE-95	1787.830 SQM
GRSSE-96	1787.830 SQM
GRSSE-97	1787.830 SQM
GRSSE-98	1787.830 SQM
GRSSE-99	1787.830 SQM
GRSSE-100	1787.830 SQM
TOTAL	1787.830 SQM

NET PARKING AREA OF BASEMENT-04	
GRSSE-1	1787.830 SQM
GRSSE-2	1787.830 SQM
GRSSE-3	1787.830 SQM
GRSSE-4	1787.830 SQM
GRSSE-5	1787.830 SQM
GRSSE-6	1787.830 SQM
GRSSE-7	1787.830 SQM
GRSSE-8	1787.830 SQM
GRSSE-9	1787.830 SQM
GRSSE-10	1787.830 SQM
GRSSE-11	1787.830 SQM
GRSSE-12	1787.830 SQM
GRSSE-13	1787.830 SQM
GRSSE-14	1787.830 SQM
GRSSE-15	1787.830 SQM
GRSSE-16	1787.830 SQM
GRSSE-17	1787.830 SQM
GRSSE-18	1787.830 SQM
GRSSE-19	1787.830 SQM
GRSSE-20	1787.830 SQM
GRSSE-21	1787.830 SQM
GRSSE-22	1787.830 SQM
GRSSE-23	1787.830 SQM
GRSSE-24	1787.830 SQM
GRSSE-25	1787.830 SQM
GRSSE-26	1787.830 SQM
GRSSE-27	1787.830 SQM
GRSSE-28	1787.830 SQM
GRSSE-29	1787.830 SQM
GRSSE-30	1787.830 SQM
GRSSE-31	1787.830 SQM
GRSSE-32	1787.830 SQM
GRSSE-33	1787.830 SQM
GRSSE-34	1787.830 SQM
GRSSE-35	1787.830 SQM
GRSSE-36	1787.830 SQM
GRSSE-37	1787.830 SQM
GRSSE-38	1787.830 SQM
GRSSE-39	1787.830 SQM
GRSSE-40	1787.830 SQM
GRSSE-41	1787.830 SQM
GRSSE-42	1787.830 SQM
GRSSE-43	1787.830 SQM
GRSSE-44	1787.830 SQM
GRSSE-45	1787.830 SQM
GRSSE-46	1787.830 SQM
GRSSE-47	1787.830 SQM
GRSSE-48	1787.830 SQM
GRSSE-49	1787.830 SQM
GRSSE-50	1787.830 SQM
GRSSE-51	1787.830 SQM
GRSSE-52	1787.830 SQM
GRSSE-53	1787.830 SQM
GRSSE-54	1787.830 SQM
GRSSE-55	1787.830 SQM
GRSSE-56	1787.830 SQM
GRSSE-57	1787.830 SQM
GRSSE-58	1787.830 SQM
GRSSE-59	1787.830 SQM
GRSSE-60	1787.830 SQM
GRSSE-61	1787.830 SQM
GRSSE-62	1787.830 SQM
GRSSE-63	1787.830 SQM
GRSSE-64	1787.830 SQM
GRSSE-65	1787.830 SQM
GRSSE-66	1787.830 SQM
GRSSE-67	1787.830 SQM
GRSSE-68	1787.830 SQM
GRSSE-69	1787.830 SQM
GRSSE-70	1787.830 SQM
GRSSE-71	1787.830 SQM
GRSSE-72	1787.830 SQM
GRSSE-73	1787.830 SQM
GRSSE-74	1787.830 SQM
GRSSE-75	1787.830 SQM
GRSSE-76	1787.830 SQM
GRSSE-77	1787.830 SQM
GRSSE-78	1787.830 SQM
GRSSE-79	1787.830 SQM
GRSSE-80	1787.830 SQM
GRSSE-81	1787.830 SQM
GRSSE-82	1787.830 SQM
GRSSE-83	1787.830 SQM
GRSSE-84	1787.830 SQM
GRSSE-85	1787.830 SQM
GRSSE-86	1787.830 SQM
GRSSE-87	1787.830 SQM
GRSSE-88	1787.830 SQM
GRSSE-89	1787.830 SQM
GRSSE-90	1787.830 SQM
GRSSE-91	1787.830 SQM
GRSSE-92	1787.830 SQM
GRSSE-	