

**DOOR, WINDOW & VENTILATOR SCHEDULE**

S.No.	TYPE	WIDTH	CILL	LINTEL
1	D	1.075	0	2.450
2	D1	1.000	0	2.450
3	D2	0.750	0	2.450
4	D3	0.995	0	2.450
5	DW1	1.750	0	2.450
6	W/EF	1.850	0	2.450
7	W1	1.525	900	2.450
8	V/PV	0.750	1.550	2.450

**AREA STATEMENT**

TOTAL PLOT AREA = 8.650 M X 15.000 M	129.750	sq.mts.	
ERMISSIBLE COVERED F.A.R. @ 200%	259.500	sq.mts.	
TOTAL PERMISSIBLE GROUND COVERAGE @ 75%	97.313	sq.mts.	
ACHIVED F.A.R. @ 64%	83.040	sq.mts.	
<b>TOTAL FAR 264%</b>	<b>342.840</b>	<b>sq.mts.</b>	
<b>PROPOSED F.A.R. AREA OF STILT</b>			
A	1.730 X 1.535	= 2.656 sq.mts.	
B	2.195 X 4.535	= 9.954 sq.mts.	
C	1.730 X 1.730	= 2.993 sq.mts.	
<b>TOTAL FAR AREA OF A+B+C</b>	<b>15.603</b>	<b>sq.mts.</b>	
<b>NON F.A.R. AREA OF STILT</b>			
AA	8.650 X 11.320	= 97.918 sq.mts.	
<b>1+2+A+B+C</b>	<b>20.316</b>	<b>sq.mts.</b>	
<b>TOTAL AREA FAR + NON FAR (AA - 1+2)</b>	<b>77.602</b>	<b>sq.mts.</b>	
<b>PROPOSED F.A.R. ON FIRST FLOOR 854</b>			
AA	8.650 X 11.320	= 97.918 sq.mts.	
or	97.918 LESS 16.362	= 81.556 sq.mts.	
1	2.485 X 1.865	= 4.635 sq.mts.	
2	6.340 X 0.130	= 0.824 sq.mts.	
3	1.850 X 4.075	= 7.539 sq.mts.	
4	0.230 X 1.075	= 0.247 sq.mts.	
5	1.800 X 1.075	= 1.935 sq.mts.	
6	1.500 X 2.250	= 3.375 sq.mts.	
<b>TOTAL OF 1 TO 6</b>	<b>16.362</b>	<b>sq.mts.</b>	
<b>PROPOSED F.A.R. ON FIRST FLOOR</b>			
<b>PROPOSED F.A.R. ON SECOND FLOOR</b>	<b>81.556</b>	<b>sq.mts.</b>	
<b>PROPOSED F.A.R. ON THIRD FLOOR</b>	<b>81.556</b>	<b>sq.mts.</b>	
<b>PROPOSED F.A.R. ON FOURTH FLOOR</b>	<b>81.556</b>	<b>sq.mts.</b>	
<b>TOTAL PROPOSED F.A.R. AREA ON ALL FLOORS (STILT + FF + SF + TF + 4TH)</b>	<b>341.827</b>	<b>sq.mts.</b>	
<b>NON F.A.R. AREA OF MUMTY</b>			
A	1.730 X 1.535	= 2.656 sq.mts.	
B	2.195 X 4.535	= 9.954 sq.mts.	
C	1.730 X 1.730	= 2.993 sq.mts.	
<b>TOTAL AREA (A+B+C)</b>	<b>15.603</b>	<b>sq.mts.</b>	
<b>FLOORS FAR AREA + NON FAR AREA</b>			
FLOORS	FAR AREA	+ NON FAR AREA	TOTAL SQ.MTS.
STILT AREA	15.603	+ 77.602	= 93.205 sq.mts.
FIRST FLOOR	81.556	+ 11.849	= 93.405 sq.mts.
SECOND FLOOR	81.556	+ 11.849	= 93.405 sq.mts.
THIRD FLOOR	81.556	+ 11.849	= 93.405 sq.mts.
FOURTH FLOOR	81.556	+ 11.849	= 93.405 sq.mts.
MUMTY AREA		+ 15.603	= 15.603 sq.mts.
<b>TOTAL ALL FLOOR AREA (FAR AREA + NON FAR AREA)</b>	<b>481.628</b>	<b>sq.mts.</b>	

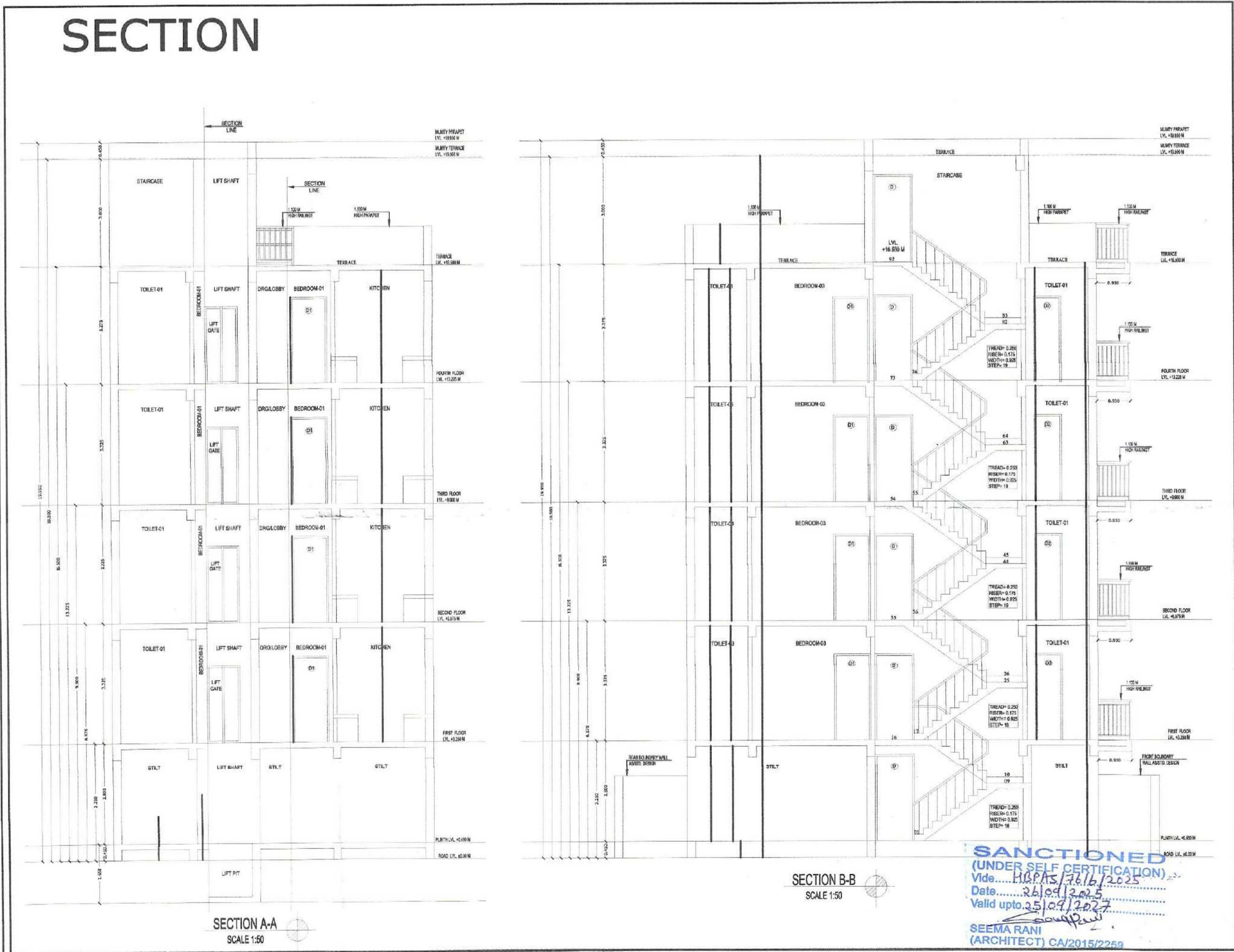

**OWNER NAME- LION INFRADEVELOPERS LLP**  
 PLOT NO= A-38  
 at Sector 06, Sohna, Haryana

**PROJECT NAME:- RESIDENTIAL PLOTTED COLONY UNDER DDJAY MERASURING 12.505 ACRES (LICENCE NO. 188 OF 2023 DATED 15.09.2023) IN SECTOR-06, SOHNA BEING DEVELOPED BY LION INFRADEVELOPERS LLP.**

STILT FLOOR PLAN, FIRST FLOOR PLAN, SECOND FLOOR PLAN, THIRD FLOOR PLAN, FOURTH FLOOR PLAN, TERRACE PLAN, MUMTY PLAN, D/W SCHEDULE, AREA CHART, ELEVATION & SECTION

Drg. No. - AR/PLOT NO=A-38/SHEET 01 OF 01      Scale      1:50

ARCHITECT'S SIGN      OWNER'S SIGN

Signature of Architect  
**SEEMA RANI**  
 CA/2015/72259

FOR LION INFRADEVELOPERS LLP  
 AUTHORIZED SIGNATORY

Drawn by:- PANKAJ KAPOOR      Mob. No. - 8800093157

**SANCTIONED**  
 (UNDER SELF CERTIFICATION)  
 Vids. No. 104/15/2023  
 Date: 21/04/2025  
 Valid upto 25/04/2027

**SEEMA RANI**  
 (ARCHITECT) CA/2015/72259