

| DOOR, WINDOW & VENTILATOR SCHEDULE |      |       |       |        |  |  |
|------------------------------------|------|-------|-------|--------|--|--|
| S.No.                              | TYPE | WIDTH | CILL  | LINTEL |  |  |
| 1                                  | D    | 1.165 | 0     | 2.450  |  |  |
| 2                                  | D1   | 1.000 | 0     | 2.450  |  |  |
| 3                                  | D2   | 0.750 | 0     | 2.450  |  |  |
| 4                                  | SD1  | 2.125 | 0     | 2.450  |  |  |
| 5                                  | W/EF | 1.200 | 0.9   | 2.450  |  |  |
| 6                                  | W1   | 1.525 | 1.900 | 2.450  |  |  |
| 7                                  | V/PV | 0.600 | 1.550 | 2.450  |  |  |

| AREA STATEMENT   |                |                |                        |
|--|----------------|----------------|------------------------|
| TOTAL PLOT AREA = 7,000 M X 15,000 M   | 105,000        | sq.mts.        |                        |
| PERMISSIBLE COVERED F.A.R. @ 200%  | 210,000        | sq.mts.        |                        |
| TOTAL PERMISSIBLE GROUND COVERAGE @ 78%                                      | 78,750         | sq.mts.        |                        |
| ACHIEVED F.A.R. @ 84%  | 67,200         | sq.mts.        |                        |
| <b>TOTAL FAR 284%</b>  | <b>277,200</b> | <b>sq.mts.</b> |                        |
| <b>PROPOSED F.A.R. AREA OF STILT</b>   |                |                |                        |
| A  | 1.845 X 1.730  | =              | 3.192 sq.mts.          |
| B  | 2.195 X 4.625  | =              | 10.152 sq.mts.         |
| <b>TOTAL FAR AREA OF A+B</b>   |                |                |                        |
| NON F.A.R. AREA OF STILT   |                |                |                        |
| AA   | 7.000 X 11.500 | =              | 80.500 sq.mts.         |
| 1+2+A+B  |                | =              | 13.578 sq.mts.         |
| <b>TOTAL AREA FAR + NON FAR (AA + 1+2)</b>                                   |                | =              | <b>81.924 sq.mts.</b>  |
| <b>PROPOSED F.A.R. ON FIRST FLOOR</b>  |                |                |                        |
| AA   | 7.000 X 11.500 |                |                        |
| 1  | 2.115 X 3.310  | =              | 6.999 sq.mts.          |
| 2  | 4.805 X 0.400  | =              | 1.922 sq.mts.          |
| 3  | 1.850 X 4.165  | =              | 7.705 sq.mts.          |
| 4  | 1.500 X 1.500  | =              | 2.250 sq.mts.          |
| <b>TOTAL OF 1 TO 4</b>   |                |                |                        |
|  |                | =              | <b>18.181 sq.mts.</b>  |
| <b>PROPOSED F.A.R. ON SECOND FLOOR</b>                                       |                |                |                        |
|  |                | =              | <b>85.313 sq.mts.</b>  |
| <b>PROPOSED F.A.R. ON THIRD FLOOR</b>  |                |                |                        |
|  |                | =              | <b>85.313 sq.mts.</b>  |
| <b>PROPOSED F.A.R. ON FOURTH FLOOR</b>                                       |                |                |                        |
|  |                | =              | <b>85.313 sq.mts.</b>  |
| <b>TOTAL PROPOSED F.A.R. AREA ON ALL FLOORS (STILT + FF + SF + TF + 4TH)</b> |                |                |                        |
|  |                | =              | <b>274.596 sq.mts.</b> |
| <b>NON F.A.R. AREA OF MUMTY</b>  |                |                |                        |
| A  | 1.845 X 1.730  | =              | 3.192 sq.mts.          |
| B  | 2.195 X 4.625  | =              | 10.152 sq.mts.         |
| <b>TOTAL FAR AREA OF A+B</b>   |                |                |                        |
|  |                | =              | <b>13.344 sq.mts.</b>  |
| <b>FLOORS FAR AREA + NON FAR AREA</b>  |                |                |                        |
|  |                |                | <b>TOTAL SQ.MTS.</b>   |
| STILT AREA   | 13.344 +       | 61.924         | = 75.268 sq.mts.       |
| FIRST FLOOR  | 66.313 +       | 9.955          | = 76.268 sq.mts.       |
| SECOND FLOOR   | 66.313 +       | 9.955          | = 76.268 sq.mts.       |
| THIRD FLOOR  | 66.313 +       | 9.955          | = 76.268 sq.mts.       |
| FOURTH FLOOR   | 66.313 +       | 9.955          | = 76.268 sq.mts.       |
| MUMTY AREA   |                | 13.344         | = 13.344 sq.mts.       |
| <b>TOTAL ALL FLOOR AREA (FAR AREA + NON FAR AREA)</b>                        |                |                |                        |
|  |                | =              | <b>389.684 sq.mts.</b> |

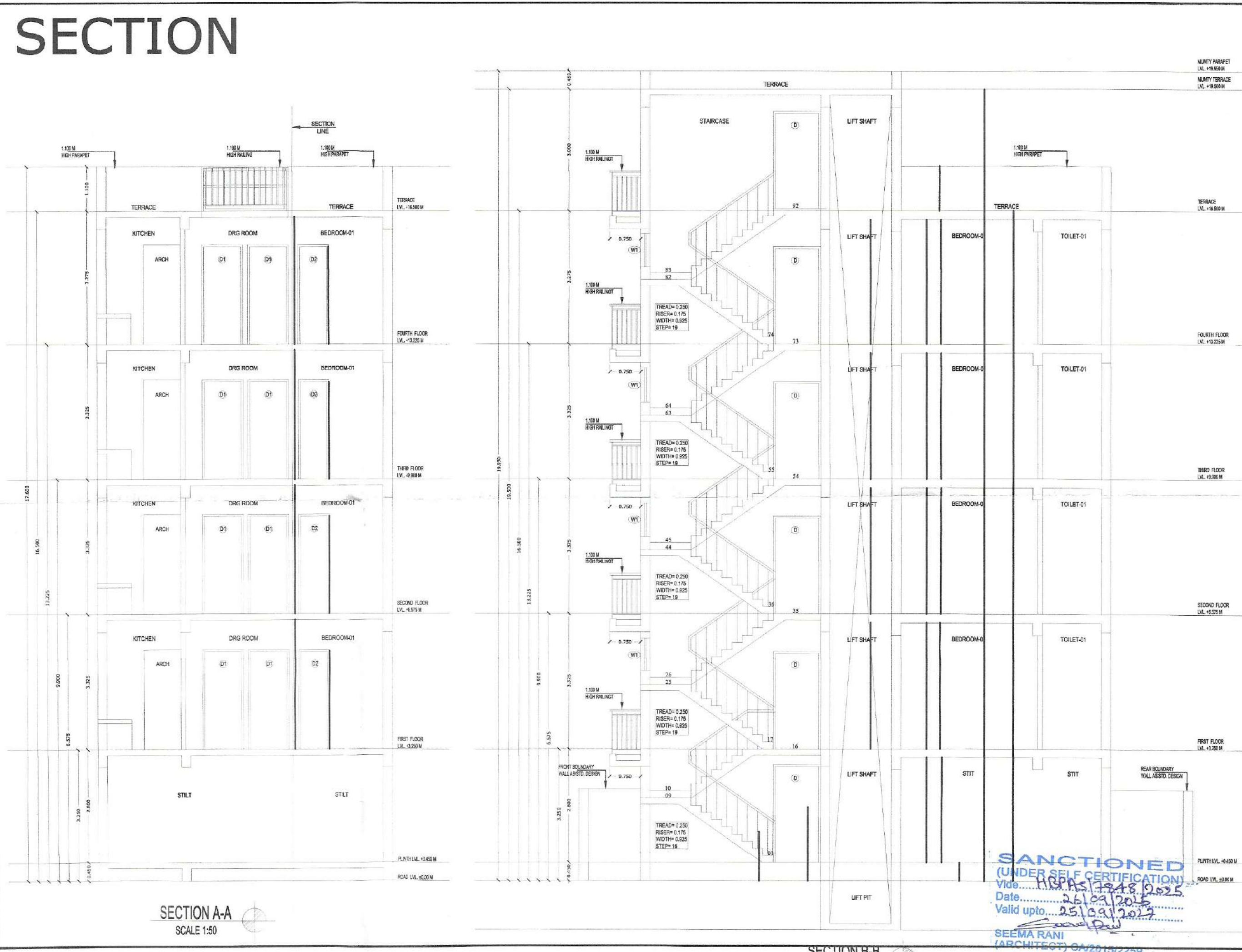

**OWNER NAME:- LION INFRADEVELOPERS LLP**  
 PLOT NO= B-159  
 at Sector 06, Sohna, Haryana

**PROJECT NAME:- RESIDENTIAL PLOTTED COLONY UNDER DDJAY MERASURING 12.505 ACRES (LICENCE NO. 188 OF 2023 DATED 15.09.2023) IN SECTOR-06, SOHNA BEING DEVELOPED BY LION INFRADEVELOPERS LLP.**

STILT FLOOR PLAN, FIRST FLOOR PLAN, SECOND FLOOR PLAN, THIRD FLOOR PLAN, FOURTH FLOOR PLAN, TERRACE PLAN, MUMTY PLAN, D/W SCHEDULE, AREA CHART, ELEVATION & SECTION

Drp. No.- AR/PLOT NO=B-159/SHEET 01 OF 01 Scale 1:50

ARCHITECT'S SIGN: *Seema Rani*  
**Signature of Architect SEEMA RANI CA/2015/72259**

OWNER'S SIGN: *Pankaj Kapoor*  
**FOR LION INFRADEVELOPERS LLP AUTHORIZED SIGNATORY**

Drawn by:- PANKAJ KAPOOR Mob. No. - 8800093157

**SANCTIONED**  
 (UNDER SELF CERTIFICATION)  
 V.No. 108/PS/2023/0225  
 Date: 25/09/2023  
 Valid upto: 25/09/2025  
 SEEMA RANI  
 (ARCHITECT)