

TOWER A6,A7,A8,A9
SECTION - AA'

TOWER A6

TOWER A7

SECTION - BB'

TOWER A8

TOWER A9

H. K. S.P. (HQ) S.P. (G) C.P. (HR)
Member Secretary Member Chairman
B.P.A.C. B.P.A.C.

DTP (HQ) ATP (HQ)

DINESH KUMAR
PA (HQ)

SANCTIONED
TO BE READ WITH THIS OFFICE
MEMO NO.: 96660
DATED: 9/2/25

- NOTE:
1. BUILDING HAS AUTOMATIC SPRINKLER SYSTEM (WHETHER REQUIRED BY NBC).
 2. BUILDING WILL BE DESIGNED (STRUCTURES) AS PER RELEVANT IS CODES FOR EARTH QUAKE RESISTANCE.
 3. 100% POWER BACKUP/ MECHANICAL VENTILATED SHAFTS.

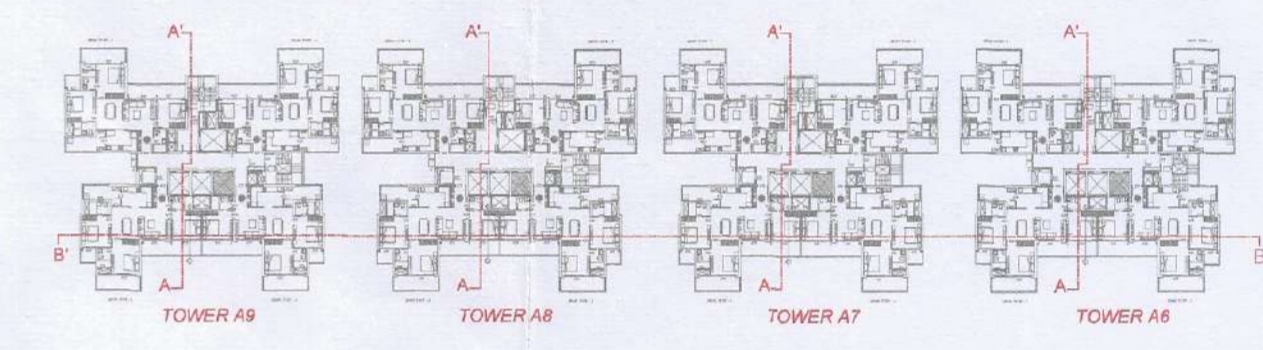

PROJECT
PROPOSED BUILDING PLAN FOR AFFORDABLE GROUP HOUSING (POCKET A) OVER AN AREA MEASURING 16.47378 ACRES, PART OF INDUSTRIAL PLOTTED COLONY OVER AN AREA MEASURING 110.22012 ACRES (ZONE NO. 106 OF 2005 DATED 06/09/2005) IN THE REVENUE ESTATE OF VILLAGE BAS HARI AND JINDI SARAI AGRI. IN SECTOR 106, M10 AND M11 GURUGRAM MANESAR URBAN COMPLEX.

OWNER
M3M INDIA INFRASTRUCTURES PVT. LTD.

ARCHITECTS
STUDIO SYMBIOSIS
INDIA GERMANY | UK
1301, TOWER-E, SKYMARK ONE
SECTOR 98, NOIDA, U.P. 201301, NOIDA
TEL: +91 120 422079
E-MAIL: INFO@STUDIO-SYMBIOSIS.COM
WWW.STUDIO-SYMBIOSIS.COM

OWNER'S SEAL & SIGNATURE
For M3M India Infrastructures Pvt. Ltd.
(Authorized Signatory)

ARCHITECT'S SEAL & SIGNATURE
AMIT GUPTA
ARCHITECT
CAL/2004/33147

DATE: SCALE: DWG NO: SEC-A6-A9
DWG TITLE: SECTION AA' RBB (TOWER A6 - A9)