

DOOR, WINDOW & VENTILATOR SCHEDULE				
S.No.	TYPE	WIDTH	CILL	LINTEL
1	D	1.075	0	2.450
2	D1	1.000	0	2.450
3	D2	0.750	0	2.450
4	D3	0.995	0	2.450
5	DW1	1.750	0	2.450
6	W/E	1.850	0	2.450
7	W1	1.525	900	2.450
8	VPV	0.750	1.550	2.450

AREA STATEMENT					
TOTAL PLOT AREA = 8.650 M X 15.000 M			129.750	sq.mts.	
ERMSSIBLE COVERED F.A.R. @ 200%			259.500	sq.mts.	
TOTAL PERMISSIBLE GROUND COVERAGE @ 75%			97.313	sq.mts.	
ACHIVED F.A.R. @ 64%			83.040	sq.mts.	
TOTAL FAR 264%			342.540	sq.mts.	
PROPOSED F.A.R. AREA OF STILT					
A	1.730	X	1.535	= 2.656 sq.mts.	
B	2.195	X	4.535	= 9.954 sq.mts.	
C	1.730	X	1.730	= 2.993 sq.mts.	
TOTAL FAR AREA OF A+B+C			= 15.603	sq.mts.	
NON F.A.R. AREA OF STILT					
AA	8.650	X	11.320	= 97.918 sq.mts.	
1+2+A+B+C			= 20.316	sq.mts.	
TOTAL AREA FAR + NON FAR (AA - 1+2)			= 77.602	sq.mts.	
PROPOSED F.A.R. ON FIRST FLOOR 0.854					
AA	8.650	X	11.320	= 97.918 sq.mts.	
or	97.918	LESS	16.362	= 81.556 sq.mts.	
1	2.485	X	1.565	= 3.889 sq.mts.	
2	6.340	X	0.130	= 0.824 sq.mts.	
3	1.850	X	4.075	= 7.539 sq.mts.	
4	0.230	X	1.075	= 0.247 sq.mts.	
5	1.500	X	1.075	= 1.613 sq.mts.	
6	1.500	X	1.500	= 2.250 sq.mts.	
TOTAL OF 1 TO 6			= 16.362	sq.mts.	
PROPOSED F.A.R. ON FIRST FLOOR			= 81.556	sq.mts.	
PROPOSED F.A.R. ON SECOND FLOOR			= 81.556	sq.mts.	
PROPOSED F.A.R. ON THIRD FLOOR			= 81.556	sq.mts.	
PROPOSED F.A.R. ON FOURTH FLOOR			= 81.556	sq.mts.	
TOTAL PROPOSED F.A.R. AREA ON ALL FLOORS (STILT + FF + SF + TF+ 4TH)			= 341.827	sq.mts.	
NON F.A.R. AREA OF MUMTY					
A	1.730	X	1.535	= 2.656 sq.mts.	
B	2.195	X	4.535	= 9.954 sq.mts.	
C	1.730	X	1.730	= 2.993 sq.mts.	
TOTAL AREA (A+B+C)			= 15.603	sq.mts.	
FLOORS	FAR AREA	+	NON FAR AREA	TOTAL	SQ.MTS.
STILT AREA	15.603	+	77.602	= 93.205	sq.mts.
FIRST FLOOR	81.556	+	3+4+5+6	= 93.205	sq.mts.
SECOND FLOOR	81.556	+	3+4+5+6	= 93.205	sq.mts.
THIRD FLOOR	81.556	+	3+4+5+6	= 93.205	sq.mts.
FOURTH FLOOR	81.556	+	3+4+5+6	= 93.205	sq.mts.
MUMTY AREA			15.603	= 15.603	sq.mts.
TOTAL ALL FLOOR AREA (FAR AREA + NON FAR AREA)			= 481.628	sq.mts.	

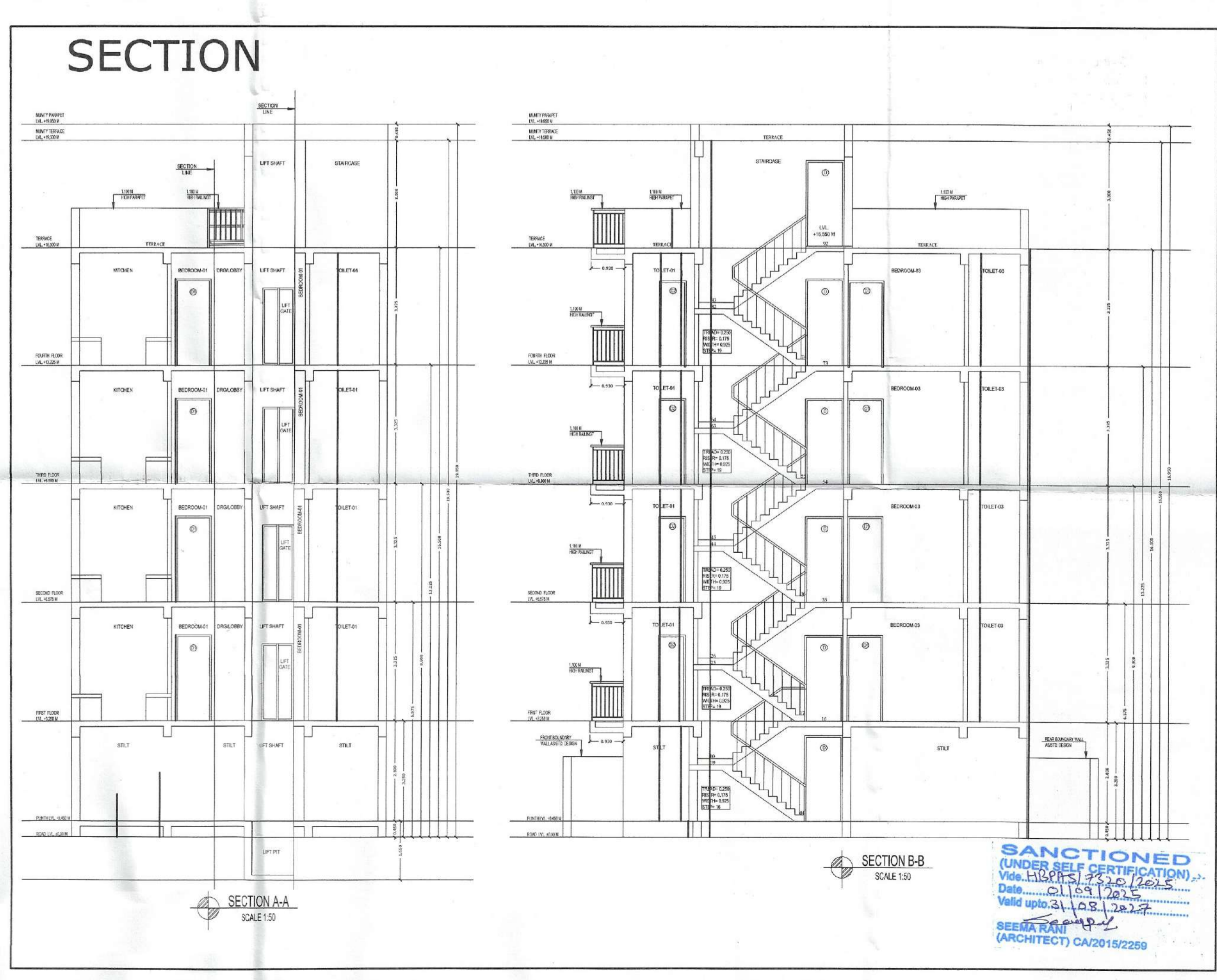

SANCTIONED
 (UNDER SELF CERTIFICATION)
 Date: 21.08.2025
 Valid upto: 21.08.2027
SEEMA RANI
 (ARCHITECT) CA/2015/2259

OWNER NAME:- LION INFRADEVELOPERS LLP
 PLOT NO= A-14
 at Sector 06, Sohna, Haryana

PROJECT NAME:- RESIDENTIAL PLOTTED COLONY UNDER DDJAY MERASURING 12.505 ACRES (LICENCE NO. 188 OF 2023 DATED 15.09.2023) IN SECTOR-06, SOHNA BEING DEVELOPED BY LION INFRADEVELOPERS LLP.

STILT FLOOR PLAN, FIRST FLOOR PLAN, SECOND FLOOR PLAN, THIRD FLOOR PLAN, FOURTH FLOOR PLAN, TERRACE PLAN, MUMTY PLAN, D/W SCHEDULE, AREA CHART, ELEVATION & SECTION

Dwg. No.- AR/PLOT NO=A-14/SHEET 01 OF 01 Scale 1:50

ARCHITECTS SIGN OWNER'S SIGN

Signature of Architect
SEEMA RANI
 CA/2015/2259

FOR LION INFRADEVELOPERS LLP
 AUTHORIZED SIGNATORY

Drawn by:- PANKAJ KAPOOR Mob. No. - 8800093157