



HARYANA REAL ESTATE REGULATORY AUTHORITY

PANCHKULA

SUPPLEMENTARY REGISTRATION

Registration Certificate No. HRERA-PKL-FBD-462-2023 Dated 31.05.2023
valid upto 12.04.2028

Project: "Wonder Walk" a Commercial Plotted Colony on land measuring 3.643 acres situated in the revenue estate of village Kheri Kalan, Sector-88, Faridabad.

Promoter: Soha Developers Pvt. Ltd., HS-16, Kailash Colony, South Delhi 110048

The request of the promoter for registration of additional area measuring 3.643 acres (total measuring 7.312 acres) was placed before the Authority in its meeting held on 03.04.2024 vide Item No. 248.04 wherein the Authority decided to grant registration for the additional area. Revised proforma A to H, REP II and the revised layout plan are annexed herewith.

Rest of the terms and conditions of the said certificate shall remain unchanged. This supplementary registration shall not affect the rights of the existing allottees who have already executed agreements for allotment of plots/shops/apartments in the project. This Supplementary Registration certificate shall be part and parcel of the Registration No. HRERA-PKL-FBD-462-2023 dated 31.05.2023 issued by the Authority.

Chander Shekhar
Member

Dr. Geeta Rathee Singh
Member

Nadim Akhtar
Member

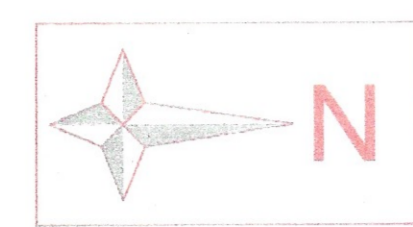

Parneet S Sachdev
Chairman



- ALREADY LICENCE GRANTED AREA
(LICENCE NO. 79 OF 2022.) 2.74375 acs.
- ALREADY LICENCE GRANTED AREA
(LICENCE NO. 80 OF 2023.) 0.925 acs.
- ALREADY LICENCE GRANTED AREA
(LICENCE NO. 191 OF 2022.) 3.64375 acs.

16 15 13 5 10 16 15
13
13
10
25

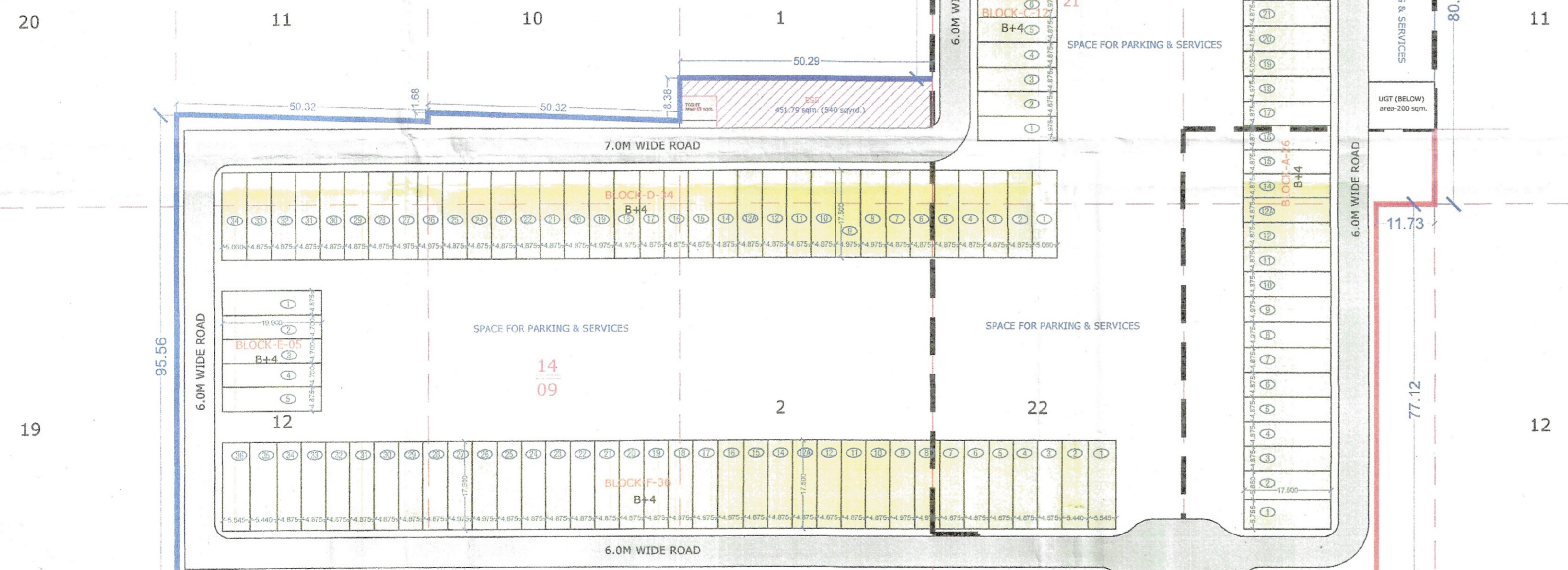
SECTOR-88 VILLAGE KHERI-KALAN



14 09
239.72
HSVP MARGINAL LAND
ALREADY PURCHASE FROM HSVP
E.O. HSVP OFFICE MEMO NO.8237
Dt. 19.09.2022. (area-294.12 sqm.)

12m wide service road

2 karam wide revenue raasta

HSVP MARGINAL LAND (SHIFTED)
area = 279.95sqm.

30m wide road constructed at site

12m wide service road

64
13

This is a "PROVISIONAL APPROVED LAYOUT PLAN"
Only for purpose of filing
Construction from the general public

DRG. No.:- DTP 9901 DATED:- 27-12-23

SECTOR-89

- (GURPREET KHEPAR) AD(HQ)
- (SUREKHA YADAV) A TP (HQ)
- (LALU BAZAD) DTP(HQ)
- (VJENDER SINGH) STP(HQ)
- (P. P. SINGH) CTP(HR.)
- (T.L. SATYAPRAKASH, IAS) DGTCP(HR.)

AREA STATEMENT :		
DESCRIPTION	AREA IN	AREA IN
	SQ.METER	ACRES
TOTAL AREA OF THE SCHEME	29592.59	7.3125 ACS.
PERMISSIBLE FAR = 150 %	44388.88 sqm.	10.9687 ACS.
PROPOSED FAR = 138.508%	40988.42 sqm.	10.1284 ACS.
PERMISSIBLE GROUND COVERAGE	35.00% (10357.38 sqm.)	2.55937 ACS.
PROPOSED GROUND COVERAGE	34.627% (10247.11 sqm.)	2.5321 ACS.

AREA DETAIL									
TYPE OF PLOTS	PLOT NO.	DIMENSION OF PLOTS IN SQM.		AREA OF PLOTS IN SQM.	NO OF PLOTS	No. OF FLOOR	GROUND COVERAGE in sqm.	Total Units	Total FAR
		W	D						
BLOCK-A	1	5.755	17.500	100.71	1	4	100.71	4	402.85
	2	5.650	17.500	98.88	1	4	98.88	4	395.50
	03 to 07	4.875	17.500	85.31	5	4	426.56	20	1706.25
	08 to 09	4.975	17.500	87.06	2	4	174.13	8	696.50
	10 to 17	4.875	17.500	85.31	8	4	682.50	32	2730.00
	18 to 19	4.975	17.500	87.06	2	4	174.13	8	696.50
	20 to 24	4.875	17.500	85.31	5	4	426.56	20	1706.25
	25	5.650	17.500	98.88	1	4	98.88	4	395.50
	26	5.755	17.500	100.71	1	4	100.71	4	402.85
BLOCK-B	1	5.130	19.900	102.09	1	4	102.09	4	408.35
	2 to 4	5.030	19.900	100.10	3	4	300.29	12	1201.16
	5	5.130	19.900	102.09	1	4	102.09	4	408.35
BLOCK-C	1	4.975	16.000	79.60	1	4	79.60	4	318.40
	2 to 5	4.875	16.000	78.00	4	4	312.00	16	1248.00
	6 to 7	4.975	16.000	79.60	2	4	159.20	8	636.80
	8 to 11	4.875	16.000	78.00	4	4	312.00	16	1248.00
	12	4.975	16.000	79.60	1	4	79.60	4	318.40
BLOCK-D	1	5.060	17.500	88.55	1	4	88.55	4	354.20
	2 to 7	4.875	17.500	85.31	6	4	511.88	24	2047.50
	8 to 9	4.975	17.500	87.06	2	4	174.13	8	696.50
	10 to 17	4.875	17.500	85.31	8	4	682.50	32	2730.00
	18 to 19	4.975	17.500	87.06	2	4	174.13	8	696.50
	20 to 25	4.875	17.500	85.31	6	4	511.88	24	2047.50
	26 to 27	4.975	17.500	87.06	2	4	174.13	8	696.50
	28 to 33	4.875	17.500	85.31	6	4	511.88	24	2047.50
	34	5.060	17.500	88.55	1	4	88.55	4	354.20
BLOCK-E	1	4.875	19.900	97.01	1	4	97.01	4	388.05
	2 to 4	4.700	19.900	93.53	3	4	280.59	12	1122.36
	5	4.875	19.900	97.01	1	4	97.01	4	388.05
BLOCK-F	1	5.545	17.500	97.04	1	4	97.04	4	388.15
	2	5.440	17.500	95.20	1	4	95.20	4	380.80
	3 to 7	4.875	17.500	85.31	5	4	426.56	20	1706.25
	8 to 9	4.975	17.500	87.06	2	4	174.13	8	696.50
	10 to 15	4.875	17.500	85.31	6	4	511.88	24	2047.50
	16 to 17	4.975	17.500	87.06	2	4	174.13	8	696.50
	18 to 25	4.875	17.500	85.31	8	4	682.50	32	2730.00
	26 to 27	4.975	17.500	87.06	2	4	174.13	8	696.50
	28 to 34	4.875	17.500	85.31	7	4	597.19	28	2388.75
	35	5.440	17.500	95.20	1	4	95.20	4	380.80
	36	5.545	17.500	97.04	1	4	97.04	4	388.15
TOTAL					118		10247.11	472	40988.42

Car Parking Size = 2.5 X 5.0 meter = 12.50 @ ECS.
 NOTE:- PARKING AREA CANNOT BE SOLD IN ANY MANNER.

For Soha Developers Pvt. Ltd. Director/Author, Signatory	Seema Rani SEEMA RANI CA/2015/72259 ARCHITECT SIGNATURE
AUTHORIZED SIGNATORY	ARCHITECT SIGNATURE

CLIENT:- ADDRESS:
 HS-16, KAILASH COLONY, NEW DELHI 110048,
 REVISED LAYOUT PLAN FOR COMMERCIAL
 PLOTTED COLONY/SCO AREA MEASURING 7.3125
 ACS. FALLING IN SECTOR-88, VILLAGE
 KHERI-KALAN FARIDABAD. SCALE 1 : 700 DT:- 10-NOV-2023

M/S SOHA DEVELOPERS PVT. LTD.