

Directorate of Town & Country Planning, Haryana

Plot No. 3, Nagar Yojna Bhawan, A-wing, Madhya Marg, Sector-18 Chandigarh,
Website: tcpharyana.gov.in; Phone: 0172-2548475, 2707175; email:
tcpharyana7@gmail.com

Regd.

To

Palm Abodes Buildcon Pvt. Ltd.
SCO No. A-2, Sector-35, Suncity,
Rohtak.

Memo No. LC-4647-JE (MK)-2023/ 36900 Dated: 31-10-2023

Subject: Approval of Service Plan/Estimates for Affordable Residential Plotted Colony (under DDJAY Policy 2016) over an area measuring 8.903 acres Licence No. 169 of 2022 dated 22.10.2022 in Sector-25D, Rohtak.

Please refer your application on the matter as subject cited above.

The service plan/ estimates of Affordable Residential Plotted Colony (under DDJAY Policy 2016) over an area measuring 8.903 acres falling under Licence No. 169 of 2022 dated 22.10.2022 in Sector-25D, Rohtak has been checked and corrected wherever necessary and are hereby approved subject to the following terms and conditions:-

1. That you will have to pay External Development Charges as a full and no deduction on account of any services proposed from other Department/from own sources by the colonizer for the time being, as EDC works for a town as a whole will have to be got executed in view of overall planning, proposed area also covered/to be covered in EDC, Rohtak Town.
2. The category wise area shown on the plans and proposed density of population thereof has been treated to be correct for the purpose of services only.
3. That you are liable to maintain the licensed area for ten years or as per HSVP norms till such time, the colony is taken over by the local authority/State Govt.
4. The wiring system of street lighting will be under ground and the specifications of the street lighting fixture etc. will be as per relevant standard of HVPNL. LED lamps shall be provided to meet the requirement of HVPNL and as well environment.
5. It is made clear that appropriate provision for fire-fighting arrangement as required in the NBC/ISI should also be provided by you and fire safety certificate should also be obtained from the competent authority before undertaking any construction. You shall be sole responsible for fire safety arrangement.
6. All technical notes and comments incorporated in the estimates in two sheets will also apply. A copy of these is also appended as Annexure-A.
7. The correctness of the levels of the colony will be sole responsibility of the owner for integrating the internal sewer/ storm water drainage of the colony by gravity with the master services.
8. That level/extent of external services to be provided by HSVP will be in accordance with EDC deposited. The colonizer will be fully responsible to meet the demand, to dispose of effluent and rain water till these services are provided by HSVP.
9. You shall be solely responsible for disposal of sewage of your colony as per requirement of HSPCB/Environment Deptt. till such time the external services are made available as per the proposal of the town. All the link connections with the

external services shall be made by you at your own cost after seeking approval from competent authority. There should be no pollution due to disposal of sewerage of the colony. The disposal of the effluent should be accordance to the standard norms fixed by Haryana State Pollution Board/Environment Department.

10. The estimate does not include the provision of electrification of the colony. However, it is clear that the supervision charges and O&M charges shall be paid by you directly to the HVPNL.
11. That you shall be solely responsible to lay the services upto the external services laid/to be laid by HSVP or any developing agency on Sector dividing road at respective locations/points.
12. You have proposed to utilize recycled water for flushing purposes and provision of separate flushing line, storage tank, metering system, pumping system and plumbing has been made. Therefore, it is clarified that no tap or outlet of any kind will be provided from the flushing lines/plumbing lines for recycled water except for connection to the cistern of flushing tanks and any scouring arrangement. Even ablution taps should be avoided.
 - (i) Two separate distribution systems, independent to each other, will be adopted, one for potable water supply and second for recycled water. Every Home/Office/business establishment will have access to two water pipe lines.
 - (ii) Potable water and recycled water supply lines will be laid on opposite berms of road. Recycled water lines will be above sewer lines. Wherever unavoidable and if all pipes are required to be laid on same side of road, these will be located from the ground surface in order of descending quality. Potable water shall be above recycled water which should be above sewer. Minimum clear vertical separation between a potable water line and a recycled water line shall be one ft, if it not possible then readily identifiable sleeve should be used.

To avoid any accidental use of recycled water for potable purposes all:-

 - (a) Recycle water pipes, fitting, appurtenances, valves, taps, meters, hydrants will be of Red Colour or painted red.
 - (b) Sign and symbols signifying and clearly indicating "Recycle Water" "Not fit for Drinking" must invariably be stamped/fixed on outlets, Hydrants Valves both surface and subsurface, Covers and at all conspicuous places of recycle distribution system.
 - (c) Detectable marker tapes of red colour bearing words "Recycle Water" should be fixed at suitable interval on pipes.
 - (d) Octagonal covers, red in colour or painted red and words "Recycle Water-Not fit for Drinking" embossed on them should be used for recycled water.
13. That it shall be mandatory to provide dual/two button or lever flushing system in toilets.
14. You shall be solely responsible for the construction of various structures such as RCC underground tank etc. according to the standard specification good quality and its workmanship. The structural stability responsibility will entirely rest upon you.
15. In case some additional structures are required to be constructed and decided by HSVP/development agency at a later stage, the same will be binding upon you. Flow of control valves will be installed preferably of automatic type on water supply connection with main water supply line, laid by developing agency or HSVP.

16. The formation level of internal road should match with sector roads. Similar other services like water supply, sewerage and SWD level etc. should be fixed in integration of levels of EDC services of water supply, sewerage and SWD etc, which shall be ensured by you.
17. In case it is decided by Govt. that HSVP/Govt. will construct 24 m wide road and will extend master services on 24 m wide internal circulation road, then additional amounts at rates as decided by the authority/Govt. will be recoverable over and above EDC.
18. Since, the construction of master road is yet to take place, you will get the road level/formation level of your service fixed from the concerned Superintending Engineer, before execution.
19. This estimate does not include the common services like water supply, storage tank on the top of the building block, the plumbing works etc. will part of the building works.
20. You will have to ensure that the sewer/storm water drainage to be laid by you will be connected with the proposed existing master services by gravity. If it is not possible to connect the services by gravity, it will be your sole responsibility to make the pumping arrangement and maintenance thereof for all the time to come.
21. That you shall not make any connection with the master services i.e. water supply, sewerage, storm water drainage, without prior approval of the competent authority in writing.
22. That the detailed technical proposal/scheme shall be got approved from this office before execution of work at site.
23. The firm will provide solar water heating system as per the guidelines issued by Haryana Govt./Ministry of Environment/Govt. of India.
24. It is made clear that roof top rain harvesting system shall be provided by you as per Central Ground Water Authority norms/Haryana Govt. Notification and the same shall be kept operational/maintained all the time. The arrangement for segregation of first rain water not to be entered into the system shall also be made by you.
25. That you shall transfer the land under master plan road as well as service road to Govt./HSVP for construction of road/service road free of cost and proportionate cost for construction of service road shall also be paid by you.
26. That you shall ascertain the compliance of all conditions of Chief Engineer-I, Haryana Shehri Vikas Pradhikaran, Panchkula imposed in his office letter memo no. CE-I/SE(HQ)/SDE (W)/HDM (R/F)/2022/215234 dated 22.12.2022 (enclosed as Annexure-A).

Note :-

- a. That you shall implement the directions given by National Green Tribunal O.A. No. 21 of 2014 and no. 95 of 2014 (in the matter of Vardhman Kaushik V/s Union of India & Others) and instructions have been issued by HSVP time to time may be implementation of these instructions at site.
- b. That you shall execute the development works as per Environmental Clearance and comply with the provisions of Environment Protection Act, 1986, Air (Prevention and Control of Pollution of Act 1981) and Water (Prevention and Control of Pollution of 1974). In case of any violation of the provisions of said statutes, you shall be liable

for penal action by Haryana State Pollution Controlled Board or any other Authority Administering the said Acts.

A copy of the approved service plan/estimates is enclosed herewith. You are requested to supply three additional copies of the approved service plan/ estimates to the Chief Administrator, HSVP, Panchkula under intimation to this office.

DA/As above



(Divya Dogra)
District Town Planner (HQ)
For Director General, Town & Country Planning
Haryana, Chandigarh

Endst. No LC-4647-JE (MK)-2023/

Dated:

A copy is forwarded to the Chief Engineer-II, HSVP, Panchkula with reference to his memo No. CE-1/SE(HQ)/SDE (W)/HDM (R/F)/2022/215234 dated 22.12.2022 for information and necessary action please.



(Divya Dogra)
District Town Planner (HQ)
For Director General, Town & Country Planning
Haryana, Chandigarh

PALM ABODES BUILDCON PRIVATE LIMITED

To,
The Executive Engineer
HSVP, Rohtak
Rohtak, Haryana

22-11-2022

Subject: Approval of service plan estimate for "DDJAY Affordable Residential Plotted Colony" over an area measuring 8.903 acres (License No. 169 of 2022 dated 22.10.2022) falling in the revenue estate of Village Pahrawar, Sector-25 D, Tehsil & District – Rohtak, Haryana by M/s. Palm Abodes Buildcon Private Limited (through authorized signatory Raveen Siwach).

Dear Sir,

With reference to the above mentioned subject, we are hereby submitting five sets of service plan, service plan estimate for your kind consideration.

We would be highly obliged if you do the needful.

Thanking You
Yours Truly
for M/s. Palm Abodes Buildcon Private Limited

PALM ABODES BUILDCON PVT. LTD.

Raveen
Auth. Signatory

Authorized Signatory



INDIA NON JUDICIAL

Government of Uttar Pradesh

e-Stamp

[Handwritten Signature]

Certificate No.	: IN-UP66832363410252U
Certificate Issued Date	: 02-Dec-2022 12:17 PM
Account Reference	: NEWIMPACC (SV)/ up14013304/ GAUTAMBUDDH NAGAR 1/ UP-GBN
Unique Doc. Reference	: SUBIN-UPUP1401330426801592180161U
Purchased by	: PALM ABODES BUILDCON PVT LTD
Description of Document	: Article 19 Certificate or other Document
Property Description	: Not Applicable
Consideration Price (Rs.)	:
First Party	: PALM ABODES BUILDCON PVT LTD
Second Party	: Not Applicable
Stamp Duty Paid By	: PALM ABODES BUILDCON PVT LTD
Stamp Duty Amount(Rs.)	: 10 (Ten only)

सत्यमेव जयते



Please write or type below this line

UNDERTAKING

M/s. Palm Abodes Buildcon Pvt. Ltd. having registered office at SCO No. A-2, Sector-35, Suncity, Rohtak, Haryana-124001 through its authorized signatory Mr. RaveenSiwach S/o Sh. Wazir Singh Siwach, for setting up DDJAY Affordable Residential Plotted Colony over an area measuring 8.903 acres (License No. 169 of 2022 dated 22.10.2022) falling in the revenue estate of village Pahrawar, Sector-25 D, Tehsil & District- Rohtak, Haryana solemnly affirm as under:



Statutory Alert:

- The authenticity of this Stamp certificate should be verified at www.sholestamp.com or using e-Stamp Mobile App of Stock Holding. Any discrepancy in the details on this Certificate and as available on the website / Mobile App renders it invalid.
- The onus of checking the legitimacy is on the users of the certificate.

02-Dec-2022 12:17 PM (02-Dec-2022 12:17 PM) IN-UP66832363410252U 10

PALM ABODES BUILDCON PVT LTD PALM ABODES BUILDCON PVT LTD PALM ABODES BUILDCON PVT LTD PALM ABODES BUILDCON PVT LTD PALM ABODES BUILDCON PVT LTD

1. We shall provide Potable water for making the underground water fit for drinking purpose till the water supply is made available by HUDA.
2. That our company will not claim for any external services till the services in the area are provided by HUDA in vicinity of our site.
3. That the company shall provide its own infrastructure i.e. water supply, sewerage disposal & SWD till the external services of HUDA are laid out.
4. The sewerage effluent shall be disposed off from colony disposal to proposed external sewer of HUDA through sewer/rising main by making its own arrangements till laying the external services by HUDA.
5. The company shall abide by all prevailing norms/rules and regulations as fixed by HUDA.
6. The N.S.L formation levels of roads have been verified and are correct. Our company shall be responsible in case any mistake in levels etc.
7. That in case our external services level will not match HUDA level, then the company should do the pumping.

Solemnly affirmed and undertaken on this 02 Day of December 2022 (Two Thousand Twenty-Two).

RaveenSiwach

PALM ABODES BUILDCON PVT. LTD.

Raveen Siwach
Auth. Signatory

(Authorised Signatory)

Place- Noida

Date- 02-12-2022

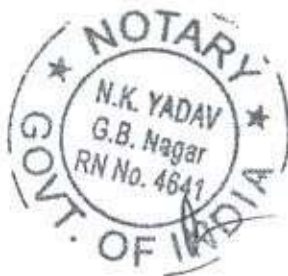

ATTESTED
N.K. YADAV
Advocate Notary
(G.B. NAGAR)

2 DEC 2022

**INTERNAL DEVELOPMENT WORKS
DESIGN AND COST ESTIMATES**

FOR

**PROJECT: PROPOSED SITE FOR D.D.J.A.Y AFFORDABLE
PLOTTED COLONY OVER AN AREA OF 8.903 ACRES
FALLING IN THE REVENUE ESTATE OF VILLAGE
PAHRAWAR, SECTOR -25 D, TEHSIL & DISTRICT -
ROHTAK.**



Rohit
ROHIT DABAS
Architect, Urban Planner
B.Arch. M.Plan (IIT Roorkee)
CA/2016/76810
AITP/2019-029

PALM ABODES BUILDCON PVT. LTD.
Ravi
Auth. Signatory

**Estimate for providing Internal Development Works in Construction of proposed D.D.J.A.Y.
Affordable Residential Plotted Colony, Rohtak, Haryana Measuring 8.903 Acres**

Rohtak is a city and the administration headquarters of the Rohtak district in the Indian State of Haryana. It lies 70 kilometers (43 mi) north-west of New Delhi and 250 kilometers (160 mi) south of the state capital Chandigarh on NH 9 (old NH 10). Rohtak being a part of the National Capital Region (NCR), has fast developing tendency and potential. The Haryana Government has asked the Union Government to declare Haryana Sub-Region (HSR) a zone of strategic national interest. HSR consists of 35 urban centers, including Gurgaon, Faridabad, Panipat, Sonapat and Rohtak.

This report and estimate is for approval of proposed DDJAY affordable plotted colony development over an area measuring 8.903 acres in the revenue estate of Village Pahrawar, Sector-25 D, Tehsil & District-Rohtak, Haryana. The above mentioned plotted colony is being developed and constructed by PALM ABODES BUILDCON PRIVATE LIMITED.

REPORT

The proposed development is Affordable Plotted colony over an area measuring 8.903 acres in the revenue estate of Village Pahrawar, Sector - 25 D, Tehsil & District - Rohtak. The above mentioned plotted colony is being developed and constructed by PALM ABODES BUILDCON PRIVATE LIMITED.

WATER SUPPLY

At present the source of water supply in this area is bore well. As the underground water is potable, provision for two numbers of bore wells have been made in this estimate. It has been proposed to construct underground tanks of capacity as per attached details and at location for domestic purpose. The underground tanks will be fed from the bore wells and HUDA supply mains passing along sector dividing master road, from their water will be pumped to O.H. tanks on the roof of the buildings. Calculated water demand are 282 KLD for Domestic and 194 KLD for Flushing. The water supply system has been designed as per the Hazen William formula.

DESIGN

The scheme has been designed for population considering 18 persons for each Plot. The rate of water supply per head/day has been taken for residential as 155.25 liters per head per day as per HUDA Norms.

PUMPING EQUIPMENTS

It has been proposed to install pumping set as described above with standby of equal capacity. Standby electric power requirement is added to the main DG Sets in case of electricity failure.

SEWERAGE SCHEME

Sewerage scheme of Building is designed for Sewer connecting to the Sewage Treatment Plant (STP) of 400 KLD capacity which cater the requirement of Buildings.

The sewer lines have been designed for three times average ^{SWP} D.W.F in relation to water supply demand. It has been assumed that about 80% of the domestic & 100% flushing water supply shall find its way into the proposed sewer. Sewer lines shall be laid to a gradient maintaining minimum 2.46 ft./sec self-cleaning velocity. Sewer line upto 400 mm dia. has been designed to run half full. However in the present case the maximum dia. works out to 200 dia. Laid Creating Velocity of 2.46 ft./Sec for peak flow. Necessary provision for laying ^{200mm dia SWP} HDPE-DWC pipe sewer line, construction of required number of manholes etc. has been made in the estimate.

ROHIT DABAS
Architect, Urban Planner
B.Arch. M.Plan (IIT Roorkee)
CA/2016/76810
AITP/2019-029



PALM ABODES BUILDCON PVT. LTD.
Ravi
Auth. Signatory

STORM WATER DRAINAGE

We propose to lay underground ^{400mm/d} R.C.C. pipe ~~drains~~ with required number of catch basins, manholes and rainwater harvesting pits / wells. Over flow of storm water will be connected to the proposed ~~HUDA~~ ^{HSVP} storm drain on sector road. The intensity of rain fall has been taken as ¼" per hour. R.C.C. storm water line will be designed as per Manning's formula. We propose to construct underground pipe drain which will be connecting rain water harvesting system for recharge aquifer and surplus storm water will be allowed to flow to the ~~HUDA~~ ^{HSVP} drain along sector dividing master road.

SPECIFICATIONS

Development work will be carried out in accordance with the standard specifications of P.H. as laid down by the Haryana Govt./HUDA.

Roads

Cost of road has been taken in the estimate.

Street Lighting

Provision for lighting on surrounding area has been made.

Horticulture

Estimates and details of plantation, landscaping, signage, etc., has been included.

Rates

The estimate has been based on the present market rates.

Cost

The total cost of the schemes, including cost of all services works out to be Rs. ~~852.42~~ ^{844.11} Lacs including 3% contingencies and 49% departmental charges which include Price Escalation & Deptt. Charges & cost per Acre works out to Rs. ~~95.75~~ ^{94.812} Lacs.

Authorized signatory



PALM ABODES BUILDCON PVT. LTD.

Auth. Signatory

PROJECT :- PROPOSED SITE FOR D.D.J.A.Y AFFORDABLE PLOTTED COLONY OVER AN AREA OF 8.903 ACRES FALLING IN THE REVENUE ESTATE OF VILLAGE PAHRAWAR, SECTOR -25 D, TEHSHIL & DISTRICT - ROHTAK.

Estimate For Providing Internal Services e.g. Water Supply, Sewerage & Storm Water Drainage etc. in respect of proposed site for D.D.J.A.Y affordable plotted colony over an area of 8.903 acres falling in the revenue estate of Village Pahrawar, Sector -25 D, Tehsil & District - Rohtak.

FINAL ABSTRACT OF COST

S.No.	Description	Amount	Amount (Laacs.)
1	Sub Work - I Water Supply Distribution System & Pumping Machinery	179.77	187.97
2	Sub Work - II Sewerage Scheme	129.97	130.29
3	Sub Work - III Storm Water Drainage	69.36	70.52
4	Sub Work - IV Roads & Footpath	190.34	190.34
5	Sub Work - V Street Lighting	7.06	34.16
6	Sub Work - VI - Horticulture	233.45	5.70
7	Sub Work - VII - Maintenance of Services for 10 years including resurfacing of roads after 1st 5 years & II phase i.e. 10 years of maintenance (as per HUDA norms)	844.11	233.45
Total		8.903	852.42
Area (Acre)		94.812	8.90
Cost Per Acre			95.75

(RUPEES Eight Crore Fifty Two Laacs Forty Two thousand only)

Rs. Eight Crore forty four Laacs + eleven thousand only

blurred
Superintending Engineer
HSVP, Circle, Rohtak

Executive Engineer
H S V P. Division No.-II
ROHTAK

Authorized Signatory

Sub Work - I (ABSTRACT OF COST)

Description	Amount (Laacs.)	Amount (Laacs.)
Water Supply Distribution System & Pumping Machinery		
Sub head I. Water Supply (Head Works)	61.48	65.68
Sub head II. Water Supply Pumping machinery	26.60	20.30
Sub head III. Water Supply Distribution (Domestic & Flushing Water)	37.42	19.23
Sub head IV. Water Supply Irrigation	0.98	11.93
Total	127.48	117.14
Adding 3% for Contingencies & PE Charges	3.67	3.51
Total	126.15	120.65
Adding 49% departmental charges & price escalation etc. Unforeseen	41.81	59.12
Say	187.97	179.77 Laacs

Checked subject to Comments
in forwarding letter No.
Dt. and notes
attached with the estimate

Superintending Engineer (HQ)
for Chief Engineer I, HSVP
Panchkula

C.O to final abstract of cost



ROHIT DABAS
Architect, Urban Planner
B.Arch. M.Plan (IIT Roorkee)
CA/2016/76810
AITP/2019-029

PALM ABODES BUILDCON PVT. LTD.

Ravi
Auth. Signatory

Director General
Town & Country Planning
Haryana, Chandigarh

PROJECT :- PROPOSED SITE FOR D.D.J.A.Y AFFORDABLE PLOTTED COLONY OVER AN AREA OF 8.903 ACRES FALLING IN THE REVENUE ESTATE OF VILLAGE PAHRAWAR, SECTOR -25 D, TEHSHIL & DISTRICT - ROHTAK.

WATER REQUIREMENT (LPD)

S.NO.	Description	Total water demand	Domestic Water (65%)	Flushing / Recycled Water (35%)
1	Plot Type-A - Water requirement @ 155.25 Lit/person for residence (as per HUDA). Number of person per Plot is 18. Total number Plot is 9. Total number of occupant is 162.	25151	16348	8803
2	Plot Type-B - Water requirement @ 155.25 Lit/person for residence (as per HUDA). Number of person per Plot is 18. Total number Plot is 6. Total number of occupant is 108.	16767	10899	5868
3	Plot Type-C - Water requirement @ 155.25 Lit/person for residence (as per HUDA). Number of person per Plot is 18. Total number Plot is 12. Total number of occupant is 216.	33534	21797	11737
4	Plot Type-D - Water requirement @ 155.25 Lit/person for residence (as per HUDA). Number of person per Plot is 18. Total number Plot is 9. Total number of occupant is 162.	25151	16348	8803
5	Plot Type-E - Water requirement @ 155.25 Lit/person for residence (as per HUDA). Number of person per Plot is 18. Total number Plot is 7. Total number of occupant is 126.	19562	12715	6847
6	Plot Type-F - Water requirement @ 155.25 Lit/person for residence (as per HUDA). Number of person per Plot is 18. Total number Plot is 28. Total number of occupant is 504.	78246	50860	27386
7	Plot Type-G - Water requirement @ 155.25 Lit/person for residence (as per HUDA). Number of person per Plot is 18. Total number Plot is 11. Total number of occupant is 198.	30740	19981	10759
8	Plot Type-H - Water requirement @ 155.25 Lit/person for residence (as per HUDA). Number of person per Plot is 18. Total number Plot is 12. Total number of occupant is 216.	33534	21797	11737
9	Plot Type-I - Water requirement @ 155.25 Lit/person for residence (as per HUDA). Number of person per Plot is 18. Total number Plot is 24. Total number of occupant is 432.	67068	43594	23474
10	Plot Type-J - Water requirement @ 155.25 Lit/person for residence (as per HUDA). Number of person per Plot is 18. Total number Plot is 8. Total number of occupant is 144.	22356	14531	7825
11	Plot Type-K - Water requirement @ 155.25 Lit/person for residence (as per HUDA). Number of person per Plot is 18. Total number Plot is 12. Total number of occupant is 216.	33534	21797	11737
12	Plot Type-L - Water requirement @ 155.25 Lit/person for residence (as per HUDA). Number of person per Plot is 18. Total number Plot is 6. Total number of occupant is 108.	16767	10899	5868
13	Commercial (Total Area 1441.150 Sq. mtr. Occupant Load @ 3 Sq. mtr. = 480)			
13.1	Visitor @ 90% (432) Water requirement @ 15 Lit. / person (Dom. Water: 35%, Flushing: 65%)	6480	2268	4212
13.2	Staff @ 10% (48) Water requirement @ 45 Lit. / person (Dom. Water: 35%, Flushing: 65%).	2160	756	1404
14	Community (Total Area 3603.020 Sq. mtr. Occupant Load @ 1.4 Sq. mtr. = 2573)			
14.1	Visitor @ 90% (2315.7 Say 2316) Water requirement @ 15 Lit. / person (Dom. Water: 35%, Flushing: 65%).	34740	12159	22581
14.2	Staff @ 10% (257.3 Say 257) Water requirement @ 45 Lit. / person (Dom. Water: 35%, Flushing: 65%).	11565	4048	7517
15	Water for floor mopping and cleaning @ 1000 litre lumsun.	1000	1000	-
16	Horticulture / Irrigation @ 6.17 lit. /sq. mt. / day. (for 2744.561 sqmt).	16934	-	16934
Sub Total		475289	281797	193492
TOTAL (M3/DAY)		476	282	194
Total Recycled water Requirement excluding Horticulture / Irrigation Requirement			176558 Ltr.	
Total Domestic Water Requirement excluding Recycled water			282 KL.	
Gross Water Requirement including Recycled Water			476 KL.	
Total STP Capacity @ 80% of Dom + 100% Flushing water demand excluding Horticulture/ Irrigation Requirement. <i>total water requirement</i>			401996 Ltr. <i>381</i>	
STP Output + 5% Marginal Factor = (401996 + 5%)			422095.8 Ltr. <i>19</i>	
OR			422.09 KL. <i>400</i>	
Say			425 KL. <i>400</i>	

ROHIT DABAS
 Architect, Urban Planner
 B.Arch. M.Plan (IIT Roorkee)
 CA/2016/76810
 AITP/2019-029



PALM ABODES BUILDCON PVT. LTD.
Raney
 Auth. Signatory

PROJECT :- PROPOSED SITE FOR D.D.J.A.Y AFFORDABLE PLOTTED COLONY OVER AN AREA OF 8.903 ACRES FALLING IN THE REVENUE ESTATE OF VILLAGE PAHRAWAR, SECTOR -25 D, TEHSHIL & DISTRICT - ROHTAK.

TUBEWELL REQUIREMENT				
1				
a)	Total Fresh Water Demand		282	KL
b)	Tubewells			
	Yield		22	KL / Hr.
	Working hours per day		12.10	hrs.
	No. of tube wells required	$\frac{282}{22 \times 12.10} = 1.07$		
	Say (1W+1S)	2		Nos.
2	Pumping machinery for Tube Wells			
a)	Gross working head		70	Meter
b)	Average fall in S.L.		5	Meter
c)	Depression Head		5	Meter
d)	Friction loss in main		10	Meter
	Total		90	Meter
	Discharge		22000	LPH
	Horse Power		12.22	HP
	(HP=(22000 x 90) / 60 x 60 x 75 x 0.6)			
	Say		12.5	HP
3	Underground Tank			
3.1	Total Domestic water demand daily		282	m ³ /day
i	Proposed underground tank for domestic use @ 60%		169.20	m ³ /day
	Say fire demand = $100 \sqrt{2592} = 259/3 = 86$ Say 100		180	m ³ /day
				Cap. of UGT = 180 + 100 = 280 KLD
3.2	Total Flushing water demand daily		194	m ³ /day
i	Proposed underground tank for flushing use @ 60%		116.40	m ³ /day
	Say		120	m ³ /day
4	UDA Main Water supply calculation			
a)	Required fresh water per day		282	m ³ /day
b)	Supply Duration		12	Hrs.
c)	Line flow rate		0.392	Cum / min
d)	Proposed line dia		100	mm
e)	Flow velocity		0.832	m/sec
f)	Friction head loss / 1000 m		3.84	Mtr.
g)	Length of line		125	Mtr.
h)	Total head loss		0.48	Mtr.



ROHIT DABAS
 Architect, Urban Planner
 B.Arch. M.Plann (IIT Roorkee)
 CA/2016/76810
 AITP/2019-029

PALM ABODES BUILDCON PVT. LTD.

Ramen
 Auth. Signatory

**PROJECT :- PROPOSED SITE FOR D.D.J.A.Y AFFORDABLE PLOTTED COLONY OVER AN AREA OF 8.903 ACRES
FALLING IN THE REVENUE ESTATE OF VILLAGE PAHRAWAR, SECTOR -25 D, TEHSHIL & DISTRICT -
ROHTAK.**

5	Pumps For Domestic water Supply			
	Domestic water requirement per day		282	m3/day
	Pumping Duration per day		8	hrs.
	Depth of Pump Room		5	Mtr.
	Clear head required		20 25	Mtr.
	Residual Pressure		5	Mtr.
	Friction head loass		15 10	Mtr.
	Total head		45	Mtr.
	Discharge of pump		587.50	LPM
		No. of Working Pumps	2	Nos.
		Say	300	LPM
	Power Required (HP= $(300 \times 45) / 60 \times 75 \times 0.6$)		5	HP
It is proposed to provide domestic water transfer pumps (2W+1S) of capacity 300 LPM each at 45 mtr. Head of 5 HP each pump.				
6	Pumps For Flushing water Supply			
	Flushing water requirement per day		194	m3/day
	Pumping Duration per day		8	hrs.
	Depth of Pump Room		5	Mtr.
	Clear head required		20	Mtr.
	Residual Pressure		5	Mtr.
	Friction head loass		15	Mtr.
	Total head		45	Mtr.
	Discharge of pump		404.17	LPM
		No. of Working Pumps	2	Nos.
		Say	200	LPM
	Power Required (HP= $(200 \times 45) / 60 \times 75 \times 0.6$)		3.3	HP
	Say		4	HP
It is proposed to provide flushing water transfer pumps (2W+1S) of capacity 200 LPM each at 45 mtr. Head of 4 HP each pump.				



Rohit
ROHIT DABAS
 Architect, Urban Planner
 B.Arch. M.Plann (IIT Roorkee)
 CA/2016/76810
 AITP/2019-029

PALM ABODES BUILDCON PVT. LTD.

Ravi
 Auth. Signatory

PROJECT :- PROPOSED SITE FOR D.D.J.A.Y AFFORDABLE PLOTTED COLONY OVER AN AREA OF 8.903 ACRES FALLING IN THE REVENUE ESTATE OF VILLAGE PAHRAWAR, SECTOR -25 D, TEHSHIL & DISTRICT - ROHTAK.

Estimate For Providing Internal Services e.g. Water Supply, Sewerage & Strom Water Drainage etc. in respect of proposed site for D.D.J.A.Y affordable plotted colony over an area of 8.903 acres falling in the revenue estate of Village Pahrawar, Sector -25 D, Tehshil & District - Rohtak.

	Capacity of Gen Set	Nos.	HP			
1	Tube Well Submersible Pumps	1	12.5	=	12.5	HP
2	Domestic Water Transfer Pumps	2	5	=	10	HP
3	Flushing Water Transfer Pumps	2	4	=	8	HP
4	STP	1	55	=	55	HP
5	Lighting			=	5	HP
					90.5	HP
	or	90.5	x 0.746 x 1.50		101.27	KVA
			Say		100.00	KVA
	Requirement of 100 KVA capacity will be added in to the main D.G. set to provide standby supply.					



Rohit
ROHIT DABAS
 Architect, Urban Planner
 B.Arch. M.Plan (IIT Roorkee)
 CA/2018/76510
 AITP/2019-029

PALM ABODES BUILDCON PVT. LTD.
Ravindra
 Auth. Signatory

Executive Engineer
H S V P. Division No.-II
ROHTAK

PROJECT :- PROPOSED SITE FOR D.D.J.A.Y AFFORDABLE PLOTTED COLONY OVER AN AREA OF 8.903 ACRES FALLING IN THE REVENUE ESTATE OF VILLAGE PAHRAWAR, SECTOR -25 D, TEHSHIL & DISTRICT - ROHTAK.

Estimate For Providing Internal Services e.g. Water Supply, Sewerage & Strom Water Drainage etc. in respect of proposed site for D.D.J.A.Y affordable plotted colony over an area of 8.903 acres falling in the revenue estate of Village Pahrawar, Sector -25 D, Tehshil & District - Rohtak.

Sub Work I				(Head Works) Water Supply		
Sub Head No. 1						
S. No.	Description	Unit	Qty	Rate	Amount (in Laes)	
1	Boring & installing tube well with rotary ring complete with 100mm dia pipe and strainer to a depth of about 120mts in all respect.	Nos.	2	1000000 ±500000	20.00 20.00	
2	Provision of rising main, connecting tube well with water main and by pass arrangements.					
3	100mm dia DI Pipe	Mtr.	165	1320 ±500	218 2.18	
3	Providing Tubewell submersible pumps capacity : 22000 LPH at 90 mtr head (12.5HP) (complete in all respect)	Nos.	2	200000	4.00	
4	Provision for carriage for materials and other un-foreseen items.	LS	-	-	0.50 1.00	
5	Provision for chlorination plant.	LS	-	-	1.00	
6	Construction of UG tanks 200 40 KL and 120 KL for Flushing in STP.	KL	400 300	5500 4500	13.20 22.00	
7	Provision of construction of tube well chambers of size 1.5 x 1.5 x 1.5 mtrs for housing tube well	Nos.	2	100000	2.00	
8	Construction of staff quarters maintenance staff	LS	-	-	300 6.50	
9	Provision for Const. of pump chambers boosting chamber of suitable size as per P.H. req.	LS	-	-	500 7.00	
(C.O. to Abstract of Cost of Sub Work No. I)					61.48	Laes

Total = 65.68 Laes



Rohit
ROHIT DABAS
 Architect, Urban Planner
 B.Arch. M.Planning (IIT Roorkee)
 CA/2016/76610
 AITP/2019-029

PALM ABODES BUILDCON PVT. LTD.

Rajesh
 Auth. Signatory

PROJECT :- PROPOSED SITE FOR D.D.J.A.Y AFFORDABLE PLOTTED COLONY OVER AN AREA OF 8.903 ACRES FALLING IN THE REVENUE ESTATE OF VILLAGE PAHRAWAR, SECTOR -25 D, TEHSHIL & DISTRICT - ROHTAK.

Estimate For Providing Internal Services e.g. Water Supply, Sewerage & Storm Water Drainage etc. in respect of proposed site for D.D.J.A.Y affordable plotted colony over an area of 8.903 acres falling in the revenue estate of Village Pahrawar, Sector -25 D, Tehshil & District - Rohtak.

Sub Work I						
Sub Head No. II						
S. No.	Description	Unit	Qty	Rate	Pumping Machinery Amount (in Laes)	
1	Providing & installing electricity driven pumping set capable of delivering 300 LPM for Each Pump of water against a total head of 45 m complete with motor and other accessories (For Domestic - 5 HP). (2W+1S)	Nos.	3	60000 20000	300 1.80	
	200 LPM for Each Pump, 45 m Head, 4 HP for Flushing Water Transfer Pump (2W+1S)	Nos.	3	50000 40000	300 1.50	
2	Provision for diesel engine generator set each for standby Arrangements or booster pump complete with gear head arrangements of following capacities.					
	1 No. - 100 KVA	LS	-	-	1200 9.00	
3	Provision for making foundations & erection of pumping machinery.	LS	-	-	2.00	
4	Provision for pipes, valves & specials inside the pump chamber.	LS	-	-	2.00	
5	Provision for carriage for materials and other unforeseen items.	LS	-	-	2.00	
6	Provision for Electric Service connection incl. electric fittings for T.W ehaush and cost of Transformer.	LS	-	-	2.00	
(C.O. to Abstract of Cost of Sub Work No. I)					26.60	Laes

R₃ = 20.30



Roht
ROHIT DABAS
 Architect, Urban Planner
 B.Arch. M. Plan (IIT Roorkee)
 CA/2016/76810
 AITP/2019-029

PALM ABODES BUILDCON PVT. LTD.

Ravi
 Auth. Signatory

PROJECT :- PROPOSED SITE FOR D.D.J.A.Y AFFORDABLE PLOTTED COLONY OVER AN AREA OF 8.903 ACRES FALLING IN THE REVENUE ESTATE OF VILLAGE PAHRAWAR, SECTOR -25 D, TEHSHIL & DISTRICT - ROHTAK.

Estimate For Providing Internal Services e.g. Water Supply, Sewerage & Storm Water Drainage etc. in respect of proposed site for D.D.J.A.Y affordable plotted colony over an area of 8.903 acres falling in the revenue estate of Village Pahrawar, Sector -25 D, Tehshil & District - Rohtak.

Sub Work I		Water Supply			
Sub Head No. III		Distribution System / Rising Main			
		(Domestic & Flushing)			
S. No.	Description	Unit	Qty	Rate	Amount (In Lacs)
1	Providing, laying, jointing and testing DI pipe lines including cost of excavation complete in all respects as per specification.				
1.1	100mm dia DI Pipe (K-7)	Mtr.	1014.0 964	14.00 14.60	14.20 13.50
2	Providing, laying, jointing and testing pipe lines including cost of complete in all respects				
	(from HHDA supply) PIF of Fire Hydrant		4	12000	0.48
2.1	100 mm dia DI pipe line from main HSVP line to UGT.	Mtr.	125	14.00 14.60	1.75 1.75
3	Providing and fixing indicating plates for sluice valve and air valves	Nos.	5	1000	0.05 0.10
4	Providing and fixing air release valve and scour valve.	Nos.	5	12000	0.60 0.40
5	Provision for carriage for materials and other unforeseen items(L/S)	LS	-	-	2.00
6	Providing for making water supply connection in HHDA (line) HSVP	LS	-	-	1.00
(C.O. to Abstract of Cost of Sub Work No. I)					33.43 19.23 Lacs



Rohit
ROHIT DABAS
 Architect, Urban Planner
 B.Arch. M.Plan (IIT Roorkee)
 CA/2016/76810
 AITP/2019-029

PALM ABODES BUILDCON PVT. LTD.

Ravi
 Auth. Signatory

PROJECT :- PROPOSED SITE FOR D.D.J.A.Y AFFORDABLE PLOTTED COLONY OVER AN AREA OF 8.903 ACRES FALLING IN THE REVENUE ESTATE OF VILLAGE PAHRWAR, SECTOR -25 D, TEHSHIL & DISTRICT - ROHTAK.

Estimate For Providing Internal Services e.g. Water Supply, Sewerage & Storm Water Drainage etc. in respect of proposed site for D.D.J.A.Y affordable plotted colony over an area of 8.903 acres falling in the revenue estate of Village Pahrawar, Sector -25 D, Tehshil & District - Rohtak.

Sub Work I					Water Supply	
Sub Head No. IV					Irrigation	
S. No.	Description	Unit	Qty	Rate	Amount (in Laes)	
1.	Providing, laying, jointing and testing ^{100 mm dia HDPE} UPVC pipe line conforming to IS 4985 including cost of excavation etc. complete in all respect.	mtr	950	1100	10.45	
a)	25 mm dia	Mtr.	50	300	0.15	
b)	40 mm dia	Mtr.	50	480	0.30	
2.	Providing and fixing 20 mm dia. Irrigation hydrant valve complete in all respect.	Nos.	4	3500	0.14	
3.	Provision for carriage of Material and other as foreseen Item	LS	-	-	05.1.00	
(C.O. to Abstract of Cost of Sub Work No. I)					0.98	Laes

Total = 11.93 Laes



Rohit
ROHIT DABAS
 Architect, Urban Planner
 B.Arch. M.Plans (IIT Roorkee)
 CA/2016/76810
 AITP/2019-029

PALM ABODES BUILDCON PVT. LTD.

Ramesh
 Auth. Signatory

PROJECT :- PROPOSED SITE FOR D.D.J.A.Y AFFORDABLE PLOTTED COLONY OVER AN AREA OF 8.903 ACRES FALLING IN THE REVENUE ESTATE OF VILLAGE PAHRAWAR, SECTOR -25 D, TEHSHIL & DISTRICT - ROHTAK.

Estimate For Providing Internal Services e.g. Water Supply, Sewerage & Storm Water Drainage etc. in respect of proposed site for D.D.J.A.Y affordable plotted colony over an area of 8.903 acres falling in the revenue estate of Village Pahrawar, Sector -25 D, Tehshil & District - Rohtak.

S. No.	Sub Work II Description	Unit	Qty	Rate	Amount (in Lacs)
1	Providing, laying and jointing DWC ^{SWP} pipes as per specifications i/c excavation, bed conc, encasement /cradle section with C.C., also i/c testing etc and construction of man holes etc complete.				
a)	200 dia pipe for depth 0 to 3.0m 3.0m ^{2.00 mtr depth}	Mtr.	831	1700 1800 1700	14.13 14.13
	Over flow line 100mm Ø G.P. Pipe ^{200 nild SWP}	Mtr.	180	1700 1875	3.06 3.06
b)	Provision for carriage of pipes, road cuts & making good of roads.	LS	-	-	2.00 1.50
c)	Provision for vent shafts	LS	-	-	2.00
d)	Provision for centering & shuttering, shoring & barricading.	LS	-	-	1.00 0.50
e)	Provision for watch & ward & lighting etc.	LS	-	-	1.00 0.50
f)	Provision for temporary disposal arrangements	LS	-	-	5.00
g)	Providing for Making connection with HUDA Master Sewer line	LS	-	-	1.00 1.00
h)	Construction of STP Capacity 425 KLD ^{400 KLD}	KLD	400 425	15000 13765	56.00 64.00
	Total				84.89 84.69
	Adding 3% for Contingencies				2.55 2.54
	Total				87.44 87.23
	Adding 49% departmental charges & price escalation etc				42.85 42.74
	Total Carry Over to Final Abstract of Cost				130.29 Lacs

Rs = 129.97 Lacs

Rohit
ROHIT DABAS
 Architect, Urban Planner
 B.Arch. M.Plan (IIT Roorkee)
 CA/2016/76610
 AITP/2019-029



PALM ABODES BUILDCON PVT. LTD.
Ramen
 Auth. Signatory

PROJECT :- PROPOSED SITE FOR D.D.J.A.Y AFFORDABLE PLOTTED COLONY OVER AN AREA OF 8.903 ACRES FALLING IN THE REVENUE ESTATE OF VILLAGE PAHRAWAR, SECTOR -25 D, TEHSHIL & DISTRICT - ROHTAK.

Estimate For Providing Internal Services e.g. Water Supply, Sewerage & Storm Water Drainage etc. in respect of proposed site for D.D.J.A.Y affordable plotted colony over an area of 8.903 acres falling in the revenue estate of Village Pahrawar, Sector -25 D, Tehshil & District - Rohtak.

Sub Work - III					Storm Water Drain	
S. No.	Description	Unit	Qty	Rate	Amount (In Laes)	
1	Providing, laying and jointing S & S RCC, NP3 pipes with rubber ring joints as per specifications i/c excavation bed & cradle section cove, also manholes & testing etc complete.					
a)	400 dia RCC pipes Class NP 3	Mtr.	878.00	2300 2500	20.19 21.95	
b)	Provision for carriage of pipes, road cutting & road restoration etc.	LS	-	-	2.00	1.00
c)	Provision of centering, shuttering shoring & barricading	LS	-	-	1.00	
d)	Provision for watch & ward & lightings etc	LS	-	-	1.00	
e)	For rain harvesting wells	Nos.	4	30000 35000	14.00	12.00
f)	Provision of temporary disposal arrangement for services till HSVP HUDA Services are made available	LS	-	-	2.00	6.00
g)	Provision for S.W.D. connection with main on master road	LS	-	-	1.00	
h)	Provision for road gully with pipe connection 250 200mm dia	LS	-	-	3.00	
Total					48.95	45.19
Adding 3% for Contingencies & PE Charges					1.38	1.36
Total					47.33	46.55
Adding 49% departmental charges & price escalation etc					23.19	22.81
Total Carry Over to Final Abstract of Cost					70.52	69.36 Lacs

Say = 69.36 Lacs



Roht
ROHIT DABAS
 Architect, Urban Planner
 B.Arch. M.Plan (IIT Roorkee)
 CA/2018/76810
 AITP/2019-029

PALM ABODES BUILDCON PVT. LTD.

Raney
 Auth. Signatory

PROJECT :- PROPOSED SITE FOR D.D.J.A.Y AFFORDABLE PLOTTED COLONY OVER AN AREA OF 8.903 ACRES FALLING IN THE REVENUE ESTATE OF VILLAGE PAHRAWAR, SECTOR -25 D, TEHSHIL & DISTRICT - ROHTAK.

Estimate For Providing Internal Services e.g. Water Supply, Sewerage & Strom Water Drainage etc. in respect of proposed site for D.D.J.A.Y affordable plotted colony over an area of 8.903 acres falling in the revenue estate of Village Pahrawar, Sector -25 D, Tehshil & District - Rohtak.

Sub Work IV		Road Work			
S. No.	Description	Unit	Qty	Rate	Amount (in Laes)
1	Provision for leveling, earth filling compaction as per specification as per site conditions	Acre	8.903	175000	15.58
2	The necessary provision for construction of roads, parks etc Has been made in the estimate according to HUDA norms				
	The following specifications has been proposed :				
i	Construction of roads by providing granular sub base 200 mm as per MORT & H es conforming to clause 401 grading -II 400.1				
ii	Providing and laying, spreading & compacting hand broken /crushed stone aggregate to wet mix conforming to physical requirement laid in 100 of MORT & H specification n in two layers (compacting to 25mm (125+125mm) by taking material 1.32 times of the (thickness of the layer) including premixing of material with water in mechanical mixer.				
iii	50 mm thick DBM				
iv	30 mm thick BC	Sq. mtr.	5447	1500	81.71
3	Provision of kerbs and channels with C.C 1.5:3 complete in all respects	Mtr.	990	600	5.94
4	Provision for making approach and pavement to each block of building	LS	-	-	5.00
5	Cost of Parking / Pavement for Commercial area 50% area	Sq. mtr.	720	1500	10.80
6	Provision for traffic arrangement, guide maps, Plot indicators	LS	-	-	3.00
7	Provision for carriage of materials & other unforeseen item	LS	-	-	2.00
	Total				124.03
	Add 3% contingencies and P L. charges				3.72
	Total				127.75
	Add 49% departmental charges, price escalation, Unforeseen admn				62.60
	Total Carry over to final abstract of cost				190.34
					Laes



ROHIT DABAS
 Architect, Urban Planner
 B.Arch. M.Plan (IIT Roorkee)
 CA/2018/76810
 AITP/2019-029

PALM ABODES BUILDCON PVT. LTD.

 Auth. Signatory

PROJECT :- PROPOSED SITE FOR D.D.J.A.Y AFFORDABLE PLOTTED COLONY OVER AN AREA OF 8.903 ACRES FALLING IN THE REVENUE ESTATE OF VILLAGE PAHRAWAR, SECTOR -25 D, TEHSHIL & DISTRICT - ROHTAK.

Estimate For Providing Internal Services e.g. Water Supply, Sewerage & Storm Water Drainage etc. in respect of proposed site for D.D.J.A.Y affordable plotted colony over an area of 8.903 acres falling in the revenue estate of Village Pahrawar, Sector -25 D, Tehsil & District - Rohtak.

Sub Work V		Street Lighting				
S. No.	Description	Unit	Qty	Rate	Amount (in Laes)	
1	Providing street lighting on roads as per standard specifications of HVPN approx. 8.903 acres	Acre	8.903	250000	22.26	
	Add 3% contingencies and PE Charges				0.67	
	Total				22.93	
	Add 49% Departmental charges, Price Escalation, Unforeseen Adm.				11.23	
	Total Carry Over to Final Abstract of Cost				34.16	Laes
Sub Work VI		Horticulture				
S. No.	Description	Unit	Qty	Rate	Amount (in Laes)	
1	Development of lawn area					
a	Trenching the ordinary soil upto depth of 60 cm including removal & packing of serviceable material & disposing at a lead of 50 M and making up the trenched area to proper level by filling with earth mixed with manure before & after flooding trench with water including cost of imported earth & manure.					
b	Rough dressing of trenched area.					
c	Grassing including watering & maintenance of lawns free from weeds & fly for mowing in rows including hedges, shrubs & green belts (as per HUDA Norms)					
	0.678 acres @ Rs. 1.50 laes / acre	Acre	0.678	2,00,000 150,000	102 1.36	
2	Provision of trees, guards and planting trees along road at 12M intervals. (900 42-35 x 2 = 180 Nos.) = 180 Nos.	Nos.	180	1800	270 3.24	
				Total	372 4.60	
	Add 3% contingencies and PE Charges				11 0.14	
				Total	383 4.74	
	Add 49% Departmental charges, Price Escalation, Unforeseen Adm.				188 2.32	
	Total Carry Over to Final Abstract of Cost			Total	570 7.06	Laes
Sub Work VII		Maintenance Charges & Resurfacing of Roads				
S. No.	Description	Unit	Qty	Rate	Amount (in Laes)	
1	Provision for maintenance charges for water supply, sewerage, storm water drainage, roads, street light, horticulture etc. complete including operation & establishments charges as per HUDA norms after completion & resurfacing of roads after 10 years or 1st phase.					
	8.903 acres @ 8 laes per acre	Per Acre	8.903	800000	71.22	
2	Provision for resurfacing & strengthening of road after five years of 1st phase with 50mm BM & 30mm BC	Sq. mtr.	5447	660	35.95	
3	Provision for resurfacing & strengthening of road after ten years of 2 nd phase with 50mm BM & 30mm BC	Sq. mtr.	5447	825	44.94	
				Total	152.11	
	Add 3% contingency & PE charges				4.56	
				Total	156.68	
	Add 49% Departmental charges, Price Escalation, Unforeseen Adm.				76.77	
	Total Carry Over to Final Abstract of Cost			Total	233.45	Laes



Rohit

ROHIT DABAS
Architect, Urban Planner
B.Arch. M.Plan (IIT Roorkee)
CA/2016/78810
AITP/2019-029

PALM ABODES BUILDCON PVT. LTD.

Raven
Auth. Signatory

**PROJECT :- PROPOSED SITE FOR D.D.J.A.Y AFFORDABLE
PLOTTED COLONY OVER AN AREA OF 8.903 ACRES FALLING
IN THE REVENUE ESTATE OF VILLAGE PAHRAWAR, SECTOR
25 D, TEHSIL & DISTRICT - ROHTAK.**

MATERIAL STATEMENT (DOMESTIC WATER SUPPLY)			
Node		Dia in MM	Length
From	To		Mtr.
U.G.T	D1	100	15.0
D1	D2	100	14.0
D2	D3	100	65.0
D3	D4	100	110.0
D3	D5	100	60.0
D5	D6	100	65.0
D6	D7	100	45.0
D6	D8	100	40.0
D8	D9	100	45.0
D5	D10	100	130.0
D10	D11	100	60.0
D10	D12	100	50.0
D12	D13	100	60.0
D12	D14	100	45.0
D14	D15	100	100.0
D14	D16	100	15.0
D2	D12	100	45.0
TOTAL			964.0



Rohit
ROHIT DABAS
 Architect, Urban Planner
 B.Arch. M.Plan (IIT Roorkee)
 CA/2018/76810
 AITP/2019-029

PALM ABODES BUILDCON PVT. LTD.

Ranvir
 Auth. Signatory

PROJECT :- PROPOSED SITE FOR D.D.J.A.Y AFFORDABLE
 PLOTTED COLONY OVER AN AREA OF 8.903 ACRES FALLING
 IN THE REVENUE ESTATE OF VILLAGE PAHRAWAR, SECTOR -
 25 D, TEHSIL & DISTRICT - ROHTAK.

MATERIAL STATEMENT (FLUSHING WATER SUPPLY)

Node		Dia in MM	Length
From	To		Mtr
S.T.P	F1	100	10.0
F1	F2	100	5.0
F2	F3	100	15.0
F3	F4	100	110.0
F3	F12	100	100.0
F2	F5	100	45.0
F5	F6	100	70.0
F6	F7	100	45.0
F6	F8	100	45.0
F8	F9	100	45.0
F5	F10	100	130.0
F10	F11	100	60.0
F12	F10	100	50.0
F12	F13	100	60.0
F12	F14	100	45.0
F14	F15	100	100.0
F14	F16	100	15.0
TOTAL			950.0



Rohit
ROHIT DABAS
 Architect, Urban Planner
 B.Arch. M.Plan (IIT Roorkee)
 CA/2016/76810
 AITP/2019-029

PALM ABODES BUILDCON PVT. LTD.

Ram
 Auth. Signatory

PROJECT :- PROPOSED SITE FOR D.D.J.A.Y AFFORDABLE PLOTTED COLONY
OVER AN AREA OF 8.903 ACRES FALLING IN THE REVENUE ESTATE OF
VILLAGE PAHRAWAR, SECTOR -25 D, TEHSHIL & DISTRICT - ROHTAK.

MATERIAL STATEMENT (GARDENT HYDANRAT)

Node		Dia in MM	Length	Length in Mtr.	
From	To		Mtr	25 mm	32 mm
GH-1	GH-2	25	35.0	35.0	0.0
GH-2	A	32	35.0	0.0	35.0
GH-3	GH-4	25	15.0	15.0	0.0
GH-4	B	32	20.0	0.0	20.0
TOTAL			105.0	50.0	55.0



Roht
ROHIT DABAS
Architect, Urban Planner
B.Arch. M.Planning (IIT Roorkee)
CA/2016/76810
AITP/2019-029

PALM ABODES BUILDCON PVT. LTD.

Raven
Auth. Signatory

PROJECT :- PROPOSED SITE FOR D.D.J.A.Y AFFORDABLE
PLOTTED COLONY OVER AN AREA OF 8.903 ACRES FALLING
IN THE REVENUE ESTATE OF VILLAGE PAHRAWAR, SECTOR -
25 D, TEHSIHL & DISTRICT - ROHTAK.

MATERIAL STATEMENT (SEWERAGE SCHEME)

Node		Diameter	Length of Pipe	Pipe Qty.
From	To	mm	mtrs.	200 dia
S1	S2	200	14.0	14.0
S2	S3	200	16.0	16.0
S3	S4	200	16.0	16.0
S4	S5	200	15.0	15.0
S5	S6	200	18.0	18.0
S6	S7	200	16.0	16.0
S7	S8	200	16.0	16.0
S8	S9	200	16.0	16.0
S9	S10	200	16.0	16.0
S10	S11	200	9.0	9.0
S11	S12	200	19.0	19.0
S14	S15	200	12.0	12.0
S15	S16	200	14.0	14.0
S16	S17	200	16.0	16.0
S17	S18	200	23.0	23.0
S18	S19	200	15.0	15.0
S20	S21	200	13.0	13.0
S21	S22	200	15.0	15.0
S22	S19	200	17.0	17.0
S19	S23	200	16.0	16.0
S23	S24	200	16.0	16.0
S24	S25	200	16.0	16.0
S25	S12	200	17.0	17.0
S12	S13	200	21.0	21.0
S26	S27	200	13.0	13.0
S27	S28	200	16.0	16.0
S28	S29	200	16.0	16.0
S29	S30	200	16.0	16.0
S30	S31	200	16.0	16.0
S31	S32	200	18.0	18.0
S33	S32	200	17.0	17.0
S32	S34	200	19.0	19.0
S34	S35	200	24.0	24.0
S36	S37	200	14.0	14.0
S37	S38	200	16.0	16.0
S38	S39	200	16.0	16.0
S39	S35	200	23.0	23.0
S35	S40	200	18.0	18.0
S40	S41	200	16.0	16.0
S41	S42	200	17.0	17.0
S42	S43	200	16.0	16.0
S43	S44	200	24.0	24.0
S45	S46	200	13.0	13.0
S46	S47	200	16.0	16.0
S47	S48	200	16.0	16.0
S48	S49	200	15.0	15.0
S49	S50	200	16.0	16.0
S50	S51	200	16.0	16.0
S51	S44	200	18.0	18.0
S44	S13	200	19.0	19.0
S13	S.T.P	200	5.0	5.0
TOTAL				831.0



Rohtak

ROHIT DABAS
Architect, Urban Planner
B.Arch. M.Plan (IIT Roorkee)
CA/2016/76810
AITP/2019-029

PALM ABODES BUILDCON PVT. LTD.

Raman
Auth. Signatory

PROJECT :- PROPOSED SITE FOR D.D.J.A.Y AFFORDABLE
PLOTTED COLONY OVER AN AREA OF 8.903 ACRES FALLING
IN THE REVENUE ESTATE OF VILLAGE PAHRAWAR, SECTOR -
25 D, TEHSIL & DISTRICT - ROHTAK.

MATERIAL STATEMENT (STORM WATER DRAIN)

Node		Diameter	Length of Pipe	Pipe Qty.
From	To	mm	mtrs.	400 dia
D1	D2	400	13.0	13.0
D2	D3	400	14.0	14.0
D3	D4	400	22.0	22.0
D4	D5	400	25.0	25.0
D5	D6	400	14.0	14.0
D22	D23	400	14.0	14.0
D23	D24	400	15.0	15.0
D24	D6	400	21.0	21.0
D6	D7	400	17.0	17.0
D7	D8	400	16.0	16.0
D8	D9	400	16.0	16.0
D9	D10	400	16.0	16.0
D10	RW-1	400	10.0	10.0
D10	D11	400	19.0	19.0
D11	D12	400	11.0	11.0
D12	D13	400	14.0	14.0
D13	D14	400	17.0	17.0
D14	D15	400	17.0	17.0
D15	D16	400	15.0	15.0
D16	RW-2	400	14.0	14.0
D16	D17	400	20.0	20.0
D17	D18	400	15.0	15.0
D18	D19	400	16.0	16.0
D19	D20	400	16.0	16.0
D20	D21	400	17.0	17.0
D21	RW-4	400	45.0	45.0
D25	D26	400	16.0	16.0
D26	D27	400	16.0	16.0
D27	D28	400	15.0	15.0
D28	D29	400	13.0	13.0
D29	D30	400	16.0	16.0
D30	D31	400	16.0	16.0
D31	D32	400	12.0	12.0
D32	D33	400	10.0	10.0
D33	D34	400	18.0	18.0
D34	RW-3	400	12.0	12.0
D34	D35	400	16.0	16.0
D35	D36	400	16.0	16.0
D36	D37	400	16.0	16.0
D37	D38	400	24.0	24.0
D39	D40	400	9.0	9.0
D40	D41	400	15.0	15.0
D41	D42	400	16.0	16.0
D42	D43	400	16.0	16.0
D43	D44	400	16.0	16.0
D44	D45	400	17.0	17.0
D45	D47	400	10.0	10.0
D46	D47	400	20.0	20.0
D47	D48	400	17.0	17.0
D48	D38	400	18.0	18.0
D38	D49	400	17.0	17.0
D49	D50	400	16.0	16.0
D50	D51	400	16.0	16.0
D51	RW-4	400	5.0	5.0
RW-4	O FLOW	400	5.0	5.0
TOTAL				878.0



Rohit

ROHIT DABAS
Architect, Urban Planner
B.Arch. M.Plan (IIT Roorkee)
CA/2016/76810
AITP/2019-029

PALM ABODES BUILDCON PVT. LTD.

Ravi
Auth. Signatory

PROJECT :- PROPOSED SITE FOR D.D.J.A.Y AFFORDABLE PLOTTED COLONY OVER AN AREA OF 8.903 ACRES FALLING IN THE REVENUE ESTATE OF VILLAGE PAHRAWAR, SECTOR -25 D, TEHSHIL & DISTRICT - ROHTAK.

Sub Work IV					Road Work
MATERIAL STATEMENT (ROAD WORK)					
TAG	LENGTH (M)	WIDTH (M)	DRIVE WAY (M)	AREA	UNIT
R1	42.74	9	5.5	235.07	SQM.
R2	52.81	9	5.5	290.455	SQM.
R3	115.14	9	5.5	633.27	SQM.
R4	25.16	12.864	5.5	138.38	SQM.
R5	74.6	10	5.5	410.3	SQM.
R6	142.49	9	5.5	783.695	SQM.
R7	65.14	9	5.5	358.27	SQM.
R8	65.14	9	5.5	358.27	SQM.
R9	89.44	9	5.5	491.92	SQM.
R10	25.13	9	5.5	138.215	SQM.
R11	150.64	9	5.5	828.52	SQM.
R12	51.97	10.601	5.5	285.835	SQM.
TOTAL	900.4			4952.2	SQM.
Add 10% for Curves	90.04			495.22	
	990.44			5447.42	SQM.
Say	990			5447	SQM.



Rohit
ROHIT DABAS
 Architect, Urban Planner
 B.Arch. M.Planning (IIT Roorkee)
 CA/2016/76810
 AITP/2019-029

PALM ABOODES BUILDCON PVT. LTD.

Rawn
 Auth. Signatory

ANNEXURE - 1

RAIN WATER HARVESTING PIT CALCULATION

S.No.	Description	Area (in sq mts)	Coefficient of run-off (As per NBC 2016 Part 9 Section 2 Drainage and Sanitation)	Peak rainfall intensity during one hour of rainfall (in mts) (as per Manual on norms and standards for environment clearance of large construction projects)	Rain water harvesting potential / hour (in m ³)	Unit
1	Roof-top area	15427.0	0.90	0.025	347.1	m ³
2	Paved podium areas and asphalted roads	17857.549	0.80	0.025	357.2	m ³
3	Lawns and parks	2744.561	0.15	0.025	10.3	m ³
TOTAL					714.6	m³
4	Considering 10 minutes retention time, total storm water load is				119.1	m ³
	Taking Length = 7.5 m, Width = 4m and effective depth as 1 m, volume of a RWII pit (LxBxH) is				30.0	m ³
6	Hence no. of pits required in approx = Total storm water load considering 10 minutes retention time / Volume of a RWII pit				3.97	Nos.
Say					4	Nos.



Rohit Dabas
ROHIT DABAS
 Architect, Urban Planner
 B.Arch. M.Plan (IIT Roorkee)
 CA/2016/76610
 AITP/2019-029

PALM ABODES BUILDCON PVT. LTD.

Ravi
 Auth. Signatory

PROJECT :- PROPOSED SITE FOR D.D.J.A.Y AFFORDABLE PLOTTED COLONY OVER AN AREA OF 8.903 ACRES FALLING IN THE REVENUE ESTATE OF VILLAGE PAHRAWAR, SECTOR -25 D, TEHSHIL & DISTRICT - ROHTAK.
(DOMESTIC WATER SUPPLY DESIGN CHART)

Sr.No	Line No		NO. OF PLOTS	POPULATION@ 18 Person/Plot	Water For Supply			Flow cum/day	Floor Finish Level		Length of Pipe (m)	Dia (mm)	Friction Loss	HGL		Head		Velocity (m/s)
	From	To			Self @ 100.91 Ltr/Person	Progressive	Total		Start	End				Start	End	Start	End	
1.	U.G.T	D1	0	0	0	281797	281797	281.80	-5.000	-1.000	15.0	100	0.058	40.00	39.94	45.00	40.94	0.8302
2.	D1	D2	0	0	0	261558.72	261558.72	261.56	-1.000	-1.000	14.0	100	0.047	39.94	39.90	40.94	40.90	0.7706
3.	D2	D3	7	126	12714.66	241578.54	254293.2	254.29	-1.000	-1.000	65.0	100	0.206	39.90	39.69	40.90	40.69	0.7492
4.	D3	D4	21	378	38143.98	0	38143.98	38.14	-1.000	-1.000	110.0	100	0.010	39.69	39.68	40.69	40.68	0.1124
5.	D3	D5	0	0	0	203434.56	203434.56	203.43	-1.000	-1.000	60.0	100	0.126	39.69	39.56	40.69	40.56	0.5993
6.	D5	D6	16	288	29062.08	43593.12	72655.2	72.66	-1.000	-1.000	65.0	100	0.020	39.56	39.54	40.56	40.54	0.2141
7.	D6	D7	12	216	21796.56	0	21796.56	21.80	-1.000	-1.000	45.0	100	0.002	39.54	39.54	40.54	40.54	0.0642
8.	D6	D8	0	0	0	21796.56	21796.56	21.80	-1.000	-1.000	40.0	100	0.001	39.54	39.54	40.54	40.54	0.0642
9.	D8	D9	12	216	21796.56	0	21796.56	21.80	-1.000	-1.000	45.0	100	0.002	39.54	39.54	40.54	40.54	0.0642
10.	D5	D10	18	324	32694.84	98084.52	130779.36	130.78	-1.000	-1.000	130.0	100	0.120	39.56	39.44	40.56	40.44	0.3853
11.	D10	D11	16	288	29062.08	0	29062.08	29.06	-1.000	-1.000	60.0	100	0.003	39.44	39.44	40.44	40.44	0.0856
12.	D10	D12	0	0	0	69022.44	69022.44	69.02	-1.000	-1.000	50.0	100	0.014	39.44	39.43	40.44	40.43	0.2033
13.	D12	D13	8	144	14531.04	0	14531.04	14.53	-1.000	-1.000	60.0	100	0.001	39.43	39.43	40.43	40.43	0.0428
14.	D12	D14	5	90	9081.9	45409.5	54491.4	54.49	-1.000	-1.000	45.0	100	0.008	39.43	39.42	40.43	40.42	0.1605
15.	D14	D15	23	414	41776.74	0	41776.74	41.78	-1.000	-1.000	100.0	100	0.011	39.42	39.41	40.42	40.41	0.1231
16.	D14	D16	2	36	3632.76	0	3632.76	3.63	-1.000	-1.000	15.0	100	0.000	39.42	39.42	40.42	40.42	0.0107
17.	D2	D12	4	72	7265.52	0	7265.52	7.27	-1.000	-1.000	45.0	100	0.000	39.90	39.90	40.90	40.90	0.0214

Rohit
ROHIT DABAS
 Architect, Urban Planner
 B.Arch. M.Plan (IIT Roorkee)
 CA/2016/76810
 AITP/2019-029



PALM ABODES BUILDCON PVT. LTD.
Ramya
 Auth. Signatory

PROJECT :- PROPOSED SITE FOR D.D.J.A.Y AFFORDABLE PLOTTED COLONY OVER AN AREA OF 8.903 ACRES FALLING IN THE REVENUE ESTATE OF VILLAGE PAHRAWAR, SECTOR -25 D, TEHSHIL & DISTRICT - ROHTAK.
(FLUSHING WATER SUPPLY DESIGN CHART)

Sr.No	Line No		NO. OF PLOTS	POPULATION @ 18 Person/Plot	Water For Supply			Flow cum/day	Floor Finish Level		Length of Pipe (m)	Dia (mm)	Friction Loss	HGL		Head		Velocity (m/s)
	From	To			Self @ 54.34 Ltr/Person	Progressive	Total		Start	End				Start	End	Start	End	
1.	S.T.P	F1	0	0	0	193492	193492	193.49	-5.000	-1.000	10.0	100	0.019	40.00	39.98	45.00	40.98	0.5701
2.	F1	F2	0	0	0	193492	193492	193.49	-1.000	-1.000	5.0	100	0.010	39.98	39.97	40.98	40.97	0.5701
3.	F2	F3	0	0	0	68468.4	68468.4	68.47	-1.000	-1.000	15.0	100	0.004	39.97	39.97	40.97	40.97	0.2017
4.	F3	F4	21	378	20540.52	0	20540.52	20.54	-1.000	-1.000	110.0	100	0.003	39.97	39.96	40.97	40.96	0.0605
5.	F3	F12	11	198	10759.32	37168.56	47927.88	47.93	-1.000	-1.000	100.0	100	0.014	39.97	39.95	40.97	40.95	0.1412
6.	F2	F5	0	0	0	72380.88	72380.88	72.38	-1.000	-1.000	45.0	100	0.014	39.97	39.96	40.97	40.96	0.2132
7.	F5	F6	16	288	15649.92	23474.88	39124.8	39.12	-1.000	-1.000	70.0	100	0.007	39.96	39.95	40.96	40.95	0.1153
8.	F6	F7	12	216	11737.44	0	11737.44	11.74	-1.000	-1.000	45.0	100	0.000	39.95	39.95	40.95	40.95	0.0346
9.	F6	F8	0	0	0	11737.44	11737.44	11.74	-1.000	-1.000	45.0	100	0.000	39.95	39.95	40.95	40.95	0.0346
10.	F8	F9	12	216	11737.44	0	11737.44	11.74	-1.000	-1.000	45.0	100	0.000	39.95	39.95	40.95	40.95	0.0346
11.	F5	F10	18	324	17606.16	15649.92	33256.08	33.26	-1.000	-1.000	130.0	100	0.010	39.96	39.95	40.96	40.95	0.0980
12.	F10	F11	16	288	15649.92	0	15649.92	15.65	-1.000	-1.000	60.0	100	0.001	39.95	39.95	40.95	40.95	0.0461
13.	F12	F10	0	0	0	0	0	0.00	-1.000	-1.000	50.0	100	0.000	39.95	39.95	40.95	40.95	0.0000
14.	F12	F13	8	144	7824.96	0	7824.96	7.82	-1.000	-1.000	60.0	100	0.000	39.95	39.95	40.95	40.95	0.0231
15.	F12	F14	5	90	4890.6	24453	29343.6	29.34	-1.000	-1.000	45.0	100	0.003	39.95	39.95	40.95	40.95	0.0865
16.	F14	F15	23	414	22496.76	0	22496.76	22.50	-1.000	-1.000	100.0	100	0.004	39.95	39.95	40.95	40.95	0.0663
17.	F14	F16	2	36	1956.24	0	1956.24	1.96	-1.000	-1.000	15.0	100	0.000	39.95	39.95	40.95	40.95	0.0058

Rohit
ROHIT DABAS
 Architect, Urban Planner
 B.Arch. M.Plan (IIT Roorkee)
 CA/2016/76610
 AITP/2019-029



PALM ABODES BUILDCON PVT. LTD.
Ravish
 Auth. Signatory

**PROJECT :- PROPOSED SITE FOR D.D.J.A.Y AFFORDABLE PLOTTED COLONY OVER AN AREA OF 8.903 ACRES FALLING IN THE REVENUE ESTATE OF VILLAGE PAHRAWAR, SECTOR -25 D, TEHSIL & DISTRICT - ROHTAK.
(DRAINAGE SYSTEM DESIGN CHART)**

S.No.	Line No.		Length	Catchment Area(Sqm)			Discharge (lps)	Pipe Dia	Slope(1 in)	Velocity(m/s)	Capacity of pipe	Fall(m)	Formation Level (m)		Invert Level(m)		Depth(m)		TYPE OF MANHOLE
	From	To		Self	Progg.	Total							Start	End	Start	End	Start	End	
1.	D1	D2	13.0	533.46	0.00	533.46	0.94	400	400	0.979	123.111	0.033	0.000	0.000	-1.100	-1.133	1.100	1.133	A
2.	D2	D3	14.0	574.50	533.46	1107.96	1.95	400	400	0.979	123.111	0.035	0.000	0.000	-1.133	-1.168	1.133	1.168	A
3.	D3	D4	22.0	902.78	1107.96	2010.74	3.55	400	400	0.979	123.111	0.055	0.000	0.000	-1.168	-1.223	1.168	1.223	A
4.	D4	D5	25.0	1025.89	2010.74	3036.62	5.36	400	400	0.979	123.111	0.063	0.000	0.000	-1.223	-1.285	1.223	1.285	A
5.	D5	D6	14.0	574.50	3036.62	3611.12	6.37	400	400	0.979	123.111	0.035	0.000	0.000	-1.285	-1.320	1.285	1.320	A
6.	D22	D23	14.0	574.50	0.00	574.50	1.01	400	400	0.979	123.111	0.035	0.000	0.000	-1.100	-1.135	1.100	1.135	A
7.	D23	D24	15.0	615.53	574.50	1190.03	2.10	400	400	0.979	123.111	0.038	0.000	0.000	-1.135	-1.173	1.135	1.173	A
8.	D24	D6	21.0	861.74	1190.03	2051.77	3.62	400	400	0.979	123.111	0.053	0.000	0.000	-1.173	-1.225	1.173	1.225	A
9.	D6	D7	17.0	697.60	5662.89	6360.49	11.22	400	400	0.979	123.111	0.043	0.000	0.000	-1.320	-1.363	1.320	1.363	A
10.	D7	D8	16.0	656.57	6360.49	7017.06	12.38	400	400	0.979	123.111	0.040	0.000	0.000	-1.363	-1.403	1.363	1.403	A
11.	D8	D9	16.0	656.57	7017.06	7673.63	13.54	400	400	0.979	123.111	0.040	0.000	0.000	-1.403	-1.443	1.403	1.443	A
12.	D9	D10	16.0	656.57	7673.63	8330.19	14.69	400	400	0.979	123.111	0.040	0.000	0.000	-1.443	-1.483	1.443	1.483	A
13.	D10	RW-1	10.0	410.35	8330.19	8740.55	15.42	400	400	0.979	123.111	0.025	0.000	0.000	-1.483	-1.508	1.483	1.508	A
14.	D10	D11	19.0	779.67	8330.19	9109.87	16.07	400	400	0.979	123.111	0.048	0.000	0.000	-1.100	-1.148	1.100	1.148	A
15.	D11	D12	11.0	451.39	9109.87	9561.26	16.86	400	400	0.979	123.111	0.028	0.000	0.000	-1.148	-1.175	1.148	1.175	A
16.	D12	D13	14.0	574.50	9561.26	10135.75	17.88	400	400	0.979	123.111	0.035	0.000	0.000	-1.175	-1.210	1.175	1.210	A
17.	D13	D14	17.0	697.60	10135.75	10833.35	19.11	400	400	0.979	123.111	0.043	0.000	0.000	-1.210	-1.253	1.210	1.253	A
18.	D14	D15	17.0	697.60	10833.35	11530.96	20.34	400	400	0.979	123.111	0.043	0.000	0.000	-1.253	-1.295	1.253	1.295	A
19.	D15	D16	15.0	615.53	11530.96	12146.49	21.43	400	400	0.979	123.111	0.038	0.000	0.000	-1.295	-1.333	1.295	1.333	A
20.	D16	RW-2	14.0	574.50	12146.49	12720.98	22.44	400	400	0.979	123.111	0.035	0.000	0.000	-1.333	-1.368	1.333	1.368	A
21.	D16	D17	20.0	820.71	12146.49	12967.20	22.87	400	400	0.979	123.111	0.050	0.000	0.000	-1.100	-1.150	1.100	1.150	A
22.	D17	D18	15.0	615.53	12967.20	13582.73	23.96	400	400	0.979	123.111	0.038	0.000	0.000	-1.150	-1.188	1.150	1.188	A
23.	D18	D19	16.0	656.57	13582.73	14239.30	25.12	400	400	0.979	123.111	0.040	0.000	0.000	-1.188	-1.228	1.188	1.228	A
24.	D19	D20	16.0	656.57	14239.30	14895.86	26.27	400	400	0.979	123.111	0.040	0.000	0.000	-1.228	-1.268	1.228	1.268	A
25.	D20	D21	17.0	697.60	14895.86	15593.46	27.51	400	400	0.979	123.111	0.043	0.000	0.000	-1.268	-1.310	1.268	1.310	A
26.	D21	RW-4	45.0	1846.59	15593.46	17440.06	30.76	400	400	0.979	123.111	0.113	0.000	0.000	-1.310	-1.423	1.310	1.423	A
27.	D25	D26	16.0	656.57	0.00	656.57	1.16	400	400	0.979	123.111	0.040	0.000	0.000	-1.100	-1.140	1.100	1.140	A
28.	D26	D27	16.0	656.57	656.57	1313.13	2.32	400	400	0.979	123.111	0.040	0.000	0.000	-1.140	-1.180	1.140	1.180	A
29.	D27	D28	15.0	615.53	1313.13	1928.67	3.40	400	400	0.979	123.111	0.038	0.000	0.000	-1.180	-1.218	1.180	1.218	A
30.	D28	D29	13.0	533.46	1928.67	2462.13	4.34	400	400	0.979	123.111	0.033	0.000	0.000	-1.218	-1.250	1.218	1.250	A
31.	D29	D30	16.0	656.57	2462.13	3118.69	5.50	400	400	0.979	123.111	0.040	0.000	0.000	-1.250	-1.290	1.250	1.290	A
32.	D30	D31	16.0	656.57	3118.69	3775.26	6.66	400	400	0.979	123.111	0.040	0.000	0.000	-1.290	-1.330	1.290	1.330	A
33.	D31	D32	12.0	492.43	3775.26	4267.69	7.53	400	400	0.979	123.111	0.030	0.000	0.000	-1.330	-1.360	1.330	1.360	A
34.	D32	D33	10.0	410.35	4267.69	4678.04	8.25	400	400	0.979	123.111	0.025	0.000	0.000	-1.360	-1.385	1.360	1.385	A
35.	D33	D34	18.0	738.64	4678.04	5416.68	9.55	400	400	0.979	123.111	0.045	0.000	0.000	-1.385	-1.430	1.385	1.430	A
36.	D34	RW-3	12.0	492.43	5416.68	5909.10	10.42	400	400	0.979	123.111	0.030	0.000	0.000	-1.430	-1.460	1.430	1.460	A
37.	D34	D35	16.0	656.57	5416.68	6073.24	10.71	400	400	0.979	123.111	0.040	0.000	0.000	-1.100	-1.140	1.100	1.140	A
38.	D35	D36	16.0	656.57	6073.24	6729.81	11.87	400	400	0.979	123.111	0.040	0.000	0.000	-1.140	-1.180	1.140	1.180	A
39.	D36	D37	16.0	656.57	6729.81	7386.38	13.03	400	400	0.979	123.111	0.040	0.000	0.000	-1.180	-1.220	1.180	1.220	A
40.	D37	D38	24.0	984.85	7386.38	8371.23	14.77	400	400	0.979	123.111	0.060	0.000	0.000	-1.220	-1.280	1.220	1.280	A
41.	D39	D40	9.0	369.32	0.00	369.32	0.65	400	400	0.979	123.111	0.023	0.000	0.000	-1.100	-1.123	1.100	1.123	A
42.	D40	D41	15.0	615.53	369.32	984.85	1.74	400	400	0.979	123.111	0.038	0.000	0.000	-1.123	-1.160	1.123	1.160	A
43.	D41	D42	16.0	656.57	984.85	1641.42	2.90	400	400	0.979	123.111	0.040	0.000	0.000	-1.160	-1.200	1.160	1.200	A
44.	D42	D43	16.0	656.57	1641.42	2297.98	4.05	400	400	0.979	123.111	0.040	0.000	0.000	-1.200	-1.240	1.200	1.240	A
45.	D43	D44	16.0	656.57	2297.98	2954.55	5.21	400	400	0.979	123.111	0.040	0.000	0.000	-1.240	-1.280	1.240	1.280	A
46.	D44	D45	17.0	697.60	2954.55	3652.15	6.44	400	400	0.979	123.111	0.043	0.000	0.000	-1.280	-1.323	1.280	1.323	A
47.	D45	D47	10.0	410.35	3652.15	4062.51	7.17	400	400	0.979	123.111	0.025	0.000	0.000	-1.323	-1.348	1.323	1.348	A
48.	D46	D47	20.0	820.71	0.00	820.71	1.45	400	400	0.979	123.111	0.050	0.000	0.000	-1.100	-1.150	1.100	1.150	A
49.	D47	D48	17.0	697.60	4883.22	5580.82	9.84	400	400	0.979	123.111	0.043	0.000	0.000	-1.348	-1.390	1.348	1.390	A
50.	D48	D38	18.0	738.64	5580.82	6319.46	11.15	400	400	0.979	123.111	0.045	0.000	0.000	-1.390	-1.435	1.390	1.435	A
51.	D38	D49	17.0	697.60	14690.68	15388.29	27.14	400	400	0.979	123.111	0.043	0.000	0.000	-1.435	-1.478	1.435	1.478	A
52.	D49	D50	16.0	656.57	15388.29	16044.85	28.30	400	400	0.979	123.111	0.040	0.000	0.000	-1.478	-1.518	1.478	1.518	A
53.	D50	D51	16.0	656.57	16044.85	16701.42	29.46	400	400	0.979	123.111	0.040	0.000	0.000	-1.518	-1.558	1.518	1.558	A
54.	D51	RW-4	5.0	205.18	16701.42	16906.60	29.82	400	400	0.979	123.111	0.013	0.000	0.000	-1.558	-1.570	1.558	1.570	A
55.	RW-4	O FLOW	5.0	205.18	34346.66	36029.11	63.55	400	400	0.979	123.111	0.013	0.000	-0.600	-1.100	-1.113	1.100	0.513	A

ROHIT DABAS
Architect, Urban Planner
B.Arch. M.Plan (IIT Roorkee)
CA/2016/76810
AITP/2019-029



PALM ABODES BUILDCON PVT. LTD.
Auth. Signatory

PROJECT :- PROPOSED SITE FOR D.D.J.A.Y AFFORDABLE PLOTTED COLONY OVER AN AREA OF 8.903 ACRES FALLING IN THE REVENUE ESTATE OF VILLAGE PAHRAWAR, SECTOR -25 D, TEHSHIL & DISTRICT - ROHTAK. (SEWERAGE SYSTEM DESIGN CHART)

S.NO.	LINE		LENGTH	PLOT			POPULATION @18 PERSON PER PLOT	SEWAGE FLOW @ 135 LPCD(LPD)	PEAK FLOW(LPD) @ 3 TIMES AVERAGE FLOW	INFILTRATION @5000 LITERS/KM/ DAY	PEAK DESIGN FLOW "Q"		PIPE SIZE(MM)	SLOPE(1 IN)MM	VFULL(M/S)	QFULL (LPS)	Q/Q	VA/V	ACTUAL VELOCITY(VA)	D/D	FORMATION LEVEL(M)		FALL(M)	INVERT LEVEL(M)		DEPTH(M)		TYPE OF MANHOLE
	FROM	TO		SELF	PREV.	TOTAL					LPD	(LPS)									START	END		START	END	START	END	
1	S1	S2	14.0	2	0.0	2.0	36.0	4860.0	14580.0	70.0	14650.0	0.170	200	195	0.884	27.77	0.006	0.353	0.312	0.078	0.000	0.000	0.072	-1.100	-1.172	1.100	1.172	A
2	S2	S3	16.0	4	2.0	6.0	108.0	14580.0	43740.0	80.0	43820.0	0.507	200	195	0.884	27.77	0.018	0.391	0.346	0.095	0.000	0.000	0.082	-1.172	-1.254	1.172	1.254	A
3	S3	S4	16.0	4	6.0	10.0	180.0	24300.0	72900.0	80.0	72980.0	0.845	200	195	0.884	27.77	0.030	0.430	0.380	0.113	0.000	0.000	0.082	-1.254	-1.336	1.254	1.336	A
4	S4	S5	15.0	4	10.0	14.0	252.0	34020.0	102060.0	75.0	102135.0	1.182	200	195	0.884	27.77	0.043	0.471	0.416	0.133	0.000	0.000	0.077	-1.336	-1.413	1.336	1.413	A
5	S5	S6	18.0	2	14.0	16.0	288.0	38880.0	116640.0	90.0	116730.0	1.351	200	195	0.884	27.77	0.049	0.490	0.433	0.142	0.000	0.000	0.092	-1.413	-1.505	1.413	1.505	A
6	S6	S7	16.0	2	16.0	18.0	324.0	43740.0	131220.0	80.0	131300.0	1.520	200	195	0.884	27.77	0.055	0.510	0.450	0.151	0.000	0.000	0.082	-1.505	-1.587	1.505	1.587	A
7	S7	S8	16.0	4	18.0	22.0	396.0	53460.0	160380.0	80.0	160460.0	1.857	200	195	0.884	27.77	0.067	0.548	0.484	0.169	0.000	0.000	0.082	-1.587	-1.669	1.587	1.669	A
8	S8	S9	16.0	4	22.0	26.0	468.0	63180.0	189540.0	80.0	189620.0	2.195	200	195	0.884	27.77	0.079	0.586	0.518	0.187	0.000	0.000	0.082	-1.669	-1.751	1.669	1.751	A
9	S9	S10	16.0	4	26.0	30.0	540.0	72900.0	218700.0	80.0	218780.0	2.532	200	195	0.884	27.77	0.091	0.619	0.547	0.203	0.000	0.000	0.082	-1.751	-1.833	1.751	1.833	B
10	S10	S11	9.0	2	30.0	32.0	576.0	77760.0	233280.0	45.0	233325.0	2.701	200	195	0.884	27.77	0.097	0.628	0.555	0.208	0.000	0.000	0.046	-1.833	-1.879	1.833	1.879	B
11	S11	S12	19.0	2	32.0	34.0	612.0	82620.0	247860.0	95.0	247955.0	2.870	200	195	0.884	27.77	0.103	0.637	0.563	0.214	0.000	0.000	0.097	-1.879	-1.977	1.879	1.977	B
12	S14	S15	12.0	2	0.0	2.0	36.0	4860.0	14580.0	60.0	14640.0	0.169	200	195	0.884	27.77	0.006	0.353	0.312	0.078	0.000	0.000	0.062	-1.100	-1.162	1.100	1.162	A
13	S15	S16	14.0	4	2.0	6.0	108.0	14580.0	43740.0	70.0	43810.0	0.507	200	195	0.884	27.77	0.018	0.391	0.346	0.095	0.000	0.000	0.072	-1.162	-1.233	1.162	1.233	A
14	S16	S17	16.0	4	6.0	10.0	180.0	24300.0	72900.0	80.0	72980.0	0.845	200	195	0.884	27.77	0.030	0.430	0.380	0.113	0.000	0.000	0.082	-1.233	-1.315	1.233	1.315	A
15	S17	S18	23.0	2	10.0	12.0	216.0	29160.0	87480.0	115.0	87595.0	1.014	200	195	0.884	27.77	0.037	0.452	0.399	0.124	0.000	0.000	0.118	-1.315	-1.433	1.315	1.433	A
16	S18	S19	15.0	1	12.0	13.0	234.0	31590.0	94770.0	75.0	94845.0	1.098	200	195	0.884	27.77	0.040	0.462	0.408	0.128	0.000	0.000	0.077	-1.433	-1.510	1.433	1.510	A
17	S20	S21	13.0	2	0.0	2.0	36.0	4860.0	14580.0	65.0	14645.0	0.170	200	195	0.884	27.77	0.006	0.353	0.312	0.078	0.000	0.000	0.067	-1.100	-1.167	1.100	1.167	A
18	S21	S22	15.0	4	2.0	6.0	108.0	14580.0	43740.0	75.0	43815.0	0.507	200	195	0.884	27.77	0.018	0.391	0.346	0.095	0.000	0.000	0.077	-1.167	-1.244	1.167	1.244	A
19	S22	S19	17.0	4	6.0	10.0	180.0	24300.0	72900.0	85.0	72985.0	0.845	200	195	0.884	27.77	0.030	0.430	0.380	0.113	0.000	0.000	0.087	-1.244	-1.331	1.244	1.331	A
20	S19	S23	16.0	3	23.0	26.0	468.0	63180.0	189540.0	80.0	189620.0	2.195	200	195	0.884	27.77	0.079	0.586	0.518	0.187	0.000	0.000	0.082	-1.510	-1.592	1.510	1.592	A
21	S23	S24	16.0	4	26.0	30.0	540.0	72900.0	218700.0	80.0	218780.0	2.532	200	195	0.884	27.77	0.091	0.619	0.547	0.203	0.000	0.000	0.082	-1.592	-1.674	1.592	1.674	A
22	S24	S25	16.0	4	30.0	34.0	612.0	82620.0	247860.0	80.0	247940.0	2.870	200	195	0.884	27.77	0.103	0.637	0.563	0.214	0.000	0.000	0.082	-1.674	-1.756	1.674	1.756	B
23	S25	S12	17.0	4	34.0	38.0	684.0	92340.0	277020.0	85.0	277105.0	3.207	200	195	0.884	27.77	0.115	0.655	0.579	0.225	0.000	0.000	0.087	-1.756	-1.844	1.756	1.844	B
24	S12	S13	21.0	2	72.0	74.0	1332.0	179820.0	539460.0	105.0	539565.0	6.245	200	195	0.884	27.77	0.225	0.802	0.709	0.321	0.000	0.000	0.108	-1.977	-2.085	1.977	2.085	B
25	S26	S27	13.0	1	0.0	1.0	18.0	2430.0	7290.0	65.0	7355.0	0.085	200	195	0.884	27.77	0.003	0.344	0.304	0.073	0.000	0.000	0.067	-1.100	-1.167	1.100	1.167	A
26	S27	S28	16.0	4	1.0	5.0	90.0	12150.0	36450.0	80.0	36530.0	0.423	200	195	0.884	27.77	0.015	0.382	0.337	0.091	0.000	0.000	0.082	-1.167	-1.249	1.167	1.249	A
27	S28	S29	16.0	4	5.0	9.0	162.0	21870.0	65610.0	80.0	65690.0	0.760	200	195	0.884	27.77	0.027	0.420	0.371	0.109	0.000	0.000	0.082	-1.249	-1.331	1.249	1.331	A
28	S29	S30	16.0	4	9.0	13.0	234.0	31590.0	94770.0	80.0	94850.0	1.098	200	195	0.884	27.77	0.040	0.462	0.408	0.128	0.000	0.000	0.082	-1.331	-1.413	1.331	1.413	A
29	S30	S31	16.0	4	13.0	17.0	306.0	41310.0	123930.0	80.0	124010.0	1.435	200	195	0.884	27.77	0.052	0.500	0.442	0.146	0.000	0.000	0.082	-1.413	-1.495	1.413	1.495	A
30	S31	S32	18.0	4	17.0	21.0	378.0	51030.0	153090.0	90.0	153180.0	1.773	200	195	0.884	27.77	0.064	0.538	0.476	0.164	0.000	0.000	0.092	-1.495	-1.587	1.495	1.587	A
31	S33	S32	17.0	2	0.0	2.0	36.0	4860.0	14580.0	85.0	14665.0	0.170	200	195	0.884	27.77	0.006	0.353	0.312	0.078	0.000	0.000	0.087	-1.100	-1.187	1.100	1.187	A
32	S32	S34	19.0	4	23.0	27.0	486.0	65610.0	196830.0	95.0	196925.0	2.279	200	195	0.884	27.77	0.082	0.596	0.526	0.191	0.000	0.000	0.097	-1.587	-1.685	1.587	1.685	A
33	S34	S35	24.0	2	27.0	29.0	522.0	70470.0	211410.0	120.0	211530.0	2.448	200	195	0.884	27.77	0.088	0.615	0.543	0.200	0.000	0.000	0.123	-1.685	-1.808	1.685	1.808	B
34	S36	S37	14.0	1	0.0	1.0	18.0	2430.0	7290.0	70.0	7360.0	0.085	200	195	0.884	27.77	0.003	0.344	0.304	0.073	0.000	0.000	0.072	-1.100	-1.172	1.100	1.172	A
35	S37	S38	16.0	2	1.0	3.0	54.0	7290.0	21870.0	80.0	21950.0	0.254	200	195	0.884	27.77	0.009	0.363	0.320	0.082	0.000	0.000	0.082	-1.172	-1.254	1.172	1.254	A
36	S38	S39	16.0	2	3.0	5.0	90.0	12150.0	36450.0	80.0	36530.0	0.423	200	195	0.884	27.77	0.015	0.382	0.337	0.091	0.000	0.000	0.082	-1.254	-1.336	1.254	1.336	A
37	S39	S35	23.0	2	5.0	7.0	126.0	17010.0	51030.0	115.0	51145.0	0.592	200	195	0.884	27.77	0.021	0.401	0.354	0.100	0.000	0.000	0.118	-1.336	-1.454	1.336	1.454	A
38	S35	S40	18.0	3	36.0	39.0	702.0	94770.0	284310.0	90.0	284400.0	3.292	200	195	0.884	27.77	0.119	0.661	0.584	0.229	0.000	0.000	0.092	-1.808	-1.900	1.808	1.900	B
39	S40	S41	16.0	2	39.0	41.0	738.0	99630.0	298890.0	80.0	298970.0	3.460	200	195	0.884	27.77	0.125	0.670	0.592	0.234	0.000	0.000	0.082	-1.900	-1.982	1.900	1.982	B
40	S41	S42	17.0	2	41.0	43.0	774.0	104490.0	313470.0	85.0	313555.0	3.629	200	195	0.884	27.77	0.131	0.679	0.600	0.240	0.000	0.000	0.087	-1.982	-2.069	1.982	2.069	B
41	S42	S43	16.0	2	43.0	45.0	810.0	109350.0	328050.0	80.0	328130.0	3.798	200	195	0.884	27.77	0.137	0.688	0.608	0.245	0.000	0.000	0.082	-2.069	-2.151	2.069	2.151	B
42	S43	S44	24.0	2	45.0	47.0	846.0	114210.0	342630.0	120.0	342750.0	3.967	200	195	0.884	27.77	0.143	0.697	0.616	0.251	0.000	0.000	0.123	-2.151	-2.274	2.151	2.274	B
43	S45	S46	13.0	2	0.0	2.0	36.0	4860.0	14580.0	65.0	14645.0	0.170	200	195	0.884	27.77	0.006	0.353	0.312	0.078	0.000	0.000	0.067	-1.100	-1.167	1.100	1.167	A

Checked subject to comments in forwarding letter No. 213294 D. 21/12/2022 and notes attached with the clearance

of 2022 dated 21/10/2022. This layout plan for an area measuring 8.903 acres (3.763 acres) of revenue land is proposed to be developed for residential purposes. The site is situated in the revenue estate of Village Bahrawar, Sector-25D, Tehsil & District - Rorhtak, Haryana. The layout plan is hereby approved subject to the following conditions:-

1. That the layout plan shall be made in conformance with the detailed approved layout plan as per the agreement entered into under Rule 11 and the bye-laws in force.
2. That the plot area of the colony shall not exceed 5% of the total area of the colony. The minimum area reserved for amenity purposes shall be as per the provisions of the bye-laws in force. The area reserved for amenity purposes shall be as per the provisions of the bye-laws in force.
3. That the construction of the colony shall be completed within the stipulated time frame. The construction of the colony shall be completed within the stipulated time frame.
4. The layout plan shall be approved by the Director General, Town & Country Planning, Haryana, Chandigarh. The layout plan shall be approved by the Director General, Town & Country Planning, Haryana, Chandigarh.
5. That the revenue land falling in the colony shall be first topographically surveyed as shown in the layout plan.
6. The construction shall be made by the developer in accordance with the bye-laws and all necessary clearances shall be obtained from the concerned authorities. The construction shall be made by the developer in accordance with the bye-laws and all necessary clearances shall be obtained from the concerned authorities.
7. That the proportion of the area reserved for amenity purposes shall be as per the provisions of the bye-laws in force. The proportion of the area reserved for amenity purposes shall be as per the provisions of the bye-laws in force.
8. The developer shall provide the water supply to the colony. The developer shall provide the water supply to the colony.
9. At the time of construction, the required percentage of approved area shall be reserved for amenity purposes. The required percentage of approved area shall be reserved for amenity purposes.
10. The developer shall provide the water supply to the colony. The developer shall provide the water supply to the colony.
11. Any area reserved above the permissible 4% under commercial use shall be permitted to be used for other purposes. Any area reserved above the permissible 4% under commercial use shall be permitted to be used for other purposes.
12. The layout plan shall be approved by the Director General, Town & Country Planning, Haryana, Chandigarh. The layout plan shall be approved by the Director General, Town & Country Planning, Haryana, Chandigarh.
13. The layout plan shall be approved by the Director General, Town & Country Planning, Haryana, Chandigarh. The layout plan shall be approved by the Director General, Town & Country Planning, Haryana, Chandigarh.
14. That the layout plan shall be approved by the Director General, Town & Country Planning, Haryana, Chandigarh. The layout plan shall be approved by the Director General, Town & Country Planning, Haryana, Chandigarh.
15. That the layout plan shall be approved by the Director General, Town & Country Planning, Haryana, Chandigarh. The layout plan shall be approved by the Director General, Town & Country Planning, Haryana, Chandigarh.
16. That the developer shall provide the water supply to the colony. The developer shall provide the water supply to the colony.
17. That the developer shall provide the water supply to the colony. The developer shall provide the water supply to the colony.
18. That the developer shall provide the water supply to the colony. The developer shall provide the water supply to the colony.

19. That the developer shall provide the water supply to the colony. The developer shall provide the water supply to the colony.

20. That the developer shall provide the water supply to the colony. The developer shall provide the water supply to the colony.

21. That the developer shall provide the water supply to the colony. The developer shall provide the water supply to the colony.

22. That the developer shall provide the water supply to the colony. The developer shall provide the water supply to the colony.

23. That the developer shall provide the water supply to the colony. The developer shall provide the water supply to the colony.

24. That the developer shall provide the water supply to the colony. The developer shall provide the water supply to the colony.

25. That the developer shall provide the water supply to the colony. The developer shall provide the water supply to the colony.

26. That the developer shall provide the water supply to the colony. The developer shall provide the water supply to the colony.

27. That the developer shall provide the water supply to the colony. The developer shall provide the water supply to the colony.

28. That the developer shall provide the water supply to the colony. The developer shall provide the water supply to the colony.

29. That the developer shall provide the water supply to the colony. The developer shall provide the water supply to the colony.

30. That the developer shall provide the water supply to the colony. The developer shall provide the water supply to the colony.

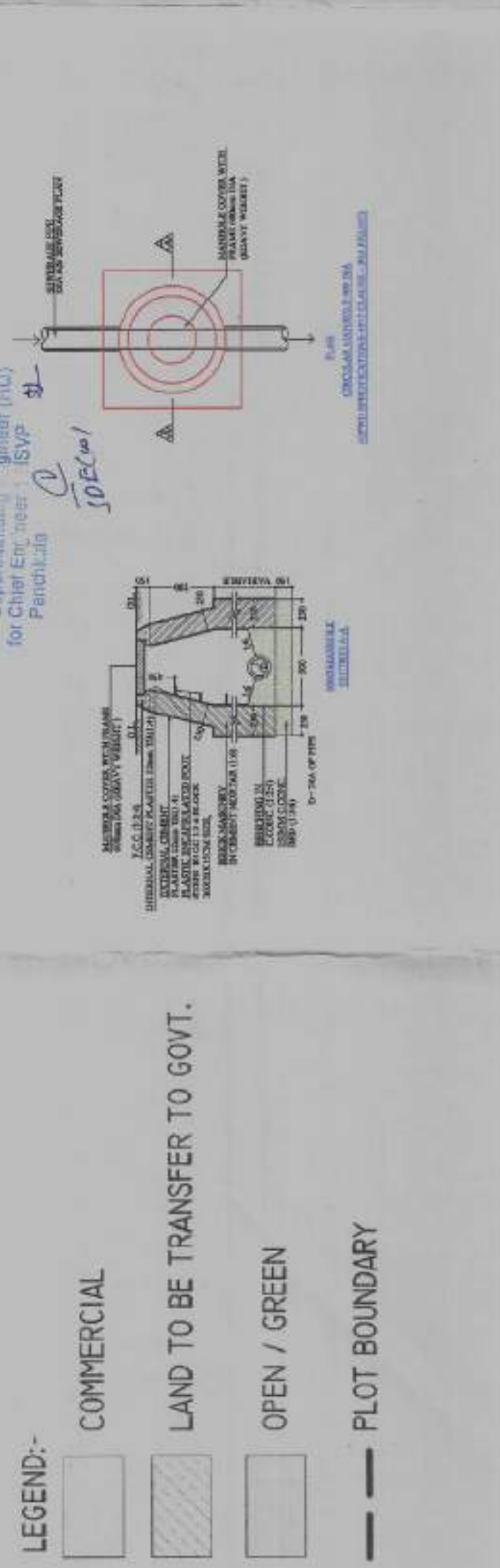

TOTAL AREA OF LAND 8.903 ACRES (6029.11 SQ.MT.)		PERMISSIBLE		PROPOSED	
S.NO.	DESCRIPTION	AREA ACRES	PERCENTAGE %	AREA ACRES	PERCENTAGE %
1	OPEN / GREEN SPACE (7.5 %)	0.668	7.500	0.678	7.618
2	10% FACILITY AREA TO BE TRANSFERRED FREE OF COST TO THE GOVT.	0.890	10.000	0.890	10.000
3	COMMERCIAL AREA	0.356	4.000	0.356	4.000
4	AREA UNDER PLOTS	5.431	61.000	4.727	53.091
5	TOTAL AREA	5.787	65.000	5.083	57.091
6	DENSITY	240 - 400 PPA		20569.400	291.139

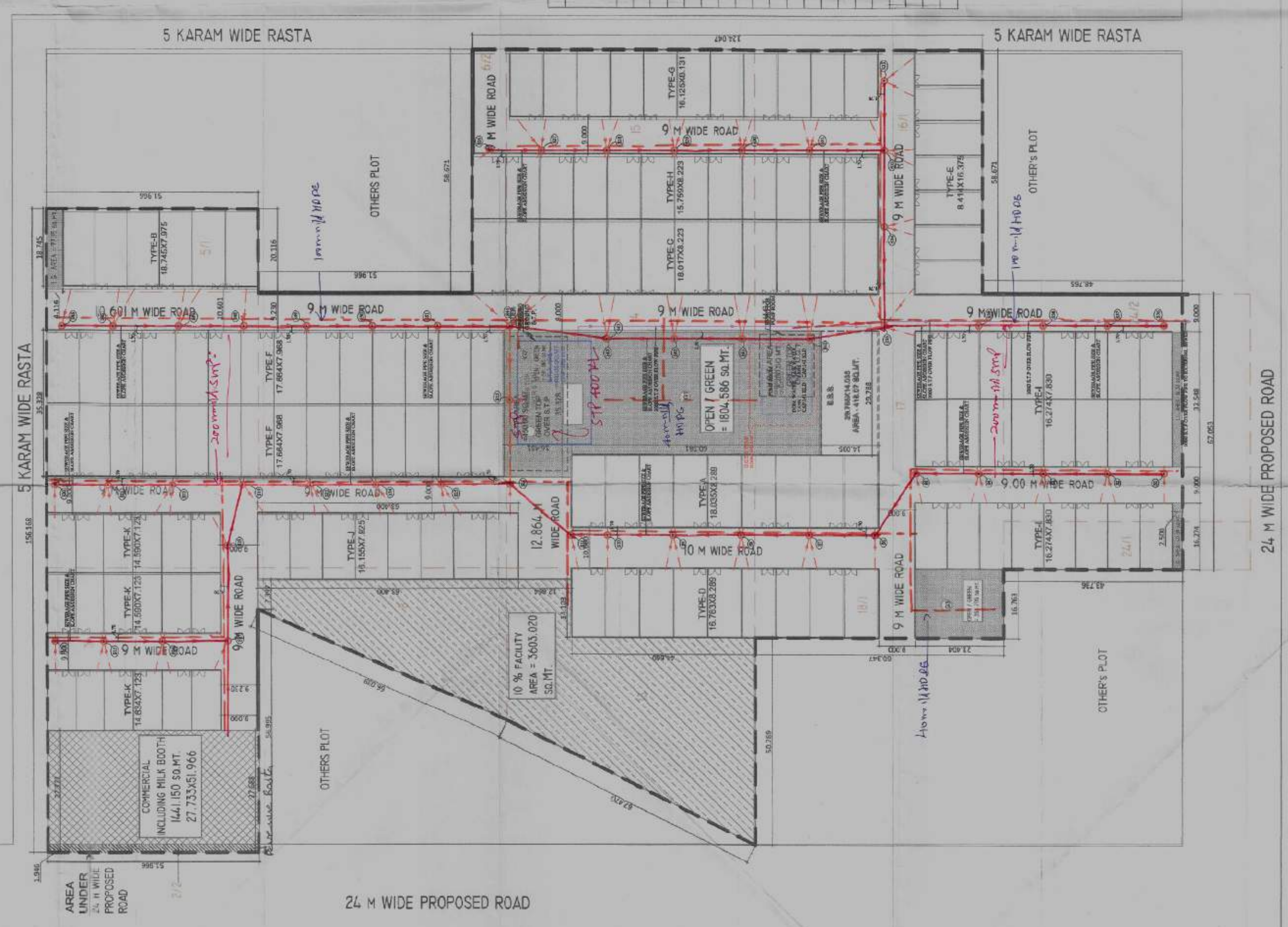

FLUSHING AND SEWERAGE SITE LAYOUT PLAN

PROJECT TITLE: PROPOSED SITE FOR O.D.LAY AFFORDABLE PLOTTED COLONY OVER AN AREA OF 8.903 ACRES FALLING IN THE REVENUE ESTATE OF VILLAGE PARMARAK, SECTOR-25D, TEHSIL & DISTRICT - RORHTAK, DEVELOPERS - PALM ABODES BULLDOGN PRIVATE LIMITED

Owner Sign: PALM ABODES BULLDOGN PVT. LTD. *Ravi* Auth. Signatory

Architect Sign: ROHIT DAGAS ARCHITECTS & URBAN PLANNERS CHANDIGARH *Rohit* Auth. Signatory

SCALE: 1:500 (A1) Architect: SACHIN TYAGI

DATE: 10-09-2022

Drgt. No. 01

TITLE SITE LAYOUT PLAN

RD DESIGN ATRIUM ARCHITECTS & URBAN PLANNERS CHANDIGARH

ALL DIMENSIONS ARE IN METERS.

PLOT AREA DETAIL

TYPE	WIDTH	LENGTH	AREA	NO OF PLOTS	TOTAL AREA UNDER PLOTS
A	8.289	18.035	149.500	9	1345.500
B	7.975	18.745	149.490	6	896.940
C	8.223	18.017	148.150	12	1777.800
D	8.289	16.763	138.950	9	1250.550
E	8.414	16.375	137.790	7	964.530
F	7.968	17.664	140.740	28	3940.720
G	8.131	16.125	131.110	11	1442.210
H	8.223	15.759	129.580	12	1554.960
I	7.83	16.274	127.430	24	3058.320
J	7.925	16.155	128.030	8	1024.240
K	7.123	14.59	103.920	12	1247.040
L	7.123	14.634	104.240	6	625.440
TOTAL PLOTS AREA				144	19128.250
TOTAL OPEN / GREEN AREA					4.72669
TOTAL OPEN / GREEN AREA (in sq.mt.)					2744.561
TOTAL OPEN / GREEN AREA (in sq.mt.)					0.67820
TOTAL OPEN / GREEN AREA (in sq.mt.)					7.618

OPEN / GREEN AREA

S.NO	NO.	PREFIX	LENGTH	BREATH	AREA
G1	1	1	29.788	60.381	1804.586
G2	1	1	35.328	16.451	581.180
G3	1	1	16.763	21.404	358.795
TOTAL OPEN / GREEN AREA (in sq.mt.)					2744.561
TOTAL OPEN / GREEN AREA (in sq.mt.)					0.67820
TOTAL OPEN / GREEN AREA (in sq.mt.)					7.618

DEF -
 1) Flushing line shown thus ---
 2) Sewer line shown thus ---

Palmit Dabas
 Architect & Urban Planner
 5 Aves, W Phase (Jyoti Residency)
 Chandigarh-160002

Palmit Dabas
 Architect & Urban Planner
 5 Aves, W Phase (Jyoti Residency)
 Chandigarh-160002

only for service plan estimate.

Executive Engineer
 H S Y P Division No.-II
 RORHTAK

Supervising Engineer
 H S Y P Circle, Rorhtak

Director General
 Town & Country Planning
 Haryana, Chandigarh

