

Note:
 1. BUILDING WILL BE DESIGNED (STRUCTURES) AS PER RELEVANT IS CODES FOR EARTH QUAKE RESISTANCE.

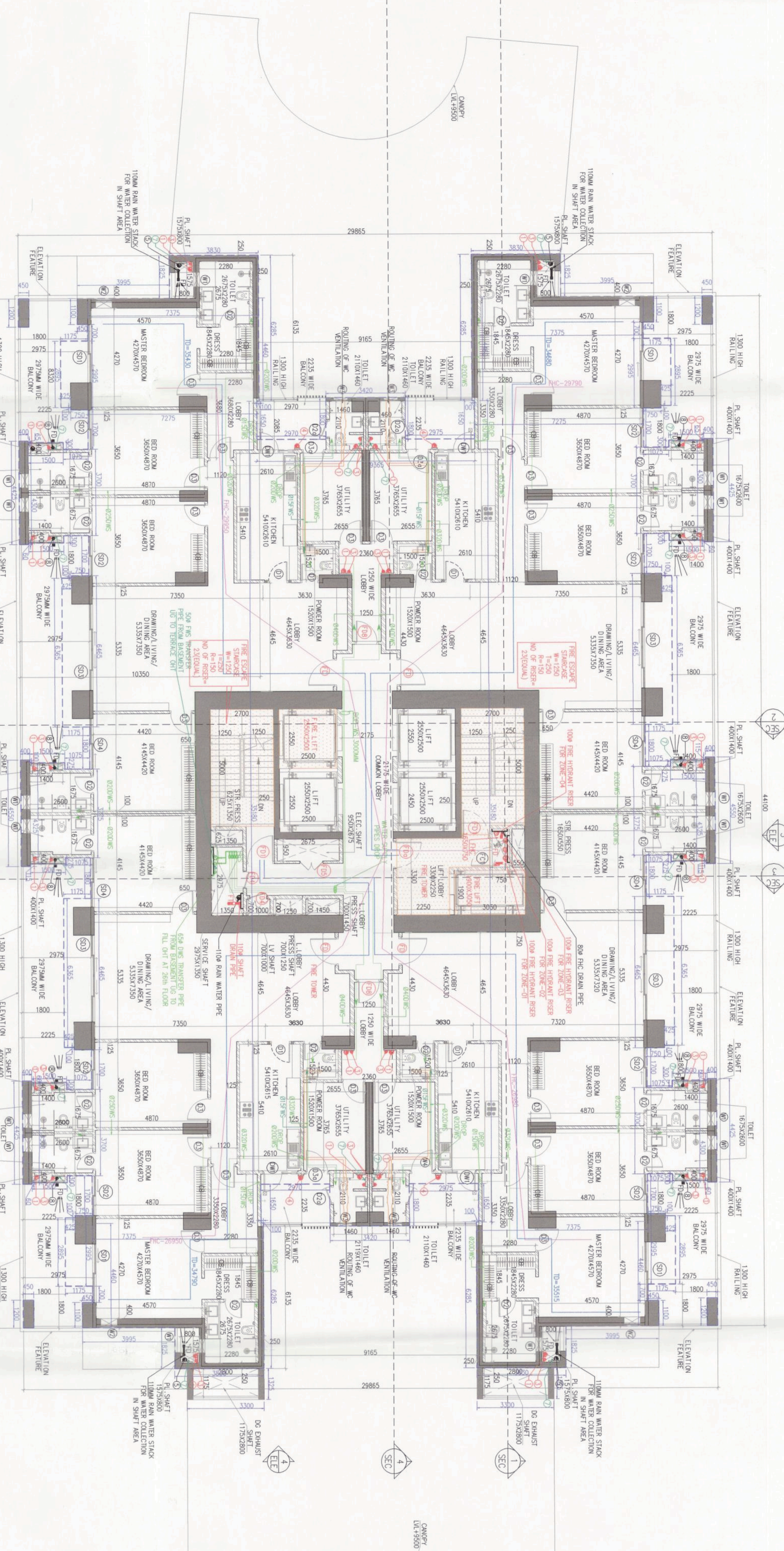

1ST FLOOR PLAN
 LT-149500
 (TOWER-F)

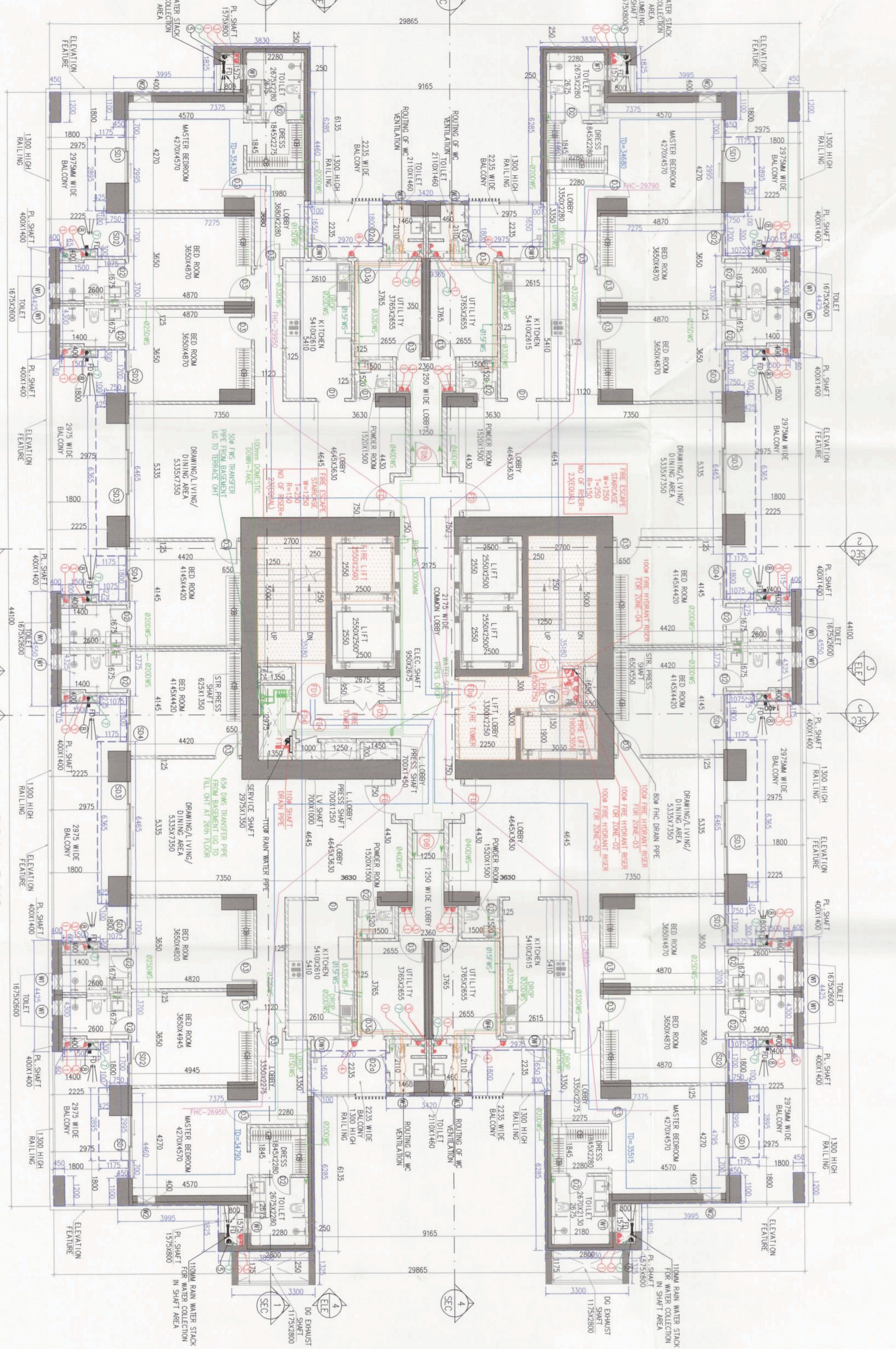

TYPICAL FLOOR
 (2ND FLOOR TO 5TH FLOOR)
 (TOWER-F)

FLOOR	TOWER
1ST FLOOR	149500
2ND FLOOR	149500
3RD FLOOR	149500
4TH FLOOR	149500
5TH FLOOR	149500

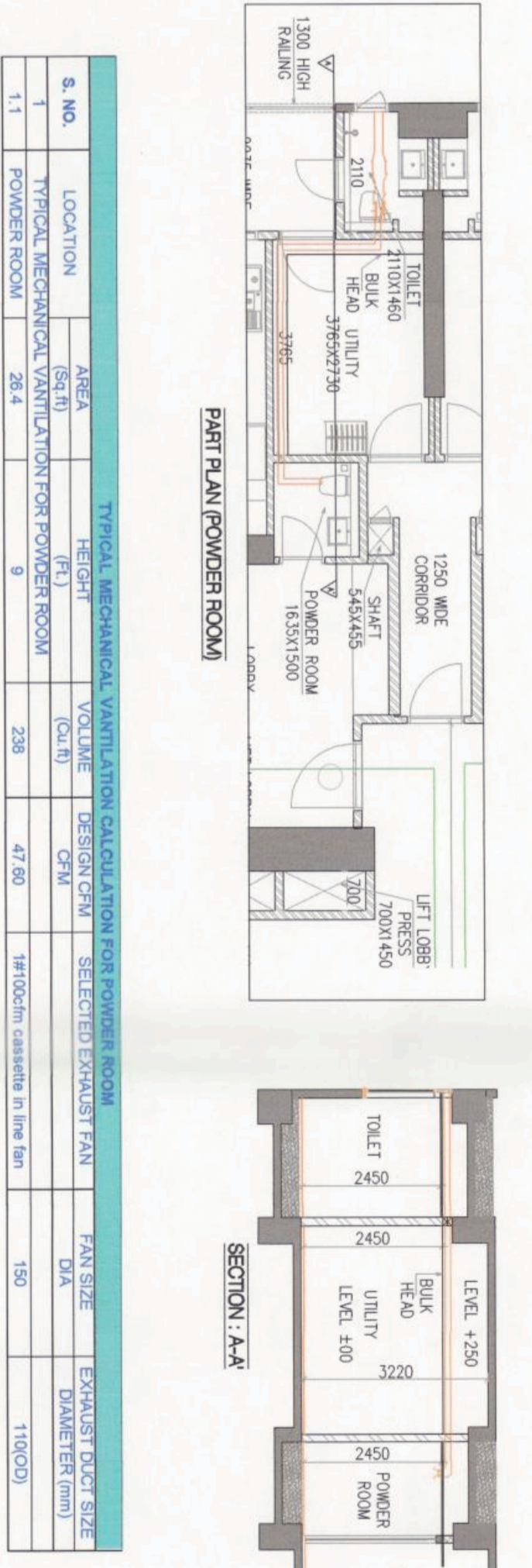

Sl. NO.	NO.	NAME	POSITION	HEIGHT	LEVEL	TYPE
1	01	DOOR	0	2420	0	UPVC
2	02	DOOR	0	2420	0	UPVC
3	03	DOOR	0	2420	0	UPVC
4	04	DOOR	0	2420	0	UPVC
5	05	DOOR	0	2420	0	UPVC
6	06	DOOR	0	2420	0	UPVC
7	07	DOOR	0	2420	0	UPVC
8	08	DOOR	0	2420	0	UPVC
9	09	DOOR	0	2420	0	UPVC
10	10	DOOR	0	2420	0	UPVC
11	11	DOOR	0	2420	0	UPVC
12	12	DOOR	0	2420	0	UPVC
13	13	DOOR	0	2420	0	UPVC
14	14	DOOR	0	2420	0	UPVC
15	15	DOOR	0	2420	0	UPVC
16	16	DOOR	0	2420	0	UPVC
17	17	DOOR	0	2420	0	UPVC
18	18	DOOR	0	2420	0	UPVC
19	19	DOOR	0	2420	0	UPVC
20	20	DOOR	0	2420	0	UPVC
21	21	DOOR	0	2420	0	UPVC
22	22	DOOR	0	2420	0	UPVC
23	23	DOOR	0	2420	0	UPVC

Sl. No.	Room Name	Area (sq. m)	Capacity
1	Bed Room	10.00	1
2	Bathroom	4.00	1
3	Living Area	12.00	1

Legend	Description
1	Room
2	Corridor
3	Staircase
4	Service Area
5	Common Area
6	Structural Column
7	Structural Wall
8	Structural Slab
9	Structural Beam
10	Structural Column
11	Structural Wall
12	Structural Slab
13	Structural Beam

Sl. No.	Room Name	Area (sq. m)	Capacity
1	Bed Room	10.00	1
2	Bathroom	4.00	1
3	Living Area	12.00	1
4	Kitchen	6.00	1
5	Dining Area	8.00	1
6	Staircase	4.00	1
7	Service Area	2.00	1
8	Common Area	1.00	1
9	Structural Column	0.50	1
10	Structural Wall	0.50	1
11	Structural Slab	0.50	1
12	Structural Beam	0.50	1
13	Structural Column	0.50	1
14	Structural Wall	0.50	1
15	Structural Slab	0.50	1
16	Structural Beam	0.50	1
17	Structural Column	0.50	1
18	Structural Wall	0.50	1
19	Structural Slab	0.50	1
20	Structural Beam	0.50	1
21	Structural Column	0.50	1
22	Structural Wall	0.50	1
23	Structural Slab	0.50	1
24	Structural Beam	0.50	1
25	Structural Column	0.50	1
26	Structural Wall	0.50	1
27	Structural Slab	0.50	1
28	Structural Beam	0.50	1
29	Structural Column	0.50	1
30	Structural Wall	0.50	1
31	Structural Slab	0.50	1
32	Structural Beam	0.50	1
33	Structural Column	0.50	1
34	Structural Wall	0.50	1
35	Structural Slab	0.50	1
36	Structural Beam	0.50	1
37	Structural Column	0.50	1
38	Structural Wall	0.50	1
39	Structural Slab	0.50	1
40	Structural Beam	0.50	1
41	Structural Column	0.50	1
42	Structural Wall	0.50	1
43	Structural Slab	0.50	1
44	Structural Beam	0.50	1
45	Structural Column	0.50	1
46	Structural Wall	0.50	1
47	Structural Slab	0.50	1
48	Structural Beam	0.50	1
49	Structural Column	0.50	1
50	Structural Wall	0.50	1
51	Structural Slab	0.50	1
52	Structural Beam	0.50	1
53	Structural Column	0.50	1
54	Structural Wall	0.50	1
55	Structural Slab	0.50	1
56	Structural Beam	0.50	1
57	Structural Column	0.50	1
58	Structural Wall	0.50	1
59	Structural Slab	0.50	1
60	Structural Beam	0.50	1
61	Structural Column	0.50	1
62	Structural Wall	0.50	1
63	Structural Slab	0.50	1
64	Structural Beam	0.50	1
65	Structural Column	0.50	1
66	Structural Wall	0.50	1
67	Structural Slab	0.50	1
68	Structural Beam	0.50	1
69	Structural Column	0.50	1
70	Structural Wall	0.50	1
71	Structural Slab	0.50	1
72	Structural Beam	0.50	1
73	Structural Column	0.50	1
74	Structural Wall	0.50	1
75	Structural Slab	0.50	1
76	Structural Beam	0.50	1
77	Structural Column	0.50	1
78	Structural Wall	0.50	1
79	Structural Slab	0.50	1
80	Structural Beam	0.50	1
81	Structural Column	0.50	1
82	Structural Wall	0.50	1
83	Structural Slab	0.50	1
84	Structural Beam	0.50	1
85	Structural Column	0.50	1
86	Structural Wall	0.50	1
87	Structural Slab	0.50	1
88	Structural Beam	0.50	1
89	Structural Column	0.50	1
90	Structural Wall	0.50	1
91	Structural Slab	0.50	1
92	Structural Beam	0.50	1
93	Structural Column	0.50	1
94	Structural Wall	0.50	1
95	Structural Slab	0.50	1
96	Structural Beam	0.50	1
97	Structural Column	0.50	1
98	Structural Wall	0.50	1
99	Structural Slab	0.50	1
100	Structural Beam	0.50	1

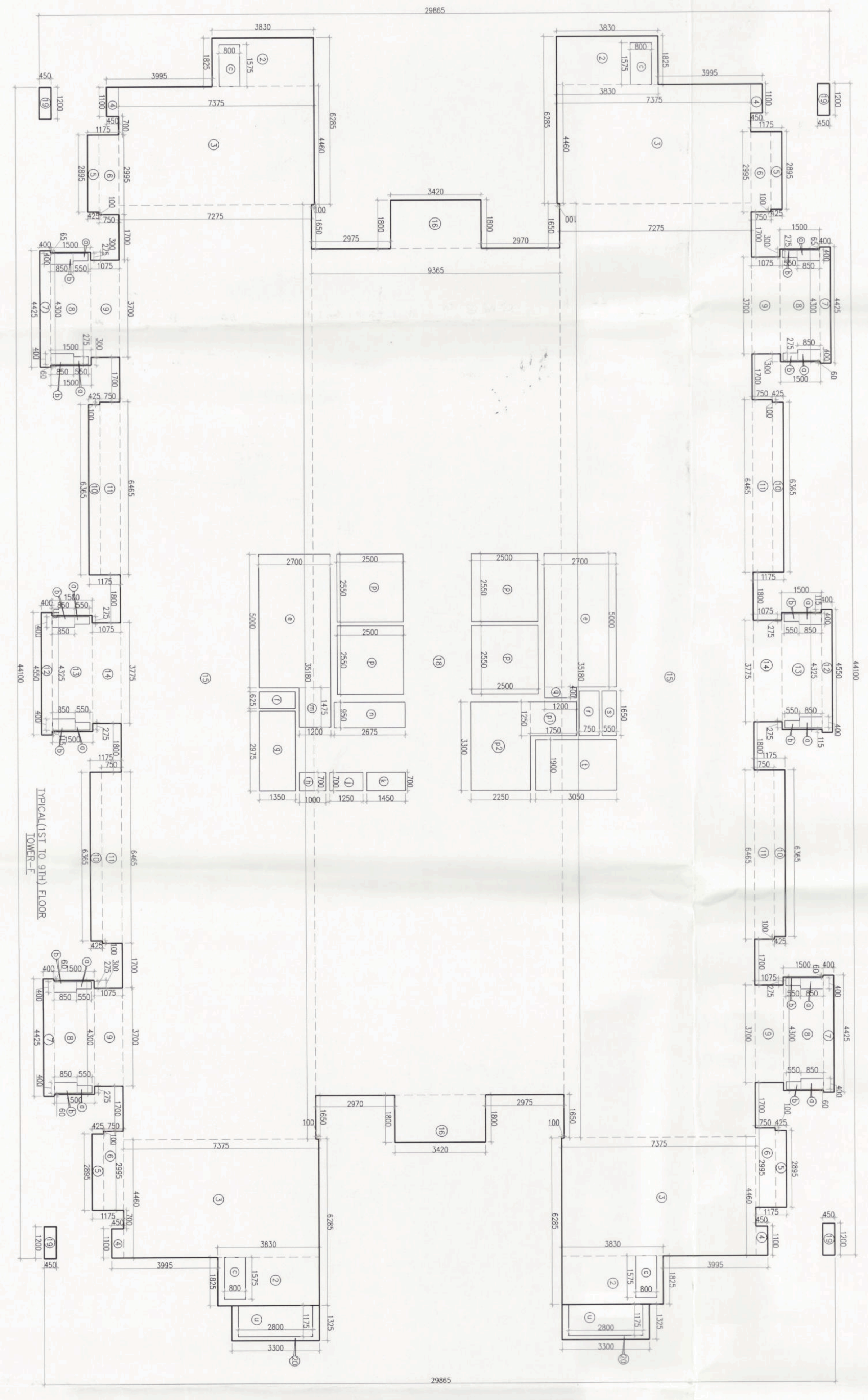

R/S/M/S ARCHITECTS
 RSM'S ARCHITECTS PVT. LTD.
 69, Nara Nivas, Bhovani Kunj,
 (Behind D2), Vasant Kunj,
 New Delhi - 110070, India
 Tel: 011-26898616, 26898617
 www.rsm-s.com

PROJECT
 RENOVATION BUILDING PLANS OF
 PHASE - (PRIMA-SOUTH) FALLING UNDER
 RESIDENTIAL CATEGORY LICENSING POLICY IN
 UNDER NEW SCHEME AND LICENSING 118-29825
 AGRES (LICENSE NO. 219 OF 2022 DATED 25-10-23)
 (AN AREA MEASURING 103.09665 ACRES MIGRATION
 FROM LICENSE NO. 27 OF 2012 DATED 02-04-2012
 IN SECTOR - 28 & 77, GURURAM WAHSAK URBAN
 COMPLEX BEING DEVELOPED BY DLF LTD IN
 LT'S ASSOCIATE COMPANIES

DESIGN ARCHITECTS
 Acrop Associates Pvt. Ltd,
 Plot No - 368 Institutional Area,
 Sector - 32, Gurgaon,
 Haryana - 122001.

SUBMISSION ARCHITECTS

ARCHITECT'S SEAL & SIGNATURE
 ARCHITECT'S SEAL & SIGNATURE
 ARCHITECT'S SEAL & SIGNATURE

DATE
 JAN - 2025

Scale
 Scale: 1:100

Drawing No.
 1ST FLOOR TYPICAL AND 2ND FLOOR PLAN (TOWER-F)

Project No.
 1-06052025