

60m wide Sector road

MAIN STORM WATER HSVP / GMDA SUPPLY LINE

12m wide West Avenue Road

DRY NO: 3784 DATED: 06-11-2023

Checked/Subject to Comments  
In Overalls refer No.133581  
D: 28/01/2024, and notes  
Attached with the estimate

Executive Engineer (H)  
for Chief Engineer-I  
HSVP, Panipat District

(P.P. SINGH)  
CTP (HR)

(R.S. BATHI)  
DTP (HQ)

(SANJAY NARANG)  
APP (HQ)

(RANI AVTAR BASSI)  
JO (HQ)

(T.L. SATYANARAYAN, IAS)  
DG, CTP (HR)

Issued Line-237 Dt. 03/11/2023

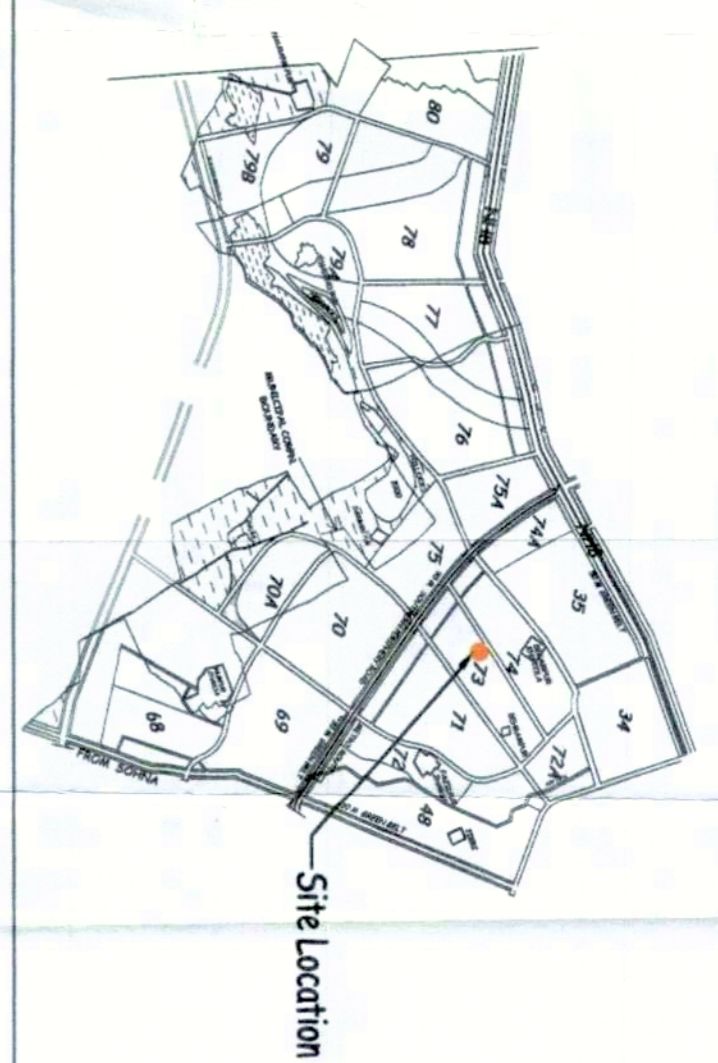

KEY PLAN

AREA DETAILS OF SCO'S 3.15625 Acre SECTOR 73

DESCRIPTION	FACTOR	AREA DESCRIPTION		SQ. MT.
		ACRES	MIGRATED AREA (Acs)	
SITE AREA		2.98125	0.175	3.15625
PERMISSIBLE G.C.	35%			12772.89
PERMISSIBLE F.A.R	1.50			4470.51
PROPOSED G.C.	34.40%			19159.33
PROPOSED F.A.R	1.50			4393.66
TOTAL NO. OF PLOTS				18831.23
RATIO OF F.A.R DISTRIBUTION ON 15Q.MT. OF GROUND COVERAGE				42
				4.286

DETAILS OF SCO'S (SECTOR 73)

TYPE	SIZE (M)		AREA		TOTAL NO OF	TOTAL AREA (SQ.M.)
	LENGTH	WIDTH	SQM.	SQYDS.		
A	19.45	7.00	136.15	163	15	2042.25
B	14.70	6.00	88.20	105	10	882.00
C	14.70	5.88	86.436	103	17	1469.41
					42	4393.66

Sheet Title :-  
STORM WATER  
LAYOUT PLAN

Project  
REVISED LAYOUT PLAN FOR PLOTTED COMMERCIAL (SCO) AN AREA MEASURING  
3.15625 ACS. IN SECTOR 73, VILLAGE BEGUMPUR KHATOLA, GURUGRAM (HARYANA)

SCALE	DATE	DRG NO.	NORTH
NTS	06.04.2023	SCO/Comm. 73	

ARCHITECT  
FAHAD SHAHBAZ  
CA/2006/38330  
ARCHITECT

AUTHORISED SIGNATORY

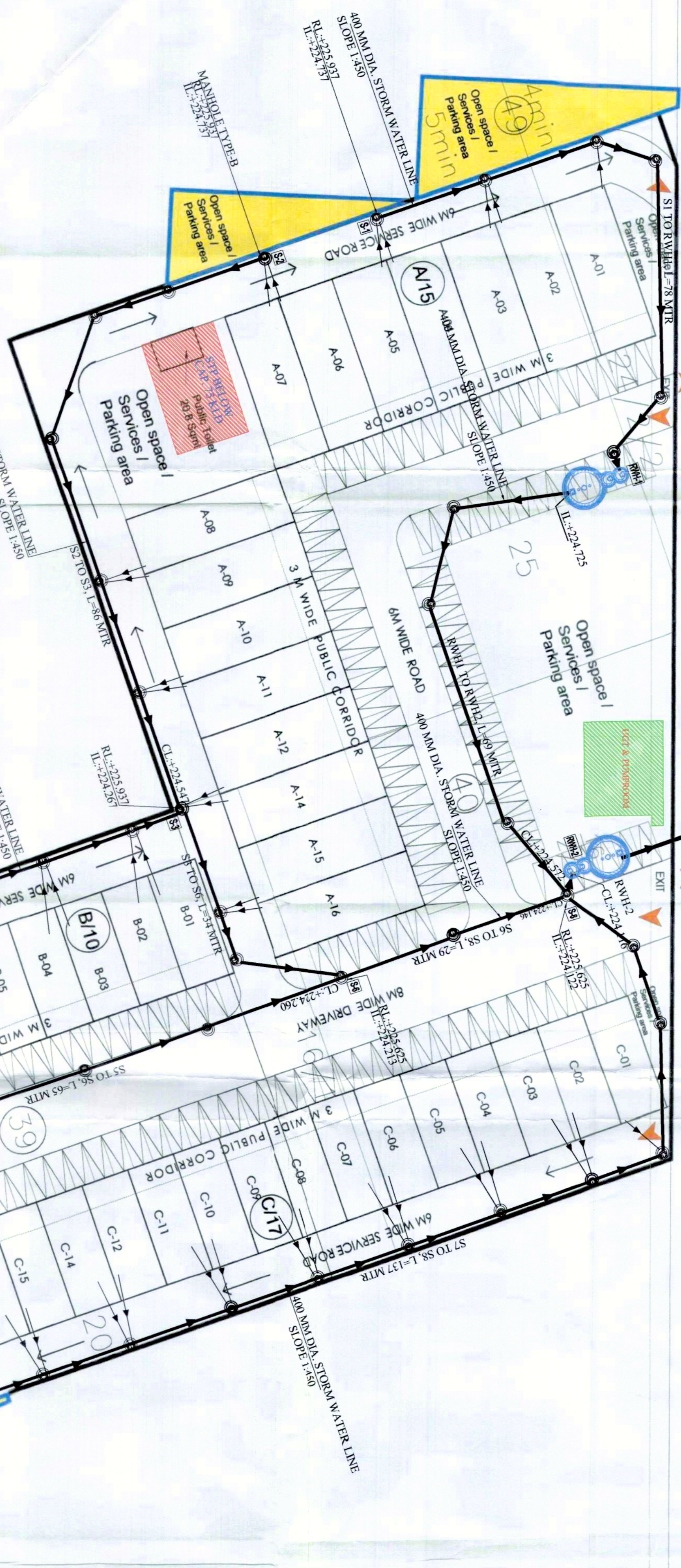

PL LEGENDS

	STORM WATER LINE
	STORM WATER MANHOLE

LICENCED AREA  
2.98125 ACS. (A)

AREA BEING MIGRATED  
0.175 ACS. (B)

TOTAL AREA (A+B)  
3.15625 ACS.

STORM WATER LAYOUT



Only For Survey Plan Estimate  
Supervising Engineer,  
HSVP, Division No. 2, Gurugram